

Ridge 54.94

Stone Building

Proposed conversion of an office and store under an existing first floor flat to form a dwelling and the conversion of a single storey flat to form a one bed apartment at The Old Pottery, School Lane, Charlestown, PL25

PN005a

Scale 1:100

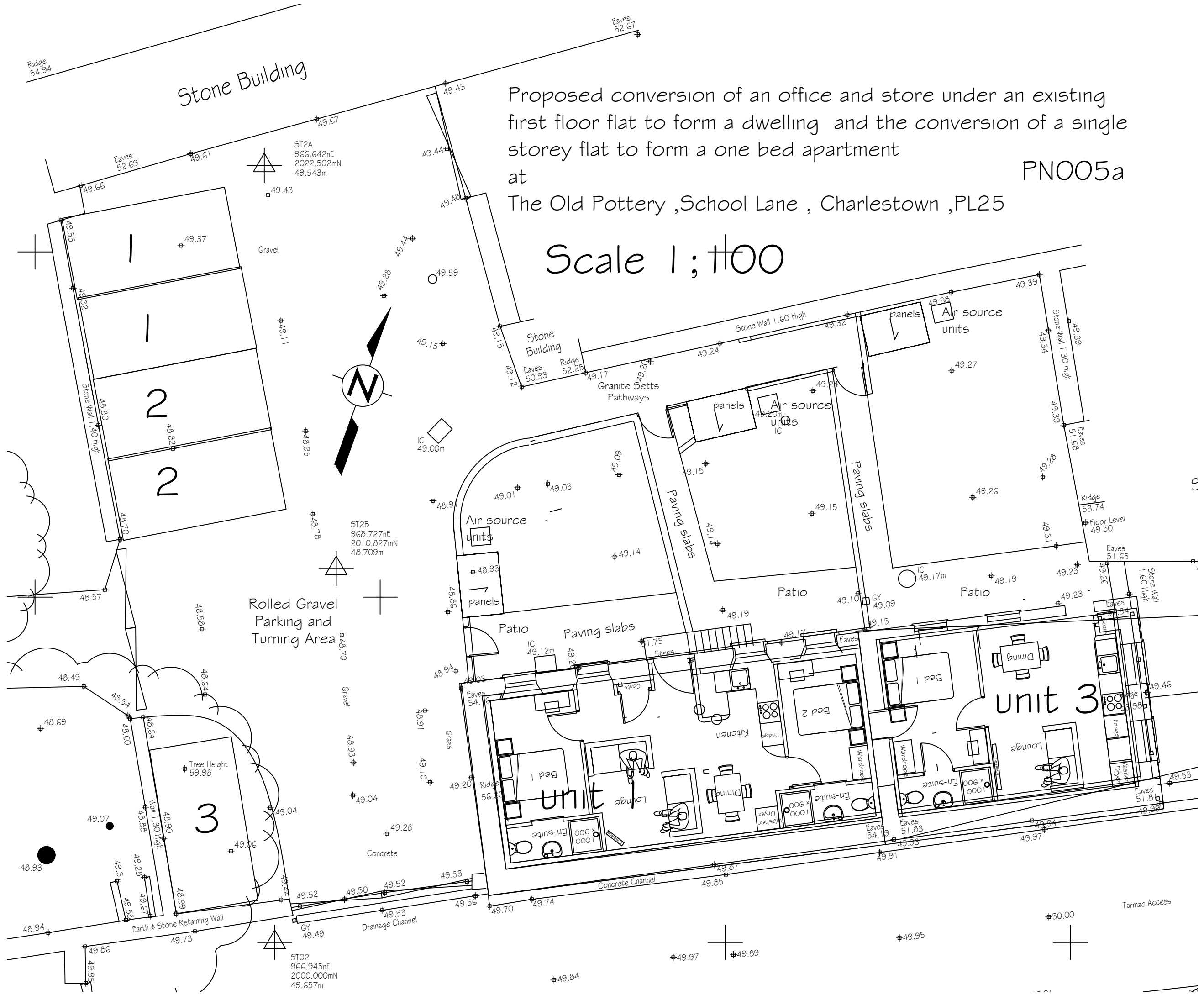

ST2A  
966.642nE  
2022.502mN  
49.543m

ST2B  
968.727nE  
2010.827mN  
48.709m

ST02  
966.945nE  
2000.000mN  
49.657m

Tarmac Access