

General Notes

The copyright of this drawing and design remains the intellectual property of the designers and may not be used without the written permission of Great Space Architecture Limited. Do not Scale. Verify all dimensions on site before commencing work or preparing shop drawings. Report any discrepancies, errors or omissions to the designers and await further instructions before the commencement of works. All building materials, components and workmanship to comply with the appropriate public health acts, building regulations, British standards, codes of practice and the appropriate manufacturer's recommendations. Ensure all works are carried out by competent person. Refer to the relevant drawings or method statement for all specialist work.

Materials:

- 1. Stone
- 2. Masonry
- 3. Slate tile
- 4. Clay tile
- 5. Corrugated sheet
- 6. Metal rainwater goods
- 7. Upvc window
- 8. Timber window
- 9. Timber door
- 10. Timber cladding
- 11. Roof window
- 12. Zinc standing seam
- 13. Timber obscure glazing
- 14. Timber slats



Existing North Elevation
1 : 50

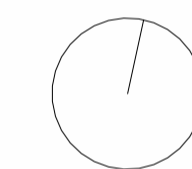
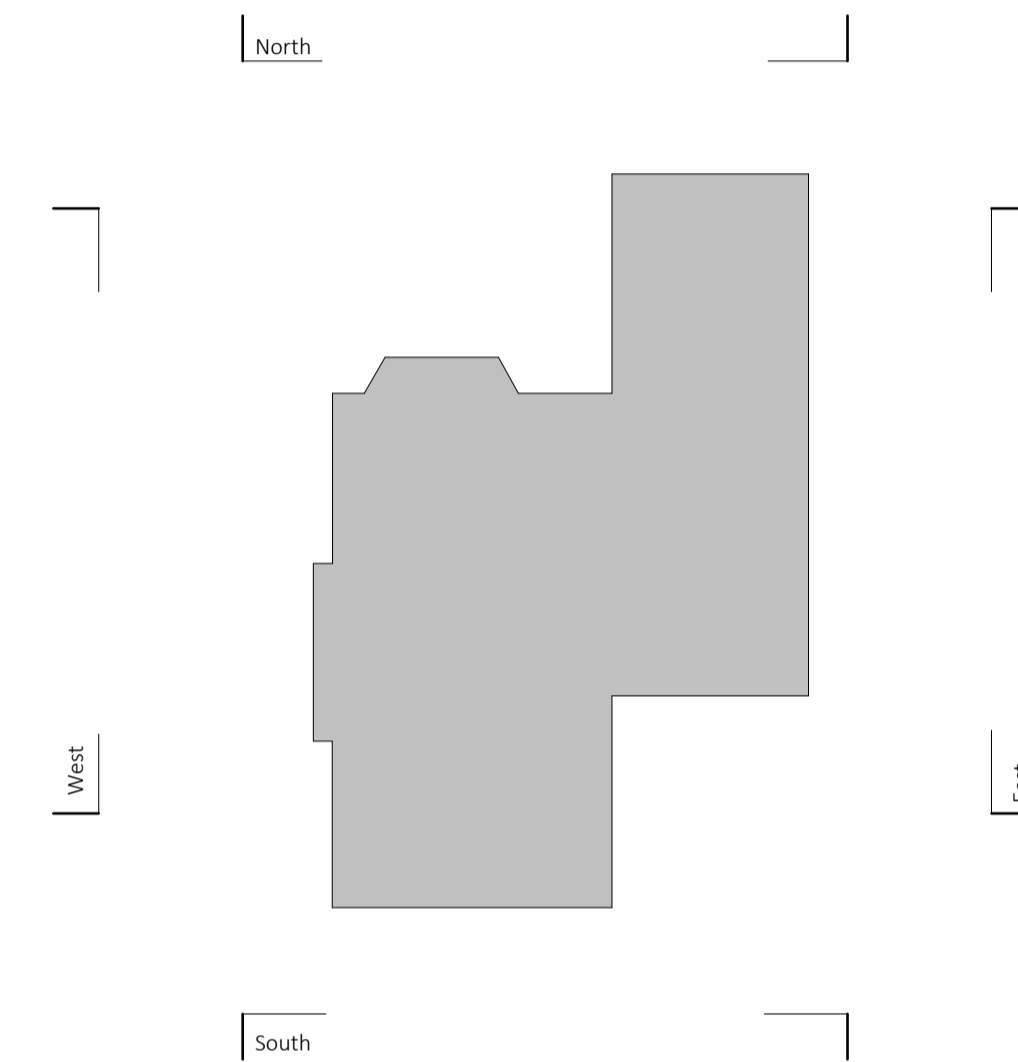

Key plan existing



Existing East Elevation
1 : 50

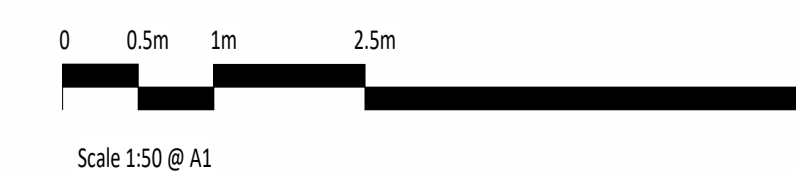

PO2	14.08.23	View titles revised and key plan added
PO1	07.08.23	Issued for Detailed Planning Consent
Rev	Date	Description

Project	Beech Close - School House	Date drawn	22/06/22
Drawing Title	Existing Elevations - Sheet 2	Drawn by	MA
		Checked by	BK
		Scale @ A1:	As indicated

PLANNING for illustrative purposes only				
Project	Origin	Volume	Level	
22_037	GSA	02	XX	
File type	Discipline	Sheet no	Stage	Rev
DR	A	02 008	S2	P02

01434 394 220
info@greatspacearchitects.com
© Great Space Architecture Ltd.

Greatspace
Architects

14/08/2023 15:53:52