

- Notes -

All dimensions to be verified on site. Figured dimensions to take preference to those scaled; all dimensions are approximate. New construction shown in thick outline only, and existing walls shown shaded. All discrepancies to be clarified with project Architect.

This drawing is the property and copyright of GMS Architecture and is issued on the condition it is not reproduced, retained or disclosed to any unauthorised person(s), either wholly or in part without the written consent of GMS Architecture.

Rev	Revisions	Date	Drawn	Checked

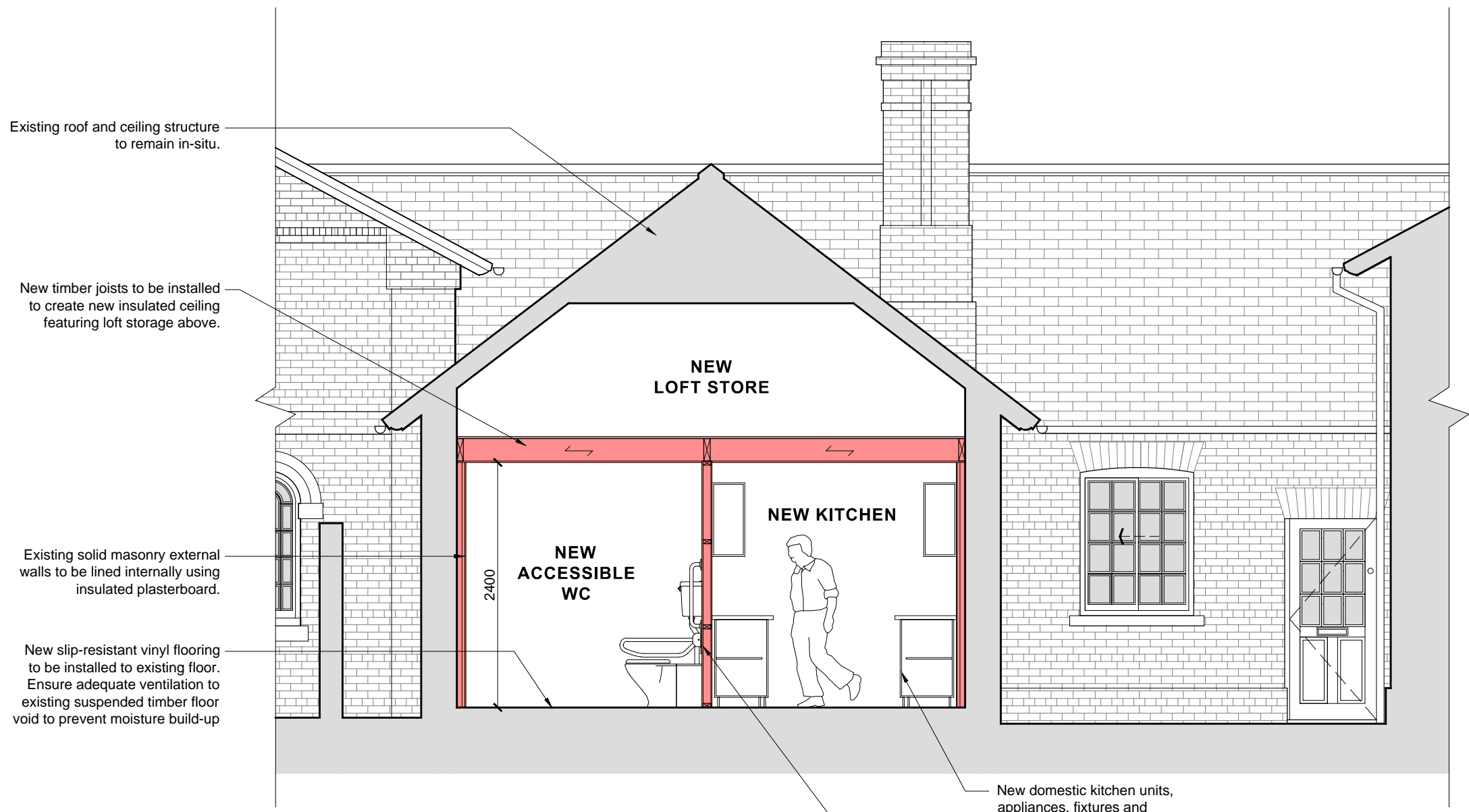

PROPOSED SECTION B-B
1:50 @ A3



LISTED GRADE II BUILDING

Drawing status:
PLANNING

Client:
Stixwold Village Hall

Drawing title:
PROPOSED SECTION B-B

Project:
REFURB & ALTERATIONS:
Stixwold Village Hall is located at Main Road,
Stixwold, Woodhall Spa, LN10 5H

Drawn by: D.C	Checked by: C.M-S	Date: 18.07.2023
Project number: 3104	Scale: 1:50	Original paper size: A3
Drawing number: 3104 / 15		Rev. *

GMS GLEW MACKINTOSH-SMITH
architecture

www.gmsarch.co.uk

66 Mona Road
West Bridgford
Nottingham
NG2 5BT

(01507) 338565
0115 9193060
info@gmsarch.co.uk