

- Notes -

All dimensions to be verified on site. Figured dimensions to take preference to those scaled; all dimensions are approximate. New construction shown in thick outline only, and existing walls shown shaded. All discrepancies to be clarified with project Architect.

This drawing is the property and copyright of GMS Architecture and is issued on the condition it is not reproduced, retained or disclosed to any unauthorised person(s), either wholly or in part without the written consent of GMS Architecture.

Rev	Revisions	Date	Drawn	Checked
A	Added elevation tags	19.06.23	D.C	C.M-S

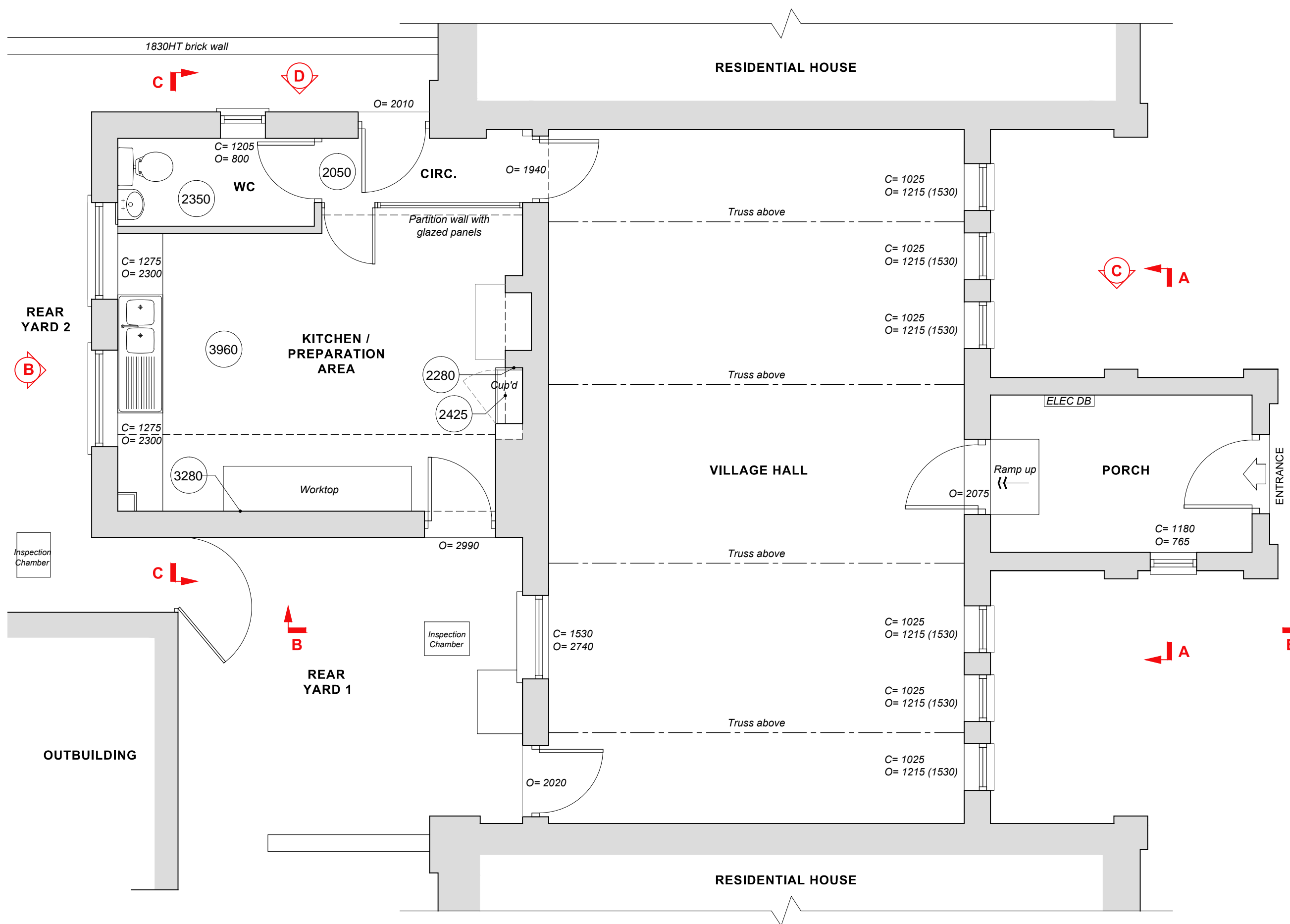

LISTED GRADE II BUILDING

Drawing status:		
PRELIMINARY		
Client:		
Stixwold Village Hall		
Drawing title:		
Existing Ground Floor Plan		
Project:		
REFURB & ALTERATIONS: Stixwold Village Hall is located at Main Road, Stixwold, Woodhall Spa, LN10 5H		
Drawn by:	Checked by:	Date:
D.C	C.M-S	07.06.2023
Project number:	Scale:	Original paper size:
3104	1:50	A3
Drawing number:	Rev.	
3104 / 02		A

GMS GLEW MACKINTOSH-SMITH
architecture
www.gmsarch.co.uk

66 Mona Road
West Bridgford
Nottingham
NG2 5BT

(01507) 338565
0115 9193060
info@gmsarch.co.uk

EXISTING GROUND FLOOR LAYOUT PLAN
1:50 @ A3