

EXISTING BUILDING HEIGHTS (ABOVE)
 1:100 @ A4

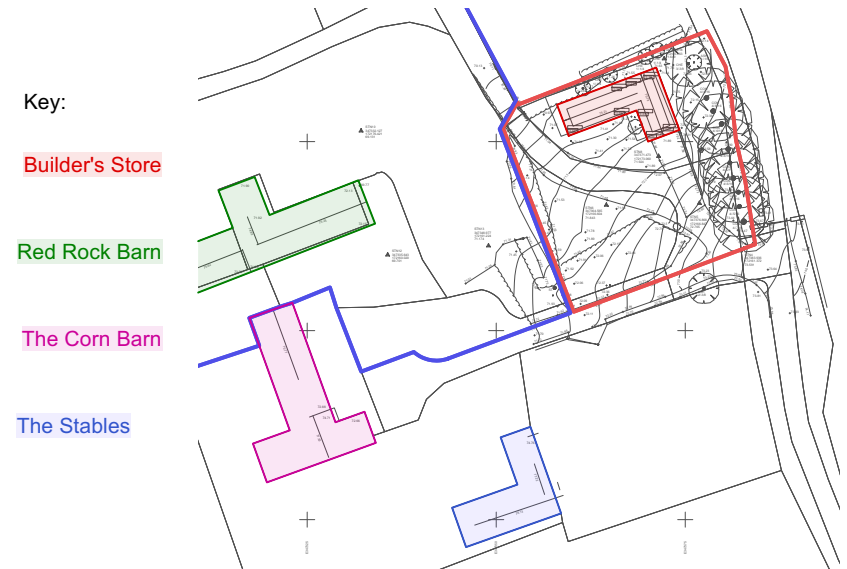

EXISTING BUILDING HEIGHTS KEY (ABOVE)
 1:1000 @ A4

Mike Smith

A: 193 Clevedon Rd, Tickenham, North Somerset, BS21 6RT
 T: 07760723257
 E: mikesmith199@hotmail.co.uk

Mike Smith retains the copyright to all the information within this drawing.

This drawing is to be read in conjunction with all other drawings, details and specifications. All dimensions are to be checked on site prior to any commencement of building works.

Do not scale from this drawing.

NOTES:

REVISION:

CLIENT: Karen Jacquest and Gary Traviss	DRAWN BY: MS
PROJECT TITLE: Conversion of Builder's Store to Dwelling	REV: -
LOCATION: Red Rock Barn, Tickenham Hill, Bristol, BS21 6SW	DATE: JUL 2022
DRAWING TITLE: Existing Building Heights	SCALE: 1:100 @ A4
DRWG NO: 2301_S_05	STATUS: CONCEPT

