

GENERAL NOTES.

THIS DRAWING IS PROTECTED BY 'COPYRIGHT' AND MUST NOT BE COPIED WITHOUT PRIOR PERMISSION FROM LIVING DESIGNS

THIS DRAWING HAS BEEN PREPARED TO OBTAIN PLANNING CONSENT ONLY THEREFORE THESE PLANS SHOULD NOT BE USED FOR CONSTRUCTIONAL PURPOSES.

THESE PLANS MUST BE READ IN CONJUNCTION WITH ALL DRAWINGS, DETAILS, CALCULATIONS & SPECIFICATIONS ISSUED FOR CONSTRUCTIONAL PURPOSES BY LIVING DESIGNS, THE STRUCTURAL ENGINEER AND ALL RELEVANT SUPPLIERS AND MANUFACTURERS.

ANY WORKS CARRIED OUT ON SITE BY THE CLIENT OR HIS MAIN/SUB CONTRACTORS PRIOR TO APPROVAL (OR THE SUBMISSION OF ANY ADDITIONAL INFORMATION OR DETAILS OR SAMPLES OR CALCULATIONS OR REPORTS REQUESTED BY THE PLANNING DEPARTMENT IN ANY CONDITIONAL APPROVAL) IS CARRIED OUT ENTIRELY AT THEIR OWN RISK.

IT SHALL BE BOTH THE CLIENTS AND PRINCIPLE CONTRACTORS RESPONSIBILITY TO EMPLOY A FULLY QUALIFIED 'CDM COORDINATOR' OR ALTERNATIVELY NOTIFY HSE TO ENSURE THE REQUIREMENTS OF THE CURRENT LEGISLATION COVERED BY THE CONSTRUCTION (DESIGN AND MANAGEMENT) REGULATIONS 1994 & THE HEALTH AND SAFETY AT WORK ACT AS WELL AS THE MANAGEMENT OF HEALTH AND SAFETY AT WORK ACT ARE COMPLIED WITH BY ALL SITE STAFF/SUPPLIERS ETC DURING THE VARIOUS STAGES OF THE DESIGN AND CONSTRUCTION WORKS.

IF IN DOUBT ASK

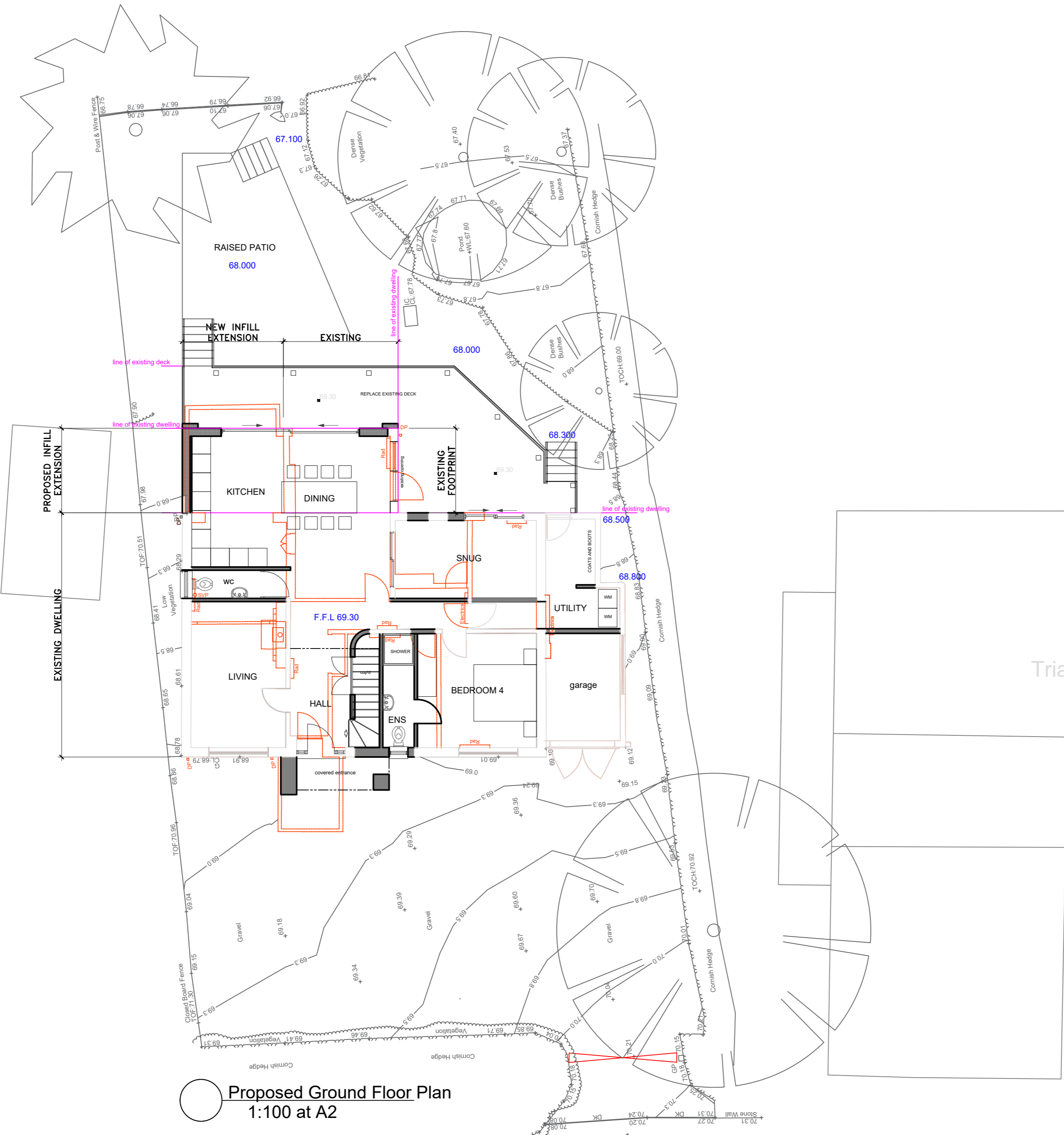
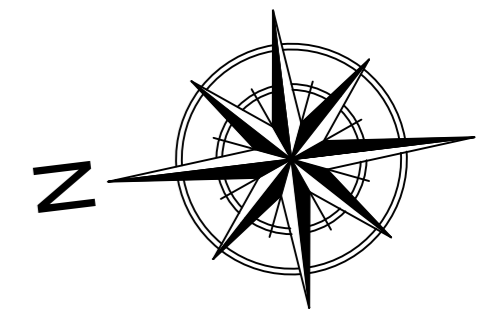

Broad Reach

Triana

Trewen Road

Proposed Ground Floor Plan  
1:100 at A2

Proposed Ground floor infill extension 7.2m<sup>2</sup>  
Proposed Porch 3m<sup>2</sup>

- Demolition
- Proposed Walls

|   |                    |           |
|---|--------------------|-----------|
| C | General amendments | 08.8.2023 |
| B | General amendments | 21.6.2023 |
| A | General amendments | 20.6.2023 |

Revisions

Proposed rear ground floor extension to replace conservatory with a first floor extension over. Proposed dormers to front and rear. Proposed roof modification, existing ridge height maintained. Alterations to and replacement of existing openings. Replacement Porch. Existing deck replaced

Site Address: Blue Horizon  
Trewen Road  
Budock Water  
Falmouth  
TR11 5EB

Client: Sarah Levinsky and Norbert Benjamin

Drawing Title: Proposed Ground Floor Plan

| PLANNING   |          |              |
|------------|----------|--------------|
| Scale      | Drawn by | Date         |
| 1:100 @A2  | KB       | 08/08/23     |
| Drawing No | Rev      | Purpose      |
| KB0345/03  | B        | FOR APPROVAL |

**LIVING DESIGNS**  
ARCHITECTURAL SERVICES

The HoHouse, Unit 2, Hope Yard, Newquay, Cornwall, TR7 1NN840  
07985 760464  
info@livingdesigns-architecturalservices.com