

## Contents

Front Cover	2
Drainage Scheme Drawings	3
Installation Document of Various Drainage	21
Installation Document for Manholes and Connections	39
Maintenance	165
Table of Contents of Products Used	172
Products Used	173

Westerleigh Group

New Crematorium

Herne Bay

Pre – Occupation Condition 4

Drainage Report Surface Water

Please see attached our installation records that include dates of installation record photographs and QA sheets for drainage system installed at the above site, all in line with the **Approved SLR design** attached (which is the critical drainage asset drawing for the scheme), all levels are as the design to all water retention areas IE swale, pound etc, with extra overflow points as detailed within the design, there as been no changers to this design from the onset regards pipe sizes location and materials used.

You will note from the information provided we have followed the **design as required and not deviated from this.**

We also include a separate file that purely shows the out and inlet points to all water bodies which area critical part of the design to prevent any surge from the new system to the existing drainage systems within the area, there has also been installed the overflow points if the rainfall is greater than any 1 in 100-year requirement for the design.

We have also include the landscape design as required which we are installation against, whilst writing we have only just progressing this element, but as you can see from the photos with this is now progressing with topsoil etc ready to start the planting process.

**Please note that this Surface Water System only connects to a exist brook.**

We have also attached the general maintenance advise for any drainage system.

# Drainage Scheme Drawings

**NOTE:**  
Contractor to include for the preparation and submission of a verification report pertaining to the drainage installation.  
The purpose of the report is to fully discharge Planning Condition 4 and should contain information and evidence (including photographs) of details and locations of all elements - please refer to the Planning Conditions for further details.

**NOTE:**  
Contractor to allow separate price within the Tender for 100m of French Drain and 8No. PPI's in addition to that detailed on the drawings. Allow for 1m deep x 0.9m wide trench.

**NOTE:**  
As part of the contractors 'As Built' package of information on the drainage i.e. CCTV survey and report, coordinates to all drainage features to be provided in MS Excel format.

**NOTE:**  
Contractor to comply with the conditions of the OMC consent. Contractor will need to submit a fully detailed method statement for the work and give KCC adequate notice before commencement.

3No. New 300mmØ pipes (Class Z bedding) to maintain overland flow path. Laid to match existing ground levels (=1 in 60), with bagwork headwalls. All pipes to be fitted with internal vermin grates.

FOR CONTINUATION REFER TO EXTRACT BELOW

- NOTES**
- This drawing to be read in conjunction with all relevant Architect's and Engineer's drawings and the Specifications.
  - Do not scale this drawing.
  - For Road Setting Out refer to drawings 402.02845.00055/20 and 21.
  - For Setting Out Co-ordinates refer to drawing 402.02845.00055/22.
  - For Road Levels, please refer to Dwg. 402.02845.00055/23 and 24.
  - For Road Construction Details, please refer to Dwg. 402.02845.00055/25 and 26.
  - For drainage layout around the crematorium please refer to Dwg. 402.02845.00055/28.
  - White lining, Lamp posts & Bollards are shown indicatively. Design and details are by others.
  - The Contractor is to remain responsible for the temporary works and ensuring stability is maintained throughout the works.
  - Note that the background level information is the topographical survey data of the existing site.
  - All drainage to be kitemark certified and installed in accordance with the latest edition of 'Sewers for Adoption' and 'Design and Construction Guidance (DCG)'.

- LEGEND**
- SITE ACCESS ROAD**  
Dense bitumen macadam construction. Refer to drawing 402.02845.00055/25 for details.
  - CREMATORIUM ROADS**  
Dense bitumen macadam construction. Refer to drawing 402.02845.00055/25 for details.
  - MAIN FOOTPATHS**  
Dense bitumen macadam construction. Refer to drawing 402.02845.00055/25 for details.
  - PERMEABLE CONSTRUCTION TO CAR PARKS**  
Refer to drawing 402.02845.00055/25 for details.
  - TACTILE PAVING**  
Refer to drawing 402.02845.00055/26 for details.
  - PATHS & FLORAL TRIBUTE AREA**  
Block pavior construction (refer also to Architects drawings). Refer to drawing 402.02845.00055/25 for details.
  - APRON TO SERVICE YARD**  
Reinforced concrete. Refer to drawing 402.02845.00055/25 for details.
  - GRAVEL CONSTRUCTION TO OVERFLOW CAR PARKS**  
Refer to drawing 402.02845.00055/25 for details.

- KERB REFERENCES:**
- NOTE:**  
All PC kerbs are to BS EN 1340:2003
- HB2 = PC Kerb - Raised
  - TK = Transition Kerb (PC or Conservation Kerb to suit location)
  - DK = Dropped Kerb (PC or Conservation Kerb to suit location)
  - CK-R = Conservation Kerb - Raised
  - CK-F = Conservation Kerb - Flush
  - EF = PC Kerb - Flush (footpath areas only)
  - CS2 = PC Square Channel - Flush
  - SP2 = PC splayed kerb
  - BN-RV = PC Kerb - Flush (BN kerb reversed)
  - CK-FRV = Conservation Kerb - Flush (CK-F kerb reversed)

- Refer to details on drawing 402.02845.00055/26.
- Indicates proposed Foul Water drainage.
  - Indicates 'treated' Foul Water drainage.
  - Indicates proposed Surface Water drainage.
  - Indicates proposed French Drain.
  - Indicates land drainage.
  - Indicates landscaping drainage.

Revision	By	Checked By	Date	Comments
P0	DH	SDE	NOV 22	Initial Issue



TREENWOOD HOUSE  
ROWDEN LANE  
BRADFORD-ON-AVON  
WILTS. BA15 2AU  
T: 01225 309400  
F: 01225 309411  
www.slrcosulting.com

Site HERNE BAY CREMATORIUM BULLOCKSTONE ROAD, HERNE BAY, KENT		Project HERNE BAY CREMATORIUM	
Drawing Title <b>ROAD &amp; BUILDING DRAINAGE</b> <b>SHEET 1 OF 2</b>		Scale 1:250 @ A1	Date NOVEMBER 2021
Drawing Number <b>402.02845.00055/27</b>		Revision <b>C0</b>	CONSTRUCTION

Revision	By	Checked By	Date	Comments
C0	SDE	SDE	NOV 22	CONSTRUCTION ISSUE
T4	DH	SDE	MAY 22	Revised Tender Scheme. TENDER ISSUE
T3	SDE	SDE	MAR 22	Reno mattress protection to culvert outlet added. Section 4.4 added.
T2	SDE	SDE	FEB 22	North end of swale reconfigured at LPA request.
T1	SDE	SDE	JAN 22	Brick Head Wall (North) coordinates added.
T0	SDE	SDE	DEC 21	TENDER ISSUE. Sub-station added.

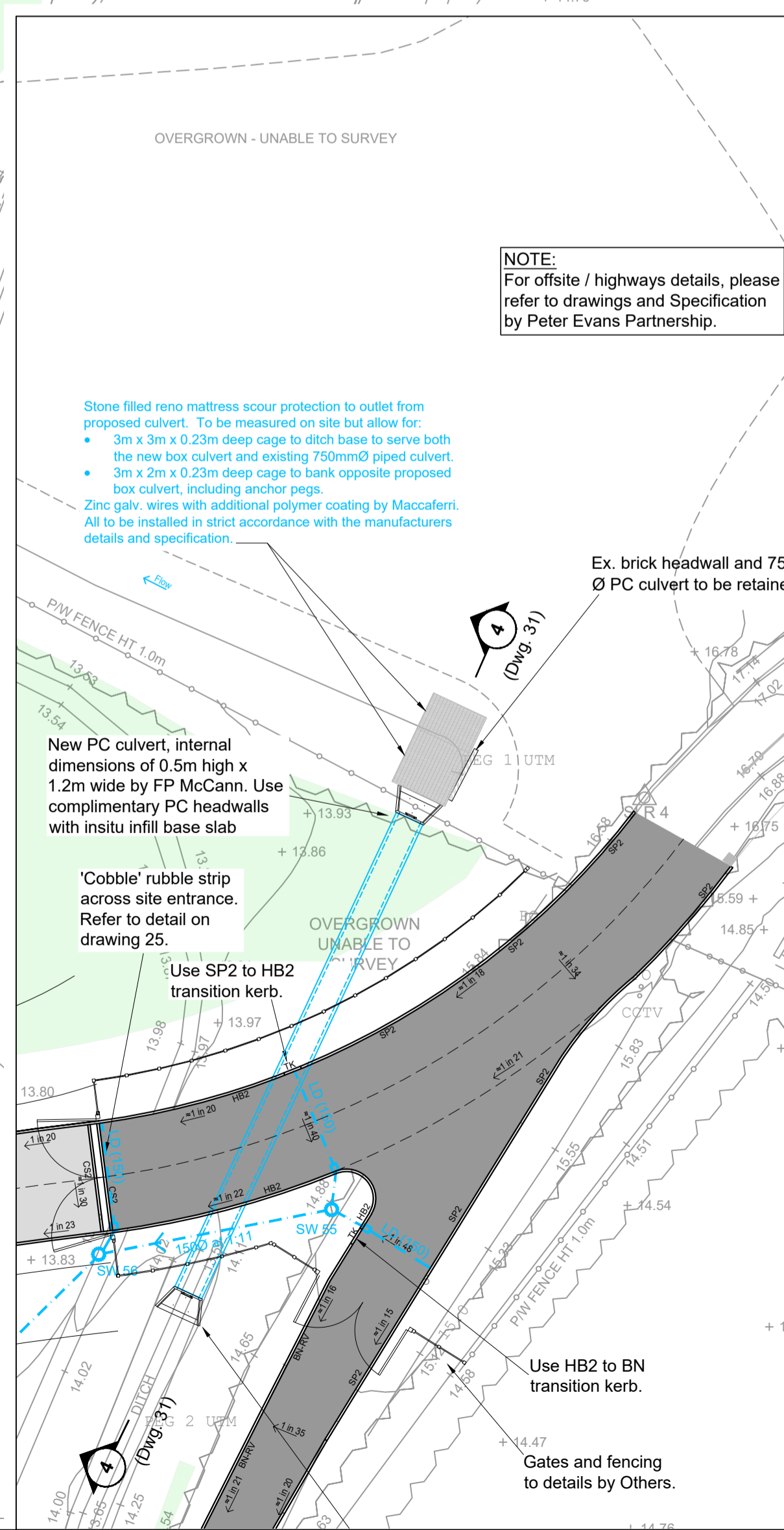
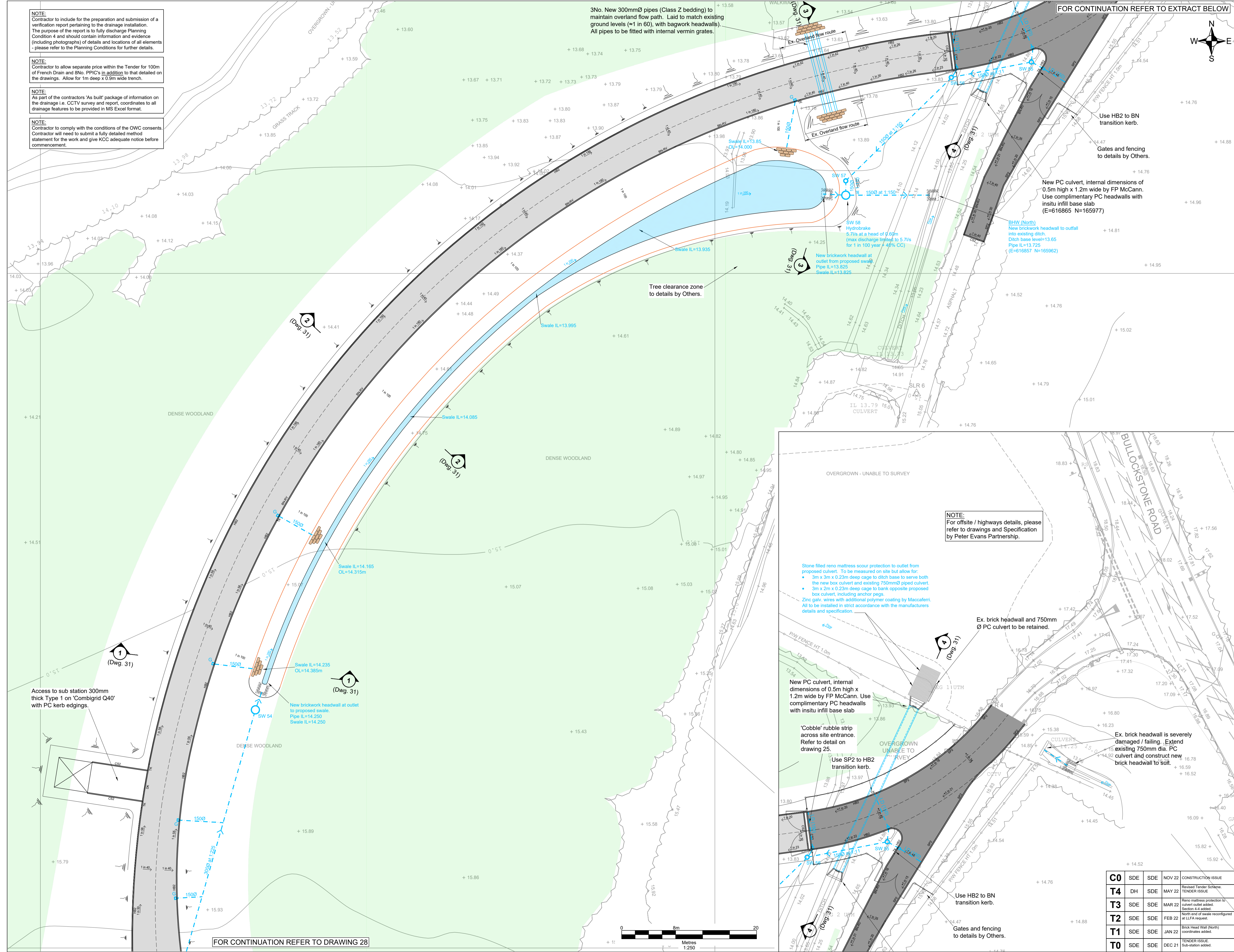

FOR CONTINUATION REFER TO DRAWING 28



**NOTE:**  
Contractor to include for the preparation and submission of a verification report pertaining to the drainage installation. The purpose of the report is to fully discharge Planning Condition 4 and should contain information and evidence (including photographs) of details and locations of all elements - please refer to the Planning Conditions for further details.

**NOTE:**  
Contractor **MUST** refer to Indigo drawings and specification for the paths and construction details to the Memorial Gardens.

**NOTE:**  
Contractor to allow separate price within the Tender for 150m of French Drain and 10No. PPI's for the Memorial Gardens in addition to that detailed on this drawing. Allow for 1m deep x 0.9m wide trench.

**NOTE:**  
As part of the contractors 'As built' package of information on the drainage i.e. CCTV survey and report, coordinates to all drainage features to be provided in MS Excel format.

**NOTE:**  
Contractor to comply with the conditions of the OWC consents. Contractor will need to submit a fully detailed method statement for the work and give KCC adequate notice before commencement.

**BRW (South)**  
New brickwork headwall to outfall into existing brook.  
Brook base level=15.1  
Pipe IL=15.25  
(E=616540 N=165723)

Outlet from basin to have 1m length of fully perforated pipe contained within a 1.5m long stainless steel headwall basket by ContraFlow. Perforated pipe to be wrapped in stainless steel mesh (max 35mm apertures).  
Pipe IL=16.600

1m wide crest to banking to allow for maintenance access. Banking down to existing levels at max 1 in 3. (Typical)

Base of Memorial Garden basin perimeter = 535m<sup>2</sup> (16.600m AOD)  
High water level of Memorial Garden basin perimeter = 930m<sup>2</sup> (17.200m AOD)  
Top of bank to Garden basin perimeter = 693m<sup>2</sup> (Min. 17.350m AOD)

1m wide crest to banking to allow for maintenance access. Banking down to existing levels at max 1 in 3. (Typical)

FOR CONTINUATION REFER TO DRAWING 28

**NOTE:**  
For main crematorium site details, please refer to:  
• Dwg 402.02845.00055/21 - Road Setting Out Plan  
• Dwg 402.02845.00055/24 - Road Setting Levels Plan  
• Dwg 402.02845.00055/28 - Road Setting Drainage Plan

**NOTE:**  
For Memorial Garden layout and details, please refer to drawings and specification by Indigo Landscape Architect.

**NOTE:**  
Please refer to Landscape Architect drawings and details for details of proposed bund.

**NOTE:**  
Please refer to Landscape Architect drawings and details for details of proposed bund.

**NOTE:**  
Please refer to Landscape Architect drawings and details for details of proposed bund.

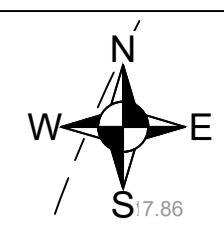

- NOTES**
1. This drawing to be read in conjunction with all relevant Architect's and Engineer's drawings and the Specifications.
  2. Do not scale this drawing.
  3. For paths and construction details to the Memorial Gardens, please refer to Indigo drawings and specification.
  4. The Contractor is to remain responsible for the temporary works and ensuring stability is maintained throughout the works.
  5. Note that the background level information is the topographical survey data of the existing site.
  6. All drainage to be kitemark certified and installed in accordance with the latest edition of 'Sewers for Adoption' and 'Design and Construction Guidance (DCG)'.
  7. For drainage schedules, please refer to Dwg. 402.02845.00055/50.

- LEGEND**
- Indicates proposed Foul Water drainage.
  - Indicates 'treated' Foul Water drainage.
  - Indicates proposed Surface Water drainage.
  - Indicates proposed French Drain.
  - Indicates land drainage.
  - Indicates landscaping drainage.

C1	SDE	SDE	NOV 22	Drainage moved lighter to paths. MG path background updated.
C0	SDE	SDE	NOV 22	CONSTRUCTION ISSUE: Southern land drain revised.
T2	DH	SDE	MAY 22	Revised Tender Scheme. TENDER ISSUE
T1	SDE	SDE	FEB 22	Brick Head Wall (South) consents added. Drainage updated.
T0	SDE	SDE	DEC 21	TENDER ISSUE
P0	DH	SDE	NOV 21	Initial Issue
Revision	By	Chk'd By	Date	Comments



**SLR**  
GREENWOOD HOUSE  
ROWDEN LANE  
BRADFORD-ON-AVON  
WILTS, BA15 2AU  
T: 01225 309400  
F: 01225 309401  
www.slrconsulting.com

Site:  
HERNE BAY CREMATORIUM  
BULLOCKSTONE ROAD, HERNE BAY, KENT

Project:  
HERNE BAY CREMATORIUM

Drawing Title:  
**MEMMORIAL GARDEN**

Scale:  
1:250 @ A1

Date:  
NOVEMBER 2021

Drawing Number:  
**402.02845.00055/50**

Revision:  
**C1**

CONSTRUCTION

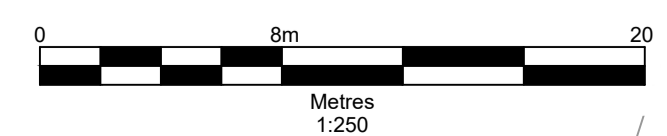

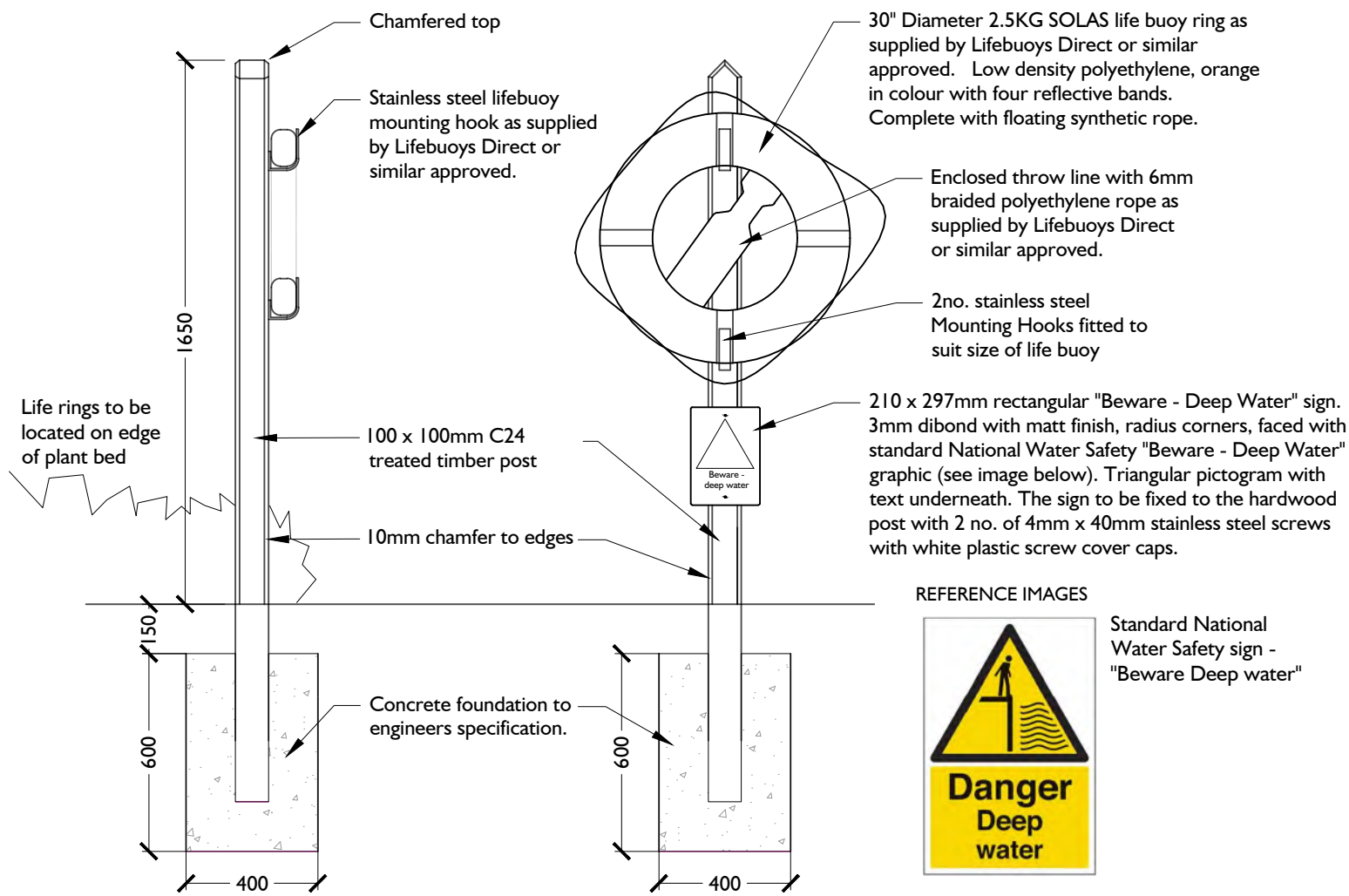

**NOTES**

- All timber to be UC4 treated C24 Grade.
- All timber to be finished to a fine sanded finish.
- All fixings to be stainless steel.
- Lifebuoy mounting hooks are to be fixed with 2 no. screws per bracket. Fixings to be pilot drilled.
- All fixings to be minimum 30mm from edges of timber.

**GENERAL NOTES:**

This drawing is to be read in conjunction with all other relevant disciplines drawings, schedules, specifications and supporting information. The contractor is to verify all dimensions and conditions on site. This drawing should not be scaled. Only figured dimensions are to be followed. Any discrepancies are to be reported to Indigo Landscape Architects Limited and resolution sought prior to proceeding. This drawing is subject to copyright.

A	Issued for construction	2022-10-27	TW	ZH
-	First issue	2022-05-25	ZH	ZH
rev	description	date	by	chk

project  
**HERNE BAY CREMATORIUM**

client  
**WESTERLEIGH GROUP LTD**

drawing title  
**LIFEBUOY DETAILS**

drawing number	revision	status	scale
<b>994-D-02</b>	<b>A</b>	<b>CONST</b>	<b>1:20@A3</b>

**SOFT LANDSCAPE KEY:**

- Existing woodland vegetation to be retained
- Proposed native scrub mix planting
- Proposed specimen trees
- Proposed large species memorial trees
- Proposed flowering memorial trees
- Proposed formal hedges
- Proposed mixed native hedges
- Proposed large shrub planting
- Proposed low shrub planting / groundcover
- Proposed managed grassland areas
- Proposed wet meadow areas
- Proposed amenity grass / lawn areas
- Proposed informal mown path
- Indicative memorial marker / ornamental grove grid

**HARD LANDSCAPE KEY:**

- Block paving to vehicular areas
- Block paving to pedestrian areas
- Gravel grid pavement to vehicular areas
- Self binding gravel footpath
- Tarmac
- Concrete
- Gravel surfacing (10-20mm: Grey)
- Decorative gravel surfacing (6-10mm: Buff)
- Decorative gravel surfacing (15-30mm: Golden Gravel)
- Gravel surfacing over land drains (30mm: Buff)
- Proposed seats / benches
- Timber post and rope swag arbor
- Proposed timber hit and miss fence
- Proposed timber post and rail fence
- Proposed timber post and wire fence
- Proposed lamp post
- Proposed bollard light
- Proposed lifebuoy
- Proposed memorial feature (Statue, fountain, sundial, bird bath etc)



Native scrub planting and flowering trees to be planted in gaps along cleared woodland edges

Attenuation basin with permanent pond integrated into the landscape as a feature

Covered floral tribute

Garden of reflection

Paving threshold / arrival space coordinated with internal finishes

Cycle parking

Hearse drive and waiting area

Dry attenuation basin integrated into the memorial garden

Formal memorial garden with rose arbor and shrub borders

Scattering garden with memorial trees

Bund along eastern boundary providing privacy

**NOTES**

- This drawing to be read in conjunction with all other relevant disciplines drawings, schedules, specifications and supporting information as required.
- Refer to 994-SW-01\_04 for planting plan
- Refer to 994-GW-01 for softworks soiling plan
- Refer to 994-GA-02 for landscape edges and surfaces plan
- Refer to 994-GA-03 for indicative landscape levels plan

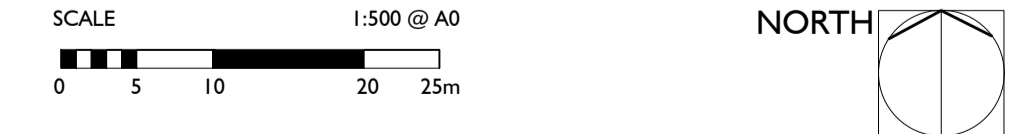

rev	description	date	by	chk.
I	Memorial garden land drainage adjusted	2022-11-08	TW	ZH
H	Land drain + car park surface revised	2022-11-03	TW	ZH
G	Issued for construction	2022-10-27	TW	ZH
F	VE Revisions	2022-08-23	ZH	ZH
E	Gravel specification updated	2022-06-08	ZH	ZH
D	Revised layout	2022-05-24	ZH	ZH
C	Bund / parking updated	2022-02-07	ZH	ZH
B	Updated layout	2021-12-07	LS	ZH
A	First issue	2021-11-29	LS	ZH





project: HERNE BAY CEMETERY  
client: WESTERLEIGH GROUP LTD.

drawing title: LANDSCAPE GENERAL ARRANGEMENT PLAN

drawing number	revision	status	scale
994-GA-01	I	CONST	1:500@A0

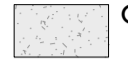

**SURFACES & EDGING KEY:**

-  Proposed block paving to vehicular areas  
Refer to Architect's drawing HNBO\_L/0/007
-  Proposed block paving to pedestrian areas  
Refer to Architect's drawing HNBO\_L/0/007
-  Proposed gravel grid to vehicular areas  
Refer to Engineer / Architect's drawings for details
-  Self binding gravel footpath by Smiths of Blechington or similar approved. Lay 50mm thick to form 50mm compacted depth over 150mm depth Type 1 subbase over geotextile membrane.  
Refer to Engineer's detail 402.02845.00055/26.
-  Tarmac surface to Engineer's specification and detail
-  Concrete surface to Engineer's specification and detail
-  50mm depth washed angular gravel (Size: 10-20mm / Colour: Grey) over 150mm type 1 base over geotextile membrane.
-  50mm depth washed decorative gravel (Size: 6-10mm / Colour: Buff) on geotextile membrane over lightly compacted / leveled soil / subsoil.
-  50mm depth golden gravel (Size: 15-30mm / Colour: Buff) on geotextile membrane over lightly compacted / leveled soil / subsoil.
-  100mm depth washed decorative gravel (Size: 30mm single size / Colour: Buff) over land drain per engineer's detail.
-  50mm settled depth ornamental bark mulch
-  Aluminum edging, eg Exced Edge AluExcel by Kinley systems or similar approved. Profile height: 100mm
-  25x150mm treated C24 timber board edging. Secure edging with 500x50x50mm treated C24 timber stakes with weathered top at max 1.5m centres, twice nailed to edge using 75mm ringbark nails. Edging fixed to inside (path side) of posts.
-  500mm height timber retaining wall with handrail, eg Woodscape Timber Retaining Wall System. Refer to 994-D-01 for general arrangement. Detailed design by Woodscape Ltd.
-  Proposed lifebuoy
-  Timber post and rope swing arbor. Refer to 994-D-02 for details.
-  1.8m height timber hit and miss fence (service yard) to Architect's specification
-  1.2m height timber post and 3-rail fence to Architect's specification
-  1.2m height timber post and 5-wire fence to Architect's specification

Note: All timber to be preservative treated Tanalith E class 4.0.



- NOTES**
- This drawing to be read in conjunction with all other relevant disciplines drawings, schedules, specifications and supporting information as required.
  - Refer to 994-GA-01 for general arrangement plan
  - Refer to 994-SW-01\_04 for planting plan
  - Refer to 994-GW-01 for softworks rolling plan
  - Refer to 994-TP-01 for tree protection and removals plan
  - Refer to 994-GA-03 for indicative landscape levels plan

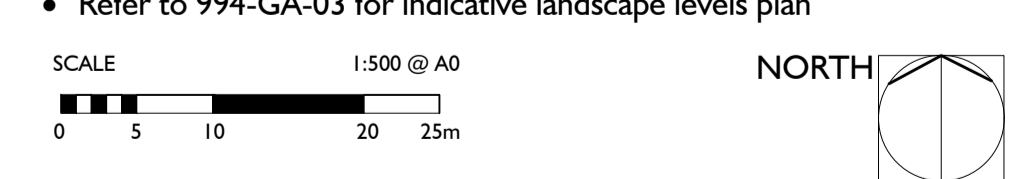

rev	description	date	by	chk.
H	Memorial garden land drainage adjusted	2022-11-08	TW	ZH
G	Land drain + car park surface revised	2022-11-03	TW	ZH
F	Issued for construction	2022-10-27	TW	ZH
E	VE Revisions	2022-08-33	ZH	ZH
D	Gravel specification updated	2022-06-08	ZH	ZH
C	Revised layout	2022-05-24	ZH	ZH
B	Bund / parking updated	2022-02-07	ZH	ZH
A	Updated layout	2021-12-07	LS	ZH

project: **HERNE BAY CEMETARIUM**  
 client: **WESTERLEIGH GROUP LTD.**  
 drawing title: **LANDSCAPE SURFACES AND EDGING PLAN**

drawing number	revision	status	scale
994-GA-02	H	CONST	1:500@A0

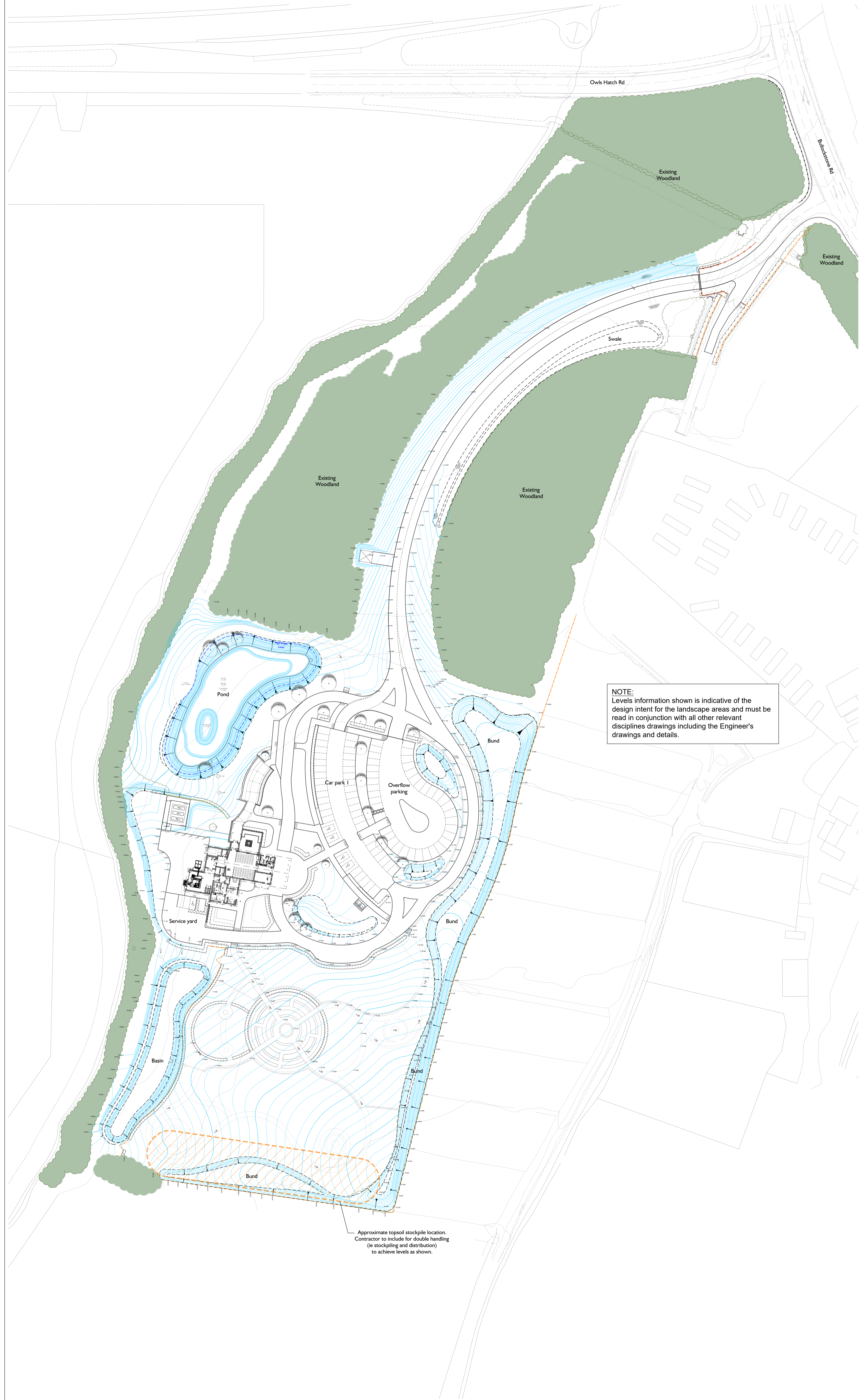

Approximate topsoil stockpile location.  
Contractor to include for double handling  
(ie stockpiling and distribution)  
to achieve levels as shown.

**NOTE:**  
Levels information shown is indicative of the design intent for the landscape areas and must be read in conjunction with all other relevant disciplines drawings including the Engineer's drawings and details.

The intention is to utilise suitable excess materials generated by the proposed groundworks to minimise the cut / fill differential. Refer to the Engineer's drawings and details for all roads, pavement, and attenuation basins (ie non-landscape areas).

- NOTES**
- This drawing to be read in conjunction with all other relevant disciplines drawings, schedules, specifications and supporting information as required.
  - Refer to 994-GA-01 for general arrangement plan
  - Refer to 994-SW-01\_04 for planting plan
  - Refer to 994-GW-01 for softworks soiling plan
  - Refer to 994-GA-02 for landscape edges and surfaces plan
  - Refer to 994-GA-03 for indicative landscape levels plan
  - Refer to 994-TP-01 for tree protection and removals plan

SCALE 1:500 @ A0

0 5 10 20 25m

NORTH

rev	description	date	by	chk.
I	Memorial garden land drainage adjusted	2022-11-08	TW	ZH
H	Land drain + car park surface revised	2022-11-03	TW	ZH
G	Issued for construction	2022-10-27	TW	ZH
F	VE Revisions	2022-08-23	ZH	ZH
E	Topsoil stockpile location	2022-06-08	ZH	ZH
D	Layout / levels updated	2022-05-25	ZH	ZH
C	Layout / levels updated	2022-05-24	ZH	ZH
B	Bund / parking / levels updated	2022-02-07	ZH	ZH
A	Updated layout	2021-12-07	LS	ZH

project  
**HERNE BAY CERMATORIUM**

client  
**WESTERLEIGH GROUP LTD.**

drawing title  
**INDICATIVE LANDSCAPE LEVELS**

drawing number	revision	status	scale
994-GA-03	I	CONST	1:500@A0

TOPSOILING DEPTHS / AMELIORATION

Key	Landscape area	Soil Type	Minimum Depth	Amelioration / Notes
	Tree pits	Site topsoil	600mm	Refer to Tree Pit Details
	Whip planting	Site topsoil	300mm	No fertiliser or additives
	Pond Area (typical)	Site topsoil	300mm	No fertiliser or additives
	Pond Area (deepened)	Site topsoil	600mm	- 50mm layer of PAS100 spread over topsoil - 70g/m <sup>2</sup> ICL Osmocote Pre-Plant Fertiliser incorporated into upper 300mm of topsoil.
	Ornamental planting/ memorial planting areas	Site topsoil	400mm	- 50mm layer of PAS100 spread over topsoil - 70g/m <sup>2</sup> ICL Osmocote Pre-Plant Fertiliser incorporated into upper 300mm of topsoil.
	Wildflower / meadow areas	Site topsoil	150mm	No fertiliser or additives
	High traffic Amenity grass / turf	Site topsoil	150mm	- 35g/m <sup>2</sup> ICL Sportsmaster Pre-Seed Fertiliser incorporated into upper 100mm of topsoil.

Soiling and planting specification

- Under existing trees / within tree root protection areas, except where minor regrading is noted, only the top 100mm of existing soil shall be prepared, by hand, to prevent damage to underlying roots. New plants, where specified, shall be carefully pit planted, to avoid any major roots.
- In new planting areas to be topsoiled, away from existing trees, underlying subsoil shall be broken up / ripped as required to provide adequate drainage. Rubble / excess kerb haunching shall be fully removed.
- Refer to the Soil Depth / Amelioration Table for requirements.
- In existing topsoiled areas, the depth of soil shall be checked to ensure minimum requirements noted above are achieved and existing vegetation shall be removed using a non-residual herbicide.
- Existing topsoil shall be reused from site where possible. A topsoil analysis test should be undertaken to assess the pH level, structural analysis and nutrient composition of the soil and to confirm that there are no harmful levels of toxins present. Topsoil shall be screened as required to remove debris and rocks over 10mm dia.
- Imported topsoil, if required, should be compatible in pH with existing soil on site and shall comply with BS3882: 2015 Multipurpose topsoil. A topsoil analysis certificate is required to indicate compliance with this specification.
- Topsoil shall be laid over prepared subsoil as noted.
- Topsoil shall be kept weed-free prior to spreading / planting by hand weeding or use of non-residual herbicides.
- Additional PAS 100 peat free organic matter shall be incorporated into the soil in ornamental planting areas at a ratio of 1 cubic metre per 20 cubic metres and thoroughly mixed in prior to planting.
- Organic fertilisers shall be incorporated as required in tree, ornamental planting and amenity grass areas per the topsoil analysis test to ensure there are sufficient plant nutrients within the soil. Do NOT fertilise wildflower / meadow seeded areas.

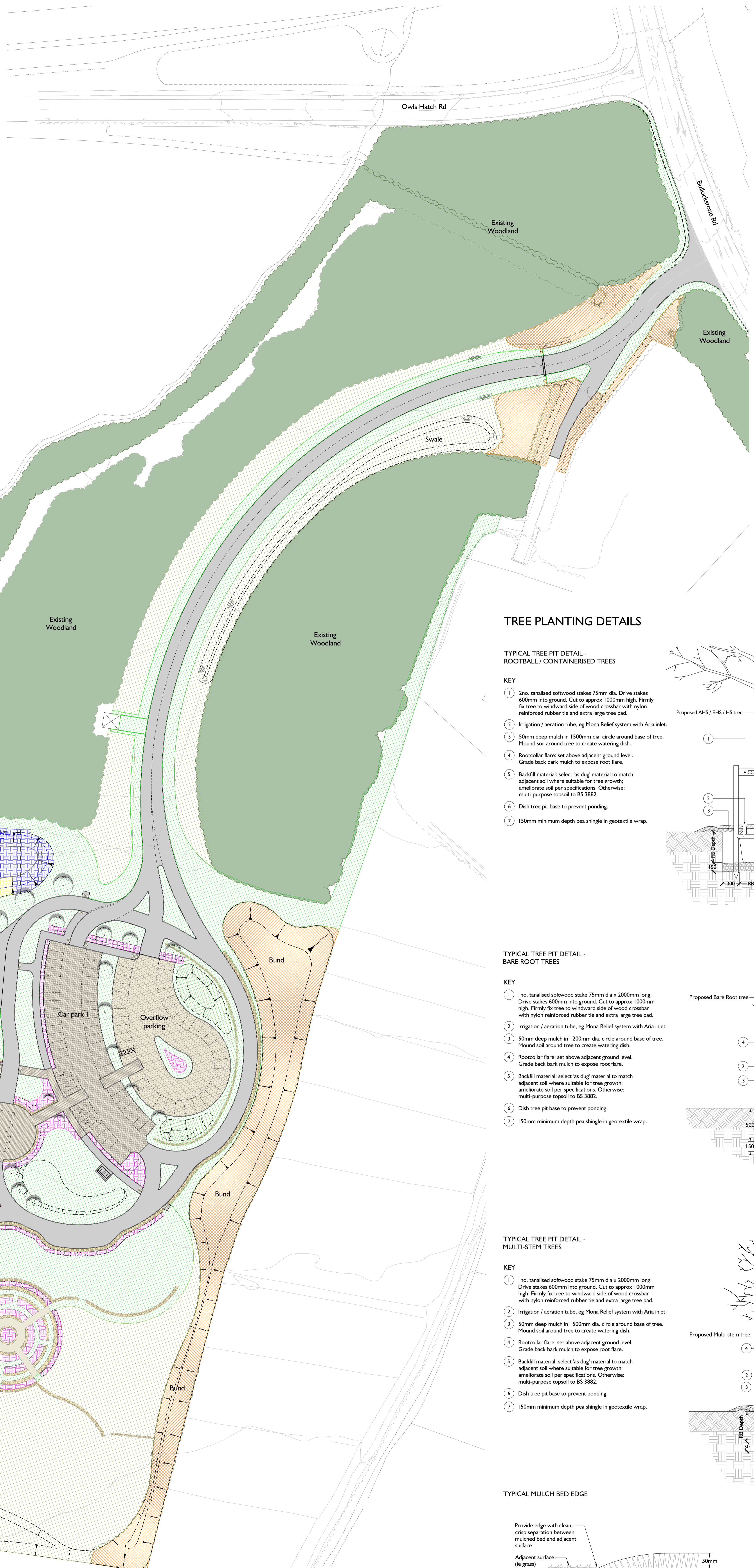

TREE PLANTING DETAILS

TYPICAL TREE PIT DETAIL - ROOTBALL / CONTAINERISED TREES

- KEY
- 2no. tanalised softwood stakes 75mm dia. Drive stakes 600mm into ground. Cut to approx 1000mm high. Firmly fix tree to windward side of wood crossbar with nylon reinforced rubber tie and extra large tree pad.
  - Irrigation / aeration tube, eg Mona Relief system with Aria inlet.
  - 50mm deep mulch in 1500mm dia. circle around base of tree. Mound soil around tree to create watering dish.
  - Rootcollar flare: set above adjacent ground level. Grade back bark mulch to expose root flare.
  - Backfill material: select 'as dug' material to match adjacent soil where suitable for tree growth; ameliorate soil per specifications. Otherwise: multi-purpose topsoil to BS 3882.
  - Dish tree pit base to prevent ponding.
  - 150mm minimum depth pea shingle in geotextile wrap.

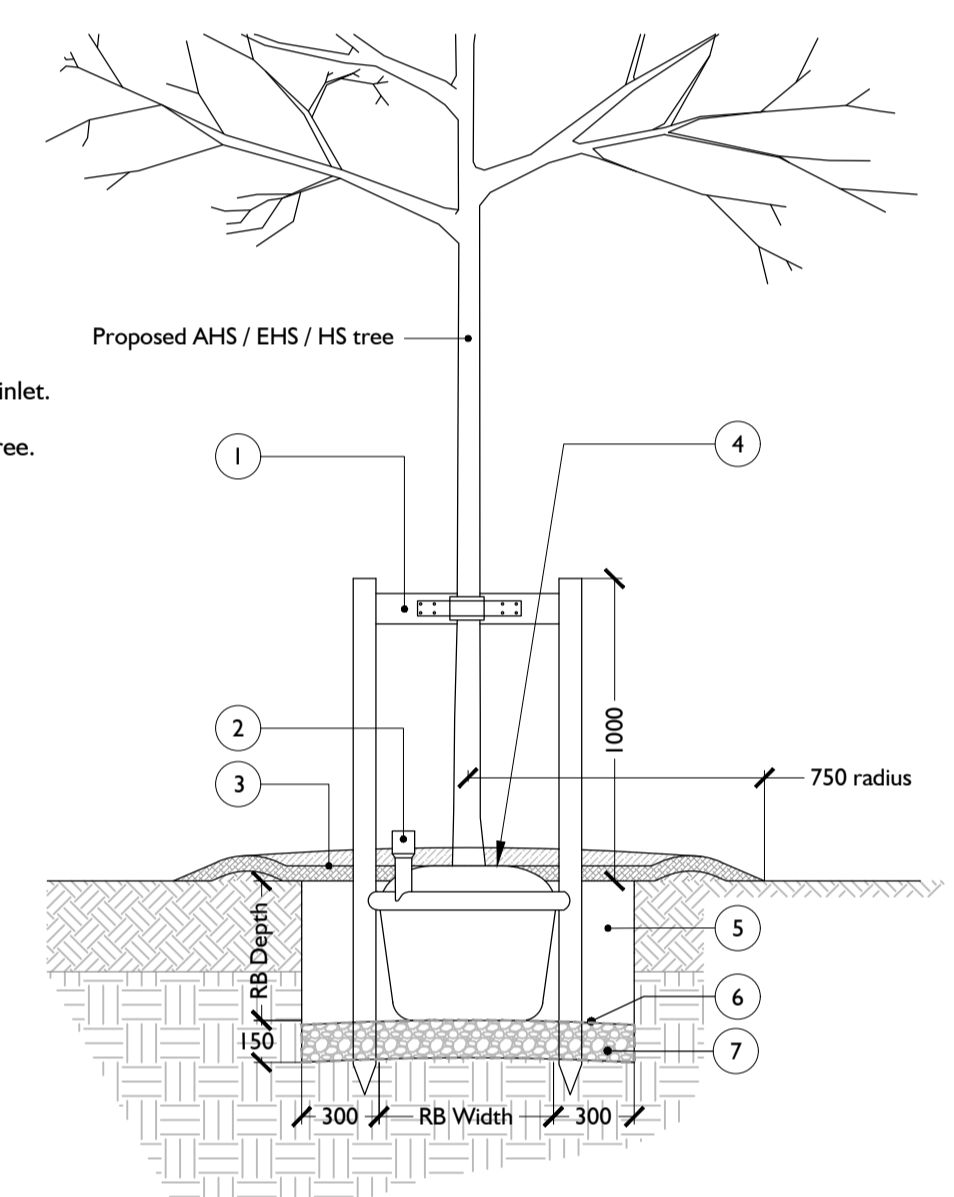

TYPICAL TREE PIT DETAIL - BARE ROOT TREES

- KEY
- 1no. tanalised softwood stake 75mm dia x 2000mm long. Drive stakes 600mm into ground. Cut to approx 1000mm high. Firmly fix tree to windward side of wood crossbar with nylon reinforced rubber tie and extra large tree pad.
  - Irrigation / aeration tube, eg Mona Relief system with Aria inlet.
  - 50mm deep mulch in 1200mm dia. circle around base of tree. Mound soil around tree to create watering dish.
  - Rootcollar flare: set above adjacent ground level. Grade back bark mulch to expose root flare.
  - Backfill material: select 'as dug' material to match adjacent soil where suitable for tree growth; ameliorate soil per specifications. Otherwise: multi-purpose topsoil to BS 3882.
  - Dish tree pit base to prevent ponding.
  - 150mm minimum depth pea shingle in geotextile wrap.

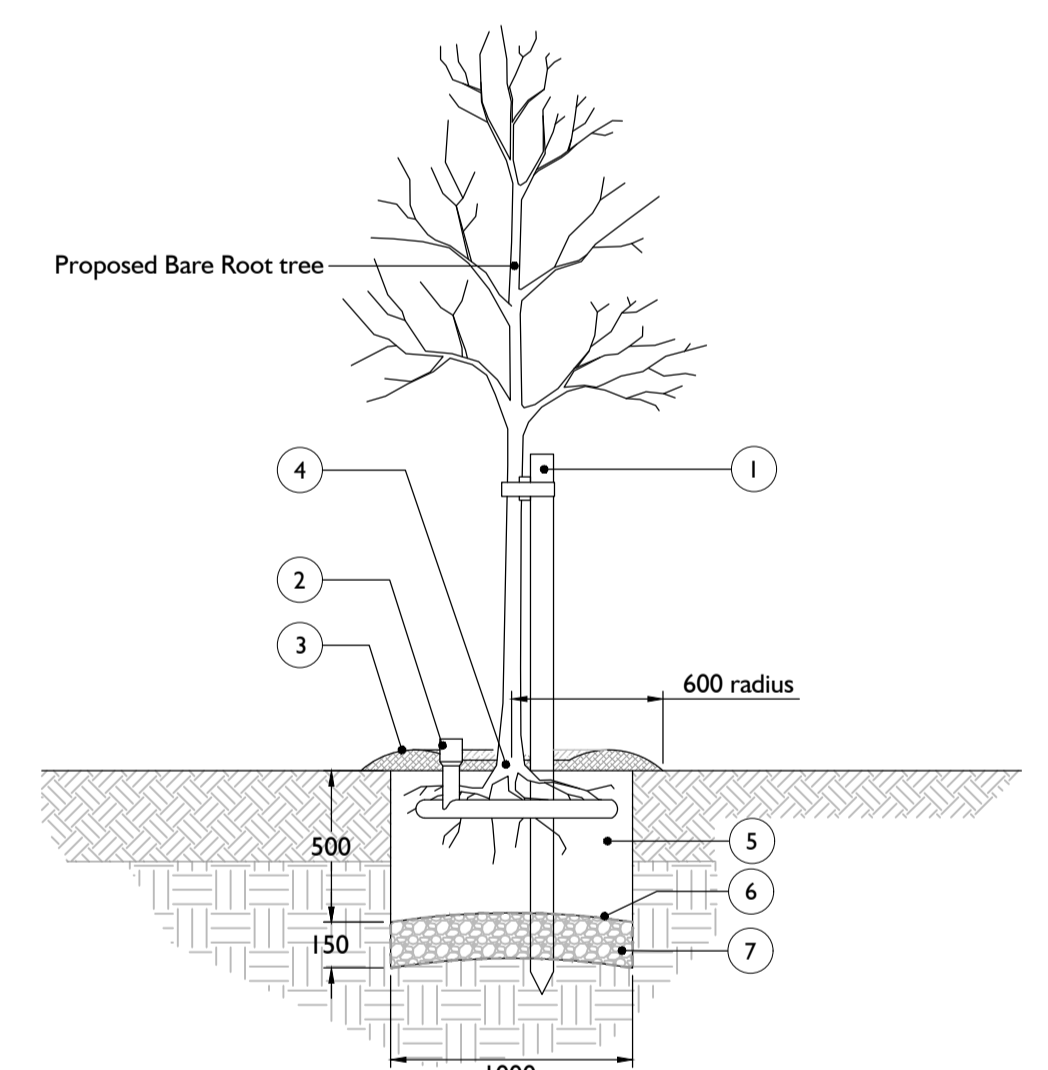

TYPICAL TREE PIT DETAIL - MULTI-STEM TREES

- KEY
- 1no. tanalised softwood stake 75mm dia x 2000mm long. Drive stakes 600mm into ground. Cut to approx 1000mm high. Firmly fix tree to windward side of wood crossbar with nylon reinforced rubber tie and extra large tree pad.
  - Irrigation / aeration tube, eg Mona Relief system with Aria inlet.
  - 50mm deep mulch in 1500mm dia. circle around base of tree. Mound soil around tree to create watering dish.
  - Rootcollar flare: set above adjacent ground level. Grade back bark mulch to expose root flare.
  - Backfill material: select 'as dug' material to match adjacent soil where suitable for tree growth; ameliorate soil per specifications. Otherwise: multi-purpose topsoil to BS 3882.
  - Dish tree pit base to prevent ponding.
  - 150mm minimum depth pea shingle in geotextile wrap.

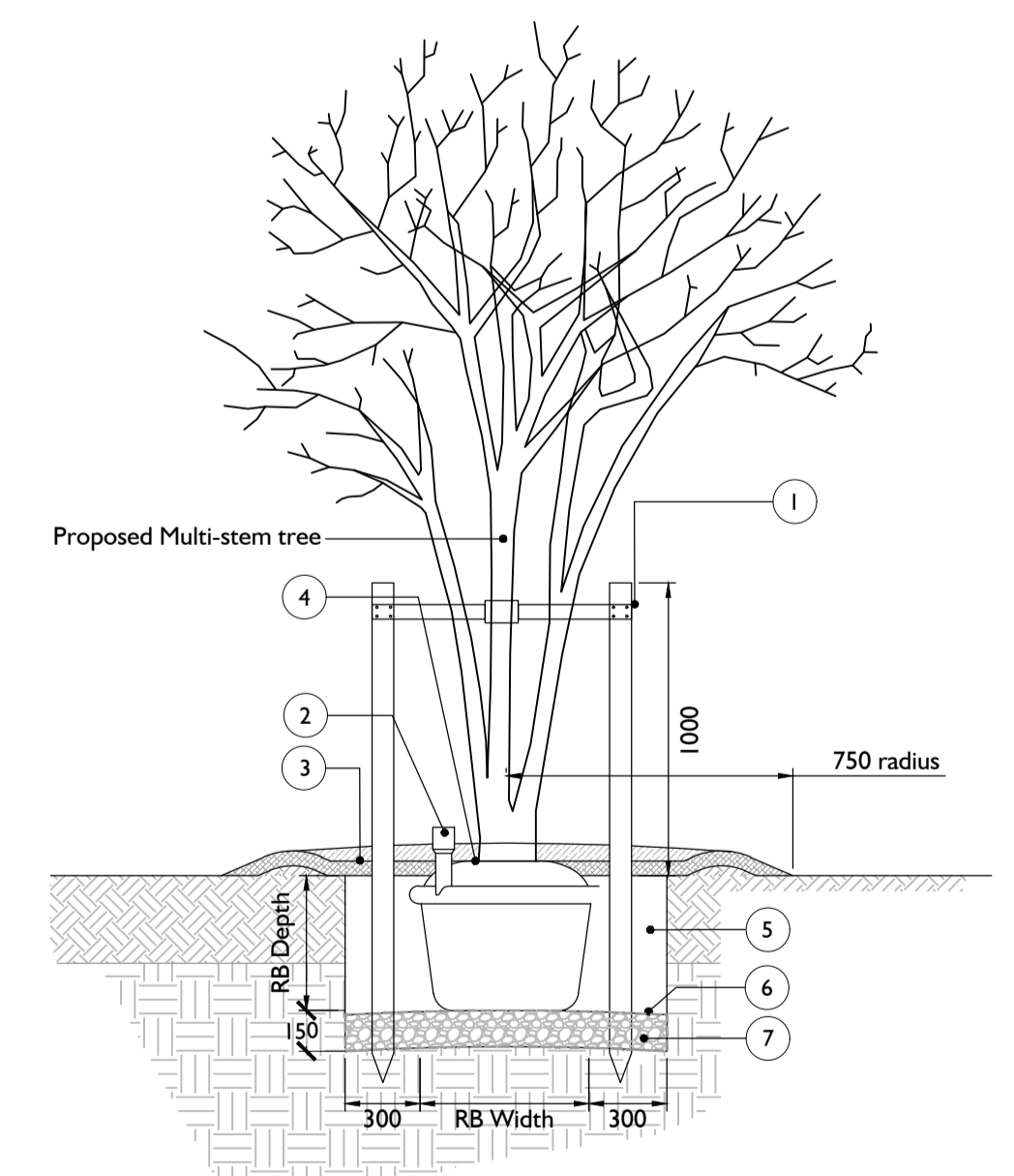

TYPICAL MULCH BED EDGE

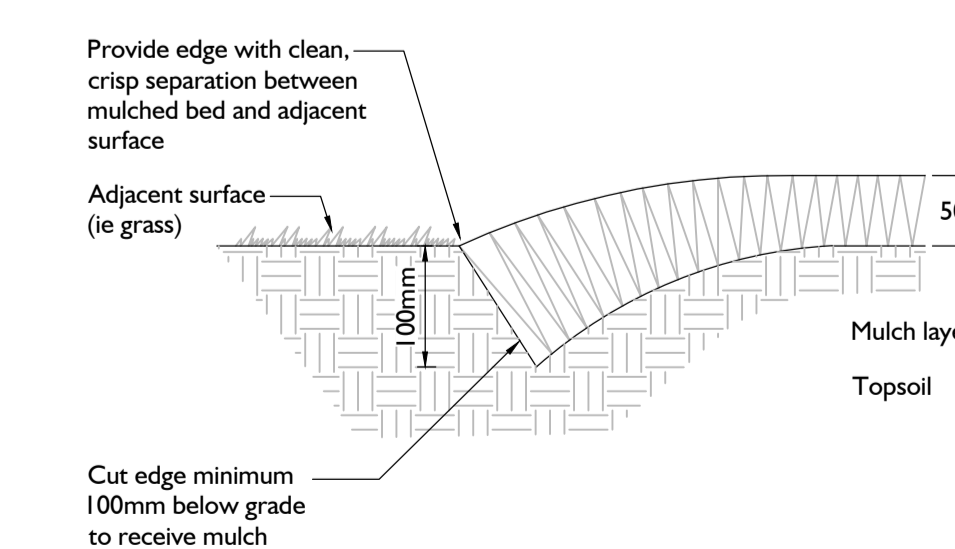

NOTES

- This drawing to be read in conjunction with all other relevant disciplines drawings, schedules, specifications and supporting information as required.
- Refer to 994-SW-01\_04 for planting plan
- Refer to 994-GA-01 for general arrangement plan
- Refer to 994-GA-02 for landscape edges and surfaces plan
- Refer to 994-GA-03 for indicative landscape levels plan
- Refer to 994-TP-01 for tree protection and removals plan

SCALE 1:500 @ A0

rev	description	date	by	chk.
G	Memorial garden land drainage adjusted	2022-11-08	TW	ZH
F	Land drain = car park surface revised	2022-11-03	TW	ZH
E	Issued for construction	2022-10-27	TW	ZH
D	VE Revisions	2022-08-23	ZH	ZH
C	Gravel specification	2022-06-08	ZH	ZH
B	Revised layout	2022-05-24	LS	ZH
A	First issue	2022-02-10	ZH	ZH

project HERNE BAY CEMETORNIUM

client WESTERLEIGH GROUP LTD.

drawing title SOFTWARES SOILING PLAN

drawing number	revision	status	scale
994-GW-01	G	CONST	1:500@A0