





## Boundary Treatments

Legend	
	1. Panelled Fencing (6ft)
	2. Farm Hedge - Native mix species
	3. Post and Wire Fencing
	4. Wicket Fence (1.2m)

### 1. Wooden Panelled Fencing (6ft)



Wooden panels supported by vertical concrete posts with concrete kicker boards (not shown)

### 2. Farm Hedge - Native mix species



### 3. Post and Wire Fencing



### 4. Wicket Fence (1.2m)

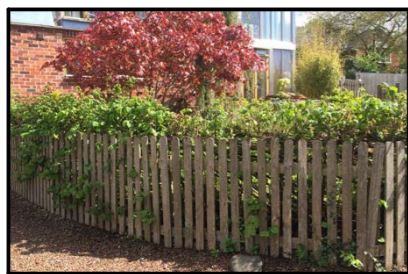

## Landscaping Scheme for Plots 1 & 2 only



### Native Hedgerow

A native hedgerow is proposed to the boundary (as indicated) in order to maintain privacy and create a natural screen of planting to soften any impact of the development. The hedgerow will contain native species to Shropshire as per the planting schedule below:

Species	Common	%	Size
Crataegus monogyna	Hawthorn	35%	60-90cm
Acer campestre	Field maple	20%	60-90cm
Prunus spinosa	Blackthorn	15%	60-90cm
Corylus avellana	Hazel	15%	60-90cm
Rosa canina	Dog rose	5%	60-90cm
Cornus sanguinea	Dogwood	5%	60-90cm
Viburnum opulus	Guelder rose	5%	60-90cm

Approximately 220m of hedgerow to be planted in a staggered row with 440mm between plants and 250mm between rows. Base of hedge to be finished with 75mm chipped bark to control weeds and allow establishment



### Drought Resistant Planting Areas

Area to be established with naturally adapted species that have developed resilience and drought tolerance. The areas should have well drained soil and have good sunshine exposure throughout the day.

Suggest species mix as below :

AMARINE ('Anastasia'), BALOTA pseudodictamnus, GAURA ('Rosy Shimmers'), HYLOTELEPHIUM ('Matrona'), IBERIS semper virens, IPHEION ('Alberto Castillo'), YCHNIS coronaria ('Gardeners World'), MORINA longifolia, PEROVSKIA ('Blue Spire'), PULSATILA vulgaris ('Rode Kloke'), STIPA tenuissima, TEUCRIUM x lucidrys, VERBASCUM ('Chantilly')

Areas to be planted are to be graded to bring to a uniform and even grade at the correct finished level and to remove all major hollows and ridges. All stones and debris greater than 50mm in size to be removed and disposed of off-site. Planted areas are to consist of min. 150mm topsoil

The area must be planted at a time recommended by the suppliers and regularly tended/watered to ensure good establishment. All areas to be well maintained and to ensure good weed control.



### Existing Tree Protection

All construction operations must be in accordance with the relevant guidelines. Protective tree fencing to be erected prior to all construction operations on site. Protective fencing must be in accordance with BS5837 as specified and approved before construction begins. Any damage to fencing must be reported immediately. All persons on site must be made aware of the Code of practice for the protection of trees and there must be strictly no access to the protection tree zone unless approved.



### Tree Planting

Trees planted in locations shown to provide additional screening and soften the development appearance.

Species	Common Name	Size (Girth)
Quercus ilex	Holm Oak	12-14cm

Trees to be planted as per standard specifications. Trees to be double staked in a minimum 2m<sup>3</sup> tree pit with tree root barrier membrane near service routes or paving where required.

### Tree planting procedures

Break up bottom of tree pit to a depth of 200mm and ensure ground is free-draining. Loosen edges of the tree pit at time of planting by hand, using a fork to ensure good drainage. Pits should be excavated no greater than 48hrs prior to planting and dewatered as required. Incorporated a soil conditioner/ameliorate in the form of peat-free and shrub compost or well rotted spend mushroom compost into back fill material at a rate of min 40l per pit

### General Planting Notes

All handling of plants must be in accordance with the HTA "Handling and establishing landscape plants" Part 1, Part 1 and Part 3 (obtainable from the Horticultural Trades Association) and the CPSE publication : Plant Handling".

Plants must be supplied at the same size and species as specified in the planting schedule on this landscape master plan. Any proposed replacements species or deviation from the proposed schedule should be highlighted and agree prior to installation.

The work must be carried out while soil and weather conditions are suitable. Planting is not to take place during periods of strong winds, frost, droughts or when the ground is waterlogged.

All Plants are to be watered thoroughly before the planting stage to ensure the rootball is thoroughly soaked prior to final backfilling.

Any topsoil retained on site in stockpiles for use in planting works is to be stored in heaps not greater than 1.2m in height and to be kept weed free at all times. Any proprietary herbicide to any perennial weeds and allow a period of time recommended by the manufacturer to elapse before disturbing and re-using elsewhere on site. Do NOT use peat or peat based products.

### Timing

All planting stated on this scheme to be completed within 2 years of first occupancy and plants health and growth monitored on a regular basis thereafter.

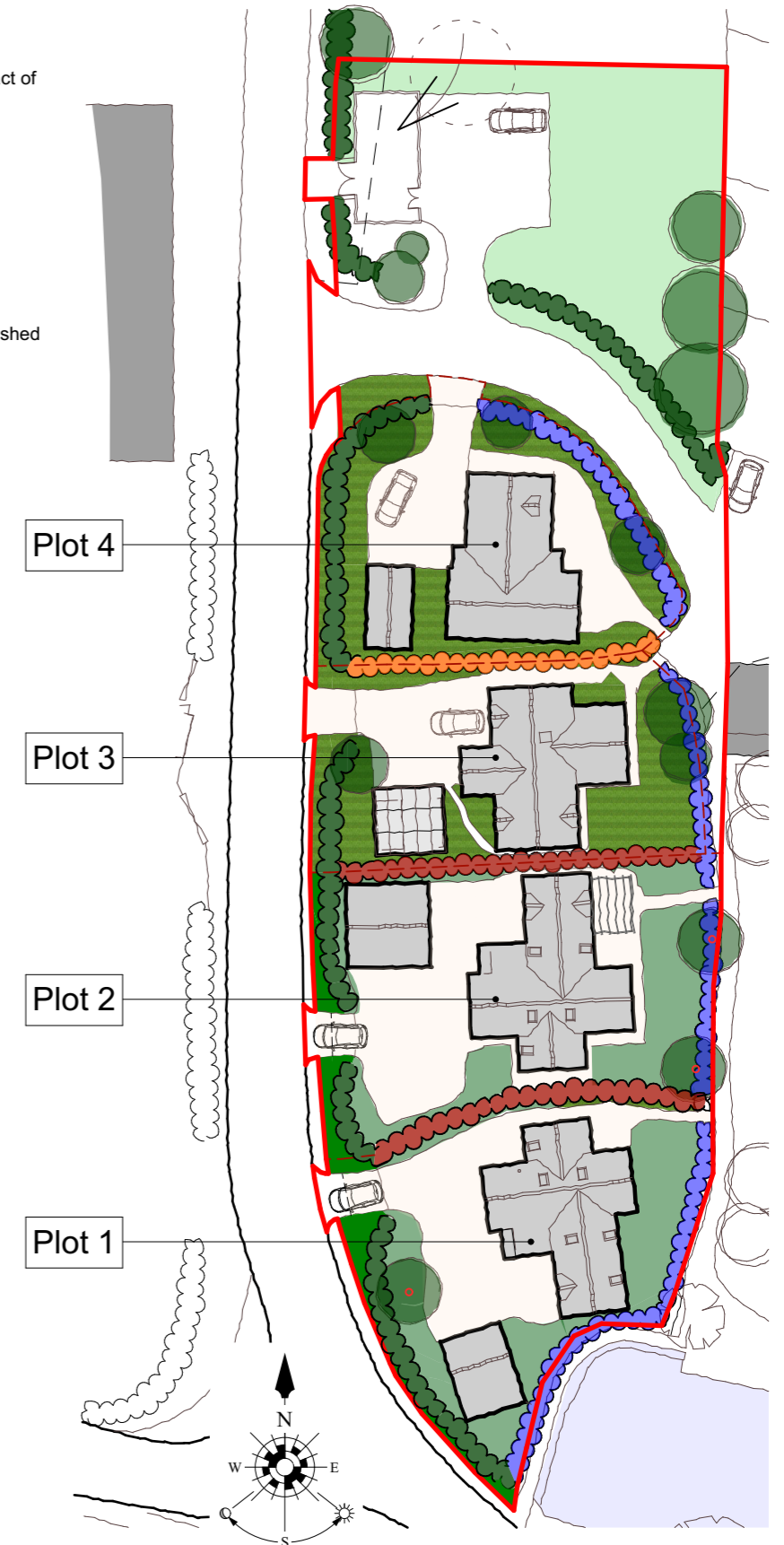

Planning Reference : 23/02534/VAR

# Landscaping and Boundary Treatments

Dimensions given on this drawing are to be verified on site, and any discrepancy reported to the architect. This drawing is the property of Steady St8 Design Services who reserves the copyright. This drawing is issued on the understanding that it shall not be copied, reproduced, retained or disclosed to any unauthorised person, wholly or in part without the written consent of Steady St8 Design Services.  
DO NOT SCALE FROM THIS DRAWING!  
(c) 2023 Steady St8 Design Services

A3

**Steady St8 Design Services**  
Mullens Chase  
Brinsop  
Hereford, HR4 7AT  
Tel : (07879) 880758  
Email : info@steadyst8ds.co.uk  
Web : www.steadyst8ds.co.uk

All dimensions are in mm unless otherwise stated

- Survey or Site Information
- Concept Design
- Developed Design
- Tender Drawing
- Contract Drawing
- Construction Issue

**Project Address**  
Proposed development at,  
The Wintles,  
Bishops Castle,  
SY9 5ES

**Project Details**  
Mr & Mrs O'Neill,  
Proposed development at  
The Wintles, Bishops  
Castle

**Scale**  
1:500

**Drawn**  
EGT

**Drawing Number**

1021•08.2

**Date :**  
23/08/2023

**Steady St8 Design Services**



Architectural Design Services