

ALL DIMENSIONS ARE IN mm UNLESS NOTED OTHERWISE

N.G.R E: 342701 N: 164002

DIRECTIONS TO SITE:  
 HEAD SOUTHWEST ON M5 TOWARD JUNCTION 21. AT JUNCTION 21, TAKE THE A370 EXIT TO WESTON-S-MARE. AT THE ROUNDABOUT, TAKE THE 1ST EXIT ONTO A370 SITE IS ON THE LEFT AFTER 3.6M BEFORE REACHING CONGRESBURY.

NOTES:

REV	MODIFICATION	BY	CH	DATE
A	Issued for Construction	NTA	SAH	28.03.23



Cell Name	WESTON ROAD	Opt:	A
Cell ID No			
CORNERSTONE	VF	VMO2	
12571221	87569_7	011734	

Site Address / Contact Details  
 WESTON ROAD  
 CONGRESBURY  
 NORTH SOMERSET  
 BS49 5EB

Drawing Title:	SITE LOCATION MAPS	Dwg Rev:	
Purpose of issue:	CONSTRUCTION		
Drawing Number:	100		
Surveyed By:	MA	Original Sheet Size:	A3
Drawn:	NTA	Date:	28.03.23
		Checked:	SAH
		Date:	28.03.23
		Issue:	B

SITE LOCATION

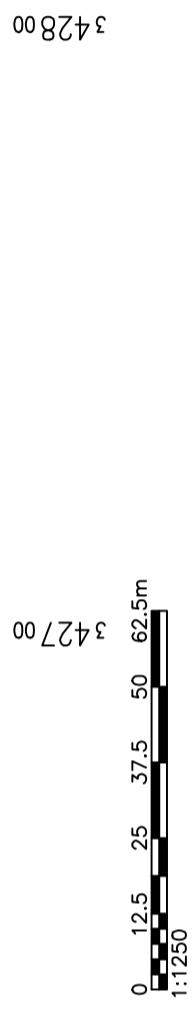
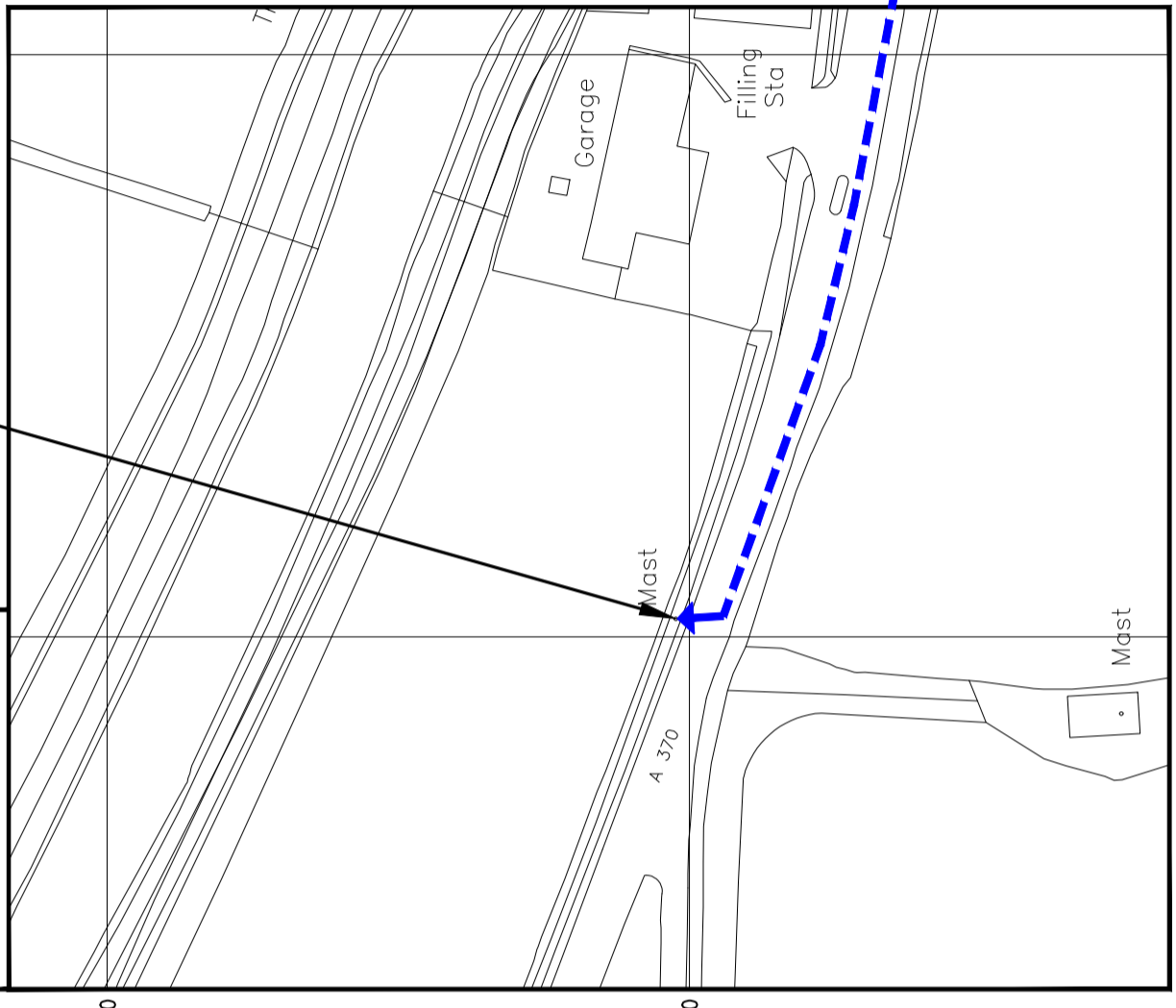
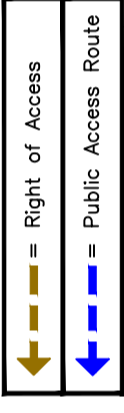

DETAILED SITE LOCATION

(Scale 1:1250)

Based upon Ordnance Survey map extract with the permission of the Controller of Her Majesty's Stationary Office. Crown copyright. Licence No. 100020449

SITE LOCATION

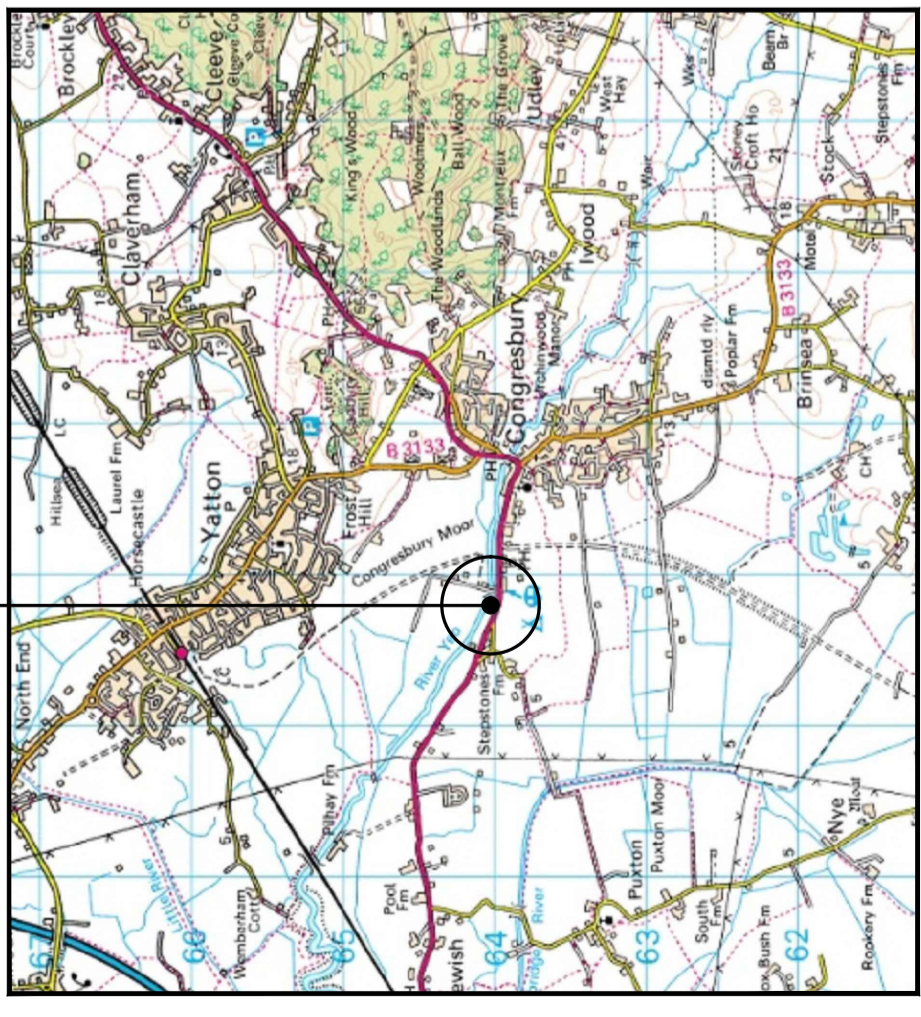

SITE LOCATION

(Scale 1:50000)

Ordnance Survey map extract based upon Landranger map series with the permission of the controller of Her Majesty's Stationary Office. Licence No. 100020449. Crown copyright.



SITE PHOTOGRAPH

The drawings comply with VMO2 & VF Standard ICNIRP guidelines under configuration VM7F. Designed in accordance with Cornerstone documents: SDN009 v6.0

ALL DIMENSIONS ARE IN mm UNLESS NOTED OTHERWISE  
 N.C.R E: 342701 N: 164002

NOTES:

REV	MODIFICATION	BY	CH	DATE
A	Issued for Construction	NTA	SAH	28.03.23



Cell Name	Opt.
WESTON ROAD	A

Cell ID No	VF	VMO2
12571221	87569_7	011734

Site Address / Contact Details  
 WESTON ROAD  
 CONGRESBURY  
 NORTH SOMERSET  
 BS49 5EB

Drawing Title:	EXISTING SITE PLAN
Dwg Rev:	A

Purpose of Issue:	CONSTRUCTION
Drawing Number:	200

Surveyed By:	MA	Original Sheet Size:	A3
Drawn:	NTA	Date:	28.03.23
		Checked:	SAH
		Date:	28.03.23
		Pack Issue:	B

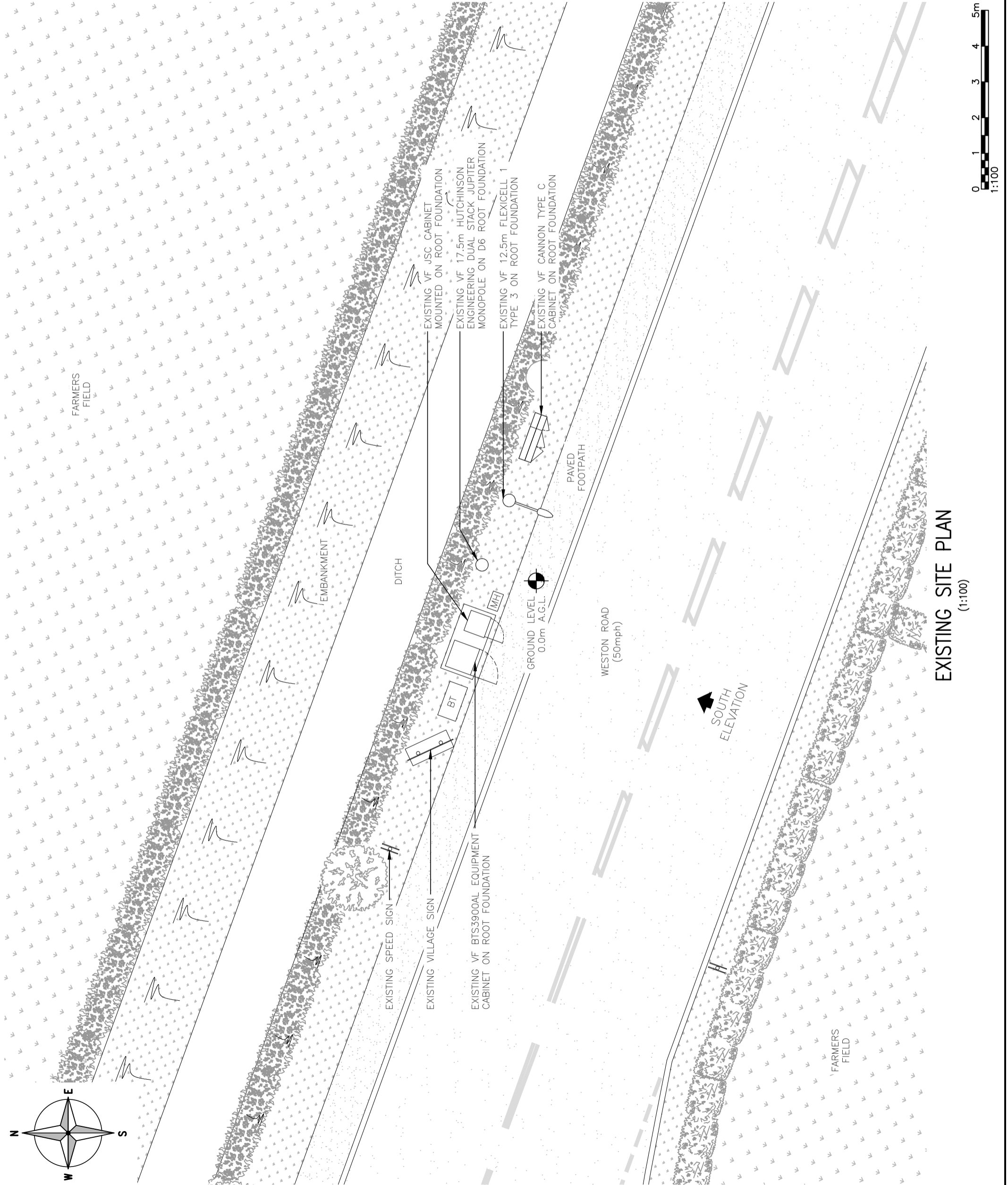

EXISTING SITE PLAN  
 (1:100)

ALL DIMENSIONS ARE IN mm UNLESS NOTED OTHERWISE

N.C.R E: 342701 N: 164002

NOTES:

REV	MODIFICATION	BY	CH	DATE
B	L26 & NR34 Added	NTA	SAH	22.05.23
A	Issued for Construction	NTA	SAH	28.03.23



**GallifordTry**  
 WOLVEY - HINCKLEY - LEICESTERSHIRE - LE10 3JF  
 Tel: +44 (0)1455 222792 Fax: +44 (0)1455 222758



Cell Name	Opt.
WESTON ROAD	A

Cell ID No	VMO2
12571221	87569_7
	011734

Site Address / Contact Details  
 WESTON ROAD  
 CONGRESSBURY  
 NORTH SOMERSET  
 BS49 5EB

Drawing Title:	PROPOSED SITE PLAN
Purpose of issue:	CONSTRUCTION
Drawing Number:	201

Surveyed By:	MA	Original Sheet Size:	A3	Pack Issue:	B
Drawn:	NTA	Date:	28.03.23	Checked:	SAH
		Date:	28.03.23		

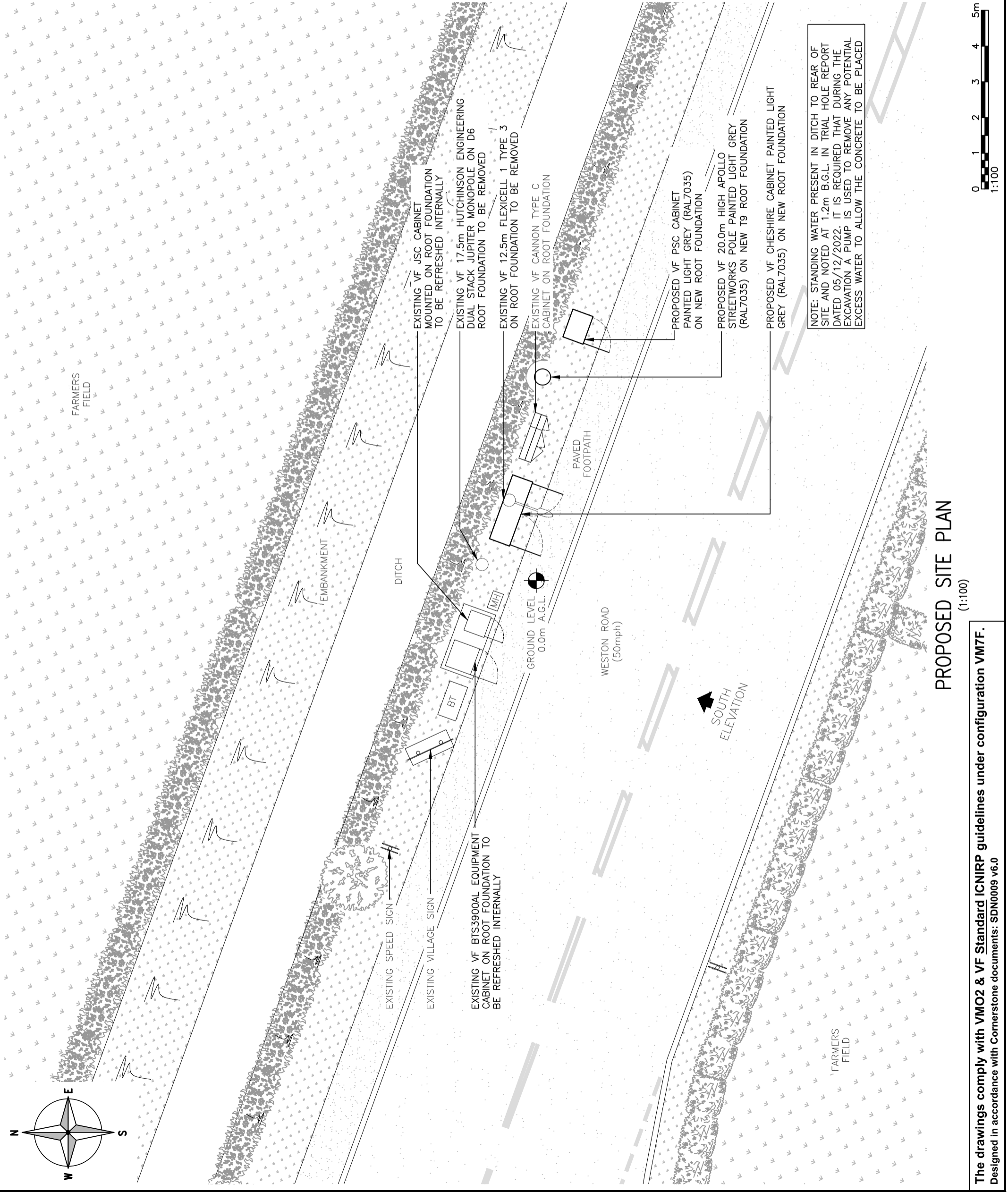

NOTE: STANDING WATER PRESENT IN DITCH TO REAR OF SITE AND NOTED AT 1.2m B.G.L. IN TRIAL HOLE REPORT DATED 05/12/2022. IT IS REQUIRED THAT DURING THE EXCAVATION A PUMP IS USED TO REMOVE ANY POTENTIAL EXCESS WATER TO ALLOW THE CONCRETE TO BE PLACED

**PROPOSED SITE PLAN**  
 (1:100)

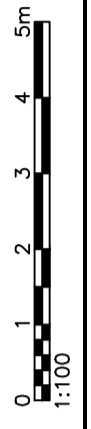

The drawings comply with VMO2 & VF Standard ICNIRP guidelines under configuration VM7F.  
 Designed in accordance with Cornerstone documents: SDN0009 v6.0



ALL DIMENSIONS ARE IN mm UNLESS NOTED OTHERWISE

N.C.R E: 342701 N: 164002

NOTES:

PROPOSED VF GPS MODULE MOUNTED TO TOP OF POLE

PROPOSED VF 3No. ANTENNAS MOUNTED TO UPPER SPINE OF SW POLE

TOP OF PROPOSED VF 3No. ANTENNAS +17.36m AGL

U/S OF PROPOSED VF 3No. ANTENNAS +16.36m AGL

PROPOSED VF 3No. ANTENNAS MOUNTED TO LOWER SPINE OF SW POLE

TOP OF PROPOSED POLE +20.00m AGL

TOP OF PROPOSED VF 3No. ANTENNAS +19.75m AGL

U/S OF PROPOSED VF 3No. ANTENNAS +17.65m AGL

PROPOSED VF 20.0m HIGH APOLLO STREETWORKS POLE PAINTED LIGHT GREY (RAL7035) ON NEW T9 ROOT FOUNDATION

PROPOSED LAMP ARM TO BE INSTALLED AT SAME HEIGHT AS EXISTING

EXISTING VF CANNON TYPE C CABINET ON ROOT FOUNDATION

PROPOSED VF CHESHIRE CABINET PAINTED LIGHT GREY (RAL7035) ON NEW ROOT FOUNDATION

EXISTING VF JSC CABINET MOUNTED ON ROOT FOUNDATION TO BE REFRESHED INTERNALLY

EXISTING VF BTS3900AL EQUIPMENT CABINET ON ROOT FOUNDATION TO BE REFRESHED INTERNALLY

EXISTING VILLAGE SIGN

EXISTING SPEED SIGN

PROPOSED VF PSC CABINET PAINTED LIGHT GREY (RAL7035) ON NEW ROOT FOUNDATION

NOTE: STANDING WATER PRESENT IN DITCH TO REAR OF SITE AND NOTED AT 1.2m B.G.L. IN TRIAL HOLE REPORT DATED 05/12/2022. IT IS REQUIRED THAT DURING THE EXCAVATION A PUMP IS USED TO REMOVE ANY POTENTIAL EXCESS WATER TO ALLOW THE CONCRETE TO BE PLACED

**PROPOSED SOUTH ELEVATION**  
(1:100)

The drawings comply with VMO2 & VF Standard ICNIRP guidelines under configuration VM7F.  
Designed in accordance with Cornerstone documents: SDN0009 v6.0

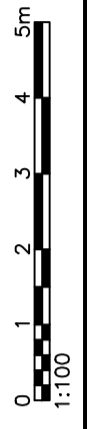

REV	MODIFICATION	BY	CH	DATE
B	L26 & NR34 Added	NTA	SAH	22.05.23
A	Issued for Construction	NTA	SAH	28.03.23



Cell Name	WESTON ROAD
Opt.	A

Cell ID No	
CORNERSTONE VF	VMO2
12571221	87569_7 011734

Site Address / Contact Details  
WESTON ROAD  
CONGRESBURY  
NORTH SOMERSET  
BS49 5EB

Drawing Title:	PROPOSED SITE ELEVATION
Purpose of Issue:	CONSTRUCTION
Drawing Number:	301
Dwg Rev:	B
Surveyed By:	MA
Original Sheet Size:	A3
Date:	28.03.23
Checked:	SAH
Date:	28.03.23
Drawn:	NTA
Pack Issue:	B