

SITE ACCESS WIDTHS

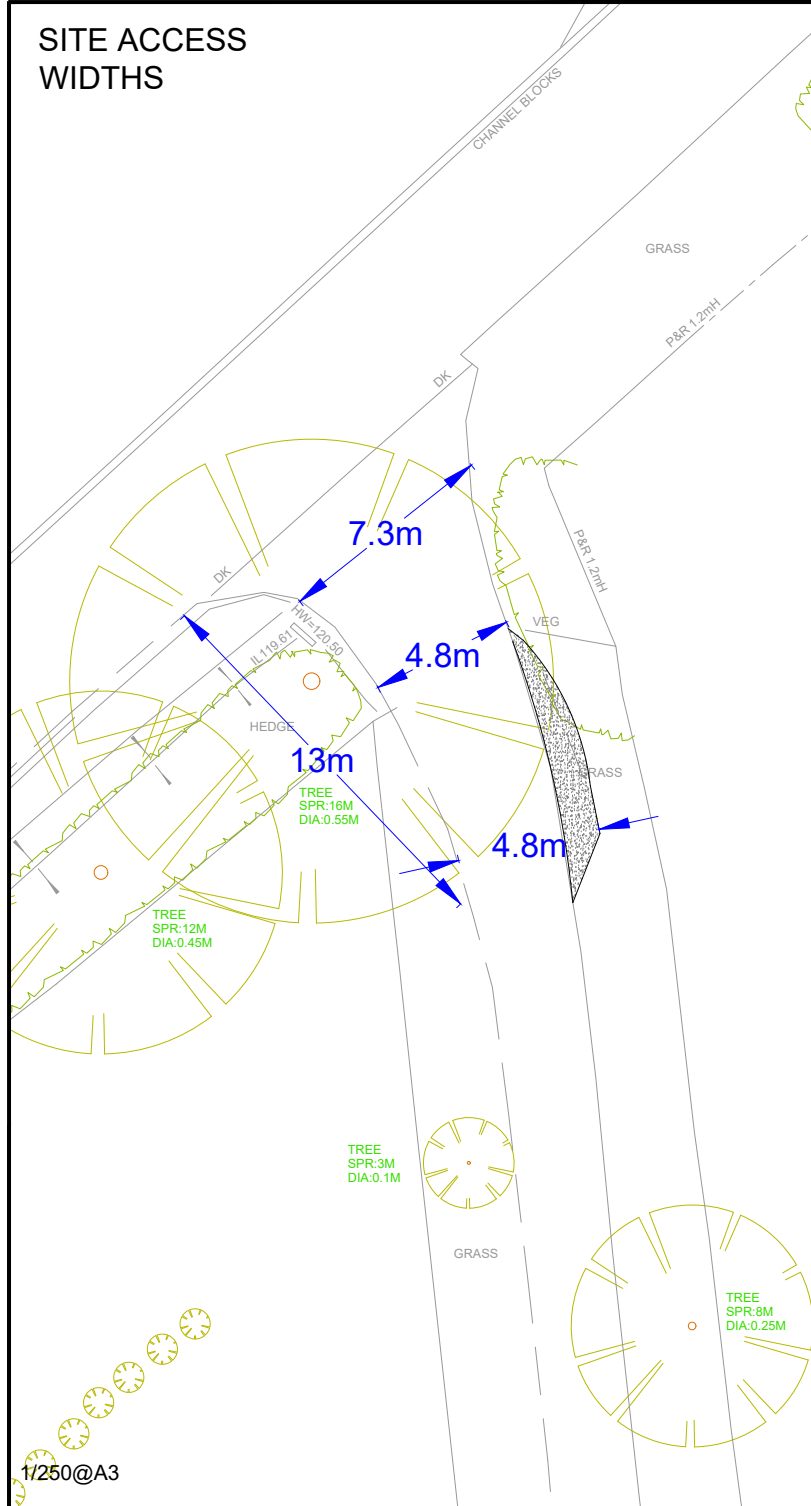

1/250@A3

PROPOSED PASSING BAY WIDTHS

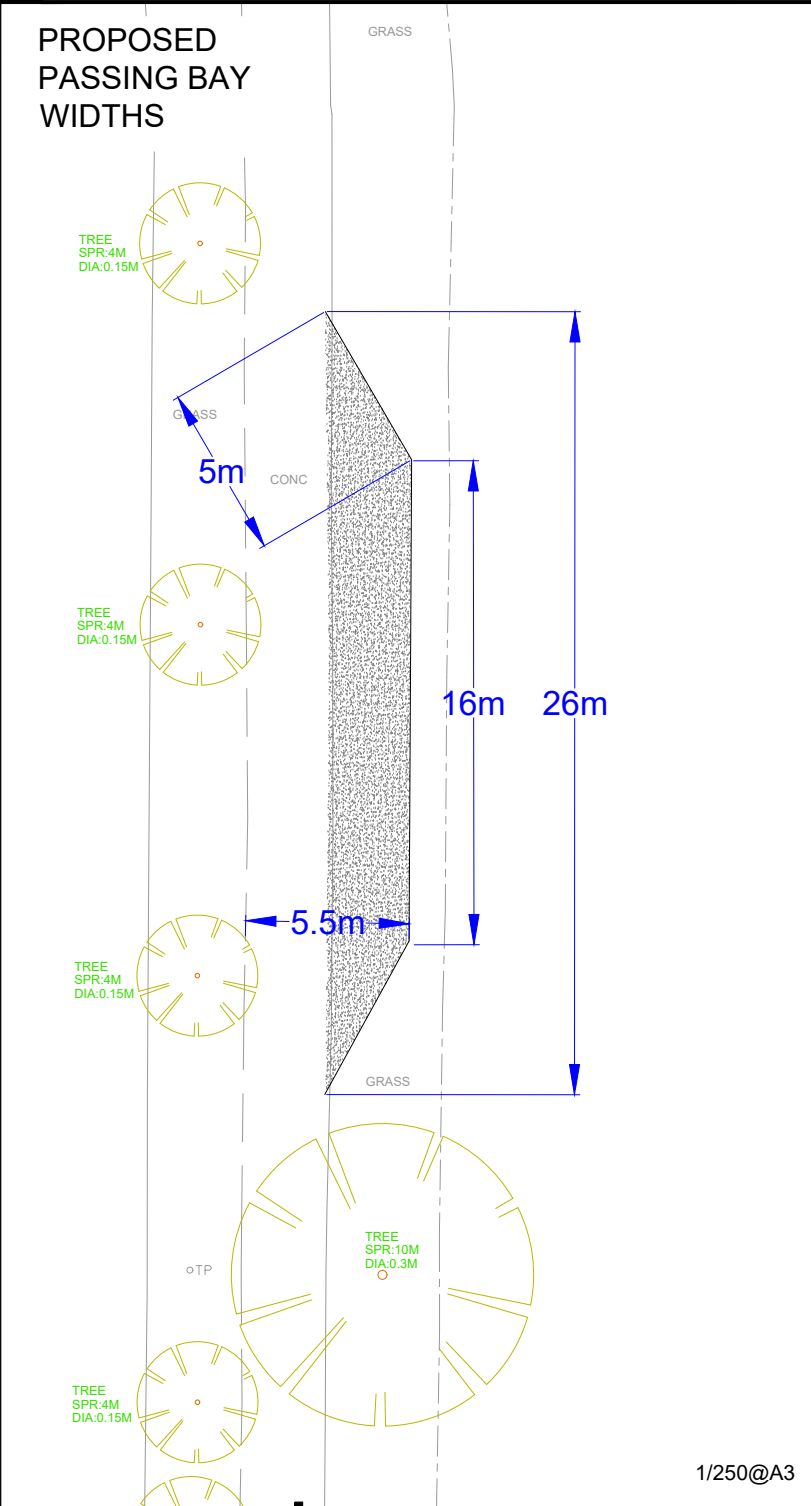

1/250@A3

SITE ACCESS TRACKING MOVEMENTS

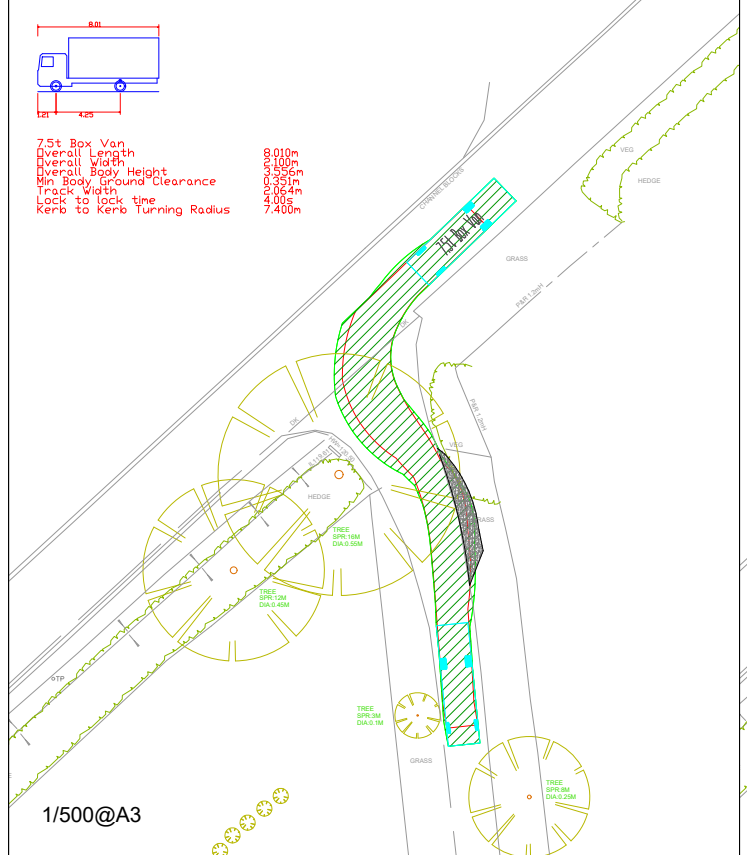

1/500@A3

1/500@A3

PASSING BAY TRACKING MOVEMENTS

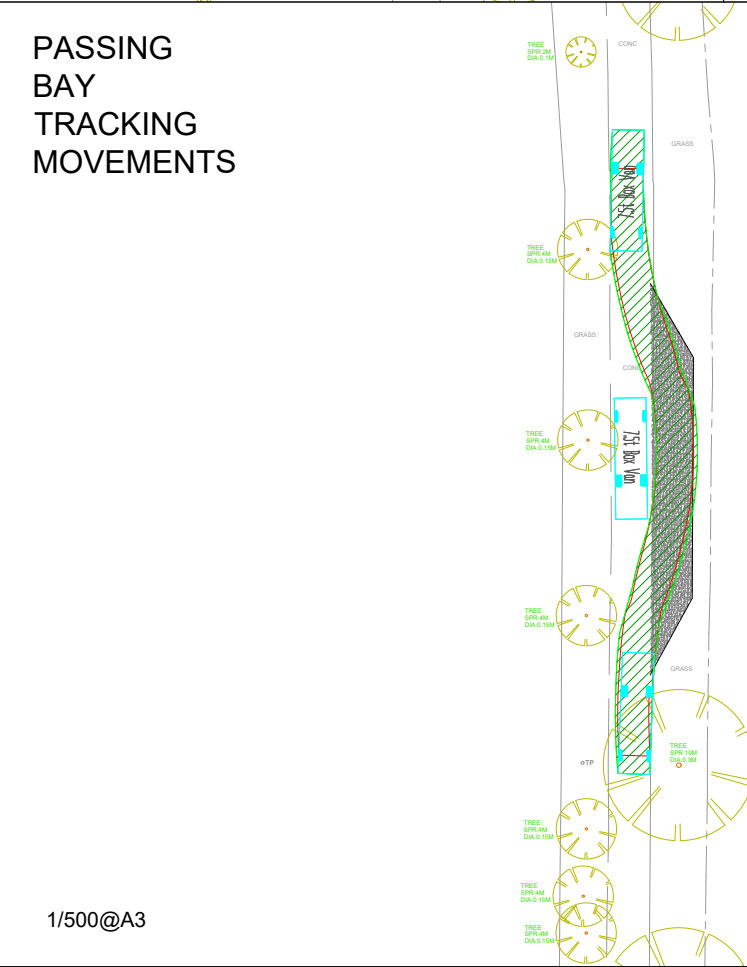

1/500@A3

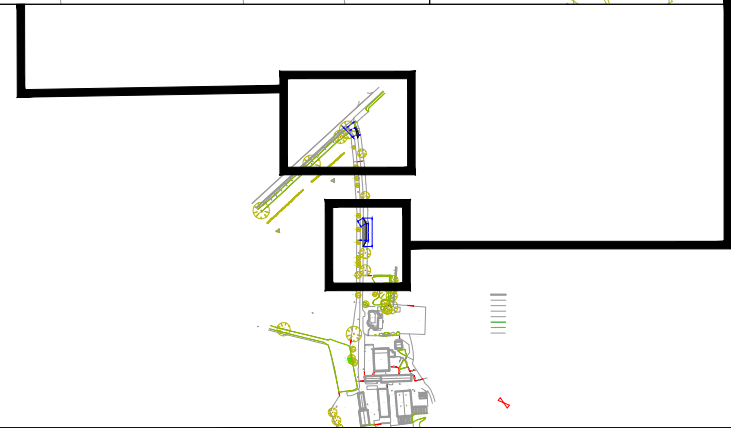

NTS

Based upon the ORDNANCE SURVEY MAPS with the permission of THE CONTROLLER OF HER MAJESTY'S STATIONERY OFFICE © Crown Copyright AL 100030412

© David Tucker Associates

REV	DESCRIPTION	DRAWN	INITIALS	DATE



Forester House, Doctors Lane, Henley in Arden, Warwickshire B95 5AW
Tel: +44(0)1564 793598
Fax: +44(0)1564 793983
www.dtatransportation.co.uk

JOB TITLE Mount Pleasant Farm, Stewkley		CLIENT Webb Developments	
DRAWING TITLE Existing Access Widths & Proposed Passing Bays with Vehicle Tracking			
SCALE See Plan	DRAWN BY DN	DATE Aug 23	DRAWING No 23529-02
			REVISION A