

Lighting Key

ALL ITEMS TO BE SUPPLIED AND INSTALLED BY CONTRACTOR UNLESS OTHERWISE STATED
SEE LIGHTING SCHEDULE FOR FULL SPECIFICATION

CONTRACTOR TO ENSURE CLIENT SIGNS OFF ALL PRODUCTS PRIOR TO ORDER AND INSTALL
FINAL SETTING OUT TO BE AGREED ON SITE WITH CLIENT

ITEMS BELOW IN 'BLUE' IP RATED

ALL RECESSED CEILING LIGHTS TO BE FIRE RATED OR HAVE FIRE HOOD

| Code (See lighting schedule) | Description (See lighting schedule for exact specification) |
|------------------------------|--|
| AS-S1 | Lighting circuits. Red = dimmable. Green = switch |
| LS_01 | IP rated Floor recessed marker light |
| LS_02 | IP rated Wall mounted feature downlight |
| LS_03 | IP rated External LED down light on sensor |
| LS_04 | IP rated External waterproof lantern |
| LS_05 | IP rated Ceiling recessed LED down lighting. Directional as shown with arrow |
| LS_06 | Waterproof External Light switch for IP rated light (at 1200mm AFFL) |
| LS_07 | Light switch (at 1200mm AFFL) |
| LS_08 | Dimmable light switch (at 1200mm AFFL) |
| LS_09 | PIR Sensor control for lighting |
| LS_10 | Feature pendant light - exact setting out point agreed on site. SUPPLY BY CLIENT |
| LS_11 | Recessed LED down lighting. |
| LS_12 | Surface mounted ceiling spotlight with adjustable head |
| LS_13 | Concealed LED strip within joinery |
| LS_14 | Outdoor security spotlight with low beam - on sensor and override |
| LS_15 | Low level ambient wall light ambient |
| LS_16 | Mid level LED ambient wall light |
| LS_17 | Floor Mounted Pop-Up Socket for 5 amp lamp - finish tbc by client |
| LS_18 | Lamp 5 amp socket |
| (R) | Existing lighting layout and fixtures retained |

NOTES:

- Final circuits to be confirmed with client
- Energy efficiency to building regs and planning conditions
- Kitchen lighting to be confirmed with suppliers
- Where light fitting clashes with building structure, contractor to notify client and agree repositioning
- Prior to first fix, client and contractor to agree final lighting position and numbers marked on ceilings
- Where existing fittings and face plates are to be removed, wiring made safe and wall made good
- Contractor to allow for all cabling of all cables within walls where lights and switches are shown. Wall to be made good (rendered or plastered and painted) to match the finish illustrated to the space.

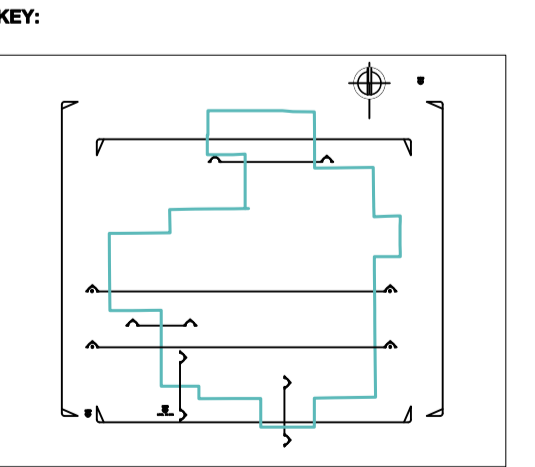
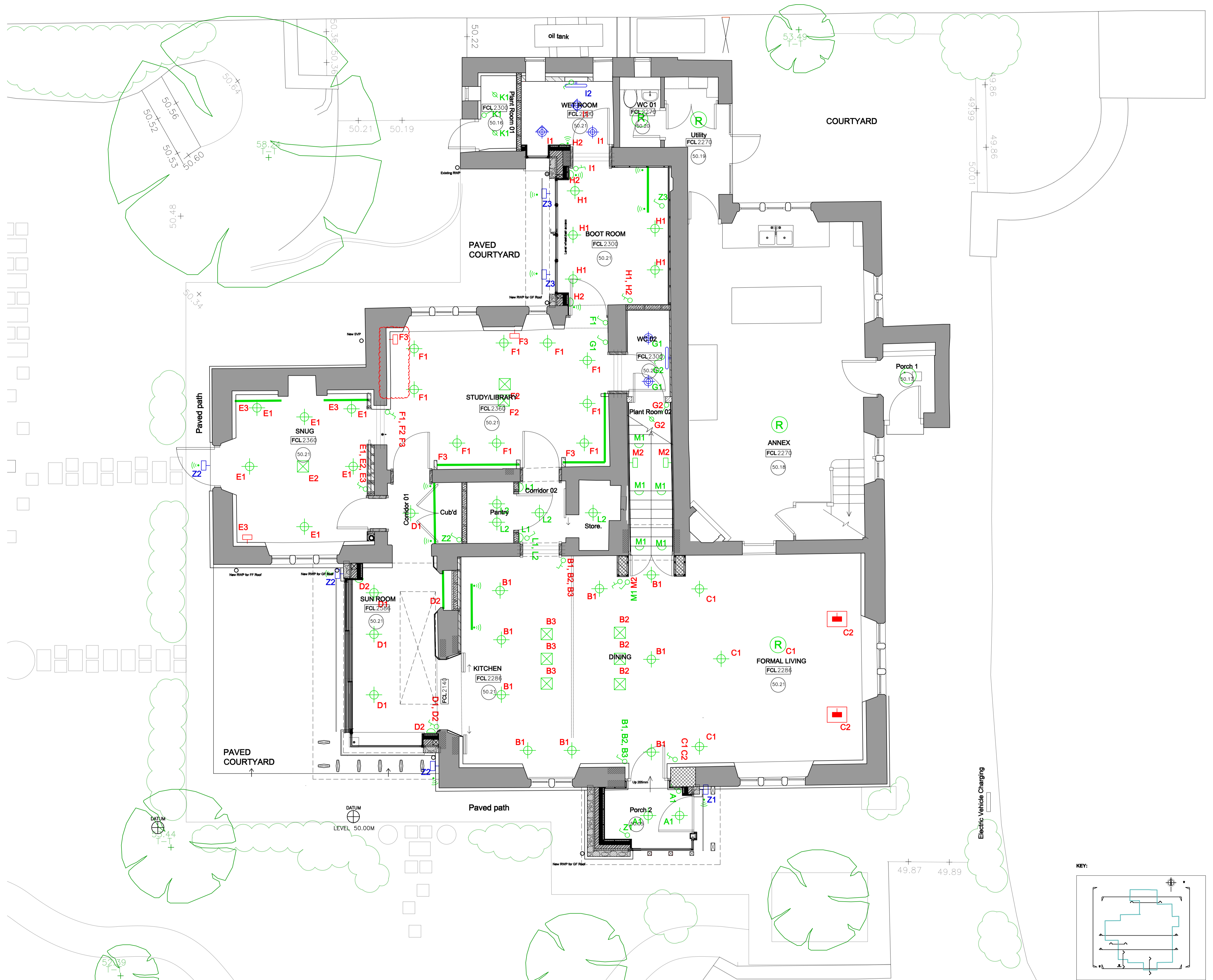

| Date | Drawn by | Checked by | Description |
|----------|----------|------------|---|
| 14/10/21 | MH | TICNT | Draft issue |
| 09/11/22 | MH | TICNT | Coasting issue |
| 09/05/23 | MH | TICNT | Construction issue - New: Omit LED light to study |

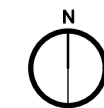
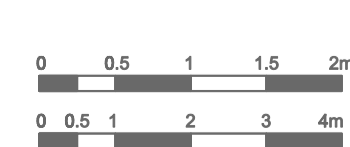

Tonic Architecture
Tonic Architecture Ltd, 5.2 Paintworks, Bath Road, Bristol, BS4 5EH
T: 0117 980 3515 | E: studio@tonicarchitecture.co.uk | www.tonicarchitecture.co.uk

Project The Old School
Location The Old School & School House, Coin St. Aldwms, GL7 5AG
Drawing Proposed Ground Floor Lighting Layout

| | | | | |
|------------------------------|------------|---------|----------|------|
| Scale 1:100 @ A1: 1:100 @ A2 | Checked by | Job No. | Draw No. | Rev. |
| Date 07.07.2021 | NT/TF/C | 1062 | T_331 | B |
| Drawn by MH | | | | |