

position of existing of 75 person  
Clearwater Bioclere sewerage  
treatment plant. See manufacturers  
brochure submitted with application.

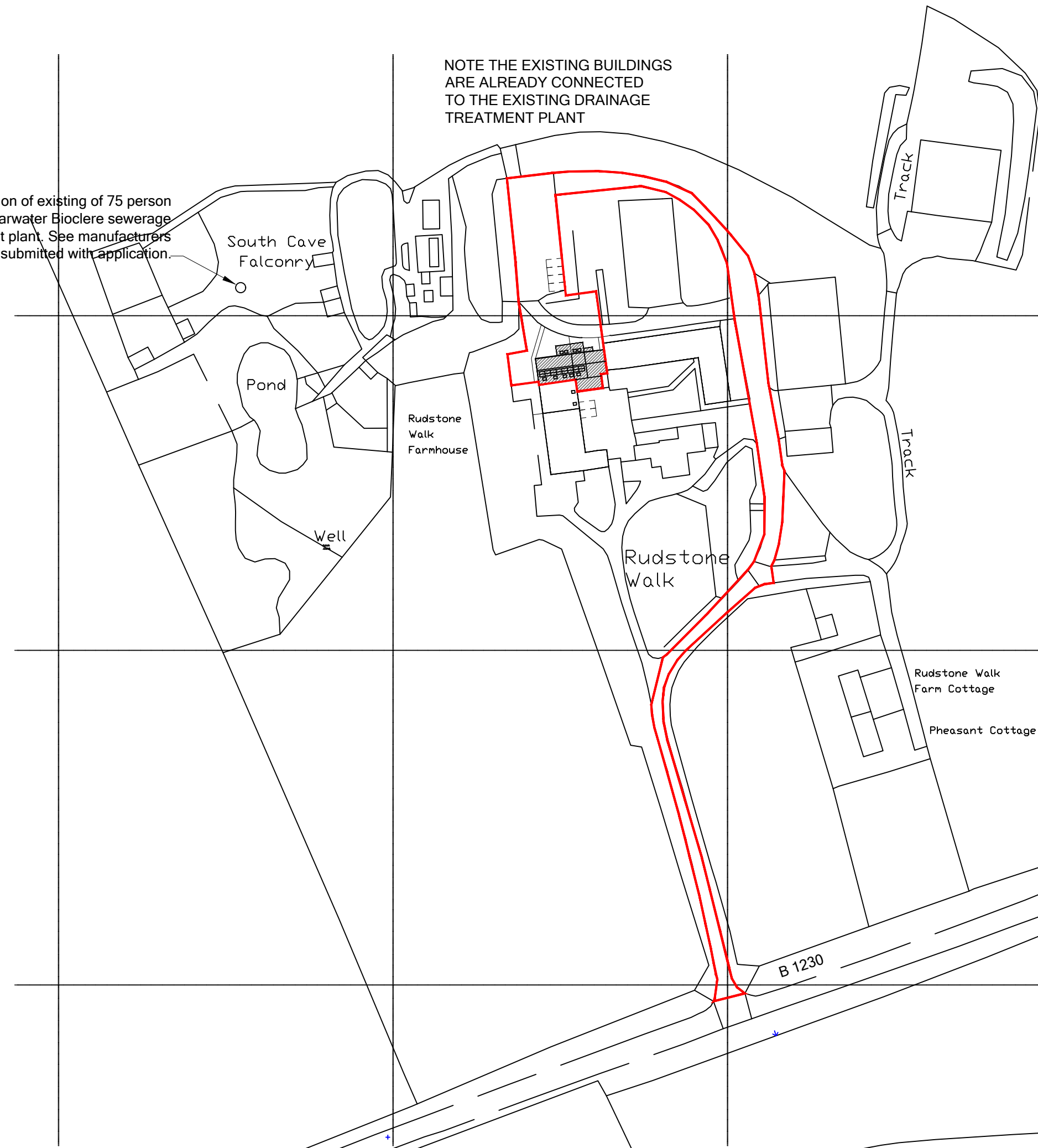

NOTE THE EXISTING BUILDINGS  
ARE ALREADY CONNECTED  
TO THE EXISTING DRAINAGE  
TREATMENT PLANT

LOCATION PLAN 1:1250

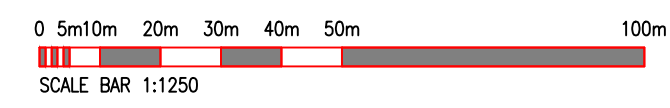

A 1024 KETTLETHORPE HILL

Rev		Note		Initial		Date	
3 Richmond House, Caldene Business Park, Mytholmroyd, Hebden Bridge, West Yorkshire, HX7 5QJ 01422 883317 enquiries@tdjagger.ltd.uk www.tdjagger.ltd.uk							
Client							
Taylor							
Project							
Rudstone Walk Southcave HU15 2AH							
Drawing							
Location Plan							
Date	June 2023	Drawn	R Lan	Checked		Scale	1:1250@A1
Drwg. No.	2842-23-33		Revision		C		
<small>Drawings are to scale indicated for planning purposes. No scaling permitted for construction purposes. Information on this drawing is copyright. All rights reserved. No part of this work may be reproduced or transmitted in any form by any means, either electronically, mechanically, by photocopying, recording or otherwise stored in any retrieval system of any nature, without the express consent of T D Jagger Ltd.</small>							
<small>Don't Ignore Health &amp; Safety</small> 							