

NORTH WESTERN STREET SCENE

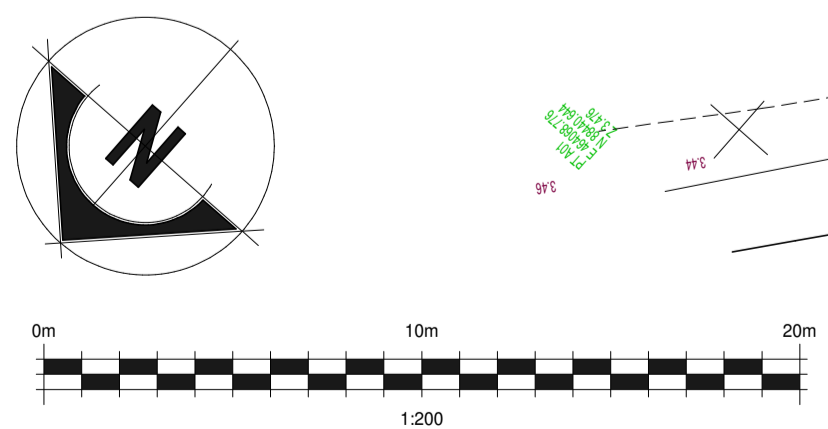
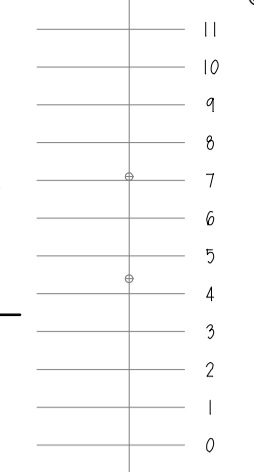

PLANNING ISSUE

DEANPARKMAN architecture Ltd
 ARCHITECTURAL CONSULTANT & SURVEYOR
 Corner House, 68-70 Lugley Street,
 Newport, Isle of Wight, PO30 5ET
 T: 01983 523709
 M: 07729778111
 E: dean@deanparkman.co.uk
 www.deanparkman.co.uk

DRAWING TITLE:
**PROPOSED REPLACEMENT DWELLING
 & 19No. INDUSTRIAL UNITS**

PROJECT TITLE:
**'BEMBRIDGE BOATYARD, PILOTS HOUSE & QUAYSIDE' EMBANKMENT ROAD BEMBRIDGE
 ISLE OF WIGHT PO35 5NR**

SCALE: 1: 200	JOB NO.	DWG NO.	REV.
SHEET: A1	406 : 2 : C		
DATE: AUGUST 2023			