

All dimensions to be checked on site. Written dimensions to be followed in preference to scaled dimensions.  
All errors and omissions to be reported to the architect.

EXISTING GROUND FLOOR PLAN

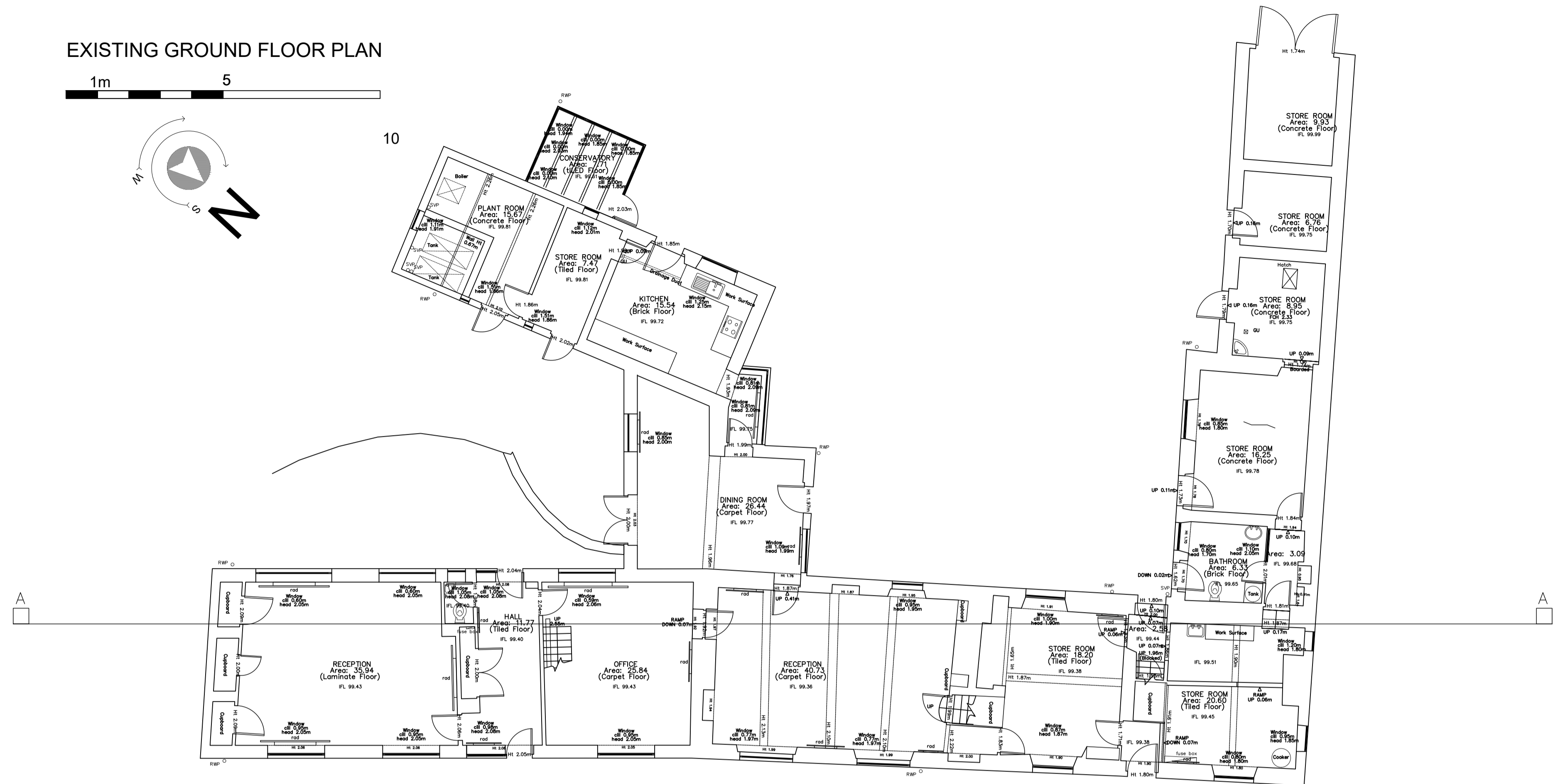

EXISTING FIRST FLOOR PLAN

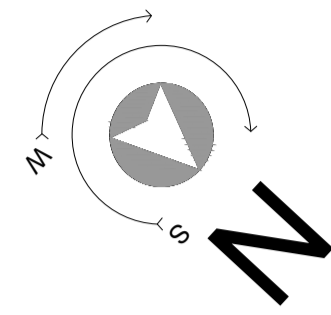
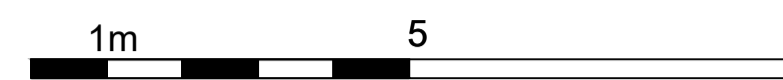
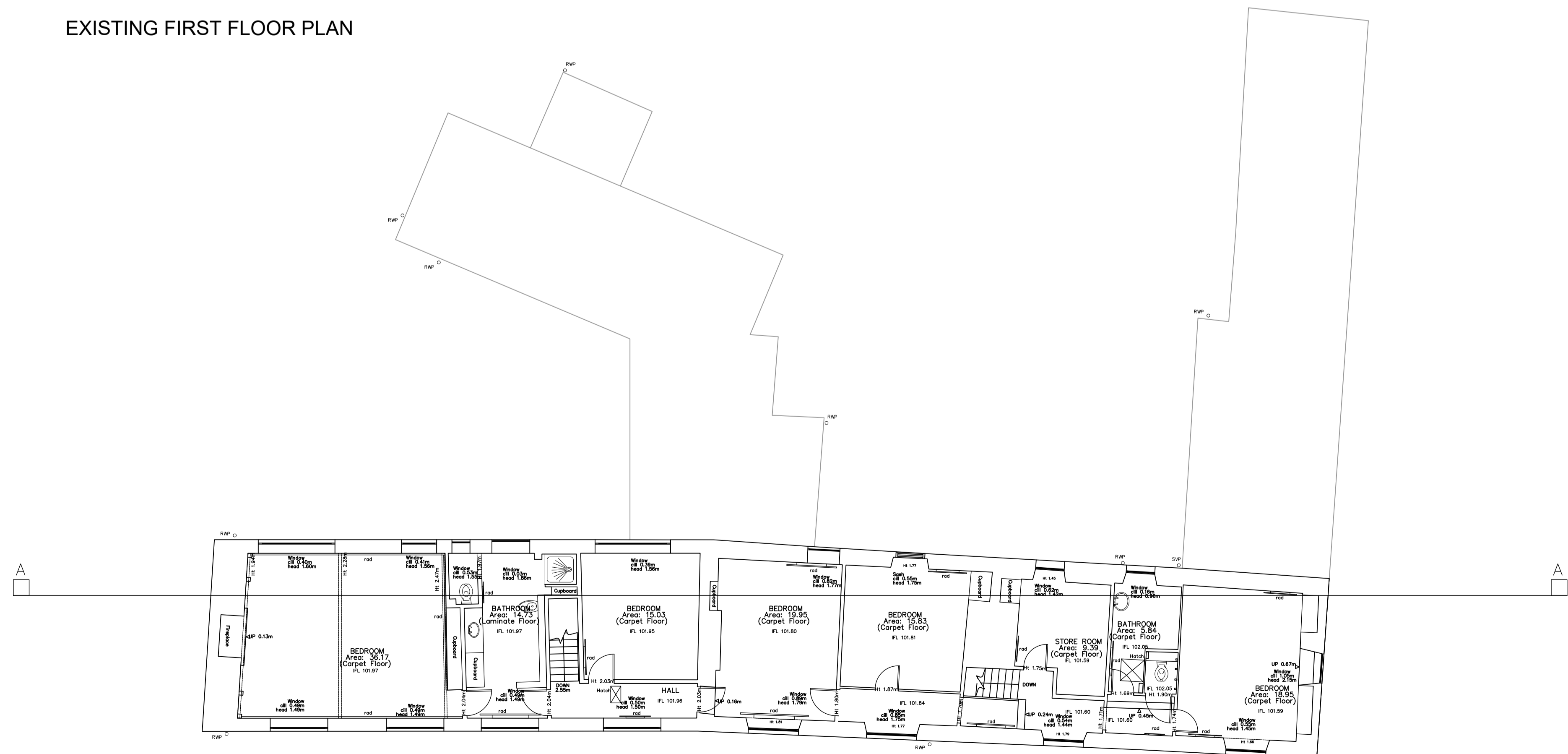

Rev.	Date	Description	Drawn

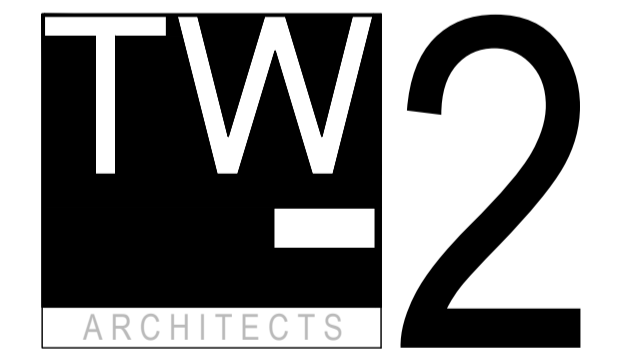

The Old Registry Office,  
20 Amersham Hill  
High Wycombe,  
Buckinghamshire,  
HP13 6NZ

Tel: 01494 512717  
Fax: 01494 471714  
email: info@tw-2.co.uk

**Project**  
ST PETERS COTTAGE  
MAIN STREET  
ALDWINGLE  
KETTERING  
NN14

**Drawing Title**  
EXISTING FLOOR PLANS

Date	Scale	Cad Ref	Drawn	Checked
AUG23	1:100			PK

**Drawing No.**  
23 680 PL03

