

PROPOSED BLOCK PLAN

1:200

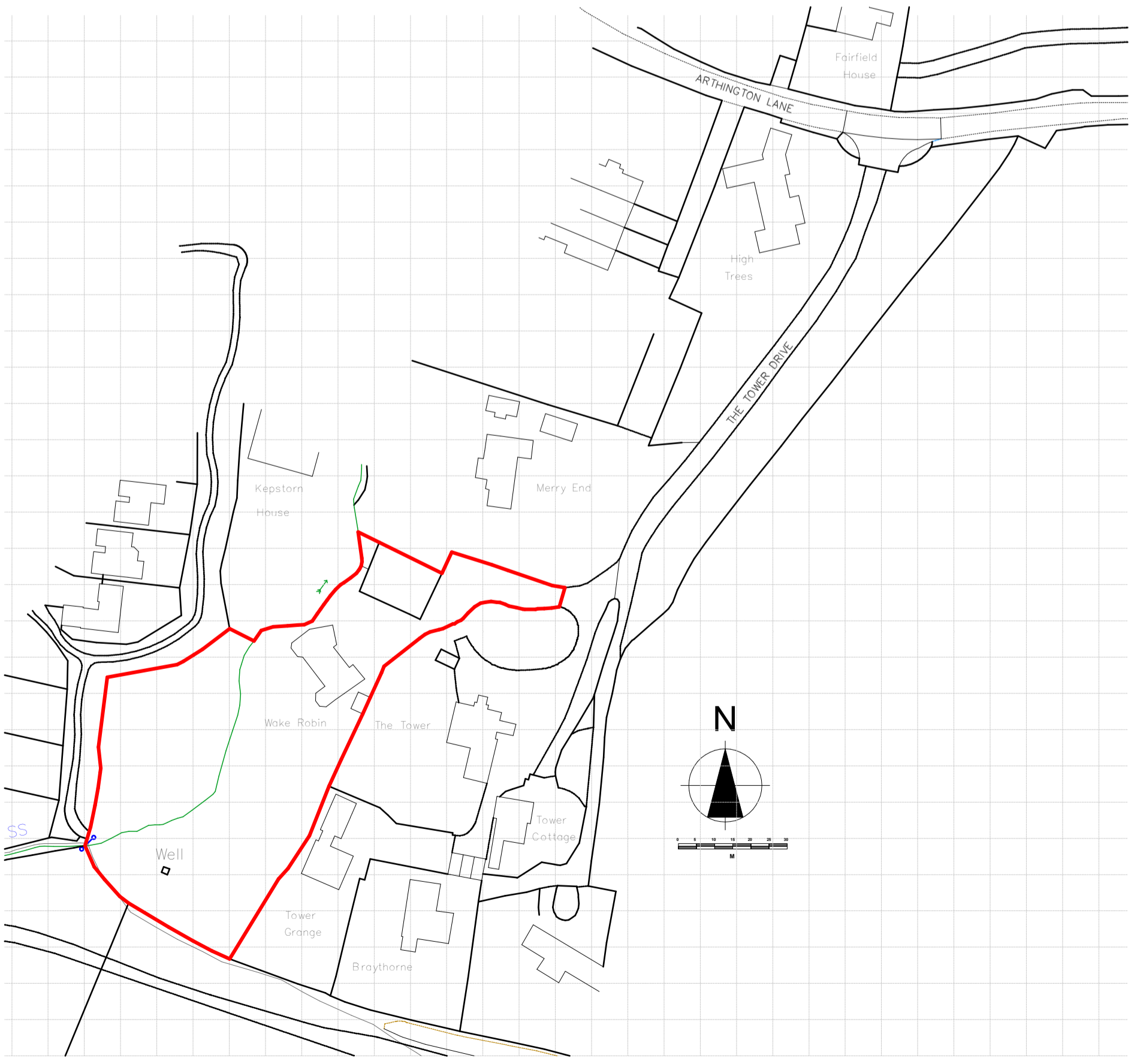

LOCATION PLAN

1:1250

<b>Title</b> <b>Proposed Block Plan &amp; Location Plan</b> <b>Planning Drawing</b>		
<b>Project</b> <b>Proposed Alterations To Dwelling at: Wake Robin, The Tower Drive, Pool, LS21 1NQ.</b>		
<b>VAUGHAN MONCKTON</b> <b>ARCHITECTURE LTD</b> 105 LONG ROW, HORSFORTH, LEEDS, LS18 5AT Telephone: 01132 253 530 Fax: 01132 253 722		
<b>Drawn</b> P.B.	<b>Date</b> Aug 2023	
<b>Scale</b> As shown @ A2	<b>Drawing No.</b> 2294/01/P4	<b>Rev.</b> -