

#11

#13

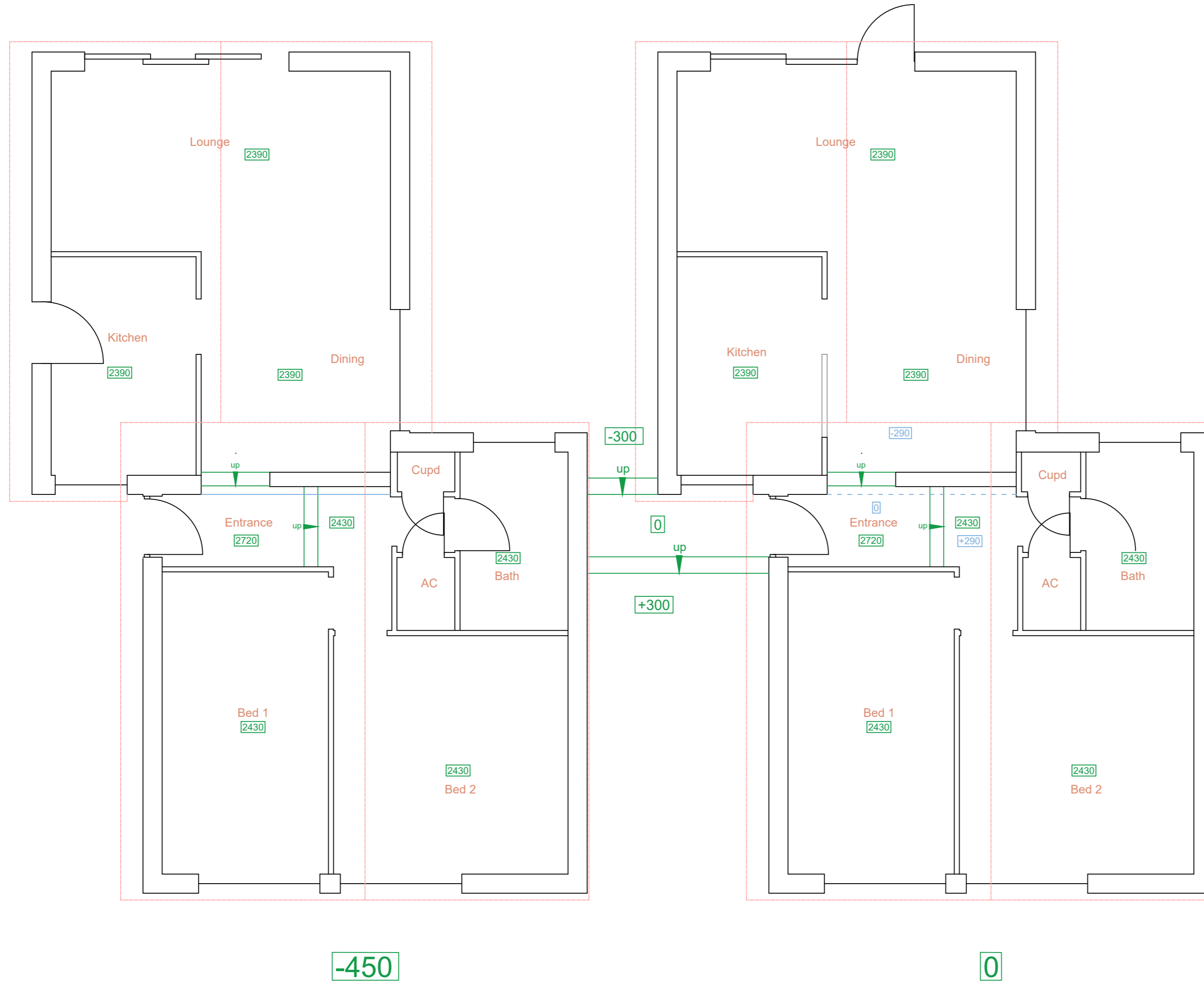

Please note:
This drawing is to be used as an aid to achieve planning / building regs approval and as a guide for the proposed works. Dimensions, levels and existing construction materials are to be checked on site prior to construction of proposed works. Therefore, design can be subject to amendment.
All structural work to be overseen by a structural engineer.

Important note: All measurements to be checked on site before any construction takes place. Do not scale from this drawing.

AGC Consultants
14 Seafeld Ave.
Mistley
Essex
CO11 1UE
07792 830411



Client Adam Paveley

Project title Rear extension at:
11 & 13 Rowley Close
Brantham
CO11 1RR

Drawing title Existing ground floor plans

Scale 1:50@A2

Date 07/10/22

Dwg No

Rev No

0424/PL/01