

BIGHTON ROAD

Existing vehicle entrance closed off, with brick infill to match existing garden wall.

Stamford House

Garage converted to 100% accommodation

Proposed new single storey extension for pool table

GOATACRE ROAD

SEE HIGHGATE TRANSPORTATION SUBMISSION FOR PROPOSED NEW DRIVEWAY DETAILS
Existing verge and road edge shown dashed

Parking

New vehicle driveway

New vehicle entrance, with pair of vertically boarded timber electric gates, 1850mm in height.

Three Ways

Garden room (dashed) partially removed

Tarmac driveway removed and front garden extended.

Conservatory (dashed) removed

Overhead power line

Green Oaks

Existing outbuilding (dashed) removed.
New single storey pitched roof extension removed

Garden

Existing tennis court

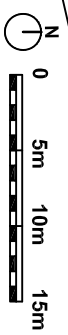
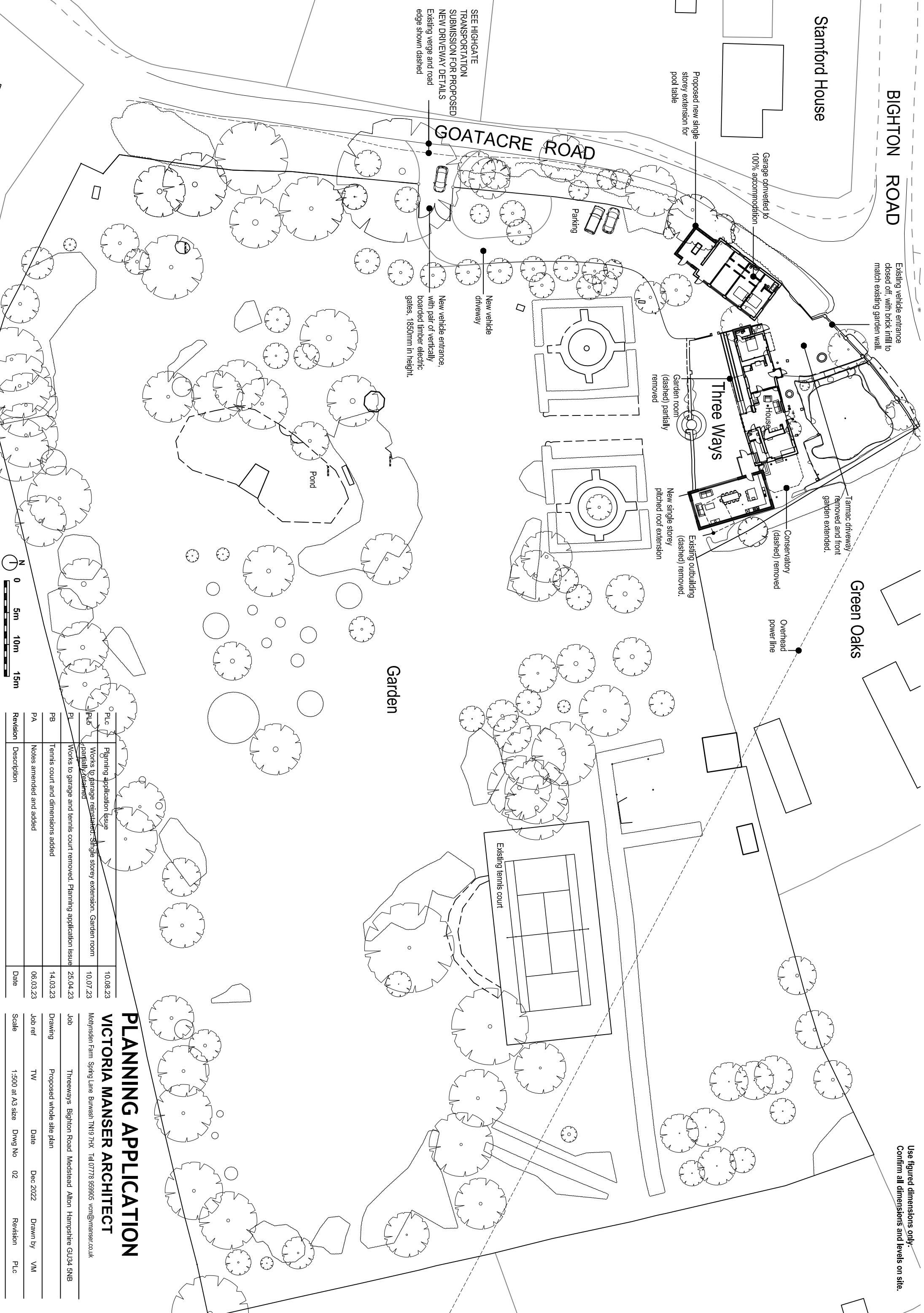

PLC	Planning application issue	10.08.23
PLB	Works to garage reinstated. Single storey extension. Garden room partially retained	10.07.23
PL	Works to garage and tennis court removed. Planning application issue	25.04.23
PB	Tennis court and dimensions added	14.03.23
PA	Notes amended and added	06.03.23
Revision	Description	Date

PLANNING APPLICATION

VICTORIA MANSER ARCHITECT

Motivnsden Farm Spring Lane Burwash TN19 7HX Tel 07778 959905 vcn@vmanser.co.uk

Job: Threeways Bighton Road Medstead Alton Hampshire GU34 5NB

Drawing: Proposed whole site plan

Job ref: TW Date: Dec 2022 Drawn by: VM

Scale: 1:500 at A3 size Dwg No: 02 Revision: PLC

Use figured dimensions only. Confirm all dimensions and levels on site.