

Use figured dimensions only.  
Confirm all dimensions and levels on site.

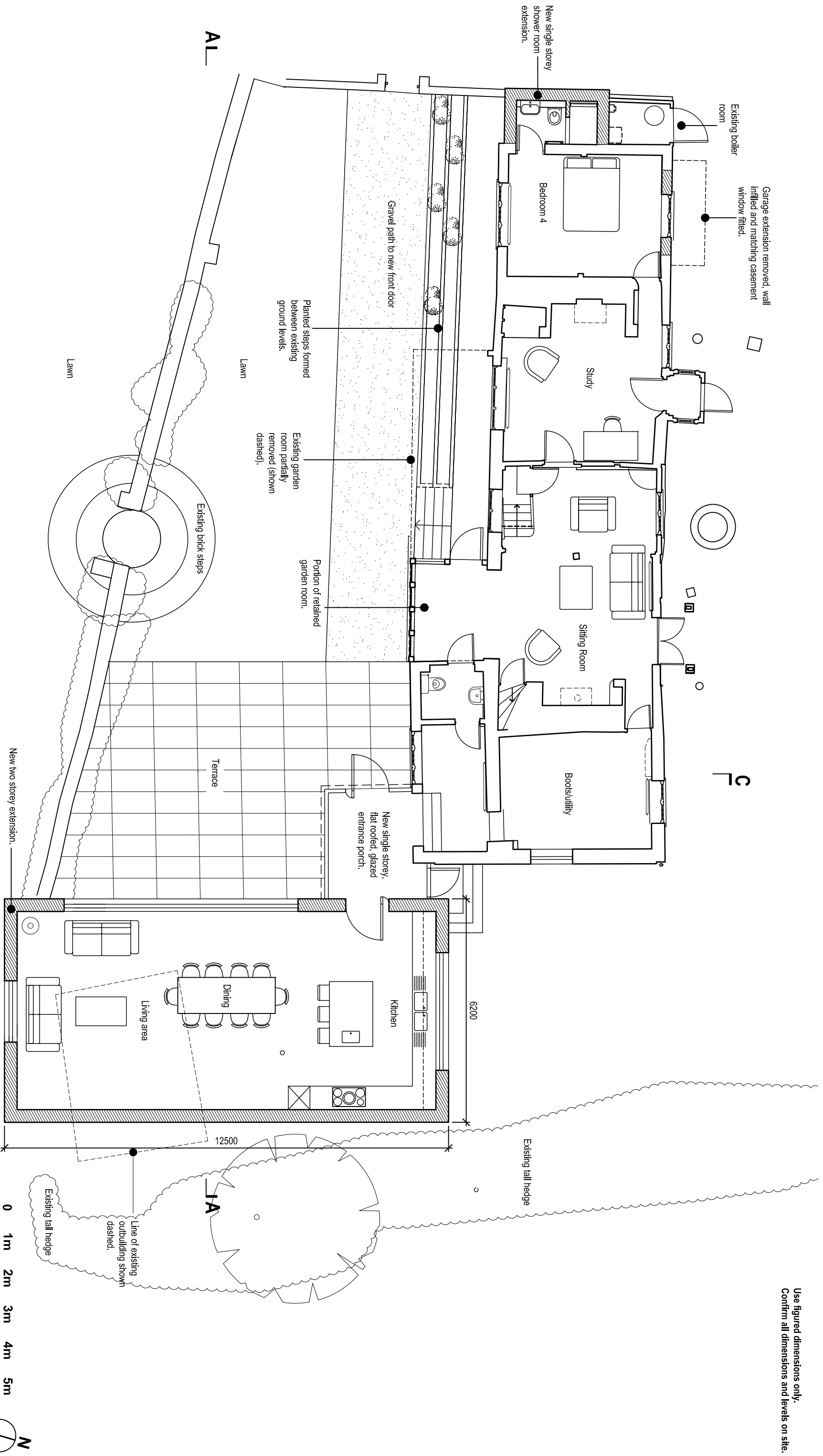

BL

LC

GROUND FLOOR PLAN

JIB

**PLANNING APPLICATION**

**VICTORIA MANSER ARCHITECT**

Moltynsden Farm Spring Lane Burwash TN19 7HX Tel 017778 959905 vcm@vmanser.co.uk

| PLC      | Planning application issue  | 10.08.23 |
|----------|---|----------|
| PLb      | Works to garage reinstated. Single storey extension. Garden room partially retained | 12.07.23 |
| PL       | Minor amendments and notes added for planning application issue                     | 25.04.23 |
| PC       | Extension stair position moved with associated alterations to layout                | 13.04.23 |
| PB       | Notes, section lines and landscape details added                                    | 26.03.23 |
| Revision | Description   | Date     |

|          |  |
|----------|--|
| Job      | Threeways Bighton Road Medstead Alton Hampshire GU34 5NB                 |
| Drawing  | Proposed building alterations- ground floor with single storey extension |
| Job ref  | TW   |
| Date     | March 2023   |
| Drawn by | VM   |
| Scale    | 1:100 at A3 size Dwg No 08 Revision PLC                                  |