

Lighting Column and Camera  
General Arrangement Detail

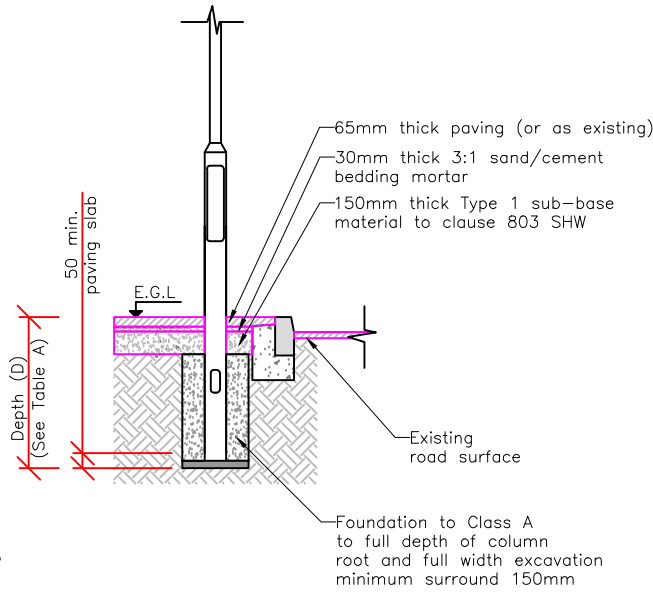
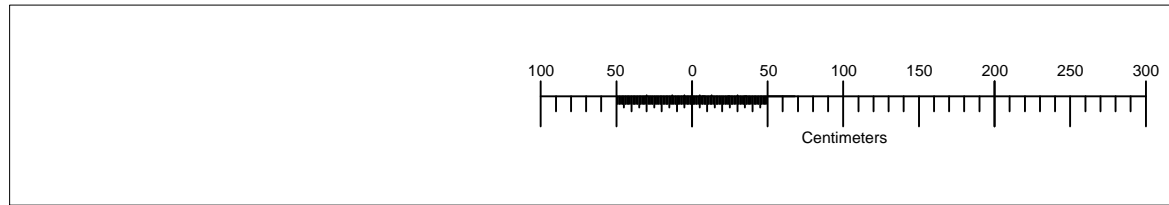

Column Foundation and  
Reinstatement Details

1. Contractors to check dimensions and notify any discrepancies or errors to the company immediately.
2. Work to figured dimensions only and to be checked before commencement of work on site.
3. Drawing is already to scale.
4. All dimensions in millimetres unless otherwise stated.
5. For further details of external cabinet, refer to drawing number C-0000-009

A | For Information | DAO|DAO|CL |01/08/2014

TABLE A:	DEPTH (D) (mm)		
	G630 GOOD SOIL	G390 AVERAGE SOIL	G230 POOR SOIL
COLUMN HEIGHT (H) (mm)			
5000	800	1000	1200

**Soil Type:** (Factor G) (BS 5649 Part 2)

**G630 Good:** Compact, well graded sand and gravel, hard clay, well graded fine and coarse sand, decomposed granite rock and soil. Good material should be well drained and in locations where water will not stand.

**G390 Average:** Compact fine sand, medium clay, compact, well drained sandy loam, loose coarse sand and gravel. Average soils should be drained sufficiently well that water does not stand on surface.

**G230 Poor:** Soft clay, clay loam, poorly compacted sand, clays containing a large amount of silt and vegetable matter, and made ground. Poor soils will normally be wet and have poor drainage.

ParkingEye

Standard  
Details

ANPR Lighting Column and Column Mounted Cabinet  
General Arrangement

Information *Y. Sahar* 22/09/22

Information

1:50 *Y. Sahar* 22/09/22

C-0000-001

A