

LNT Care Developments

Cllr Peter Harris
Town Hall
Station Road
Clacton-on-Sea
Essex
CO15 1SE

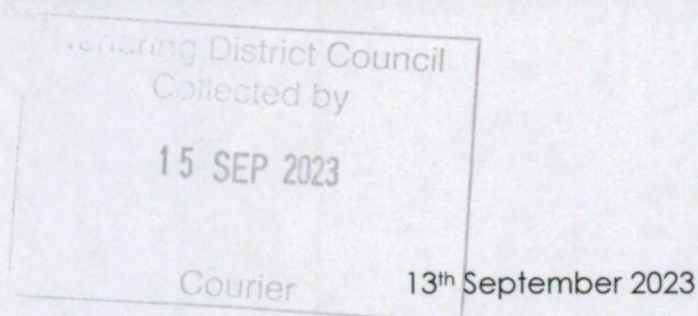

Dear Cllr Harris,

PROPOSED CARE HOME FOR OLDER PEOPLE, THE OAKS, CLACTON ROAD, WEELEY HEATH, CO16 9EF (PP Ref No -PP-12451886)

Please accept this letter as an introduction and notification of our proposal to develop a site at The Oaks, to provide a new care home for older people.

LNT Care Developments has considerable experience of developing care homes across the country with a portfolio of care homes in a number of locations across Yorkshire, Midlands and the South.

The National Care Standards Act 2000 was introduced to secure improved standards in the quality of care provided and the physical characteristics of the premises in which care is offered. All new care home developments are now expected to be provided by way of purpose-built facilities compliant with these standards; that provide single-room accommodation with en-suite facilities; and a much-improved ratio of communal/recreational space per resident.

After extensive research into the general demographics and need for residential care in the area, LNT Care Developments have resolved to develop this site to provide a new facility. Following consideration of the character and appearance of the area we are proposing a new two-storey 66 bed care home. Our proposed site layout and building design are illustrated on the enclosed drawings. These drawings form the basis of a planning application that has recently been submitted to Tendring District Council.

This planning application proposes an important new local community care facility. Residents of the home will be expected to come from no more than three to five miles away or be associated with families/relative's resident within this same catchment. In addition, the development is expected to generate over 50 new jobs, the majority of which will be offered to suitable candidates from the same three-mile catchment.

This letter and the attached information are to ensure that you, as local Councillor are fully informed of the proposed development and of the planning application. Letters of consultation have also been sent to all

neighbouring residents, whose properties lie within close proximity to the site boundaries.

I hope this information is of some assistance. If you have any queries or wish to discuss any matters, please do not hesitate to contact me on [REDACTED] or by email on [REDACTED]

Yours faithfully

[REDACTED]

**Tracey Spencer BA (Hons) Dip TP
Senior Planning Manager**

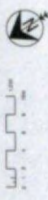

PROPOSED IN RED LINE AND
 SET BACK FROM CLACKTON ROAD
 BUILDING FOOTPRINT (NEW)
 EXISTING BUILDING FOOTPRINT (EXIST)
 EXISTING DRIVEWAY (EXIST) &
 EXISTING DRIVEWAY (NEW)
 EXISTING DRIVEWAY (NEW)

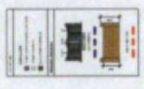

REV	DATE	DETAILS OF AMENDMENTS	DRAWN
REVISIONS			

LNT Construction

LNT CONSTRUCTION LTD
 UNIT 2, HELIOS 47
 ISABELLA ROAD
 GARFORTH
 LS25 2DY

LNT CARE DEVELOPMENTS

CLACKTON ROAD
 CLACKTON SOUTH
 CV4 8EP

SCALE	DATE	REVISIONS	DATE
1:500	15/05/2024	1	
1:500	15/05/2024	2	

FOR PLANNING APPROVAL	
CHECKED BY	DATE
APPROVED BY	DATE

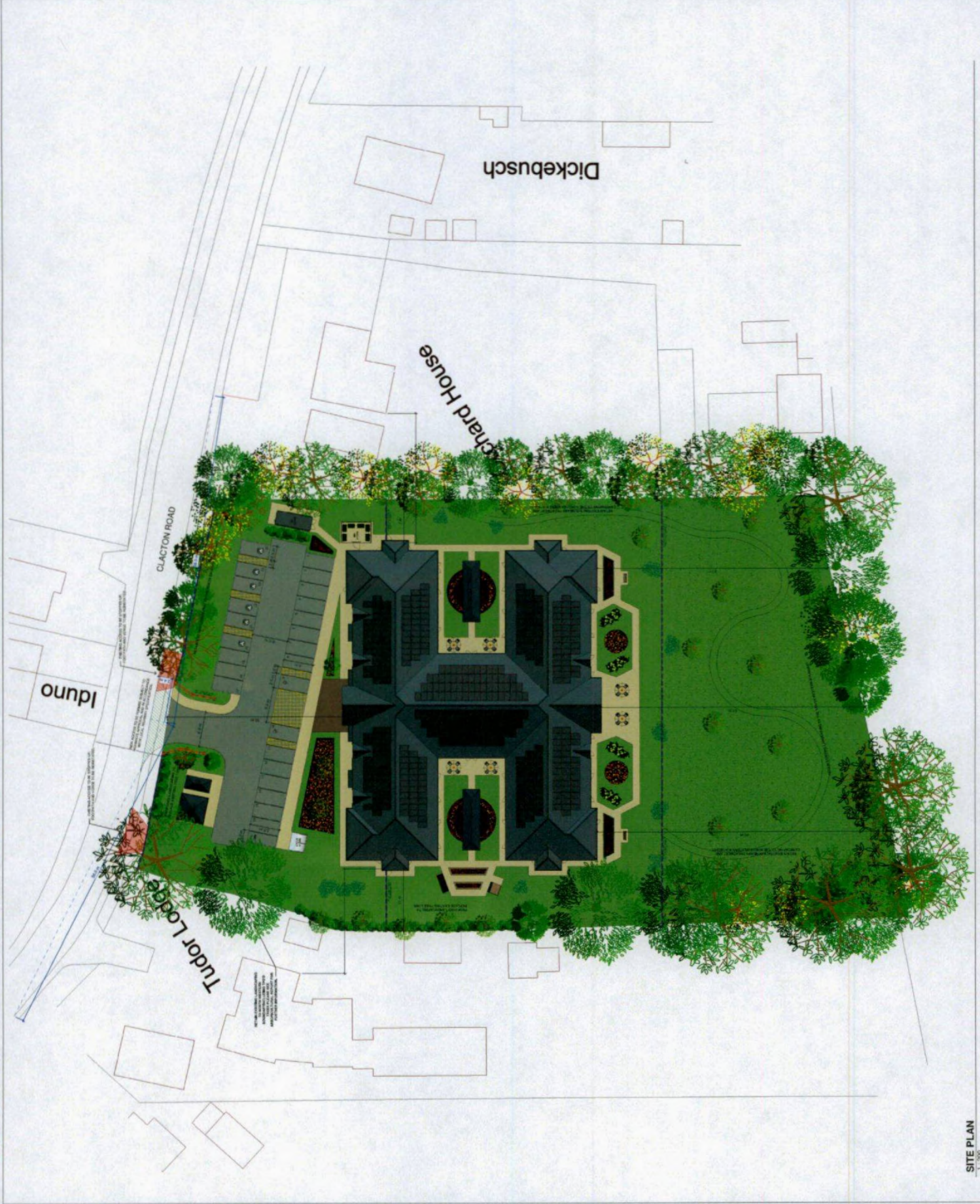



CLIENT: LNT CARE DEVELOPMENTS

SITE: CLACTON ROAD
WEELEY HEATH
CO16 9EP

DATE: 07/09/2023 21:06:31

TITLE: 3D VIEW

DWG NO: CO16 9EP A-06

LNT Construction

LNT CONSTRUCTION LTD
UNIT 2, HELIOS 47
ISABELLA ROAD
GARFORTH
LE25 9DY

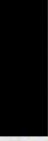

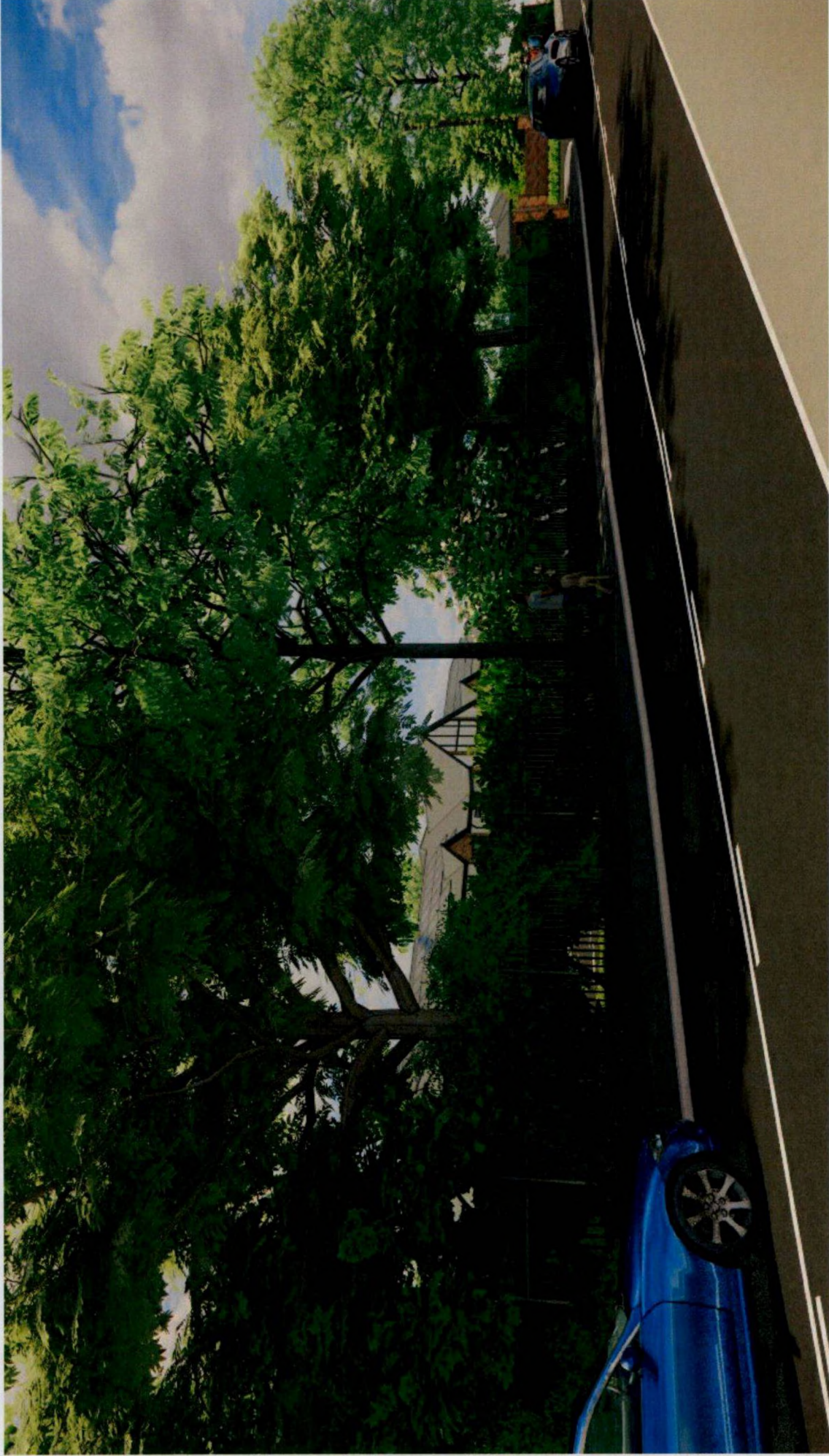

CLIENT: LNT CARE DEVELOPMENTS

SITE: CLACTON ROAD
WEELEY HEATH
CO16 9EP

DATE: 07/09/2023 21:07:24

TITLE: 3D VIEW

DWG NO: CO16 9EP A-06.2

LNT Construction

LNT CONSTRUCTION LTD
UNIT 2, HELIOS 47
ISABELLA ROAD
GARFORTH
LS25 2DY



CLIENT: LNT CARE DEVELOPMENTS

SITE: CLACTON ROAD

WEELEY HEATH

CO16 9EP

DATE: 07/09/2023 21:07:56

DWG NO:

CO16 9EP A-06.3

TITLE: 3D VIEW

LNT Construction

LNT CONSTRUCTION LTD
UNIT 2, HELIOS 47
ISABELLA ROAD
GARFORTH
LS25 2DY



CLIENT: LNT CARE DEVELOPMENTS

SITE: CLACTON ROAD

WEELEY HEATH

CO16 9EP

DATE: 07/09/2023 21:08:47

TITLE: 3D VIEW

DWG NO: CO16 9EP A-06.5

LNT Construction

LNT CONSTRUCTION LTD
UNIT 2, HELIOS 47
ISABELLA ROAD
GARFORTH
LS25 2DY

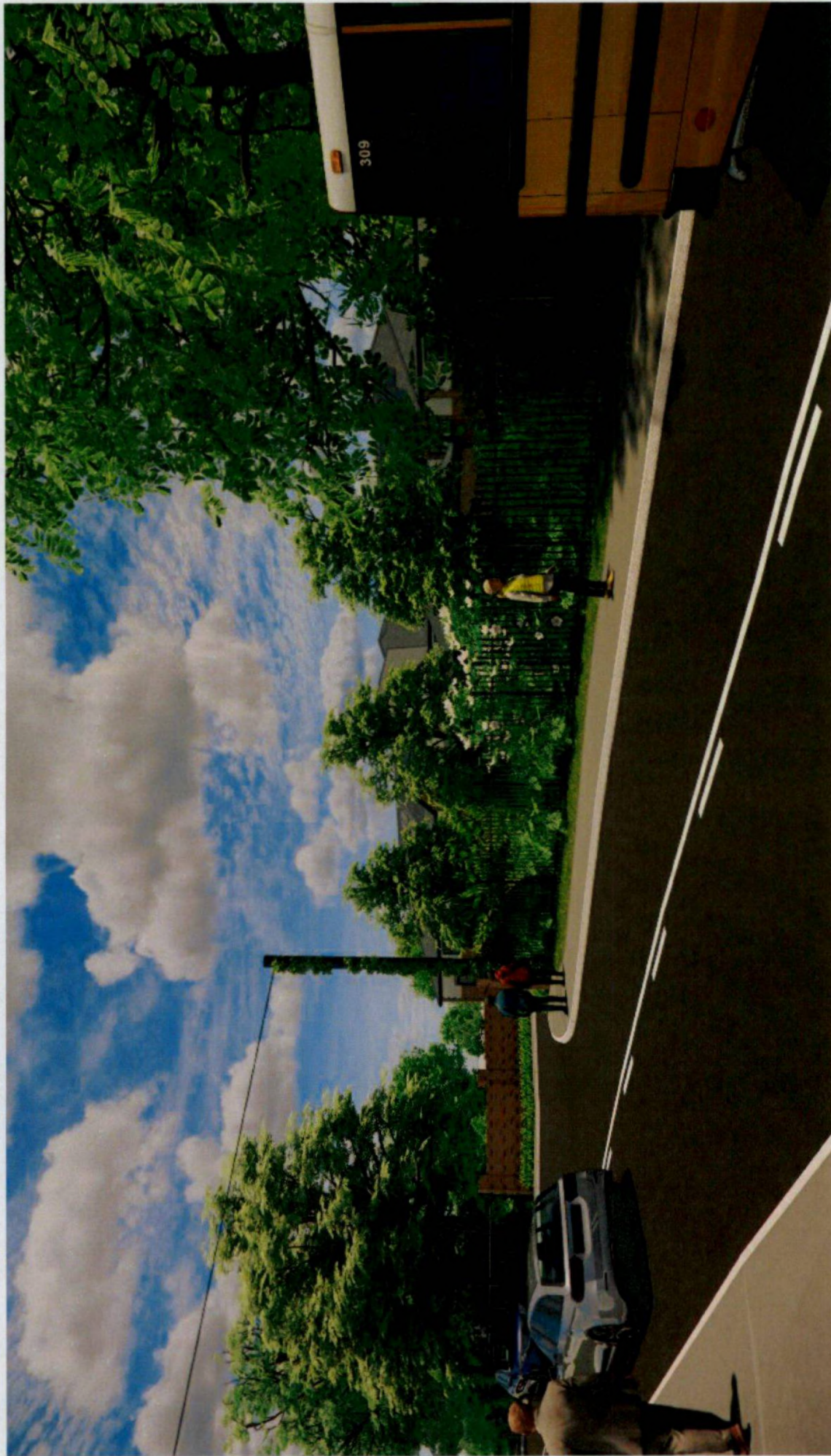

CLIENT: LNT CARE DEVELOPMENTS

SITE: CLACTON ROAD
WEELEY HEATH
CO16 9EP

DATE: 07/09/2023 21:06:56

TITLE: 3D VIEW

DWG NO: CO16 9EP A-06.1

LNT Construction

LNT CONSTRUCTION LTD
UNIT 2, HELIOS 47
ISABELLA ROAD
GARFORTH
LS25 2DY

Tandring
District Council

**This is a scan of the
original document**

