

### LEGEND

Utility Survey Point Features		
AV	Air Valve	MH - Round
BB	Belisha Beacon	MH - Surface Water
CP	CCTV Camera Pole	Marker Post
CR	Cable Riser	Pipe Riser
DP	Down Pipe	Recessed Light
DPG	Down Pipe To Ground	Rodding Eye
EP	Electrical Pole	Stop Cock
ER	Earth Rod	Traffic Light
FR	Fire Hydrant	Valve General
GM	Gas Meter	Water Meter
GV	Gas Valve	Water Valve
G	Gully	

Utility Survey Linework Features			
BT	British Telecom	EHV	Electrical - Extra High Voltage
CATV	Cable TV	HV	Electrical - High Voltage
CCTV	Closed Circuit TV	LV	Electrical - Low Voltage
COMMS	Communications	TFL	Electrical - TFL
FOL	Fibre Optic Line	SL	Street Lighting
FOLD	Fibre Optic Line - Colt	TCSU	Traffic Control System Unit
FOLE	Fibre Optic Line - Energis	G	Gas
FOLF	Fibre Optic Line - Fibernet	GP	Gas Service
FOLL	Fibre Optic Line - Level 3	GLP	Gas Low Pressure
FOLM	Fibre Optic Line - Mercury	GIP	Gas Intermediate Pressure
FOLMF	Fibre Optic Line - MFS	GMP	Gas Medium Pressure
FOLT	Fibre Optic Line - Tanet	GHP	Gas High Pressure
FOLV	Fibre Optic Line - Virgin	GR	Gas + Unknown
FOLVF	Fibre Optic Line - Vodafone	ED	Empty Duct
FOLVN	Fibre Optic Line - Verizon	GR	GR Anomaly
FOLVW	Fibre Optic Line - WCOM	UA	Unknown Asset
TS	Telecom Service	UA	UA Passive Sweep
		UCL	Unknown Cable
			GPR Slab
			GPR Survey Area
			GPR buried structure
			GPR Reinforced Slab
			GPR interface layer (change in material)
			Other
			District Heat
			Fuel Pipe
			Decommissioned/Abandoned
			Manhole Chamber
			Manhole ID
			Pot End
			Scope of Works

PAS128 Quality Levels	
(Consult document PAS128-2014.pdf for full details)	
XX - A	Quality Level A
XX - B1	Quality Level B1
XX - B1P	Quality Level B1P
XX - B2	Quality Level B2
XX - B2P	Quality Level B2P
XX - B3	Quality Level B3
XX - B3P	Quality Level B3P
XX - B4	Quality Level B4
XX - C	Quality Level C
XX - D	Quality Level D

Special Survey Features	
E-XXXX-XXX	Electricity - XXX
N-YYYY-YYY	Survey Station
H-ZZZ-ZZZ	Scan Target

Utility Survey Abbreviations			
AB	Abandoned	MH	Manhole
AR	Assumed Route	OE	Overhead Electric
BI	Illuminated Bollard	OT	Overhead Telecom
CL	Cover Level	SOF	Soft Level
CPD	Capped	TFR	Taken From Records
CUT	Disconnected Utility	TVM	Ticket Vending Machine
EDG	End of GPR Signal	UTO	Unable to Open
EOT	End of Tape	UTS	Unable to Survey
IC	Inspection Cover	UKN	Unknown
IL	Invert Level	WL	Water Level
CSER	Confined Space Entry Required	XXd	Service Depth

Utility Material Abbreviations					
AC	Asbestos Cement	CO	Concret	SI	Spun Iron
BC	Brick Chamber	DI	Ductile Iro	ST	Steel
CI	Cast Iron	PE	Polyethylene	WTR	Water

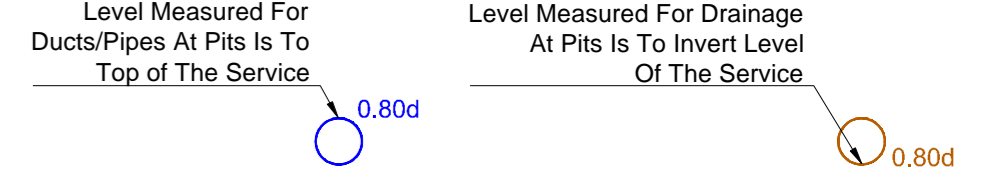

**Murphy Geospatial Disclaimer**

All reasonable endeavours have been used to capture the required data in the survey to the agreed standards of accuracy. Where features have been obscured due to a lack of access, the areas will be annotated as UTS (Unable To Survey). The Company shall not be liable for any damage or consequential losses arising from the reliance on survey information beyond its specified scale and accuracy, or survey information used for purposes other than that stated in the Contract of Works.

Any concerns with the survey should be raised with Murphy Geospatial, who will endeavour to promptly provide a remedy. The Client shall not seek recourse through any third party until such time as Murphy Geospatial have had the opportunity to address any concerns raised.

For full terms and conditions visit [Terms and Conditions](http://www.murphygs.com) www.murphygs.com

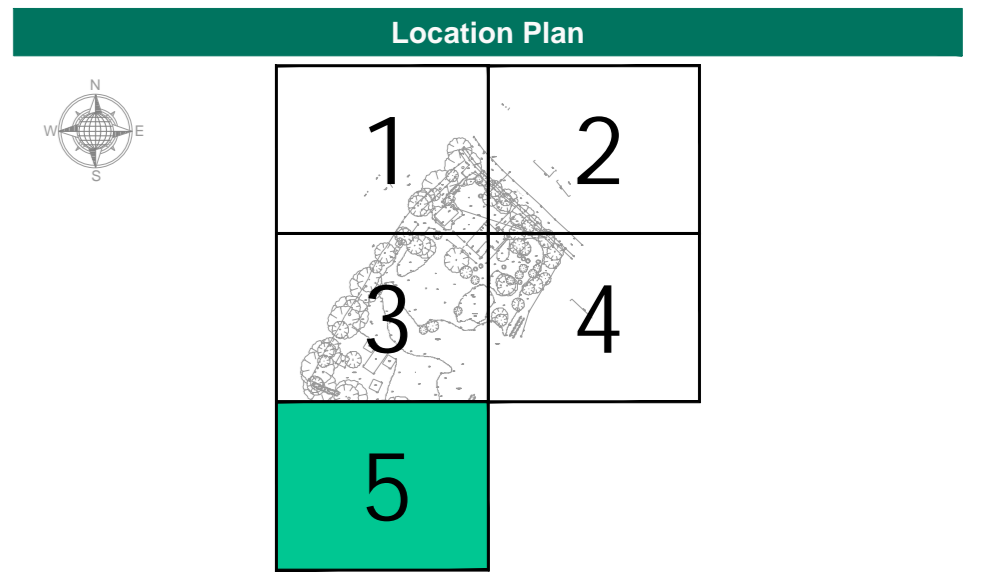

Revisions			
Rev	Description	Surveyed by	Checked by
A	First Issue	LL - 23/06/23	DK - 04/07/23



Geospatial certainty you can trust [murphygs.com](http://murphygs.com)



Client	LNT Construction Ltd
Project	The Towers, Clacton Road, Wessley Heath CO16 4J Utilities and CCTV surveys
Site Address	Clacton Road, Clacton-on-Sea, CO16 9EF
Description	Underground Utility Survey(PAS128)
Survey Grid	Localised OSGB36(15) - Scale Factor 1.0
Survey Datum	GNSS - Ordnance Datum Newlyn (ODN)
RICS Band	Band E
Drawing Scale	1:100 @A0
Drawing Number	MGS53500-U-AII-05

**PLEASE NOTE:**

Topographical plan and Utility assets records supplied by client.