

Roof Plan - Proposed

1:750

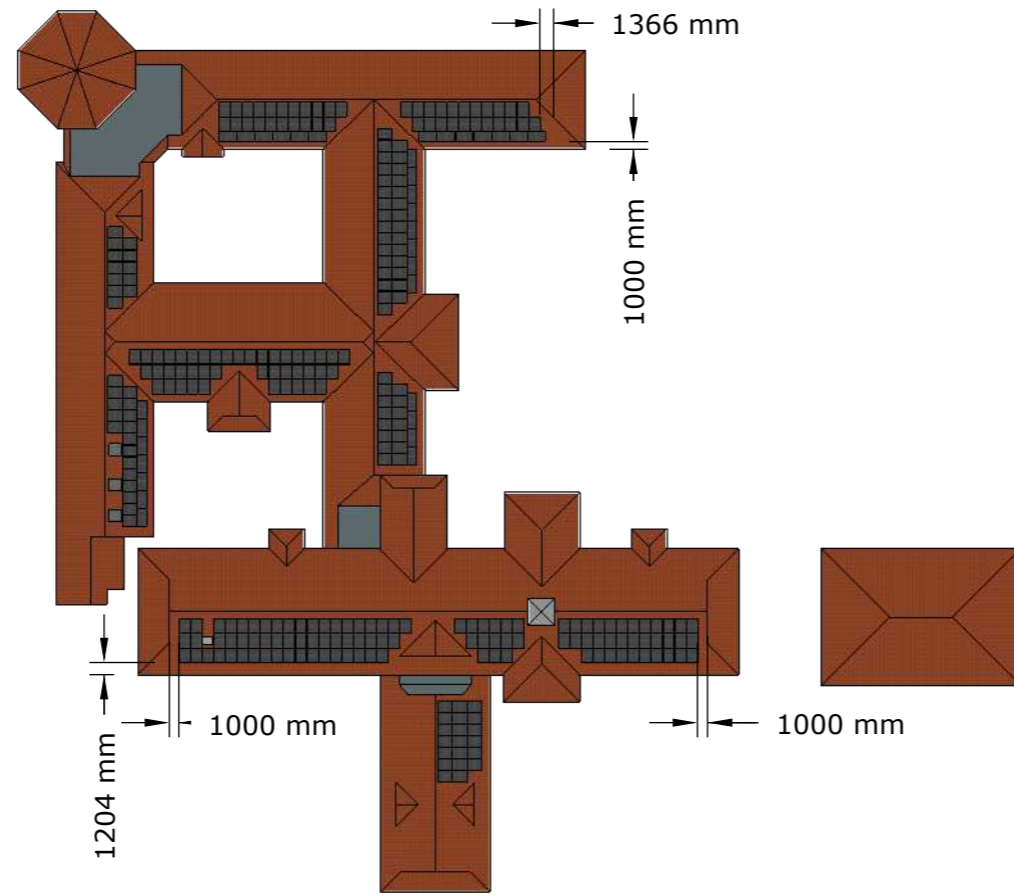

Roof Plan - Existing

1:750

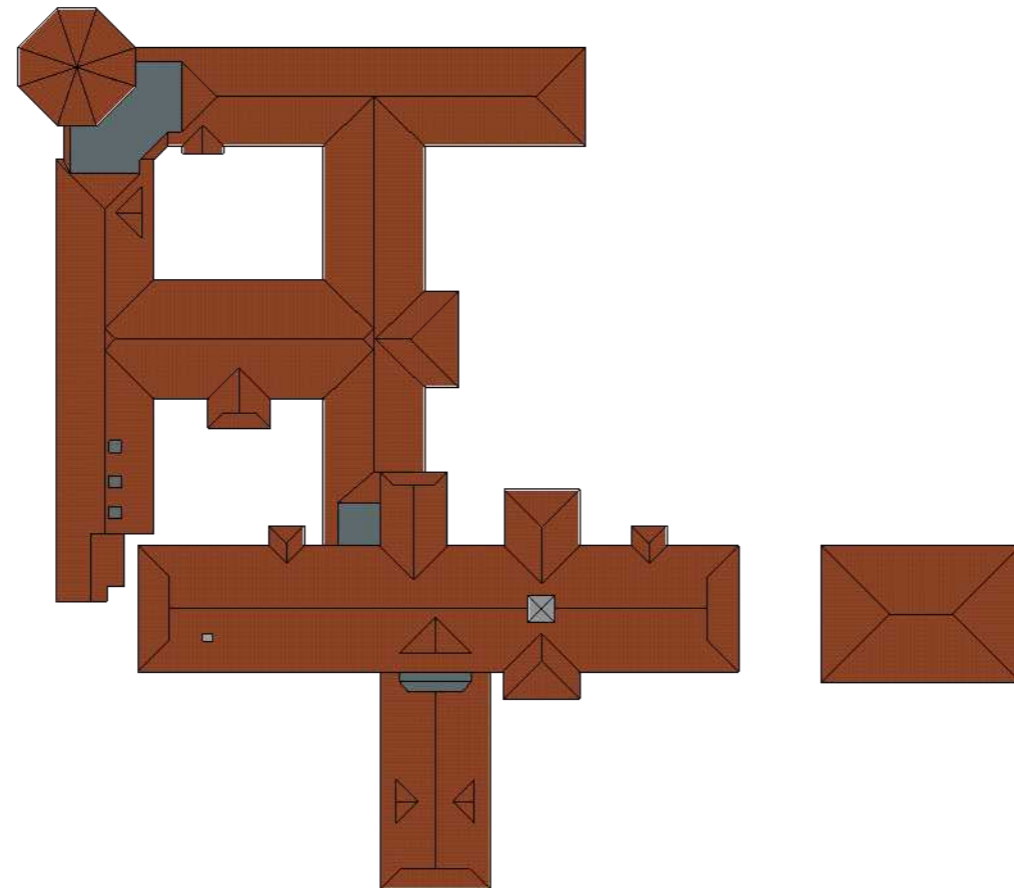

Spirit Energy

44 Portman Road, Reading, Berkshire, RG30 1EA
Telephone: 01189514490 Fax: 01189514499

SITE

Littlemore Mental Health Centre
OX4 4XN

DESCRIPTION

Roof Plan
Proposed and Existing

CLIENT

Oxford Health NHS Foundation Trust
Littlemore Mental Health Centre
Sandford Road
Oxford
OX4 4XN

DATE 22/06/2022	SCALE 1:750@A3
------------------------	-----------------------

DRAWN CN	DRAWING NO. 31435-1-3	REV A
-----------------	------------------------------	--------------