

*For the purposes of Planning Consent the following applies to any copy of this drawing made by the Local Authority:

This copy has been made by and with the authority of the person required to make the plan and drawing open to public inspection pursuant to Section 47 of the Copyright, Designs and Patents Act 1988. Unless that Act provides a relevant exception to copyright, the copy must not be copied without the prior permission of the copyright owner. If any copy is made under the authority only the whole drawing including the copyright holder's name and this notice, is to be copied.*

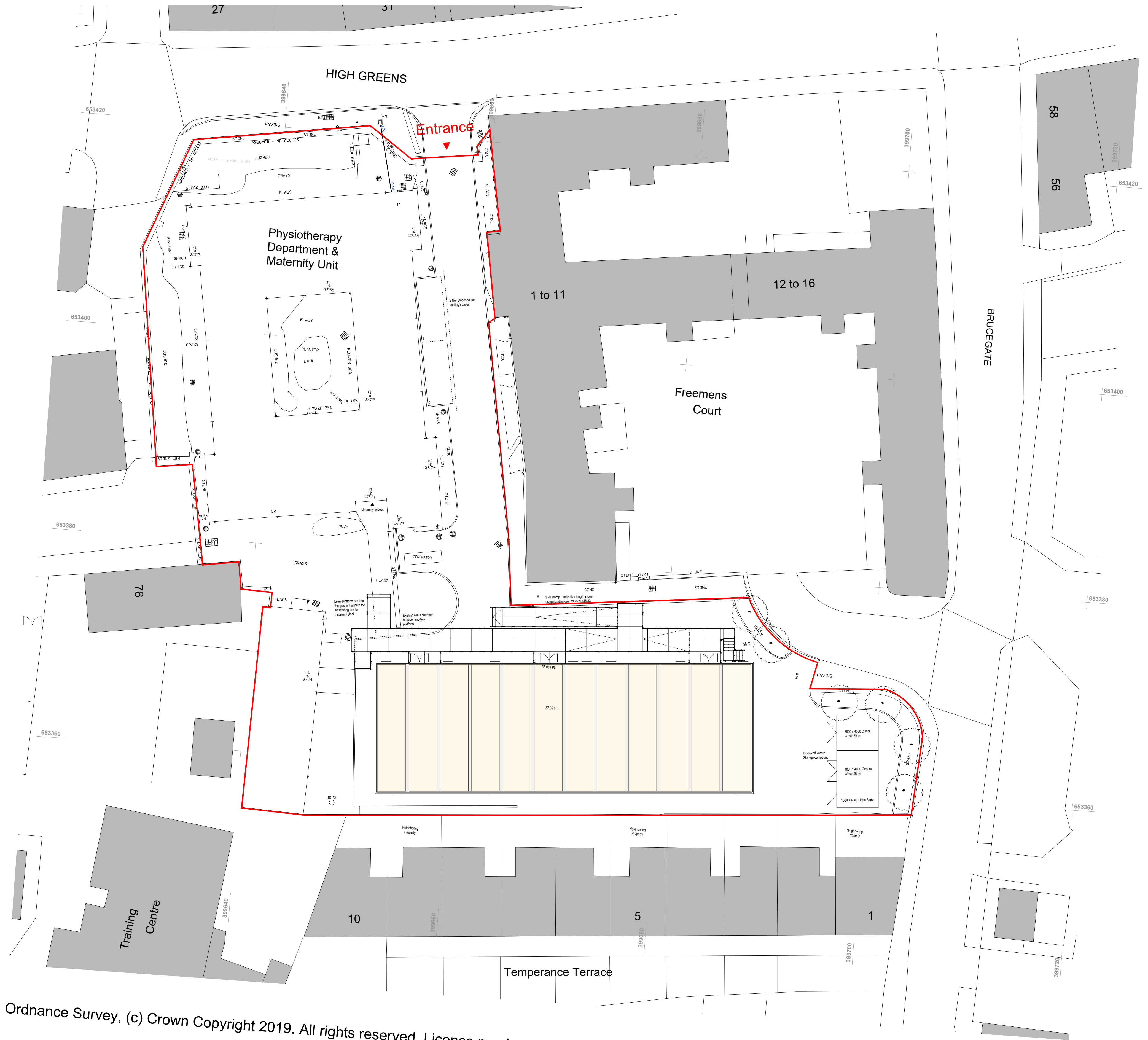

NOTE : Ramp setting out to be confirmed on receipt of Rapid Ramps drawings. Existing boundary to be defined and agreed prior to manufacturer and installation.

P07 : 21.09.23 : Access Ramp Manufacturers design overlaid onto proposed site plan SWL JA
 P06 : 06.09.23 : Access ramp Design finalised. Storage compound added. x2 Car parking bays added SWL JA
 P05 : 21.06.23 : Topo survey overlaid, access ramps amended to suit site levels. SWL JA
 P04 : 13.06.23 : Building entrance access ramps added to site plan SWL JA
 P03 : 09.06.23 : Building footprint updated to reflect existing module sizes/modular grid. SWL JA
 P02 : 25.04.23 : Additional module added to building SWL JA
 P01 : 24.04.23 : First issue MA JA

Rev: Date: Description: By: Auth:

P+HS
architects

a. The Old Station
Station Road
Stokesley
TS9 7AB
e. Stokesley@pandhs.co.uk
t. 01642 712 684
w. www.pandhs.co.uk

Client:
Premier Modular Ltd

Project No: 3715
Project Name: Berwick Temporary Ward Block

Project	Originator	Functional	Spatial	Form	Discipline	Number
NHFBTW	- PHS	- XX	- XX	- DR	- A	- 90002

Proposed Site Plan

Status Code	Description	Revision Code
S2	INFORMATION	P07

Created By: SWL
 Authorised By: JA
 Date of first issue: 16.06.2023
 Scale at A1: 200

This document is © P+HS Architects. If in doubt ASK. Drawing measurements shall not be obtained by scaling. Verify all dimensions prior to construction or product manufacture. Immediately report any discrepancies on this document to the Architect. This document shall be read in conjunction with associated models, specifications and related consultants documents.

Ordnance Survey, (c) Crown Copyright 2019. All rights reserved. Licence number 100022432

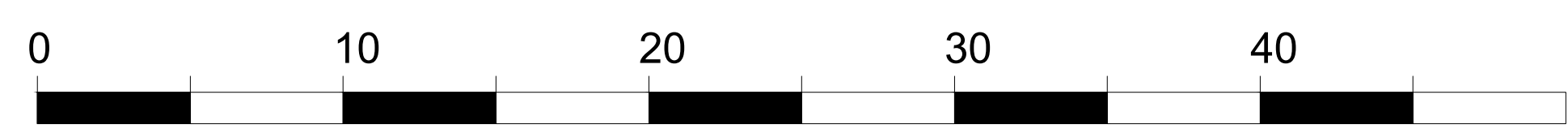

Scale: 1,200