

**PERMEABLE PAVING PRIVATE SHARED DRIVE/CARPARKING CONSTRUCTION DETAIL**  
SCALE 1:10

**NOTE:**  
SUB-BASE FORMATION LEVEL OF PERMEABLE PAVING TO HAVE NOMINAL FALL (1in100)

- GENERAL**
- DO NOT SCALE THIS DRAWING. ALL DIMENSIONS ARE IN MILLIMETERS UNLESS OTHERWISE NOTED. ANY DISCREPANCIES ARE TO BE RECORDED AND REPORTED TO THE ENGINEERS IMMEDIATELY.
  - THIS DRAWING IS TO BE READ IN CONJUNCTION WITH ALL OTHER ENGINEERS AND ARCHITECTS DRAWINGS AND THE SPECIFICATION.
  - ALL WORK IS TO BE TO THE SATISFACTION OF THE ENGINEER AND LOCAL AUTHORITY BUILDING CONTROL.
  - THE CONTRACTOR IS RESPONSIBLE FOR AND MUST TAKE ALL NECESSARY PRECAUTIONS TO ENSURE THE STABILITY OF THE WORKS AT ALL TIMES DURING CONSTRUCTION.
  - ALL WORKMANSHIP AND MATERIALS ARE TO BE TO CURRENT BRITISH STANDARDS.
  - ALL SERVICES ARE TO BE LOCATED AND PROTECTED AS NECESSARY BY THE CONTRACTOR PRIOR TO THE COMMENCEMENT OF THE WORKS.
  - ANY EXISTING DETAILS WHICH ARE SHOWN ON THIS DRAWING ARE FOR GUIDANCE ONLY AND ARE TO BE CHECKED ON SITE BY THE CONTRACTOR. ANY VARIATIONS ARE TO BE RECORDED AND REPORTED TO THE ENGINEER IMMEDIATELY.
  - ALL HIGHWAY WORKS ARE TO BE IN ACCORDANCE WITH THE LOCAL AUTHORITIES DESIGN GUIDE AND SPECIFICATION.
  - PRIOR TO THE OCCUPATION OF THE FIRST DWELLING, STREET NAMEPLATES SHALL BE ERECTED IN ACCORDANCE WITH THE HIGHWAY AUTHORITY AND TO THE WORDING AGREED WITH THE PLANNING AUTHORITY.
  - DURING CONSTRUCTION WORKS ON SITE, ALL ROADS AND FOOTPATHS ARE TO BE SWEEPED AND KEPT CLEAR OF OBSTRUCTIONS, THIS IS TO INCLUDE EXISTING HIGHWAYS AS APPROPRIATE TO ENSURE SAFE PASSAGE OF ALL ROAD USERS.
  - PROVISION SHALL BE MADE FOR THE INSTALLATION OF ALL MAINS SERVICES INCLUDING DUCTING PRIOR TO THE LAYING OF THE ROAD BASE-COURSE.
  - ALL ROAD MARKINGS AND SIGNS ARE TO BE IN ACCORDANCE WITH 'THE TRAFFIC SIGNS REGULATIONS AND DIRECTIONS' 2016.
- FOR DETAILS AND SPECIFICATION FOR SOFT LANDSCAPING, GRAVEL, TIMBER EDGINGS, COBBLES, KNEE RAILS ETC. - REFER TO LANDSCAPE ARCHITECT

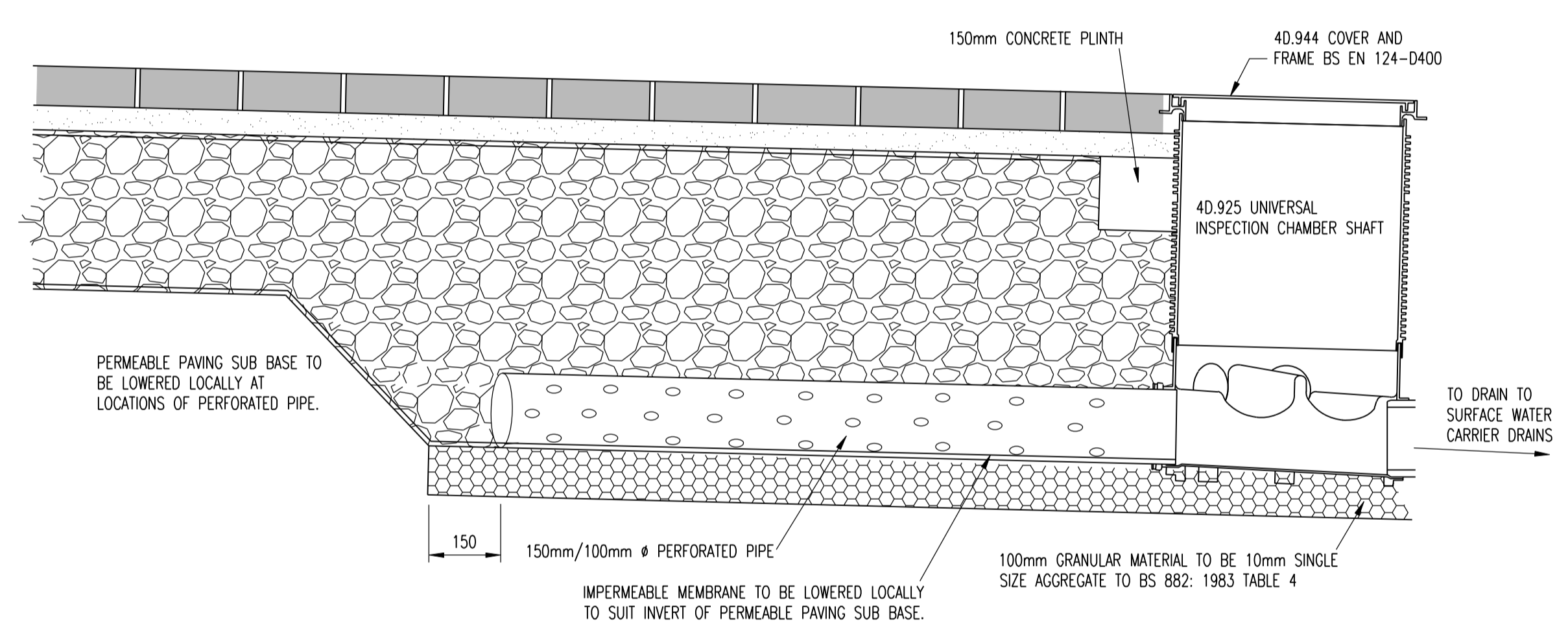

**DRAINING OF PERMEABLE PAVING SUB BASE DETAIL**  
SCALE 1:10

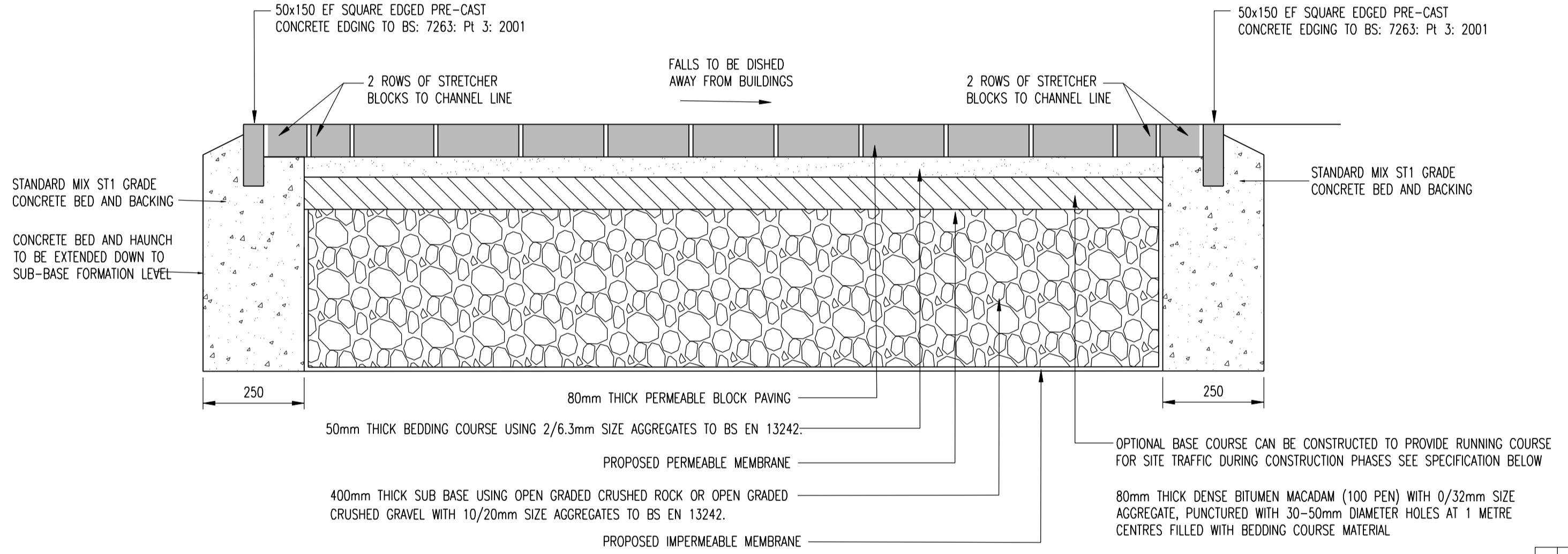

**PERMEABLE PAVING INDIVIDUAL PRIVATE DRIVE CONSTRUCTION DETAIL**  
SCALE 1:10

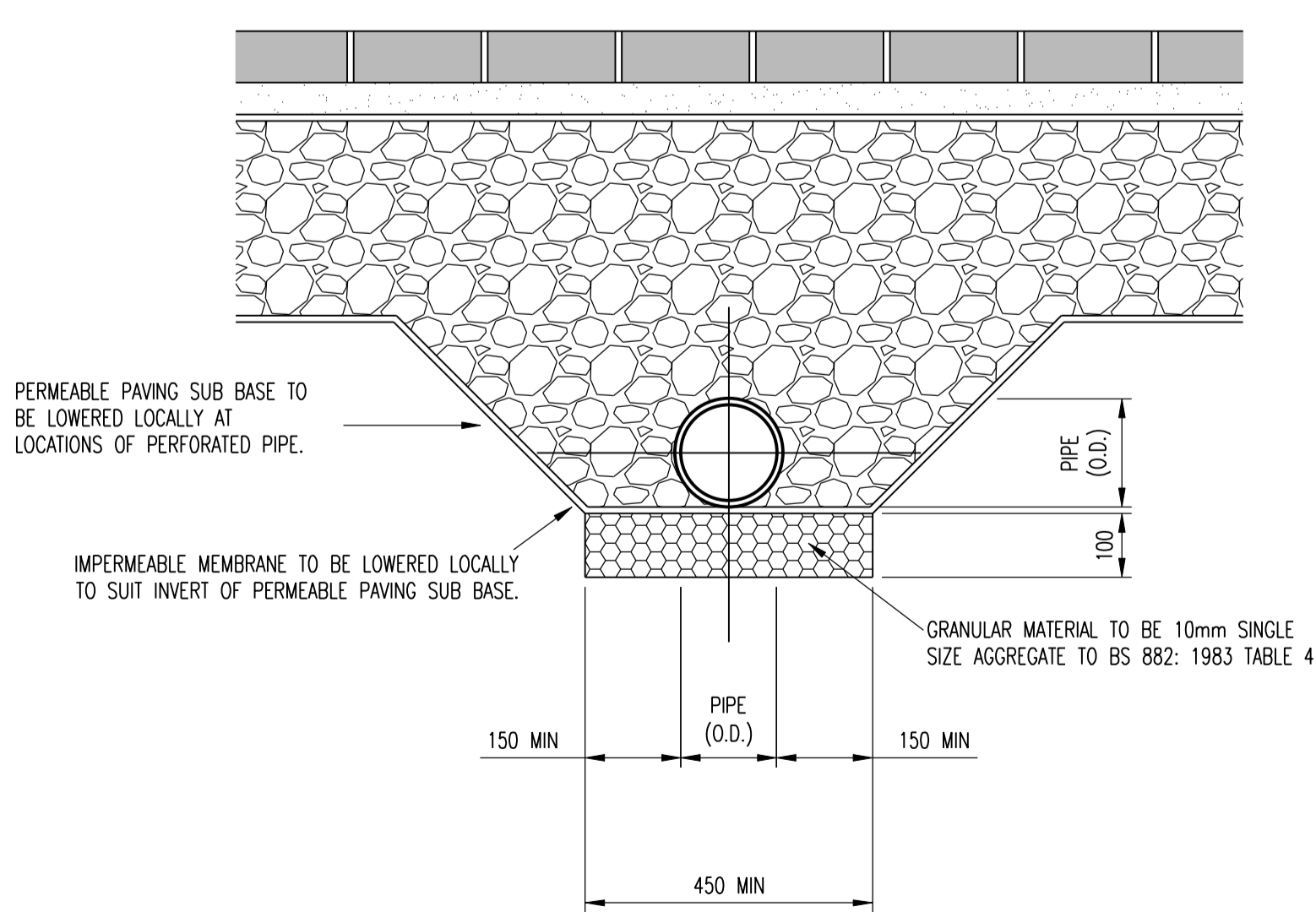

**PERFORATED PIPE BEDDING**  
SCALE 1:10

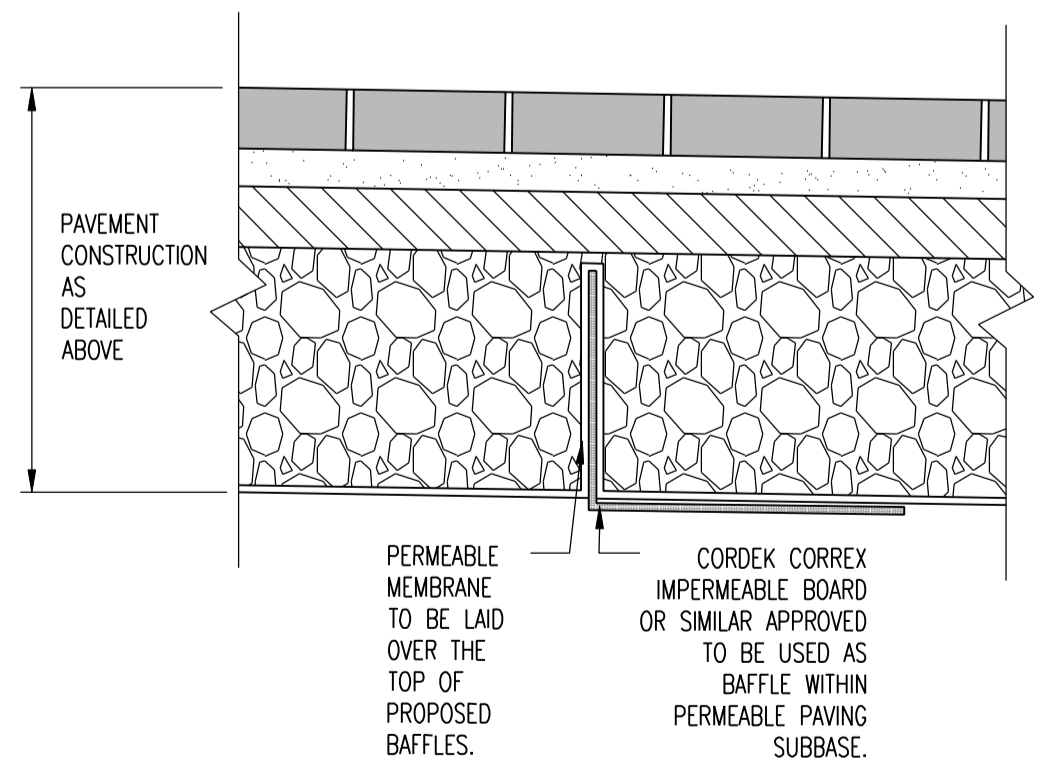

**PERMEABLE PAVING BAFFLE CONSTRUCTION DETAIL**  
SCALE 1:10

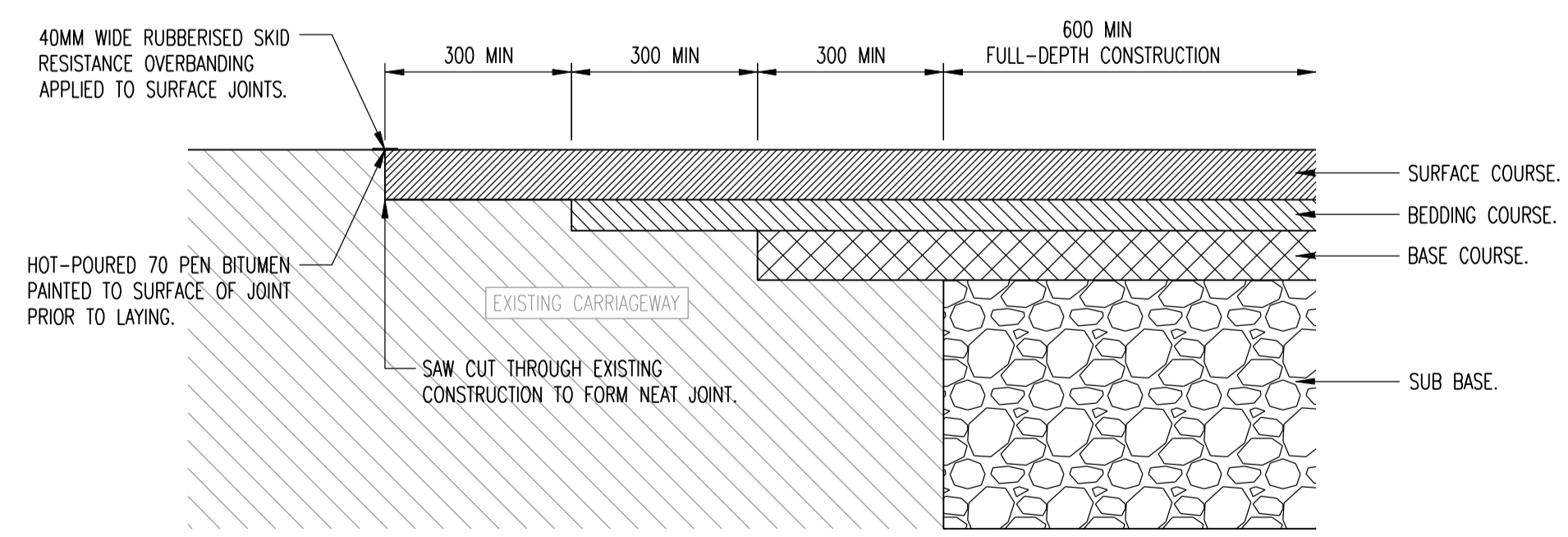

**TYPICAL CARRIAGEWAY TIE-IN TO EXISTING CARRIAGEWAY DETAIL**  
SCALE 1:10

Rev	Revision Notes	LB	RGW	30.06.23
A	CARRIAGEWAY TIE IN DETAIL ADDED			

**INGENT**  
CONSULTING ENGINEERS  
Unit 10 Brightwell Barns, Waldringfield Road, Brightwell, Suffolk, IP10 0BJ.

**PRELIMINARY**

Project:  
LAND REAR OF EAST HOUSE  
GREAT FINBOROUGH, SUFFOLK

Drawing Title:  
PRIVATE ROAD CONSTRUCTION DETAILS

Client:  
MCNAMARA DEVELOPMENTS

Date:  
JUN 2023

Drawn: LB  
Designed: LB  
Checked: RGW  
Approved: RGW

Scale:  
As Shown

Project No:  
2305-819

Drawing No & Revision:  
004A

Size:  
A1