

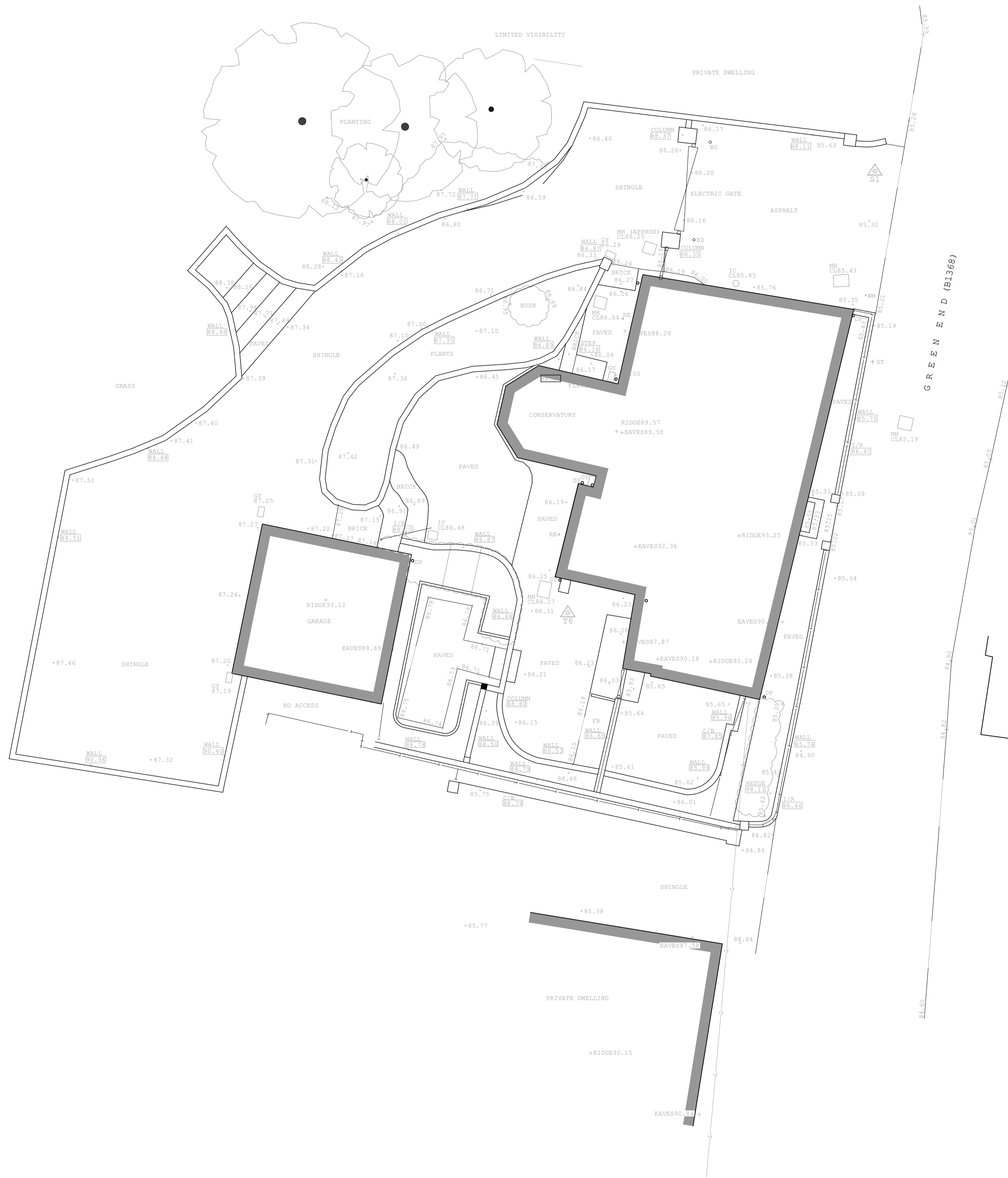

LOCATION PLAN
1/1250 @ A1



EXISTING SITE PLAN
1/100 @ A1

This drawing is for Planning purposes only.
All dimensions to be checked on site.

Notes

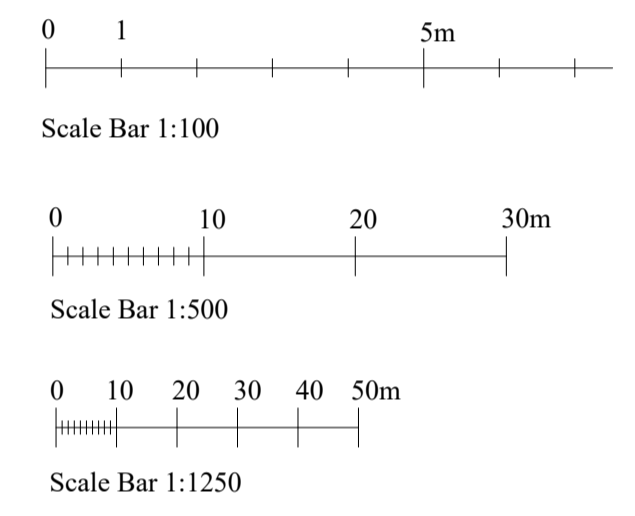

**IAN ABRAMS
ARCHITECT LIMITED**
5 The Matings, Station Road, Newport, Essex CB11 3RN
Telephone: 01799 543 533
Fax: 01799 543 653
e-mail: ian@abrams.uk.com
www.ian-abrams-architects.co.uk

Job title
Proposed Extension & Alterations to St. Annes, 17 Green End, Braughing, Herts SG11 2PG

Drawing title
Location Plan & Existing Site Plan

Scale	Date	Drawn
AS SHOWN @A1	25.07.23	TS & DU
Drawing No	Rev	
128223.01	-	

J:\2023\128223\128223_01_Existing Site Plan.dwg