

General Notes

SVP Soil Vent Pipe with rodding access

IPC Inspection Chamber

CD Channel Drain

PS Pumping Station

GU New Gully

ST New Silt Trap

Water Supply
25mm supply pipe laid at a depth of 750-1350mm to connect to private supply

Electricity Supply
Underground connection laid at a depth not less than 600mm from private supply

Foul Drainage
Upgrade existing Septic tank to Sewage treatment plant. Tricel UK18 suitable for 6 to 18 persons. Treatment plant with outfall to water course see engineer's and manufacturers details.
Foul to be brought from building to IPC via long radial bend 110mm. IPC to link to pumping station 110mm. Pumping station to link to water treatment plant with 63mm MDPE pipe. Soil vent stack (SVP) to be used above toilet outlet. SVP to have rodding access.

Rainwater
Upgrade existing gullies and connect to existing culvert. Gully's to be set in concrete. Renew all guttering to 112mm half round with 68mm downpipe. Install new silt trap. Channel drain to be installed in front of front door with minimum of 150mm either side of door opening.

Internal drainage
All internal drainage to be minimum of 40mm

63MM MDPE PIPE TO WATER TREATMENT PLANT

EXISTING CULVERT

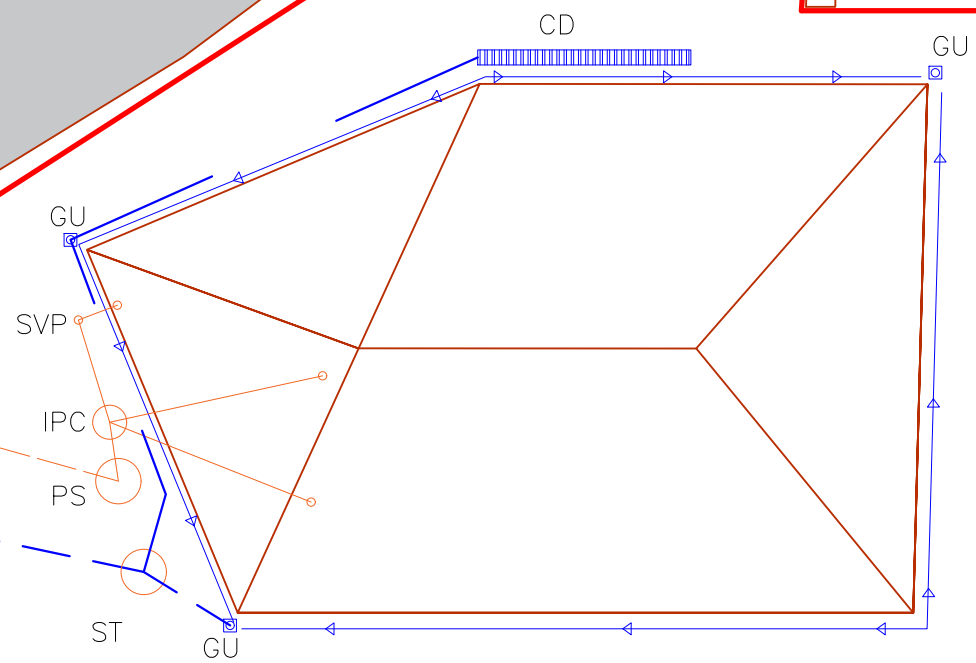

scale 1-100

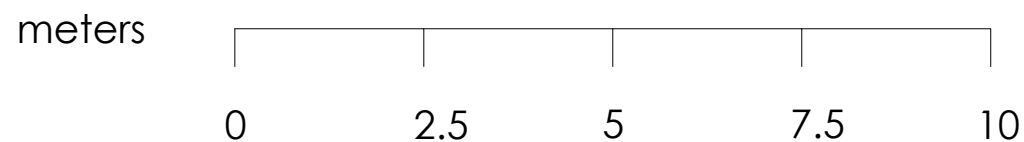

PLANNING

ANNA COULSON - PAGECROFT WORKSHOP, HAYDON BRIDGE, NE47 6JX
DRAINAGE 2 1:100 / A3
DWG NO. AC14 DATE: 08/02/2022 REVISION A

All information remains the property of the designer and may not be used for any purpose whatsoever, or reproduced through any medium without the permission of the designer. No responsibility is accepted for unauthorised used.
Do not scale off drawings. Work from figured dimensions only and verify on site.