

EXISTING SECOND FLOOR PLAN

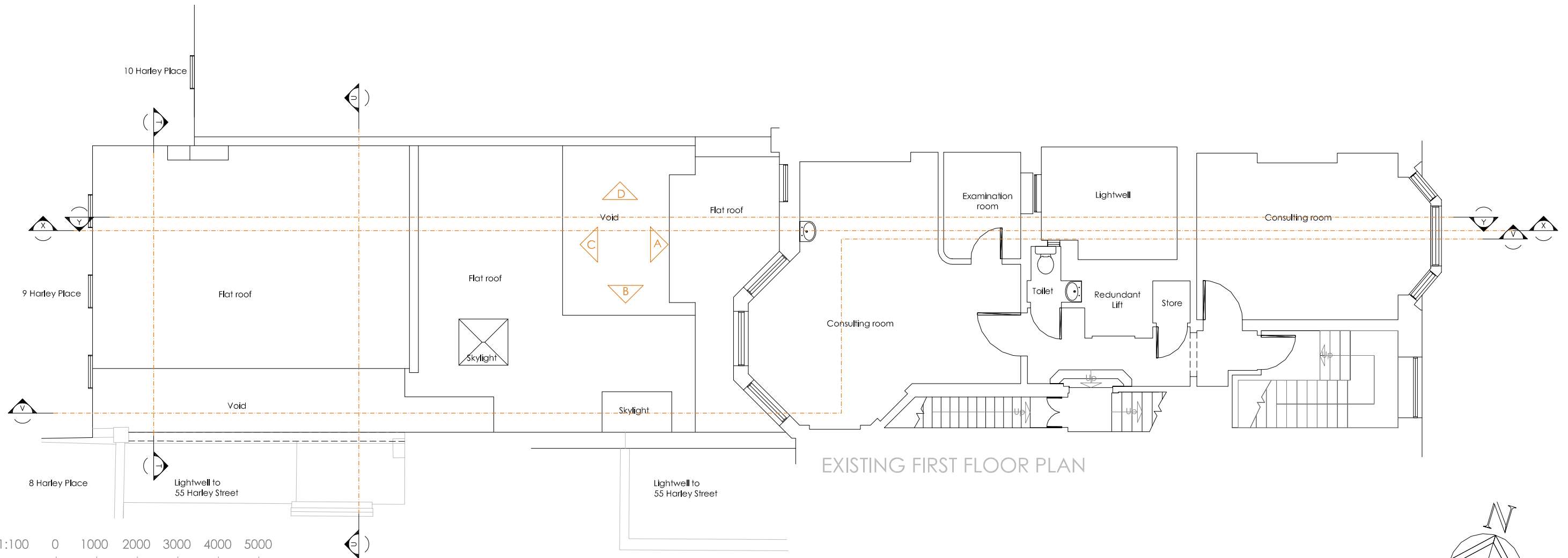

EXISTING FIRST FLOOR PLAN

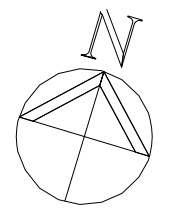
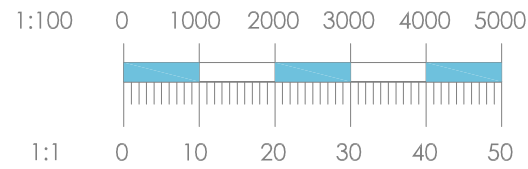

Copyright Andrew Neil Associates
Report all discrepancies to Andrew Neil Associates immediately.
All dimensions to be confirmed by the Contractor prior to commencement of the works.

Revisions	
No.	Description

Client: The Harley Street Hospital	Drawn: Existing First and Second Floor Plans	Project No: 22/05	ANDREW NEIL ASSOCIATES LTD CHARTERED ARCHITECTS AND DESIGNERS 27 HARLEY STREET LONDON W1G 9PL
Project: 57 Harley Street London W1 Proposed Rear Extension	Date: June 2022	Drawing No: PL-602	
Scale: 1:100 @ A3			