

One & a half brick pier either side bonded into wall

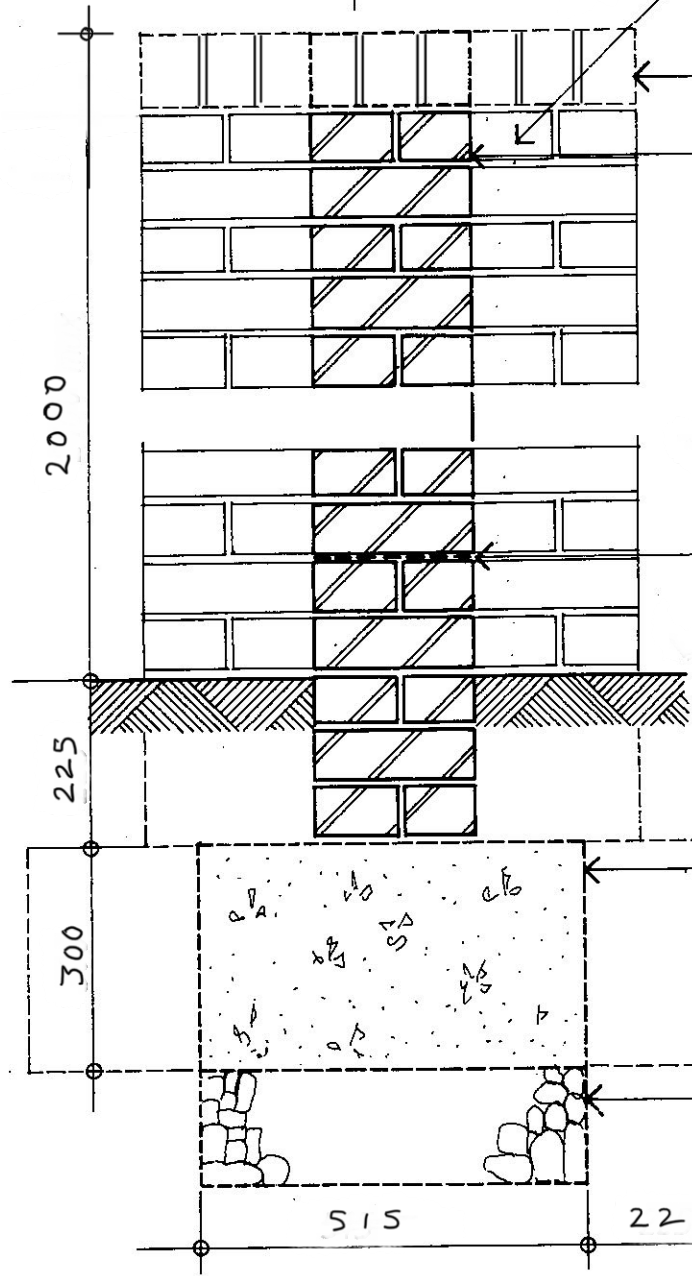

Brick on edge coping

One brick wall with bricks matched to existing house  
Flemish Double Bond

DPC

In-situ concrete strip foundation

Compacted subbase

Scale 1:10 @ A4

OLD VICARAGE  
Badmeh Ash  
Nr Bung St Eds. IP31 3DU.

PERIMETER WALLS  
Brick with piers.

DWG  
DEB-23-  
03