

Ground Floor Plan

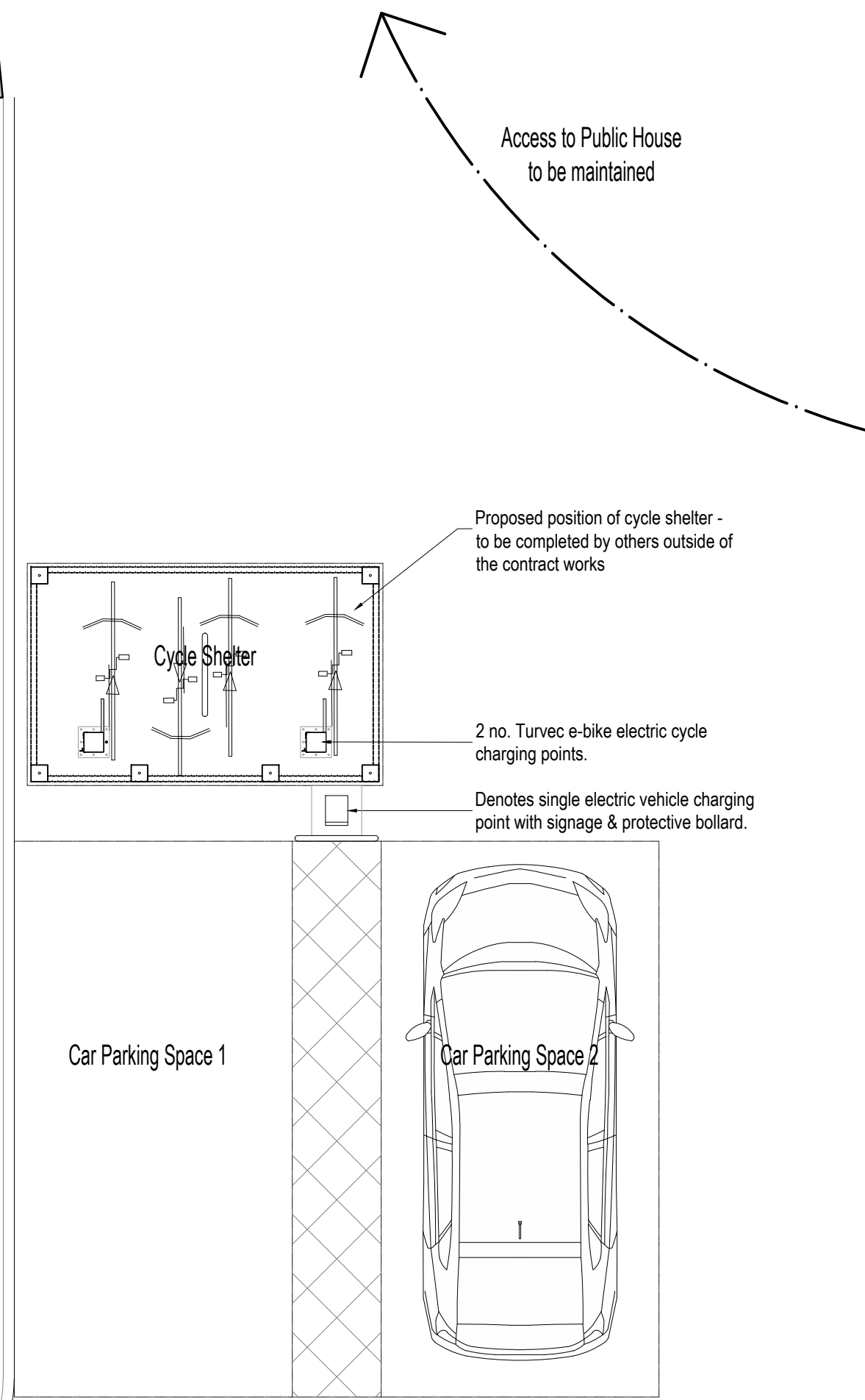

First Floor Plan

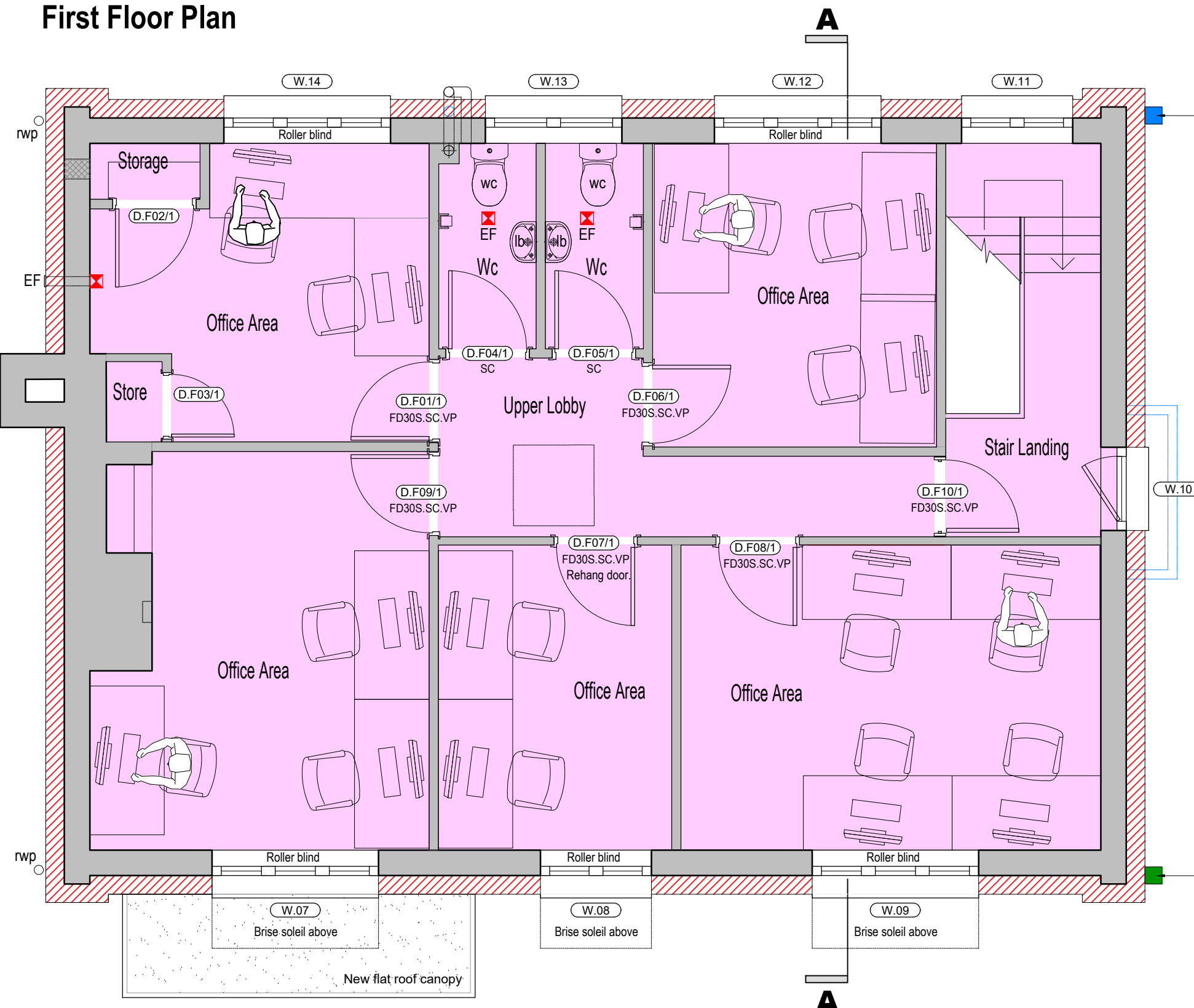

2 No F2 No FSC certified standard passerine timber nest boxes with a 32mm dia entrance hole. Location to face North to East, fixed 2-4m above the ground. Decorated to match the render colour.

2 No FSC certified timber single chamber bat boxes. Location to face South to South East, fixed 4-6m above the ground. Decorated to match the render colour.

Roof Plan

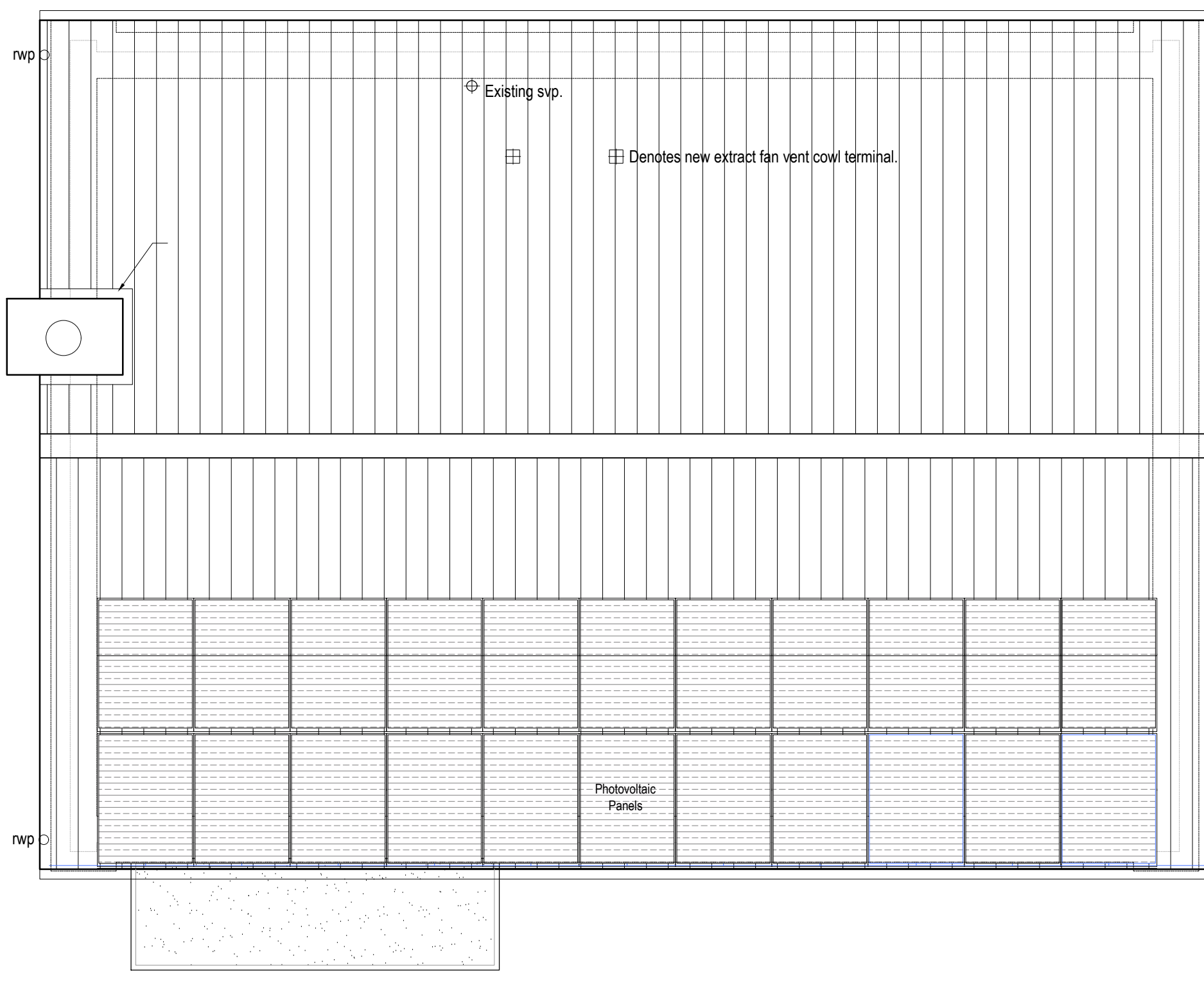

- NOTES**
- Walls & partitions:**
- Denotes existing walls to be retained.
 - Denotes existing walls to be removed & walls, floors & ceilings made good as necessary.
 - Denotes existing external walls to receive K Systems M Thin Coat external wall insulation system.
 - Denotes walls to receive a cavity drain membrane to a height of 1000mm & finished with a waterproof plaster & independent metal stud lining. Provide 12mm plywood pattress behind plasterboard to allow fixing of wall units, grab rails etc. Refer to Maljon Inspection Report Ref: 39931D dated 23.11.2021.
 - Denotes external walls to be drilled & injected forming a horizontal damp proof course. Refer to Maljon Inspection Report Ref: 39931D dated 23.11.2021.
 - Denotes external walls to be drilled & injected forming a vertical damp proof course. Refer to Maljon Inspection Report Ref: 39931D dated 23.11.2021.
 - New 100mm blockwork plastered both sides. (126mm total thickness)
 - New 47x97 timber studwork with 12.5mm plasterboard & skim to both sides filled with 65mm Isover Acoustic Roll APR1200 insulation. (126mm total thickness).
 - New 47x97 timber studwork with 12.5mm plasterboard & skim to both sides & 12mm OSB to one side filled with 65mm Isover Acoustic Roll APR1200 insulation. (138mm total thickness).
 - New 47x97 timber studwork with 12mm OSB & 12.5mm plasterboard & skim to both sides filled with 65mm Isover Acoustic Roll APR1200 insulation. (150mm total thickness).
- Door notes:**
- Denotes Town Council accommodation. (Yellow shade).
 - Denotes Shared facilities. (Blue shade).
 - Denotes Tenants accommodation. (Magenta shade).
 - Denotes Public Lobby. (Green shade).
- Door notes:**
- FD30S - 30 minute fire rated door with smoke seals.
 - FD30 - 30 minute fire rated door without smoke seals.
 - L - signage to indicate "fire door keep locked".
 - SC - positive door closer device to be fitted.
 - VP - leaf to incorporate glazed vision panel(s).
 - AC - door to be fitted with access control system (number lock).

27.09.2023	B	Non material amendment application	DS	KW
24.06.2021	A	Planning Issue	MP	KW
Date	Rev.	Descriptions	Drawn	Checked

barefoot & giles

Third Floor, Eidon House
2 Eidon Street, London, EC2M 7LS
Tel: 020 7422 7800

Nine Hills Road, Cambridge, CB2 1JT
Tel: 01223 653068

2 Cromwell Court, 16 St. Peters Street
Ipswich, Suffolk, IP1 1XG
Tel: 01473 252174

design@barefootgiles.com www.barefootgiles.com

Project	6 Cross Street, Eye Eco Renovation		
Client	Babergh & Mid Suffolk District Councils		
Drawing	Proposed Plans		
Scale & Format	1:50	@A1	Date
BGA Drawing No.	2159 DE 20-002	Revision	B
BIM Model File	-		
Drawing Status	PLANNING		

PROJECT NO.	STATUS	TYPE	DWG NO.
example 1234	SK = Sketch DE = Planning PI = Production Information	10- Site / External Plans 20- Floor / Roof Plans 30- Sections 40- Sections 50- Details 60- Schedules 70- Room Layouts	example 01

DISCLAIMER
This drawing was prepared for the Client, Project & Site stated below and for the purposes set out in the Project Particulars.
Barefoot & Giles Limited accepts no responsibility whatsoever should the drawing be used by any other person, on any other site or for any other purpose than those stated.
This drawing is to be read in conjunction with all relevant drawings and specifications.

WORK TO FIGURED DIMENSIONS ONLY. ALL MEASUREMENTS ARE TO BE CHECKED ON SITE AND ANY DISCREPANCIES REPORTED TO BAREFOOT & GILES LIMITED

© Copyright Barefoot & Giles Limited 2021

