

Proposed Site Plan 1:200

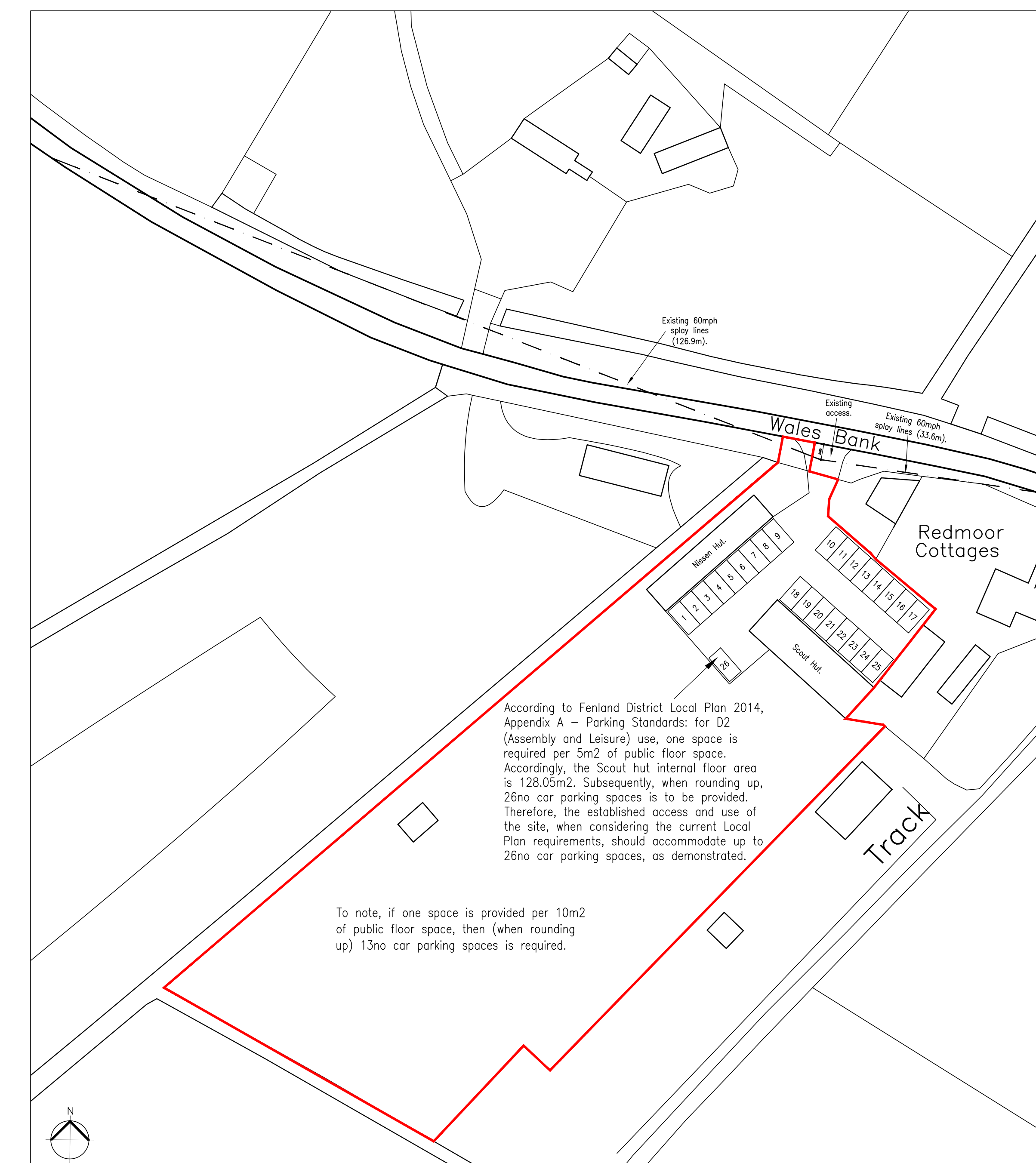
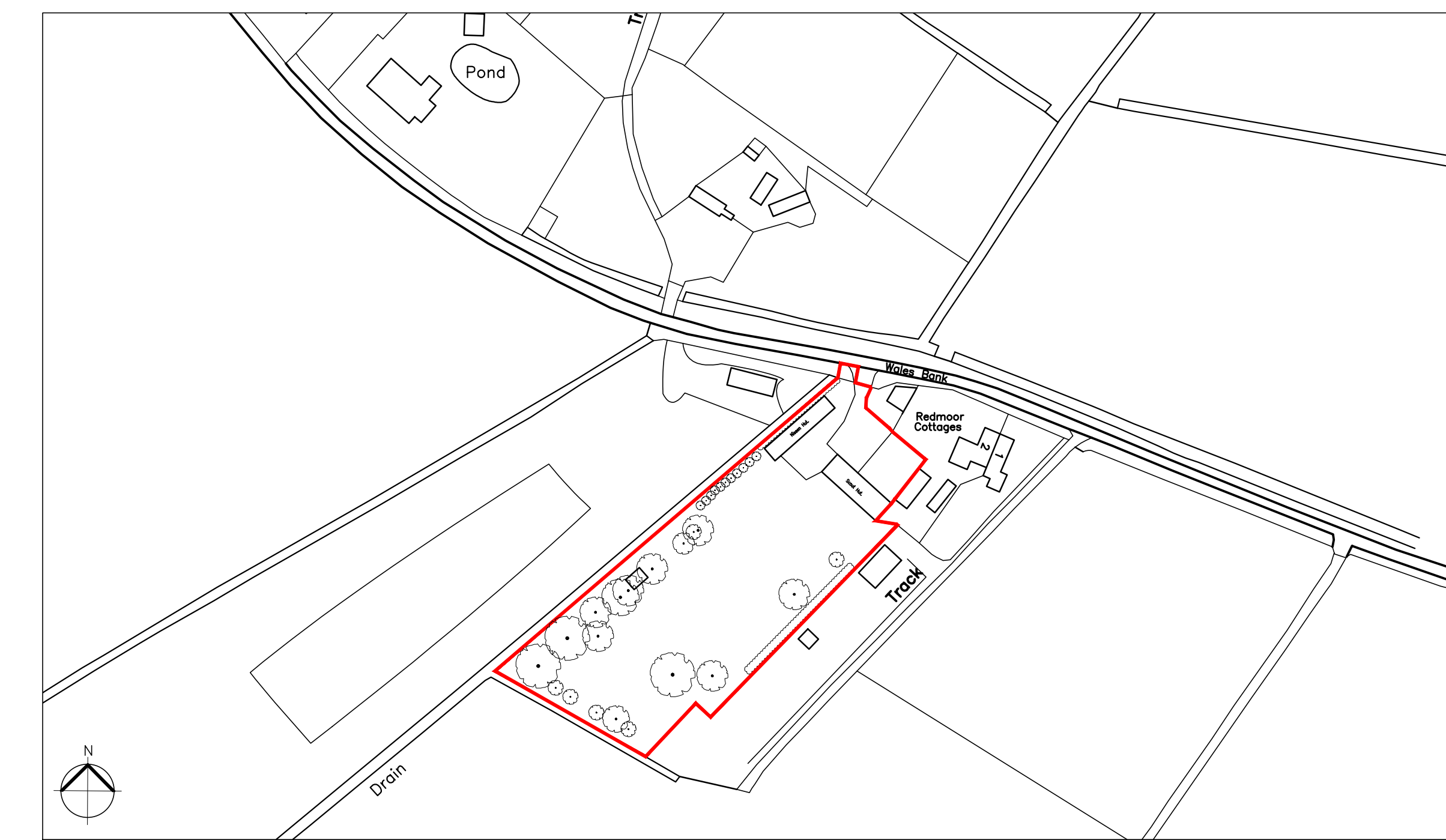

Existing Site Plan 1:500

C: 30 08 2023 - Ecology mitigation information  
 R: 15 08 2023 - Revised resident list proposal  
 6552/PL01C - After amendment

JOB NO.	PAPER SIZE	DATE
6552/PL01C	A0	AUG 2023

**Notes:**  
 This drawing is the property of Peter Humphrey Associates Ltd, and may not be copied, loaned or copied in whole or part without written consent.  
 All dimensions shown on the drawing are in millimeters unless stated otherwise. If the drawing is received electronically (PDF) it is the recipient's responsibility to ensure it is printed to the correct paper size. All drawings to be checked on site prior to commencing work and any discrepancies to be highlighted immediately.  
 The Construction (Design and Management) Regulations 2015.  
 Peter Humphrey Associates' form of appointment with the client confirms whether the agent is appointed as 'Designer' or 'Principal Designer' under these regulations. Nevertheless, the design phase has been carried out with due consideration for the safety during construction, occupation and maintenance of the finished project. No extraordinary hazards or risks were identified outside of the routine construction operations that would not already have occurred in a competent contractor.

**CLIENT**  
 Mrs C Wing

**PROJECT**  
 NEW DWELLINGHOUSE

**SITE**  
 SCOUT AND GUIDE HUT  
 WALES BANK  
 ELM  
 CAMBRIDGESHIRE  
 PE14 0AY

**DRAWING**  
 EXISTING & PROPOSED SITE PLAN

**PETER HUMPHREY ASSOCIATES**  
 ADDRESS: 2 CHAPEL ROAD, WISBECH, CAMBS. PE13 1RG.  
 TELEPHONE: 01945 456966  
 E-MAIL: info@peterhumphrey.co.uk  
 WEB: www.peterhumphrey.co.uk