

● TREES TO CUT

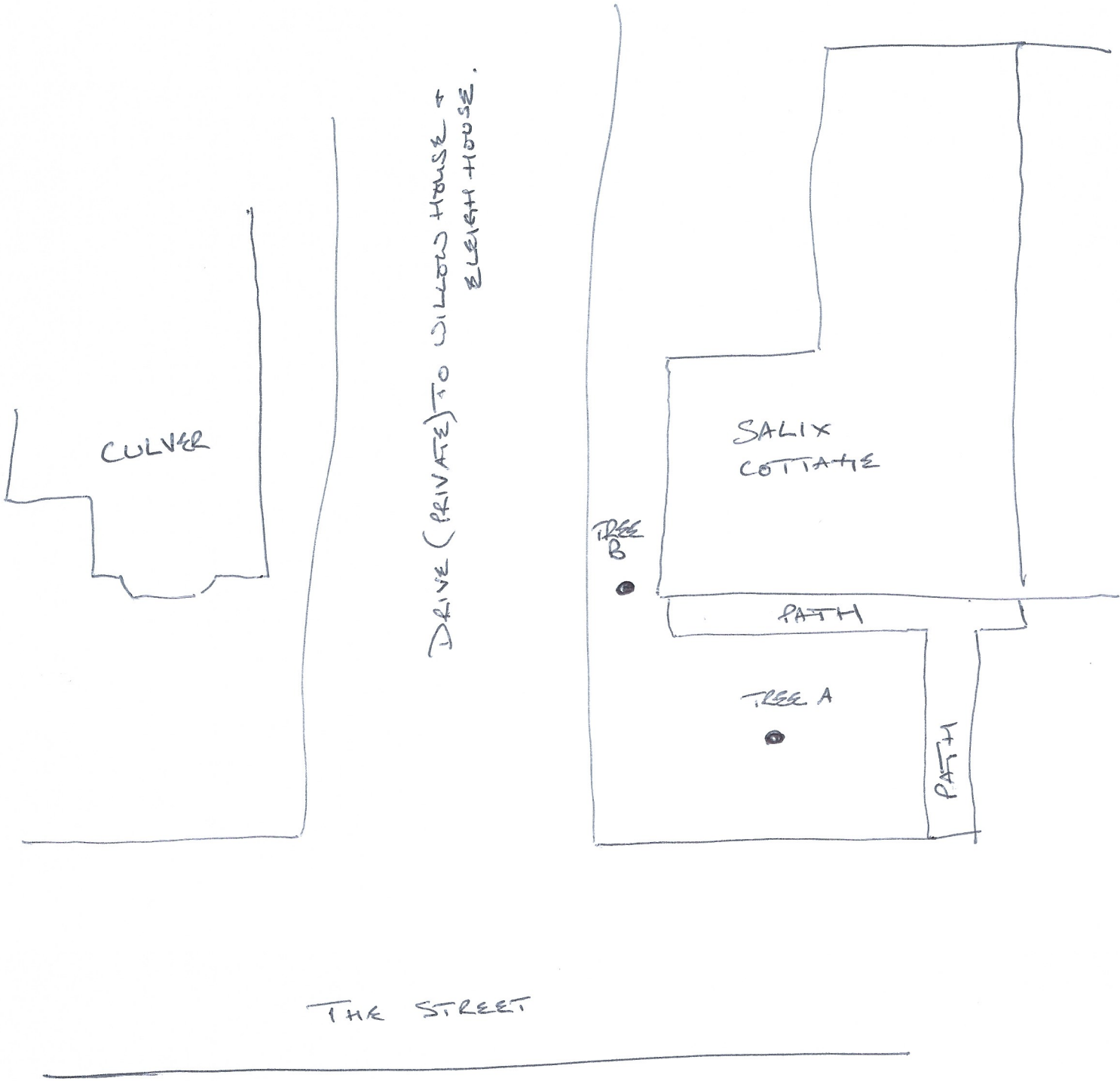

TREE A: NEEDS RESHAPING AS IT IS BRANCHING TOO CLOSE TO WINDOWS. PROXIMITY TO HOUSE ACCEPTED BY INSURERS, BUT ONLY JUST!

TREE B: MUST BE REMOVED AS IT IS JUST A FOOT FROM FOUNDATIONS AND WALLS. SUBSIDENCE RISK AND NOT 'INSURANCE' COMPLIANT.

9/18/2023

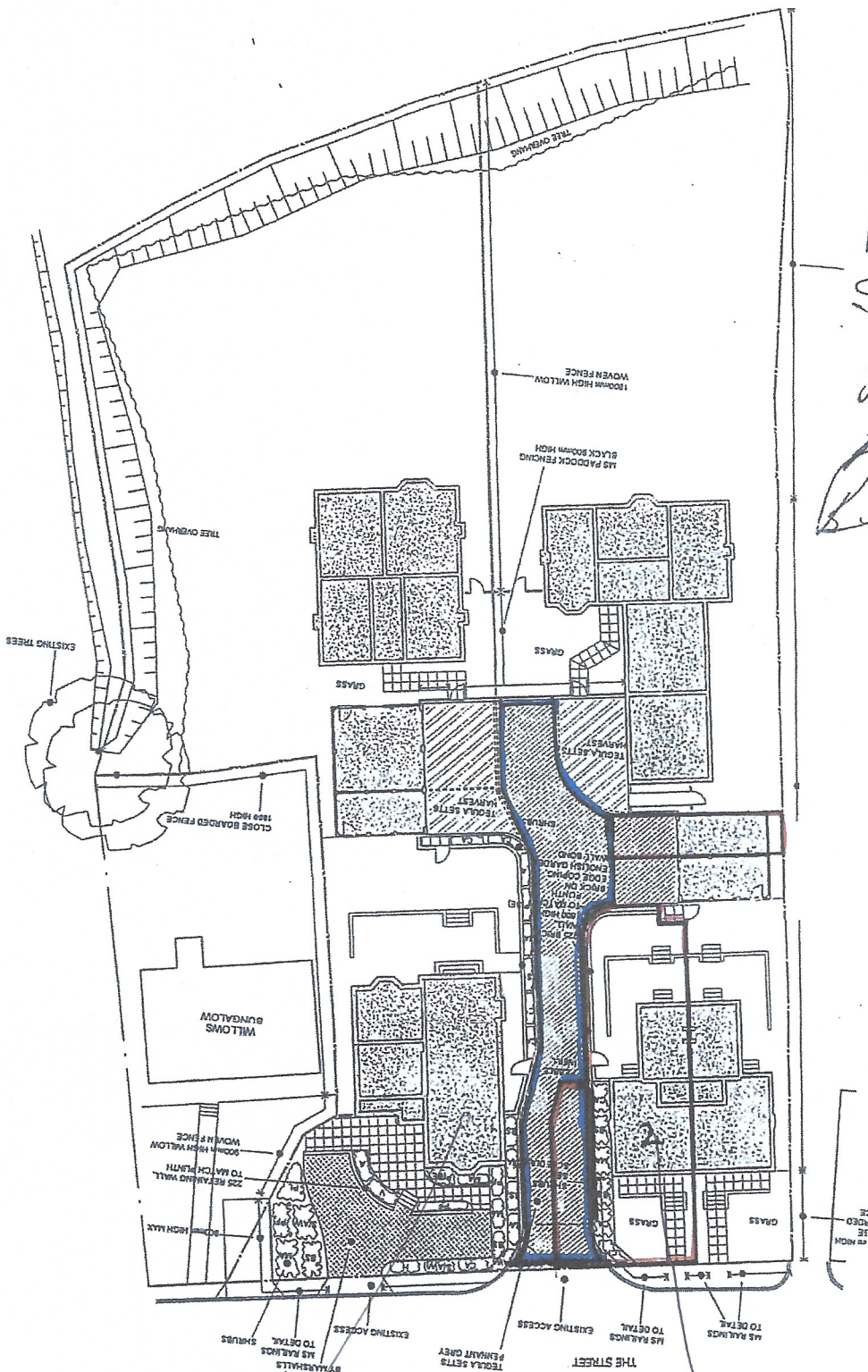

P. K...
 S.A. ...
 [Handwritten signatures]

Scale 1/200

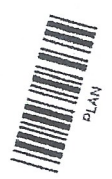

CULVER

SALIX COTTAGE