



Proposed North Elevation  
1 : 50



Proposed South Elevation  
1 : 50

**General Notes**

The copyright of this drawing and design remains the intellectual property of the designers and may not be used without the written permission of Great Space Architecture Limited. Do not Scale. Verify all dimensions on site before commencing work or preparing shop drawings. Report any discrepancies, errors or omissions to the designers and await further instructions before the commencement of works. All building materials, components and workmanship to comply with the appropriate public health acts, building regulations, British standards, codes of practice and the appropriate manufacturer's recommendations. Ensure all works are carried out by competent person. Refer to the relevant drawings or method statement for all specialist work.

**Materials:**

1. Slate
2. Brick
3. Existing UPVc windows and doors
4. Oak frame
5. Proposed Timber frame windows and doors

**KEYPLAN:**

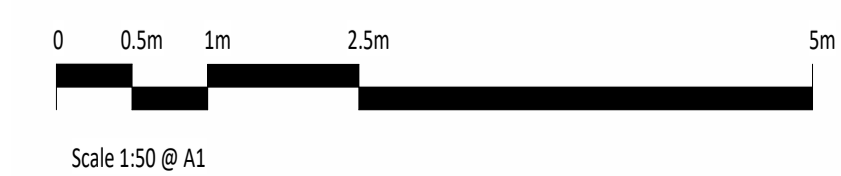
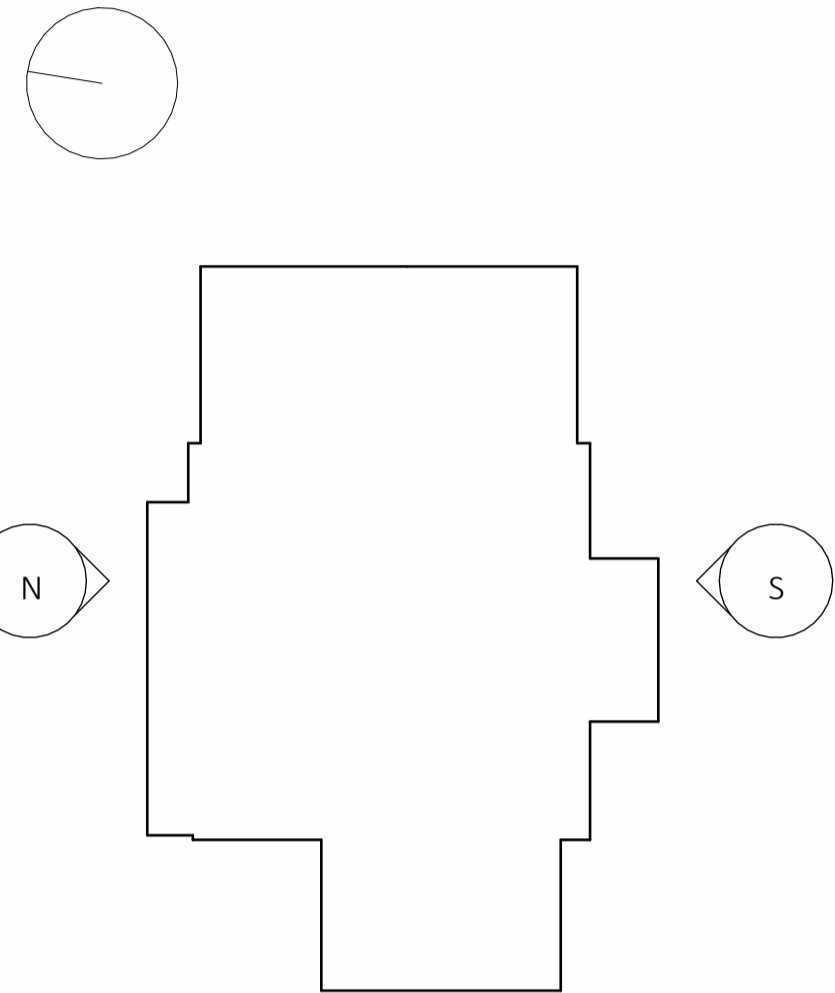

PO2	21.08.2023	Full Planning Submission
PO1	01.06.2023	PAE Submission
Rev	Date	Description

Project	Silver Hill House	Date drawn	14.03.2023
Drawn by	FF	Checked by	BK
Drawing Title	Proposed Elevations Sheet 2	Scale @ A1:	As indicated

<b>PLANNING</b> for illustrative purposes only				
Project	Origin	Volume	Level	
22_076	GSA	X	XX	
File type	Discipline	Sheet no	Stage	Rev
DR	A	20 004	S2	P02