

General Notes

The copyright of this drawing and design remains the intellectual property of the designers and may not be used without the written permission of Great Space Architecture Limited. Do not Scale. Verify all dimensions on site before commencing work or preparing shop drawings. Report any discrepancies, errors or omissions to the designers and await further instructions before the commencement of works. All building materials, components and workmanship to comply with the appropriate public health acts, building regulations, British standards, codes of practice and the appropriate manufacturer's recommendations. Ensure all works are carried out by competent person. Refer to the relevant drawings or method statement for all specialist work.

Materials:

1. Slate
2. Brick
3. Existing UPVc windows and doors
4. Oak frame
5. Proposed Timber frame windows and doors

KEYPLAN:

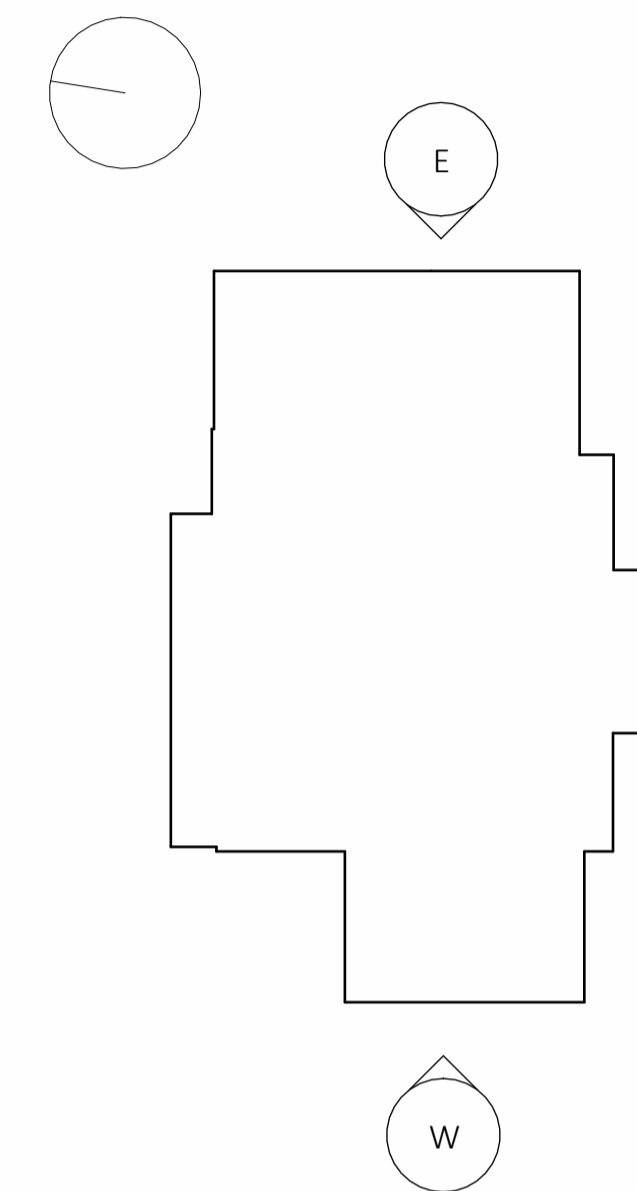

Existing East Elevation
1 : 50



Existing West Elevation
1 : 50

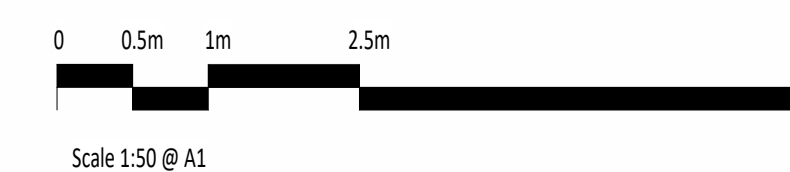

Rev	Date	Description
P02	21.08.2023	Full Planning Submission
P01	01.06.2023	PAC Submission

Project Silver Hill House	Date drawn 14.03.2023
Drawing Title Existing Elevations Sheet 1	Drawn by FF
	Checked by BK
	Scale @ A1: As indicated

PLANNING for illustrative purposes only				
Project	Origin	Volume	Level	
22_076	GSA	XX	XX	
File type	Discipline	Sheet no	Stage	Rev
DR	A	20 001	S1	P02

01434 394 220
info@greatspacearchitects.com
© Great Space Architecture Ltd.

Greatspace Architects

22/08/2023 12:58:16