

General Notes

The copyright of this drawing and design remains the intellectual property of the designers and may not be used without the written permission of Great Space Architecture Limited. Do not Scale. Verify all dimensions on site before commencing work or preparing shop drawings. Report any discrepancies, errors or omissions to the designers and await further instructions before the commencement of works. All building materials, components and workmanship to comply with the appropriate public health acts, building regulations, British standards, codes of practice and the appropriate manufacturer's recommendations. Ensure all works are carried out by competent person. Refer to the relevant drawings or method statement for all specialist work.

Materials:

1. Slate
2. Brick
3. Existing UPVc windows and doors
4. Oak frame
5. Proposed Timber frame windows and doors

KEYPLAN:

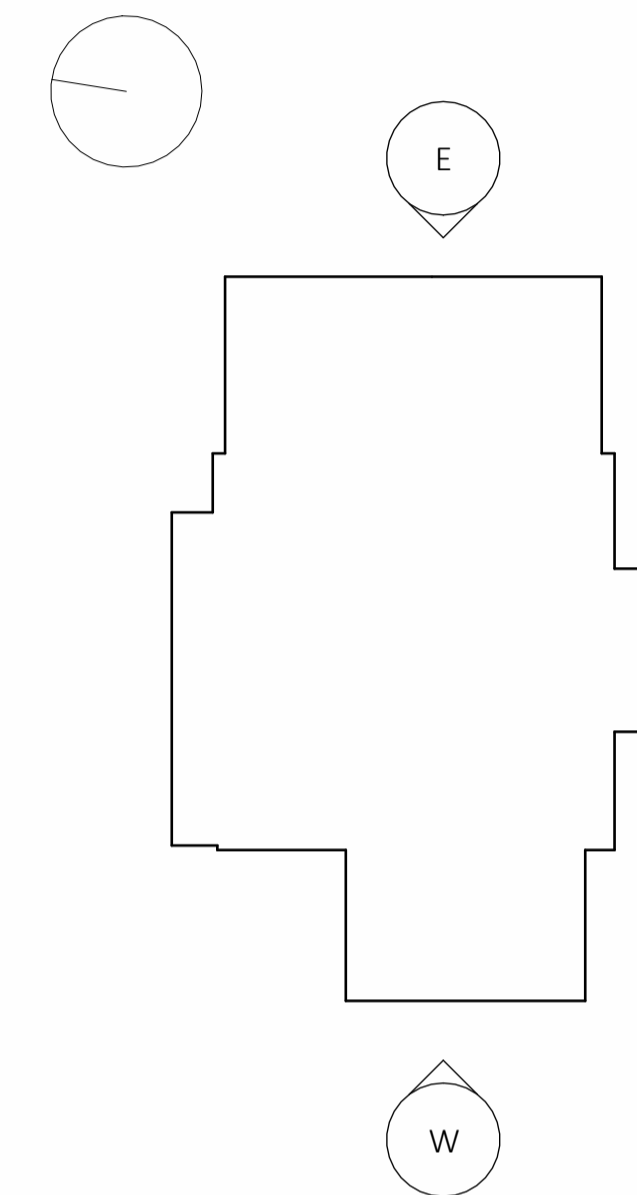

Proposed East Elevation
1 : 50



Proposed West Elevation
1 : 50

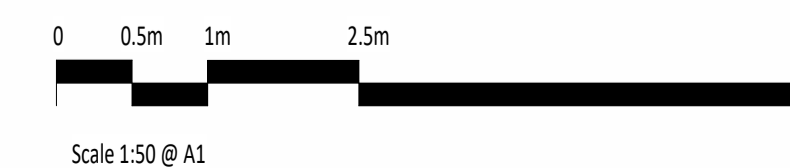

| | | |
|-----|------------|--------------------------|
| PO2 | 21.08.2023 | Full Planning Submission |
| PO1 | 01.06.2023 | P&E Submission |
| Rev | Date | Description |

| | | | |
|---------------|-----------------------------|-------------|--------------|
| Project | Silver Hill House | Date drawn | 14.03.2023 |
| Drawn by | FF | Checked by | BK |
| Drawing Title | Proposed Elevations Sheet 1 | Scale @ A1: | As indicated |

PLANNING
for illustrative purposes only

| | | | |
|-----------|------------|----------|-------|
| Project | Origin | Volume | Level |
| 22_076 | GSA | XX | XX |
| File type | Discipline | Sheet no | Stage |
| DR | A | 20 003 | S1 |
| | | | Rev |
| | | | P02 |

01434 394 220
info@greatspacearchitects.com
© Great Space Architecture Ltd.

Greatspace Architects

22/08/2023 12:28:50