

**General Notes**

The copyright of this drawing and design remains the intellectual property of the designers and may not be used without the written permission of Great Space Architecture Limited. Do not Scale. Verify all dimensions on site before commencing work or preparing shop drawings. Report any discrepancies, errors or omissions to the designers and await further instructions before the commencement of works. All building materials, components and workmanship to comply with the appropriate public health acts, building regulations, British standards, codes of practice and the appropriate manufacturer's recommendations. Ensure all works are carried out by competent person. Refer to the relevant drawings or method statement for all specialist work.

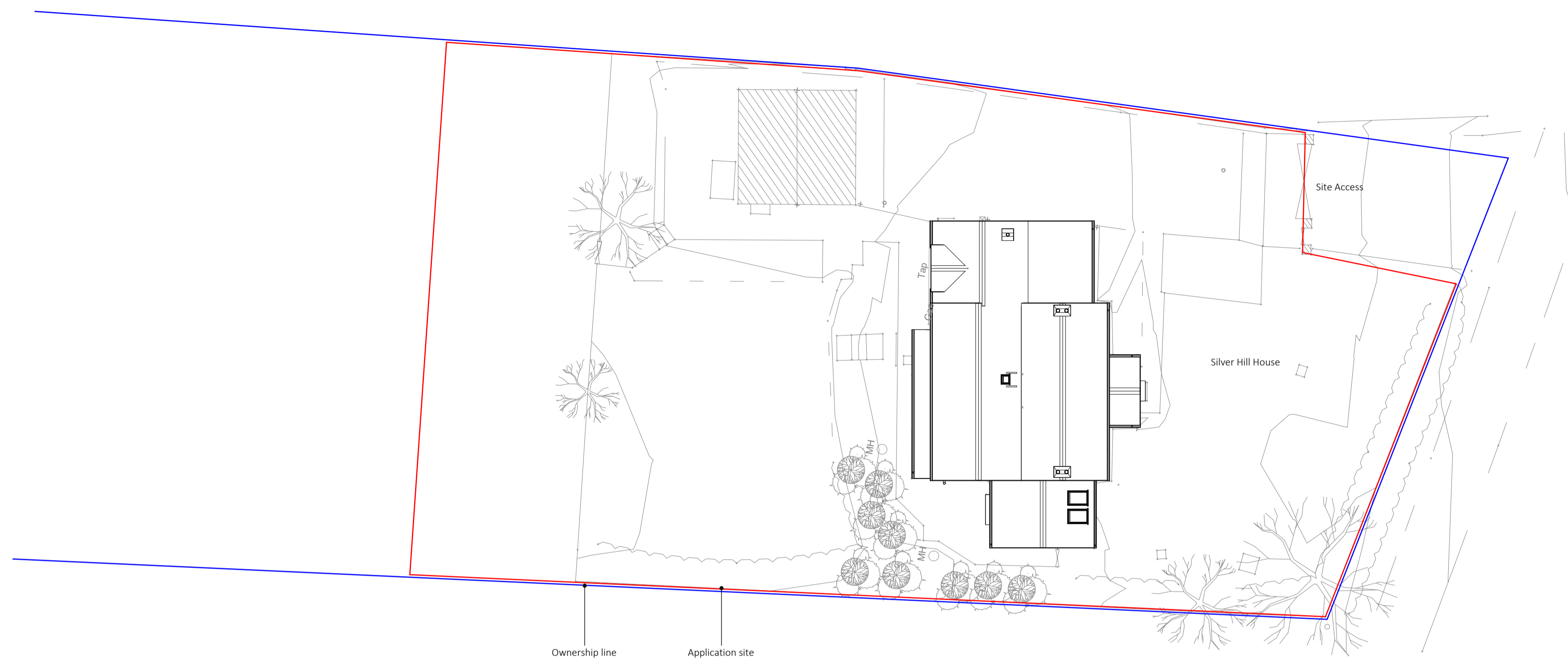

**Existing Site Plan**  
1 : 200



**Proposed Site Plan**  
1 : 200

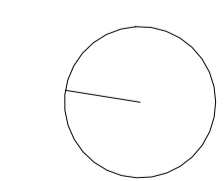
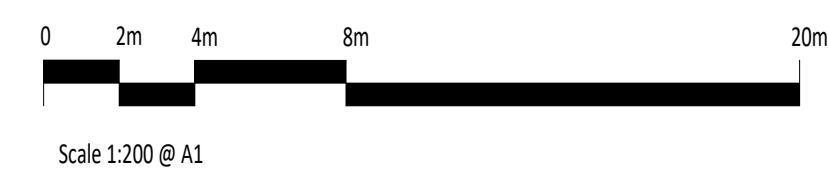

PO3	21.08.2023	Full Planning Submission
PO2	02.06.2023	PAE Update
PO1	01.06.2023	PAE Submission
Rev	Date	Description

Project	Silver Hill House	Date drawn	16.05.2023
Drawn by	FF	Checked by	BK
Drawing Title	Existing and Proposed Site Plan	Scale @ A1:	1 : 200

**PLANNING**  
for illustrative purposes only

Project	Origin	Volume	Level
22_076	GSA	XX	XX
File type	Discipline	Sheet no	Stage
DR	A	90 001	S2
			Rev
			P03

01434 394 220  
info@greatspacearchitects.com  
© Great Space Architecture Ltd.

**Greatspace Architects**

22/08/2023 13:57:24