

# PROPOSAL

NOTE: DO NOT SCALE OFF THIS DRAWING.  
ALWAYS WORK TO NOTED DIMENSIONS

LOCATION PLAN:

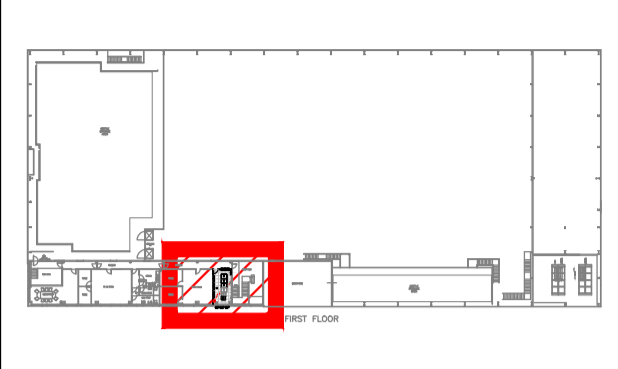

LEGEND:

- SP 32A INDUSTRIAL 32A SP&N COMMANDO SOCKET OUTLET
- 13A UNSWITCHED FUSED CONNECTION UNIT
- 16A TP&N ISOLATOR LOCATED WITHIN CEILING VOID

NOTES:

1. ALL CABLE LENGTHS ARE TO BE CHECKED AND MEASURED ON SITE BEFORE ORDERING.
2. WHERE SITE MEASURED CABLE LENGTHS EXCEED THE DESIGN LENGTHS PROVIDED, PLEASE INFORM THE ELECTRICAL DESIGN TEAM ASAP IN ORDER TO REVALIDATE THE DESIGN.
3. WHERE ELECTRONIC TRIP UNITS ARE TO BE USED, PLEASE REFER TO THE BREAKER SETTINGS SCHEDULE FOR MCCB MODEL NUMBERS AND BREAKER SETTINGS.
4. WHERE DESIGN DISCREPANCIES EXIST, THE INFORMATION CONTAINED WITHIN THE PROVIDED AMTECH DOCUMENTATION SHALL TAKE PRECEDENCE.
5. DISCREPANCIES SHOULD BE HIGHLIGHTED TO THE ELECTRICAL DESIGN TEAM AS SOON AS IDENTIFIED TO ALLOW DESIGN/AS FITTED INFORMATION TO BE UPDATED.
6. PLEASE REFER TO MANUFACTURERS DATA FOR REQUIRED TORQUE SETTINGS.
7. ALL SWA CABLE GLANDS TO BE CW TYPE. FOR CABLE DETAILS OF SUBMAIN CABLING PLEASE REFER TO CABLE SCHEDULE.
8. FOR CABLE DETAILS OF FINAL CIRCUITS PLEASE REFER TO DISTRIBUTION BOARD SCHEDULE.
9. WHERE CONTAINMENT IS INSTALLED INTERNALLY IT SHALL BE OF HOT DIPPED PRE-GALV CONSTRUCTION IN ACCORDANCE WITH BS EN 10346.
10. NEW CONTAINMENT SHALL COORDINATE WITH ALL NEW AND EXISTING SERVICES.
11. THE ELECTRICAL INSTALLATION SHALL BE DESIGNED, CONSTRUCTED, INSTALLED AND TESTED IN ACCORDANCE WITH THE 18TH EDITION AMENDMENT 2 OF THE IET WIRING REGULATIONS BS 7671 "REQUIREMENTS FOR ELECTRICAL INSTALLATIONS"
12. EXTERNAL LADDER RACK SHALL HAVE LIDDING FITTED THROUGHOUT ITS LENGTH

P01	PROPOSAL ISSUE	14/07/23	SE	AG
REV	DESCRIPTION	DATE	BY	CHK



SUDLOWS LIMITED  
DUCIE WORKS  
HULME HALL LANE  
MANCHESTER M40 8HH

TELEPHONE: 0800 783 5697  
FAX: 0161 205 0295  
EMAIL: CAD@SUDLOWS.COM  
WWW.SUDLOWS.COM

Client:



Site:

BELLSHILL

Status: PROPOSAL Scale: 1:25

Date Created: 07/07/23 Drawn By: SE Sheet Size: A1

Drawing Title:

SMALL POWER LAYOUT  
DC2  
FIRST FLOOR

Project No.: PR85150 Suitability: S3

Drawing No.: SUD-XX-01-DR-E-2001 Rev: P01

