

GENERAL NOTES:

- ALL DRAWINGS ARE COPYRIGHT OF NORTHERN STRUCTURAL SERVICES LTD.
- ALL DIMENSIONS TO BE CONFIRMED ON SITE.
- ANY REQUIRED DIMENSIONS TO BE TAKEN FROM ON-SITE MEASUREMENTS
- DO NOT SCALE FROM THIS DRAWING.
- THIS / THESE DRAWINGS TO BE READ IN CONJUNCTION WITH ALL RELEVANT ARCHITECTS & ENGINEERS DRAWINGS & DETAILS.
- ALL DIMENSIONS IN mm U.N.O.
- ALL LEVELS IN m U.N.O.
- SETTING OUT, INSULATION, DPM, FIRE-PROOFING, ACOUSTIC ISOLATION, EXTERNAL WORKS (LANDSCAPING), MASONRY COURSING, ETC TO ARCHITECTS DETAILS.
- CONTRACTOR TO ENSURE ALL CONSTRUCTION PRODUCTS HAVE APPROPRIATE CE ACCREDITATION & BBA CERTIFICATIONS ETC.
- ANY CONSTRUCTION WORK CARRIED OUT PRIOR TO RECEIVING ALL NECESSARY APPROVALS FOR PLANNING AND/OR BUILDING REGULATIONS, PARTY WALL NOTICES, WATER AUTHORITY APPROVALS ETC. IS ENTIRELY AT THE CLIENT'S / HOUSEHOLDER'S RISK.
- THE CLIENT AND CONTRACTOR TO BE AWARE OF THEIR RESPECTIVE DUTIES WITH REGARD TO CDM 2015. WHERE CLIENT / CONTRACTOR REQUIRES ADVICE OR IS IN DOUBT PLEASE DO CONTACT HSE (www.hse.gov.uk/construction/cdm) OR NORTHERN STRUCTURAL SERVICES. NORTHERN STRUCTURAL SERVICES ARE NOT APPOINTED AS THE PRINCIPAL DESIGNER UNLESS SPECIFICALLY AGREED OTHERWISE.
- THE CONTRACTOR SHALL INSPECT ALL ADJOINING PROPERTIES - WHEN APPLICABLE - WHICH MAY BE AFFECTED BY THE WORKS PRIOR TO COMMENCEMENT AND MUST REPORT ANY DEFECTS TO THE OWNER.
- IT IS THE CLIENT'S / HOUSEHOLDER'S RESPONSIBILITY TO FORMALLY NOTIFY ADJOINING OWNERS OF ANY POTENTIAL WORK THAT MAY AFFECT THEM UNDER THE PARTY WALL ACT 1996.

TEMPORARY WORKS

- CONTRACTOR IS RESPONSIBLE FOR THE TEMPORARY WORKS DESIGN, INCLUDING PHASING, INSTALLATION & MAINTENANCE
- ALL PROPPING IS TO BE CARRIED OUT FOLLOWING THE APPROPRIATE RISK ASSESSMENTS FOR THE SITE. ANY RISKS OR HAZARDS REVEALED DURING THE WORKS SHALL BE SUBMITTED TO THE SITE MANAGER TO BE EVALUATED.
- ALL PROPPING IS TO BE SECURED PRIOR TO REMOVAL OF SUPPORTING ELEMENTS.
- ALL OPERATIVES ARE TO BE TRAINED & SUPERVISED IN ACCORDANCE WITH THE PROJECT & BE FAMILIAR WITH PROPPING TECHNIQUES.

PROPRIETARY PRODUCTS

- ALL PROPRIETARY PRODUCTS TO BE INSTALLED IN ACCORDANCE WITH MANUFACTURERS DETAILS / RECOMMENDATIONS.
- IF PREFERRED, PRODUCTS FROM ALTERNATIVE SUPPLIERS MAY BE USED. CONTRACTOR TO ENSURE DESIGN REQUIREMENTS OF NEW PRODUCTS ARE EQUAL OR BETTER TO THOSE SPECIFIED BY ENGINEER.

LOAD BEARING MASONRY NOTES:

- ALL LOAD-BEARING BLOCKWORK (ABOVE DPC) 4.2N/mm²
- ALL LOAD-BEARING BLOCKWORK (BELOW DPC) 7.2N/mm²
- ALL LOAD-BEARING BRICKWORK MIN 7.2N/mm²
- ALL NEW MASONRY TO BE CONSTRUCTED WITH M6 (CLASS II) GENERAL PURPOSE MORTAR, U.N.O BY ENGINEER. OUTER LEAF MASONRY BELOW DPC TO USE SULPHATE RESISTING MORTAR.
- MOVEMENT JOINT (M.J.) TO BE PLACED AT MAXIMUM 6.0m-9.0m CENTRES IN UNREINFORCED BLOCKWORK, 12.0m-15.0m IN UNREINFORCED BRICKWORK AND AS PER MASONRY MANUFACTURERS DETAILS. FOR DETAILED MOVEMENT JOINT SPACING / DESIGN CONTACT ENGINEER.
- PROVIDE STRAPPING TO MASONRY AT JUNCTION WITH PARALLEL FLOORS, CEILINGS, FLAT ROOFS, GABLE END RAFTERS ETC. STRAPPING TO TAKE THE FORM OF 30x5 STAINLESS STEEL STRAPS PLACED AT 1500mm CENTRES (U.N.O). TAKE STRAP ACROSS 3No. JOISTS / 1.0m FOR PCU FLOORS
- FOR CAVITY WALL TIE SPECIFICATION REFER TO MASONRY DETAILS DRAWING.
- PROPOSED MASONRY TO HAVE 'EXECUTION CLASS 1' & 'MASONRY UNIT CATEGORY 1' U.N.O.
- ALL LOAD-BEARING MASONRY TO EN 1996-1-1:2005 (EC6) AND BS EN 771.
- ALL PROPRIETARY PRODUCTS E.G. LINTELS, WINDPOSTS, ETC TO BE INSTALLED IN ACCORDANCE WITH MANUFACTURERS DETAILS / RECOMMENDATIONS.

PADSTONE:

- ALL PADSTONES TO BE GRADE C50 CONCRETE TO EN 1992-1-1:2004 (EC2). ALTERNATIVELY FORM USING REINFORCED PRE-CAST CONCRETE LINTEL, CUT TO LENGTH.
- WHERE P215 IS DENOTED ALTERNATIVELY USE ENGINEERING BRICK OR CONCRETE COMMON.
- PADSTONE SIZES GIVEN ARE THE MINIMUM TO BE USED. LARGER SIZES MAY BE USED FOR EASE OF CONSTRUCTION.
- PADSTONE TO BE SOLIDLY EMBEDDED INTO NEW/EXISTING MASONRY USING M6 (CLASS II) GENERAL PURPOSE MORTAR.
- WHERE REQUIRED, MAKE GOOD EXISTING MASONRY BENEATH PADSTONE USING 'CLASS B' ENGINEERING BRICK
- STEELWORK TO HAVE MINIMUM 150mm (WHEN PARALLEL) OR FULL WIDTH (WHEN PERPENDICULAR) BEARING ONTO PADSTONES.

STRUCTURAL STEELWORK NOTES:

- INTERNAL STEELWORK WITHIN HEATED SPACES / INSULATION ENVELOPE TO BE MANUALLY CLEANED & CHECKED FOR DEFECTS.
- INTERNAL STEELWORK IN UNHEATED HEATED SPACES / OUTSIDE THE INSULATION ENVELOPE (E.G. PARAPETS, IN CAVITY ETC) TO BE BLAST CLEANED TO SA 2½. APPLY HIGH BUILD ZINC PHOSPHATE EPOXY PRIMER 120µm. ALTERNATIVELY THESE SECTIONS MAY BE HOT DIP GALVANIZED.
- WHERE SMALL AREAS OF STEELWORK PROJECT INTO CAVITY, SITE APPLY ADDITIONAL HIGH BUILD BITUMEN COAT 150µm.
- ALL EXTERNAL STEELWORK TO BE GALVANISED U.N.O
- ALL STEELWORK BELOW G.L. TO BE ENCASED IN 100mm CONCRETE & D49 WRAPPING MESH.
- POINTS ABOVE FOR GUIDANCE ONLY. ALL STEELWORK FINAL COATINGS IN ACCORDANCE WITH ARCHITECTS SPECIFICATION/BUILDING REGULATIONS.
- BASEPLATES TO BE FULLY GROUTED USING 1:1 [SAND:CEMENT] SLURRY OR PROPRIETY GROUT. SHRINKAGE COMPENSATED.
- ALL STEELWORK TO BE IN ACCORDANCE WITH BS:EN 1993-1-1:2005 (EC3) & THE LATEST EDITION OF THE NSSS (NATIONAL STRUCTURAL STEELWORK SPECIFICATION).
- ALL OPEN SECTIONS (UB / UC / PFC / RSA) TO BE GRADE S355JR TO BS EN 10025 U.N.O.
- ALL CLOSED SECTIONS (SHS / RHS / CHS / OHS) ARE TO BE 'TATA - CELCIUS 355' OR EQUIVALENT GRADE TO BS EN 1002. U.N.O.
- ALL BOLTS TO BE GRADE 8.8 TO BS:EN 1090 UNLESS STATED OTHERWISE BY ENGINEER.
- ALL BOLTS, NUTS & WASHERS IN ACCORDANCE WITH THE LATEST EDITION OF THE NSSS (NATIONAL STRUCTURAL STEELWORK SPECIFICATION)
- ALL WELDS TO BE 6mm CONTINUOUS FILLET TO BS:EN 1090 - FULL PROFILE UNLESS STATED OTHERWISE BY ENGINEER. ALL FULL & PARTIAL PENETRATION WELDS TO BE GROUND DOWN SMOOTH.
- ALL STEELWORK, FABRICATION, ERECTION, PROTECTION ETC TO BE IN ACCORDANCE WITH THE NATIONAL STRUCTURAL STEELWORK SPECIFICATION FOR BUILDING CONSTRUCTION.
- ALL STEELWORK TO BE C.E. MARKED AND FABRICATED TO EXECUTION CLASS 2 OR HIGHER TO BS:EN 1090
- FIRE PROTECTION REQUIREMENTS TO BE CONFIRMED BY ARCHITECT / B.C.O
- ALL CONNECTIONS TO HAVE 4No. M16 (GRADE 8.8) BOLTS & MIN 10mm (GRADE 275) MILD STEEL PLATE TO BS:EN 1090, U.N.O.
- ALL STEELWORK ASSUMED TO BE MILD STEEL (E.G. NOT STAINLESS STEEL, WITHOUT PRIOR CONSENT OF ENGINEER)
- WHERE STAINLESS STEEL IS USED, CONTRACTOR TO ENSURE A NEOPRENE LAYER IS PROVIDED BETWEEN MILD STEEL & STAINLESS STEEL TO AVOID BI-METALLIC REACTION.
- FABRICATION ENGINEER TO PROVIDE DIMENSION FABRICATION DRAWINGS FOR ENGINEERS APPROVAL. AN ALLOWANCE 10 WORKING DAYS SHOULD BE MADE FOR ENGINEERS CHECKS. THESE CHECKS ARE TO CONFIRM DESIGN INTENT BASED ON PROVIDED FORCES. DIMENSIONS, LEVELS, SETTING OUT, ETC WILL BE EXCLUDED.

TIMBER NOTES:

- ALL PROPRIETARY TIMBER - STEEL PRODUCTS E.G. CLIPS, BRACKETS & HANGERS ETC TO BE INSTALLED IN ACCORDANCE WITH MANUFACTURERS DETAILS / RECOMMENDATIONS.
- FOR TIMBER TO MASONRY HANGERS CONTRACTOR TO ENSURE SUFFICIENT MASONRY IS PROVIDED OVER, AS PER MANUFACTURERS DETAILS / RECOMMENDATIONS
- ALL TIMBER TO BE GRADE C16 TO BS:EN 1995-1-1:2004 U.N.O
- PROVIDE FULL DEPTH NOGGINS AT SUPPORT/BEARING POSITION. PROVIDE ADDITIONAL AT:
 - 1/3 & 2/3 SPAN TO ALL JOIST & RAFTERS > 4.0m.
 - MID-SPAN TO ALL JOIST & RAFTERS < 4.0m.
- WHERE NON-LOAD BEARING PARTITIONS RUN PARALLEL TO JOIST, DOUBLE UP JOISTS BENEATH. WHERE NON-LOAD BEARING PARTITIONS RUN PERPENDICULAR TO JOIST PROVIDE ADDITIONAL LINE OF NOGGINS BELOW.
- WHERE ENGINEERED JOISTS ARE USED, BLOCK & NOTCHING TO BE IN STRICT ACCORDANCE WITH SUPPLIERS REQUIREMENTS.
- NOTCHING OF TIMBER JOISTS IS TO BE AGREED WITH ENGINEER
- PROVIDE RESTRAINT STRAPPING AS PER NOTE (L.B. MASONRY NOTES) AND DETAIL, WHERE JOIST/RAFTERS RUN PARALLEL TO MASONRY PANEL.
- JOIST SIZE NOTED ON DRAWINGS ARE NORMALLY A MINIMUM - DEEPER SECTION MAY BE USED IF REQUIRED TO CONCEAL STEELWORK ETC.
- ALL TIMBERS TO BE PLACED WITH NATURAL BOW UPWARDS
- WHERE MULTIPLE TIMBER MEMBERS ARE SPECIFIED (E.G. TRIMMERS), FIX TOGETHER VIA M12 BOLTS (GRADE 8.8) & DOGTOOTH WASHERS @ MAX 600 (STAGGERED) CENTRES WITH MIN 40mm TOP & BOTTOM COVER / EDGE DISTANCE.
- TIMBER BLOCKING FIXED TO WEB OF STEEL MEMBER USING M10 BOLTS (GRADE 8.8) @ 600 CENTRES.
- BOLTS HOLES IN TIMBER TO BE CLOSE TOLERANCE. (I.E < 1.0mm LARGER THAN BOLT WIDTH)
- ALL NAILS, SCREWS, BOLTS & CONNECTOR PLATES TO BE ZINC PLATED OR GALVANISED.
- FIX JOIST HANGERS, FRAMING ANCHORS & TRUSS CLIPS TO TIMBER MEMBERS USING 30 x 3.75mm GAUGE GALVANIZED SQUARE TWIST NAILS THROUGH ALL HOLES.
- ALL BOLT FIXINGS THROUGH TIMBER MEMBERS TO BE PROVIDED WITH OVERSIZED TIMBER WASHERS OF AT LEAST 3 x BOLT DIAMETER.
- CONTRACTOR IS TO ENSURE TIMBER IS INSTALLED IN ACCORDANCE WITH BS:EN 1995-1-1:2004 (BS:EN 1995-1-1:2009 + A1:2008)
- ALL TIMBER TO BE PRESSURE INTEGRATED WITH PRESERVATIVE. ALL CUT ENDS TO BE BRUSH TREATED WITH PRESERVATIVE ON-SITE.
- ALL JOISTS TREATED FOR 'EXTERNAL USE' TO BE TANALISED TIMBER TREATED USING WATER-BASED ORGANIC PRESERVATIVE. E.G. TANALITH M 6305 OR EQUIVALENT.
- WHERE PRE-FABRICATED TRUSSES ARE USED, TRUSSES & LOOSE RAFTER INFILL TO BE DESIGNED, SUPPLIED & INSTALLED BY A SPECIALIST CONTRACTOR. PLAN ROOF BRACING TO BE PROVIDED IN ACCORDANCE WITH BS 5268-3, PD6693-1 AND NHBC CH.7. TRUSS MANUFACTURER TO ALLOW FOR FLOORS LOADS FROM APPROPRIATE USE.
- IT IS ASSUMED FLOORS WILL BE MINIMUM 22mm T&G FLOORING CHIPBOARD (TO ARCHITECTS SPECIFICATION) SCREWED DOWN TO JOISTS AT MAXIMUM 150mm CENTRES. CHIPBOARD FLOORING TO BE MOISTURE RESISTANT GRADE

WALLPLATE

- ALL TIMBER WALL PLATES TO HAVE AT LEAST 3.0m LENGTH & 300 LONG HALF-LAP JOINTS AT SPLICES. FIXED USING 4 No. 8 GAUGE NAILS (PER TIMBER)
- WALLPLATES (ON MASONRY) TO BE FIXED DOWN USING 30x5 GALVANIZED STEEL STRAPS (1050 LONG) @ MAXIMUM 1200 CENTRES U.N.O. PLUG & SCREW STRAPS TO WALL USING 5 No. 12 GAUGE x 50mm LONG SCREWS.
- WALLPLATES (ON STEELWORK) TO BE FIXED DOWN THROUGH TOP FLANGE OF SUPPORTING BEAM USING M10 BOLTS (GRADE 8.8) @ 600 CENTRES.
- PROVIDE TRUSS CLIPS OR FRAMING ANCHORS TO FIX ALL RAFTERS & CEILING JOISTS TO WALLPLATES, PURLINS & BINDERS U.N.O.

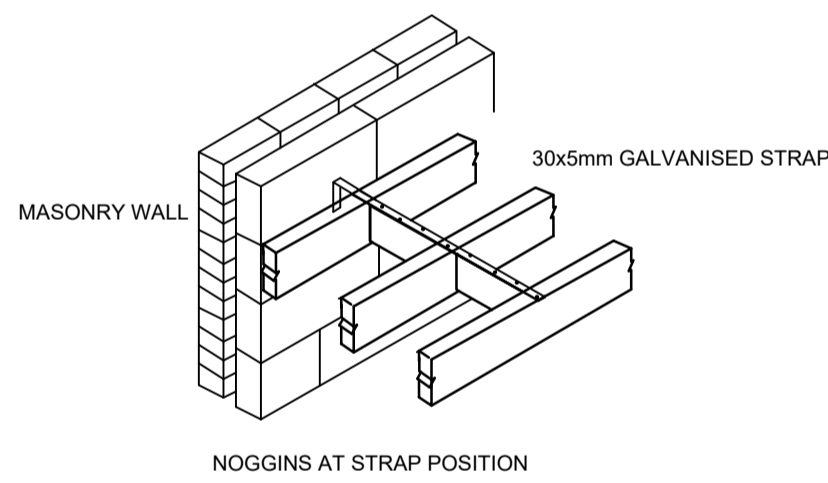

INDICATIVE STRAPPING DETAIL

NOT TO SCALE

STRAPPING DETAIL:

STRAPPING TO BE PLACED WHERE EXTERNAL WALL RUNS PARALLEL WITH RAFTERS/CEILING JOISTS. STRAPPING TO TAKE THE FORM OF 30mm x 5mm MILD STEEL STRAPS FIXED INTO INNER LEAF OF MASONRY AND ACROSS 3No RAFTERS/JOISTS WITH NOGGINS BETWEEN. STRAPS TO BE PLACED AT MAXIMUM 120-1500mm CENTRES

PRELIMINARY - FOR APPROVAL

**PROPOSED ALTERATIONS AT
MULLER, BELSHILL
BELGOWAN STREET, GLASGOW
FOR SUDLOWS**

Scale: NTS @ A1	Drawing No.: c 14520/N1	Rev: P1
Drawn by: DM		
Date: DECEMBER 2022		

GENERAL NOTES

**NORTHERN STRUCTURAL
SERVICES**

1, Prestbury Road
Macclesfield
Cheshire SK10 1AU
Tel: 01625 425243 Fax: 01625 429714
www.northernstructuralservices.co.uk