

SEWAGE DISCHARGE & PACKAGE TREATMENT PLANT NOTES:

The package treatment plant (PTP) shall be suitability sized for the dwelling and be strictly in accordance with the General Binding Rules for small sewage discharges (SSDs) and receive necessary planning and building control permission.

The PTP is proposed to discharge to an existing surface water ditch, with the discharge volume NOT exceeding 5 cubic metres per day.

It must be installed and operated in accordance with the manufacturers specification, serviced / maintained by competent person and waste sludge to be disposed of safely by an authorised person.

The foul water sewage is domestic only, will be treated via a package treatment plant before discharging into the surface water ditch therefore will not cause pollution of surface water or ground water

If a property is sold, the operator must give the new operator a written notice stating that a small sewage discharge is being carried out and giving a description of the waste water system and its maintenance requirements.

If for any reason the system is no longer required to be in operation, the owner must ensure that it is decommissioned appropriately to ensure no risk of pollutants entering ground water.

The discharge must not be in or within: 30m of a public sewer; 500m of Special Area of Conservation (SAC), Special Protection Area (SPA), Ramsar site, biological Site of Special Scientific Interest (SSSI), freshwater pearl mussel population, designated bathing water, or protected shellfish water; 200 metres of an aquatic local nature reserve and / or 50 metres of a chalk river or aquatic local wildlife site.

For a new discharge started on or after 2nd October 2023, the following apply:

- A new discharge shall not use the same outlet as any other discharge if the combined volume of those discharges would exceed the volumetric general binding rules thresholds for groundwater or surface water.
- A new discharge shall not be made to a discharge point within 50 metres of any other exempt groundwater activity or water discharge activity.

New Klargester (or similar approved) Sealed Package Treatment Plant with Outflow to Ditch. - See Sewage Discharge & Treatment Plant Notes

Proposed Site Plan 1:250

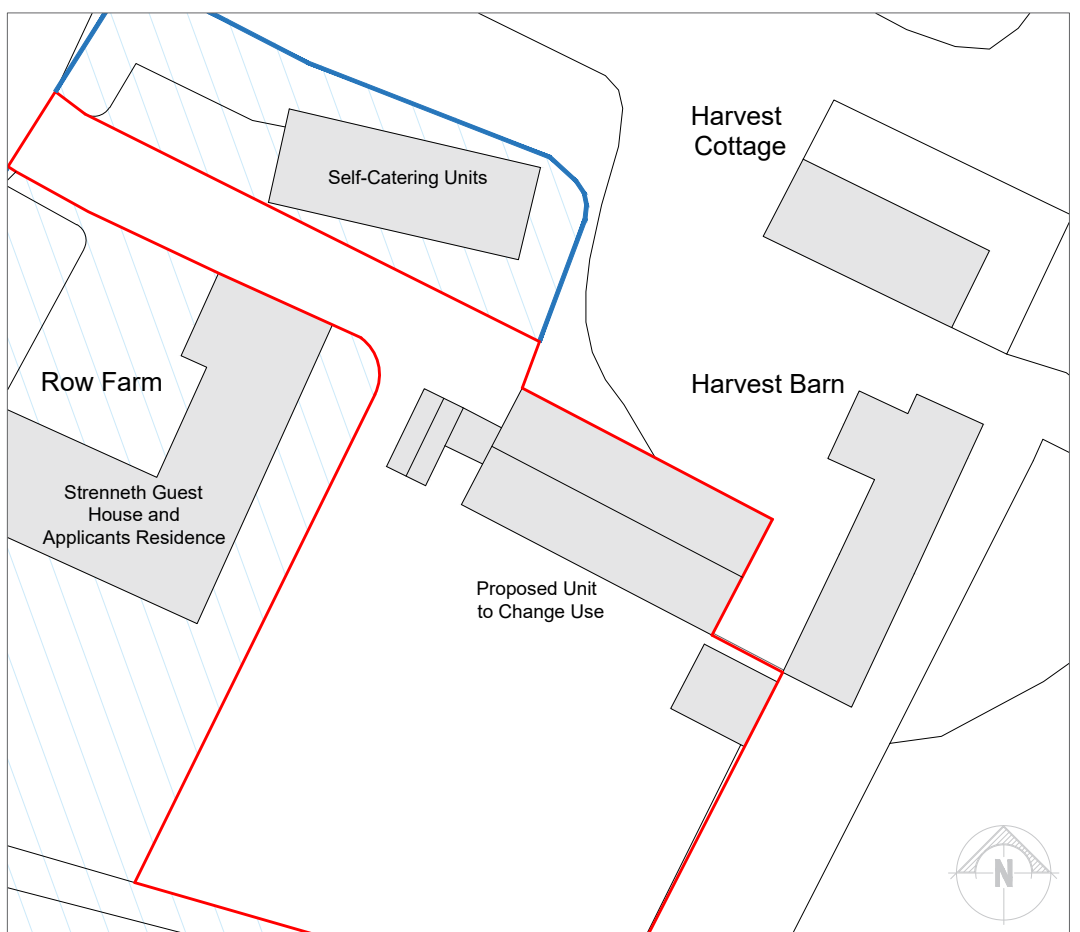

Existing Site Plan 1:500

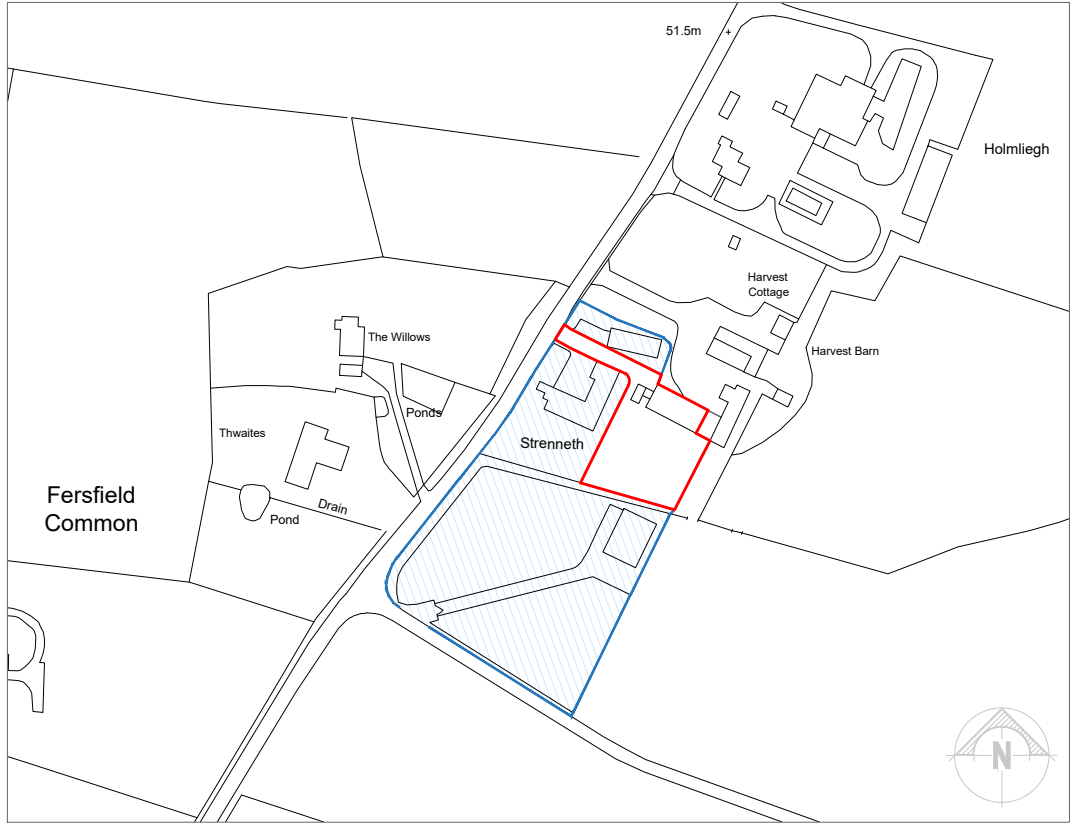

Existing Location Plan 1:2500

Rev	Description	Name	Date

DO NOT SCALE: All figured dimensions to be checked on site and the Architect notified of any variation

This drawing is the copyright of KFD ARCHITECTURE and should not be Reproduced without Prior Consent

Drawn: LB	Checked:	Approved:
Scale @ A3: as above	Date: July 23'	Job No: 1066
Drawing No: 1066-01	Rev:	

Project Title: Conversion of Existing Storage Unit to Dwelling at Row Farm, Airfield Road, IP22 2FF
For: Mr Paul Davey
Drawing Title: Existing Location and Site Plan, Proposed Plan

KFD ARCHITECTURE

Bellrope View, Rectory Road, Shelfanger, Digs, Norfolk, IP22-2DQ

Tel: 01379 643945

Fax: 01379 650655

Email: info@kfd-architects.co.uk

COMPLETE ARCHITECTURAL SERVICES