

**EXISTING GROUND FLOOR**

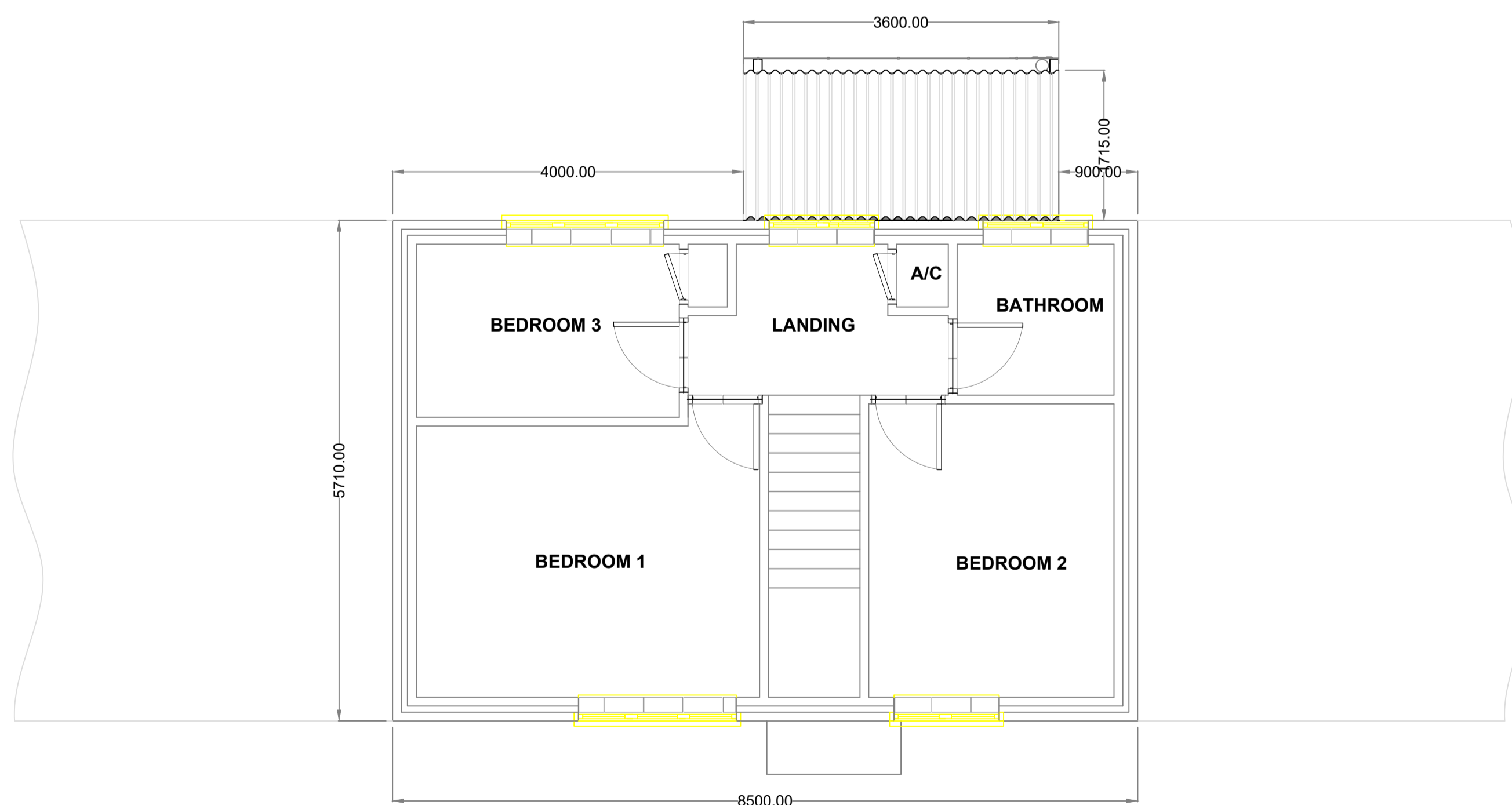

**EXISTING 1st FLOOR**  
NO CHANGE TO THIS LEVEL WITH EXTENSION

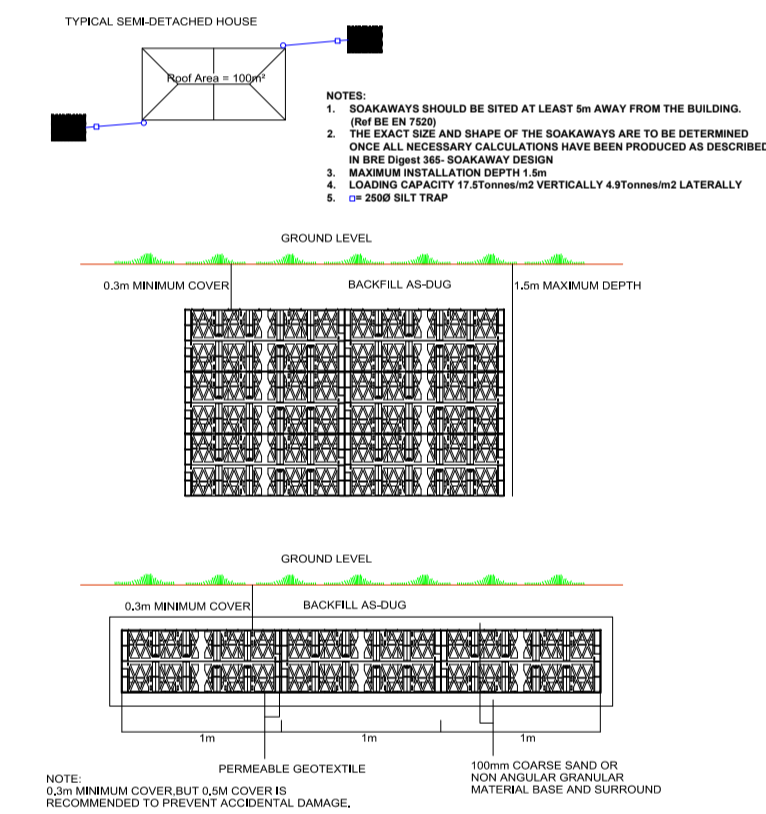

**PROPOSED SOAKAWAY**

**General Notes:**

Do not scale from these drawings. The Contractor is responsible for checking all dimensions on site prior to commencement of the works with any errors being reported to FBI CAD & DESIGN solutions as soon as possible.

Any construction work carried out prior to receiving all necessary approvals is entirely at the householders / clients risk.

All building work to be carried out to the satisfaction of the Local Authority Building Control Officer and in accordance with the current Building Regulations and as such additional unforeseen building works may be required on site.

The Contractor shall inspect all adjoining properties which may be affected by the works prior to commencement of works and record and report with the owner any defects.

The Contractor shall be entirely responsible for the security, strength and stability of the building during the course of the works.

Drawings produced for the purpose of obtaining Building Regulations approvals only and do not constitute full working drawings.

All drawings are the copyright of FBI CAD & DESIGN solutions. This drawing may not be copied by any third parties without prior permission.

THIS DRAWING SHOULD BE READ  
IN CONJUNCTION WITH  
CONSTRUCTION NOTATION  
DOCUMENT PTS 142

**FBI Cad & Design Solutions**  
Far Beyond Imagination  
"Your Dream is our Passion"

Email address: pt.softley@sky.com Phone: 01366 377075  
07900 954472

Title: Kitchen & Lounge Extension to Rear

Drawn By: Paul Softley

Address: 65 Recreation Drive, Southery, Downham Market,  
Norfolk, PE38 0NB

Date: September 2023 PTS 142

Building Regulations: Drawing 3 Rev 2; Scale 1:50