

- Notes:
1. ALL LEVELS IN METERS ABOVE ORDNANCE DATUM
 2. ALL DIMENSIONS IN MILLIMETERS UNLESS OTHERWISE STATED
 3. ALL LEVELS AND DIMENSIONS TO BE CONFIRMED BY CONTRACTOR ON SITE PRIOR TO ANY WORKS

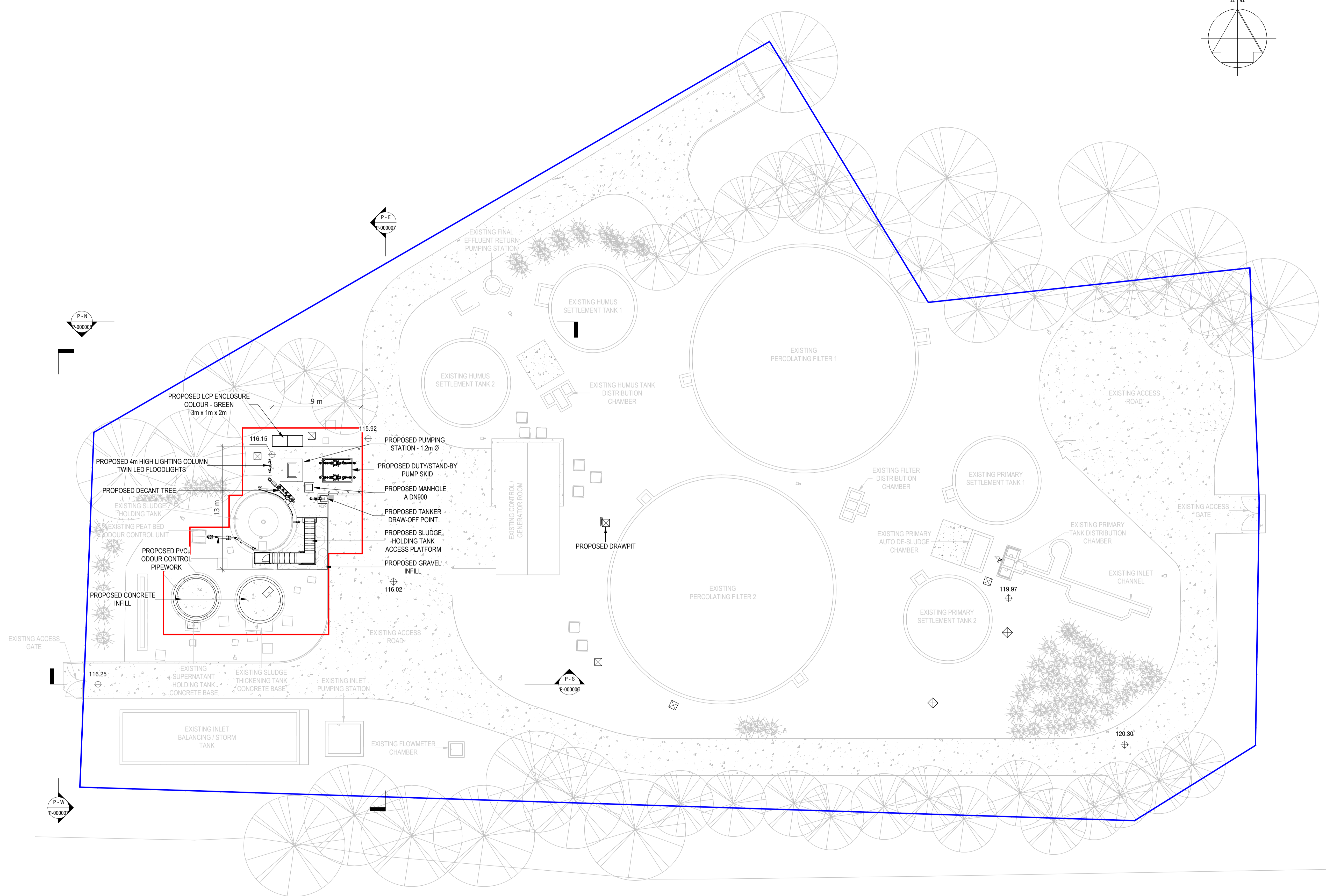
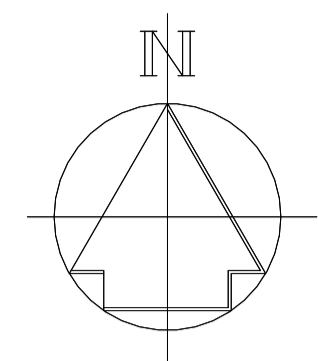

- LEGEND:
- SCOTTISH WATER SITE BOUNDARY (SECURITY FENCE)
 - PROPOSED DEVELOPMENT (AREA= 315 m²)

Rev	Description	Chk'd	App'd	Date
PD1	FOR PLANNING	GY	SzW	24.08.23

This drawing is the property of Scottish Water and must not be copied or used for any purpose other than that for which it is supplied without the written consent of Scottish Water.
Copyright © Scottish Water.

Scottish Water
Trusted to serve Scotland

SCOTTISH WATER
CASTLE HOUSE
6 CASTLE DRIVE
CARNEGIE CAMPUS
DUNFERMLINE
FIFE
KY 11 8GG
Tel 0800 0778778

RSE
ROSS-SHIRE ENGINEERING

Muir of Ord Industrial Estate,
Muir of Ord,
Ross-shire,
IV5 7UA.
E-mail: info@ross-eng.com
TEL: 01463 870049
RSE Job No.34452

Originated By	Drawn By	Checked By	Approved By
G.Dolby	P.Devlin	G.Yuen	S.Weier
Date	Date	Date	Date
07.07.23	07.07.23	30.08.23	30.08.23
Scale	Status	Suitability	
As indicated@A1	A8	Published for Gate 90	

Project Title	
INSHCH STW SLUDGE HOLDING TANK	
Drawing Title	
PLANNING - PROPOSED SITE LAYOUT	
ELLIPSE EQUIPMENT No. 5000062177	
ELLIPSE PLANT No. STW001438	AUTOCODE No. 5279480000
Drawing No.	Revision
5279480000-RSE-ZZ-ZZ-DR-T-000003	P01



PROPOSED SITE PLAN
1:200