

- Copyright Jessop and Cook Architects Limited.
- Do not scale from drawings, all dimensions to be checked on site.
- For more information on the condition of the fabric of the Barn and Stables please refer to the report produced by Hall & Ensom Chartered Surveyors "Building Condition Survey in respect of Lords Farm Barn" (August 2019).

**KEY**  
■ Demolition of walls, partitions and other structures  
--- Boundaries

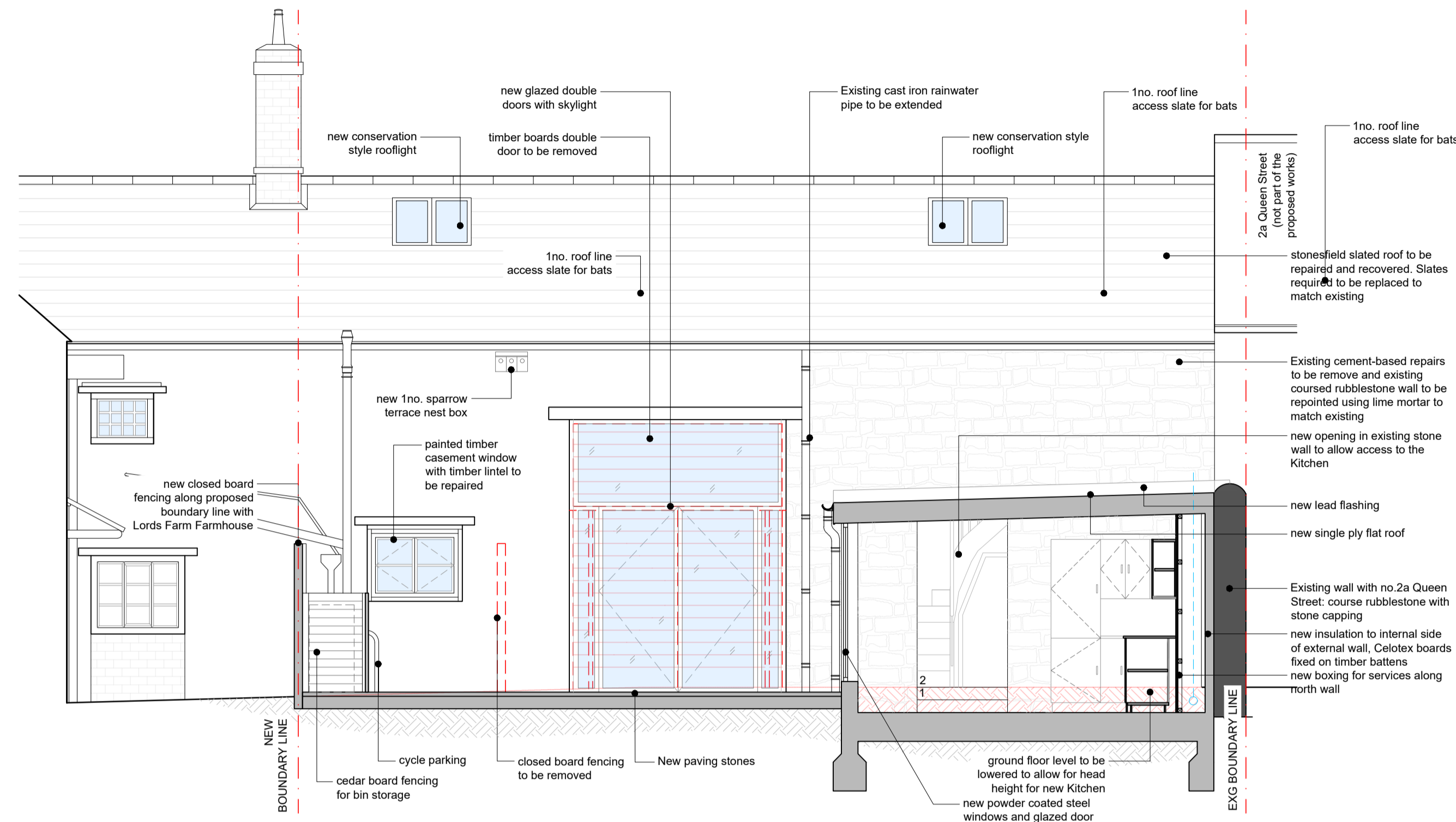

PROPOSED SECTIONAL ELEVATION EE

Scale 1:50

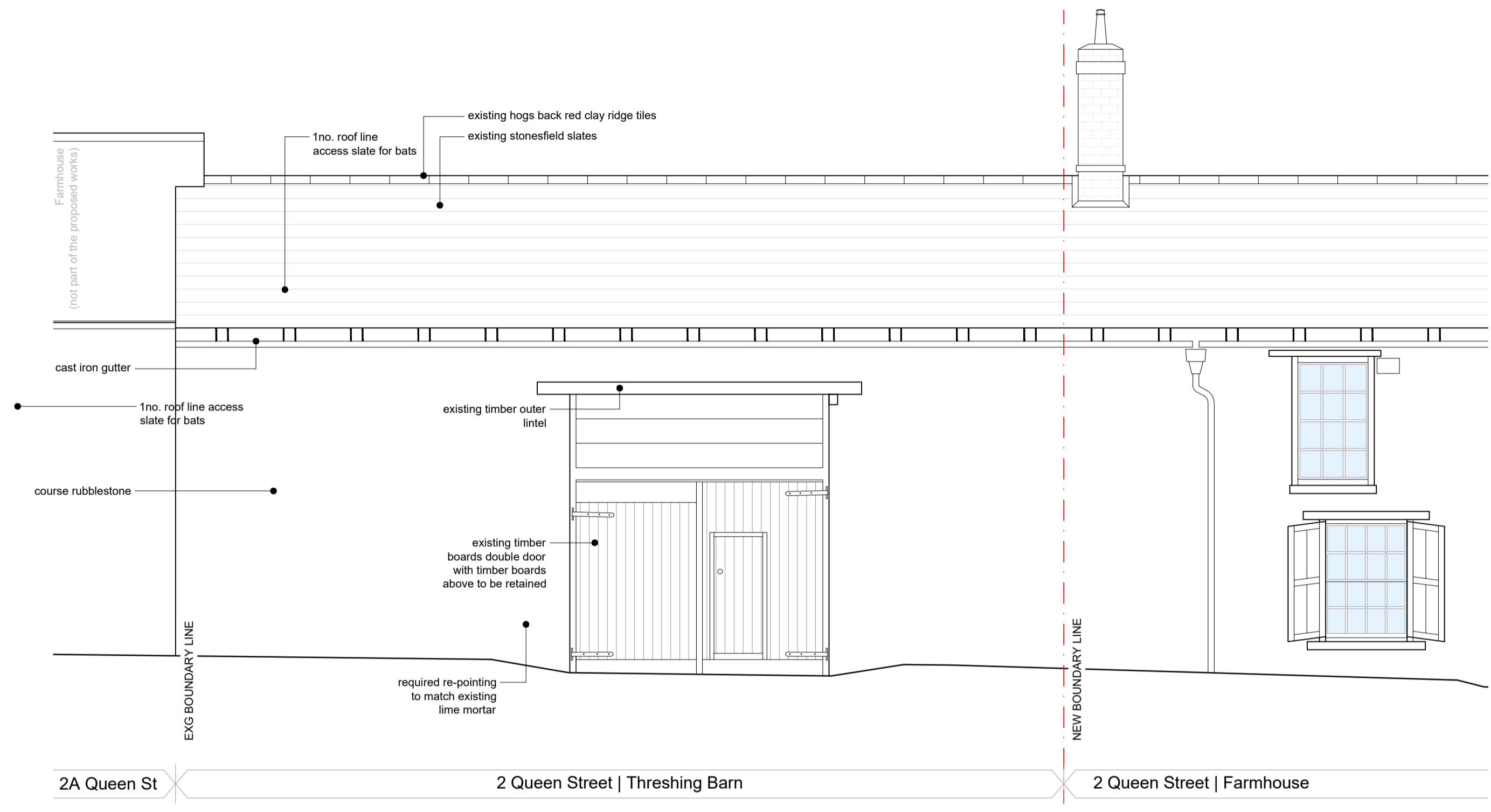
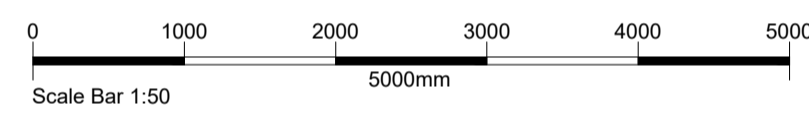

PROPOSED ELEVATION GG

Scale 1:50

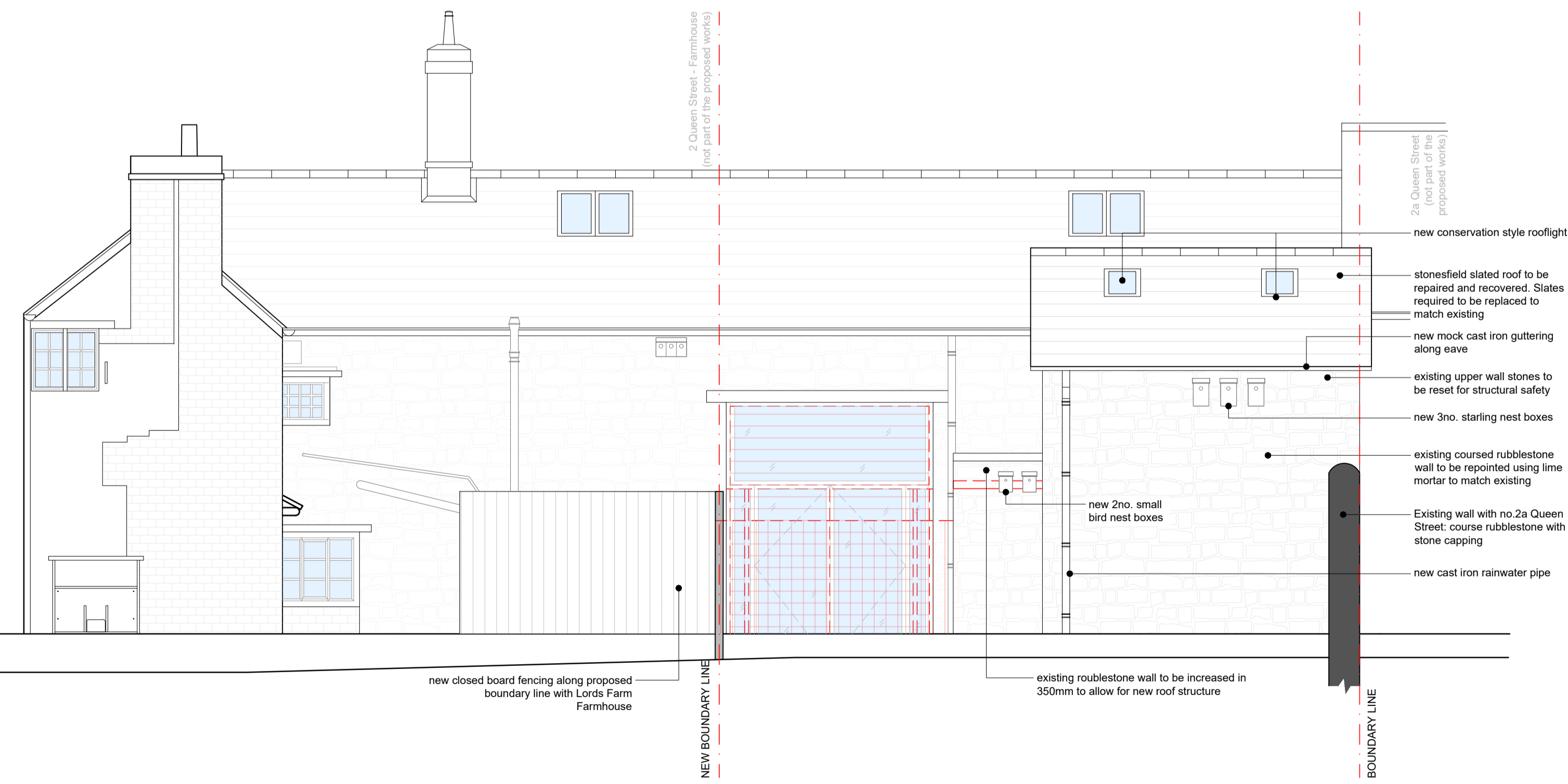
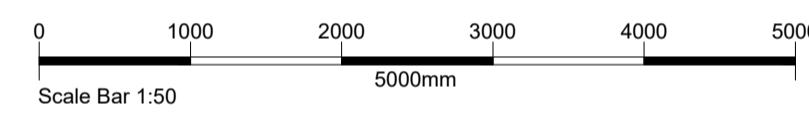

PROPOSED ELEVATION FF

Scale 1:50

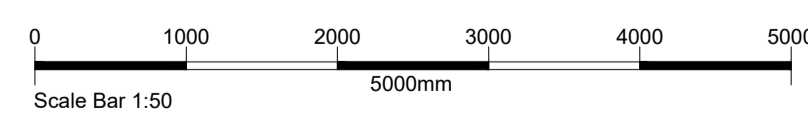

A 22.10.2020 Added access slates for bats and bird boxes AB

Revisions

PLANNING ISSUE

Conversion of threshing barn into residence at Lords Farm, 2 Queen Street Eynsham, Witney OX29 4HQ

for Oxford Preservation Trust  
 10 Turn Again Lane, St Ebbes, Oxford: OX1 1QL

Drawing title  
 Proposed Sections and Elevations E to G

**JESSOP & COOK ARCHITECTS**  
 WEST WING, SECOND FLOOR  
 9 PARK END STREET  
 OXFORD OX1 1HH  
 T: 01865 591212  
 E: info@jessopandcook.co.uk  
 www.jessopandcook.co.uk

Scale at A1 Date Drawn by Checked

1:50 Sep 19 AB

Drawing number Revision

P.1354\_086 A