

SPECIFICATION NOTES:

- Generally**
- All soft landscape areas are to be topsoiled to the depths indicated in the key and cultivated: 100mm depth for turfed and seeded areas and 250mm depth for planted areas.
 - Carry out minor grading of all areas to be seeded or planted, bringing the soil to an even grade, free from minor hollows and ridges at correct finished levels.
- Seeded Areas**
- Lightly and uniformly reduce to a fine tilth 25mm deep by harrowing and raking. Remove stones over 30mm in any dimension.
 - Supply and sow specified seed mixture at specified rate of 35-50g/m² in accordance with supplier's recommendations.
 - Carry out initial cut to all grass areas. Timing and height of cut to be as recommended by seed supplier and dependent on establishment.
- Planted Areas**
- Supply, spread and incorporate at time of cultivation a 50mm depth of PAS 100 compost to all ornamental planted areas.
 - Supply and plant the plant material as specified including the incorporation of compost and fertilizer with backfill.
 - All plants/ trees will match the following criteria:
 - Condition: Materially undamaged, sturdy, healthy and vigorous.
 - Appearance: Of good shape and without elongated shoots.
 - Hardiness: Grown in a suitable environment and hardened off.
 - Health: Free from pests, diseases, discoloration, weeds and physiological disorders.
 - Budded or grafted plants: Bottom worked.
 - Root system and condition: Balanced with branch system.
 - Standard: Generally in accordance with BS 3936 and The National Plant Specification.
 - Species: True to name.
 - Origin/ Provenance: As plant schedule.
 - Definition: Origin and Provenance have the meaning given in the National Plant Specification.
 - Supply and fix to hedging and transplants, 600mm x 200mm diameter Plant Care Treeguard Mesh No. 5. To be secured with galvanised staples to supporting 32mm square sawn timber stakes to be 90cm long.
 - Following planting all beds to be well watered prior to spreading of a 50mm thick layer of ornamental, 5-35mm bark mulch.
- Maintenance**
- All soft landscape areas are to be maintained for a period of 12 months following Practical Completion in accordance with the specification and to meet the requirements of the Green Spaces Team.
 - All grassed areas to be mown to maintain a height between 25-50mm.
 - Wildflower seeded and areas of enhanced grassland are to be maintained in accordance with ecologist's recommendations and seed supplier's recommendations depending on establishment. All for four cuts in the first year.
 - Planted areas are to be maintained weedfree by hand weeding or approved herbicide treatment. Shrubs to be pruned where required to promote bushiness and remove overhanging growth obstructing footpaths. Herbaceous plants and grasses to have dead growth removed and to be cut back in the spring.
 - Any trees, shrubs or grassed areas that have failed to thrive within the 12 months maintenance period shall be replaced/reinstated at the landscape contractor's expense.

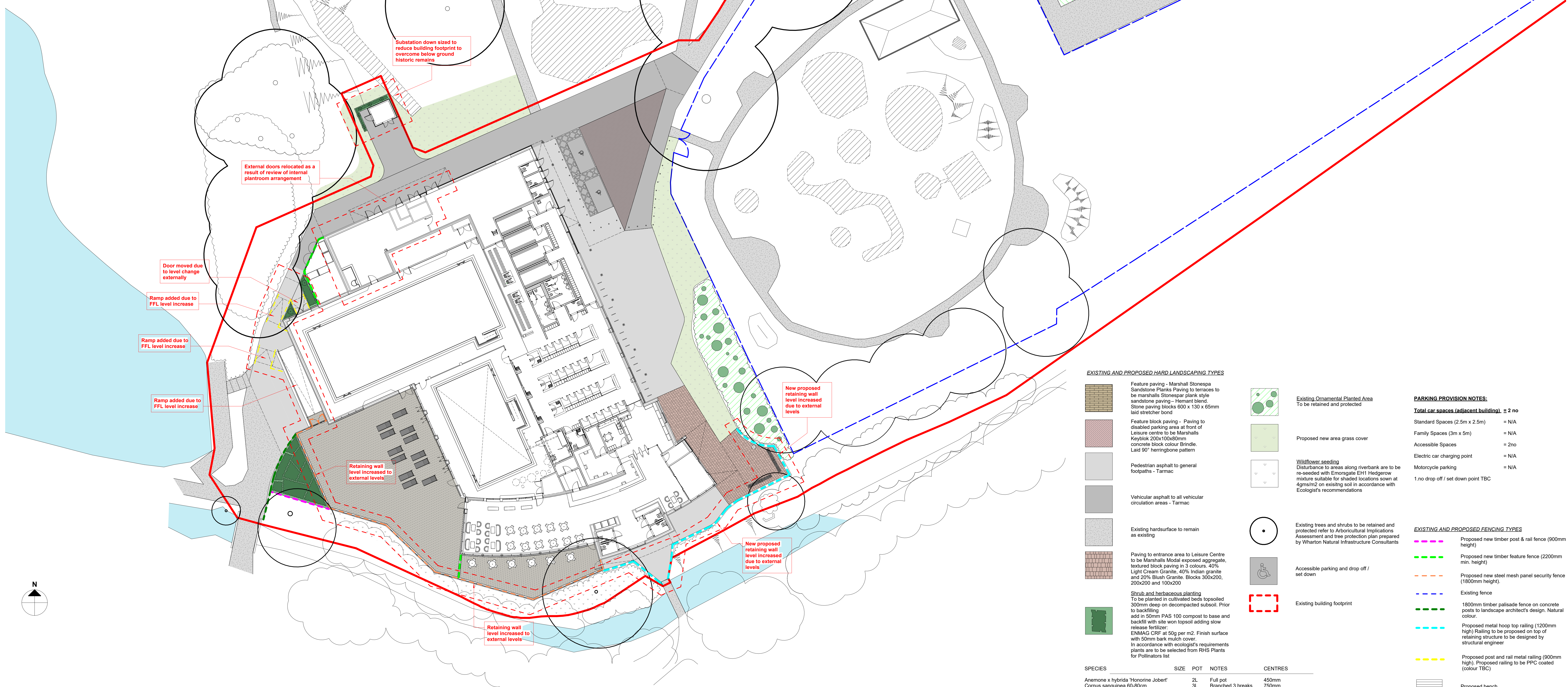

EXISTING AND PROPOSED HARD LANDSCAPING TYPES

- Feature paving - Marshall Stonespa Sandstone Planks Paving to terraces to be Marshall's Stonespa plank style sandstone paving - Hemant blend. Stone paving blocks 600 x 130 x 65mm laid stretcher bond.
- Feature block paving - Paving to disabled parking area at front of Leisure centre to be Marshall's Keyblok 200x100x50mm concrete block colour Brindle. Laid 90° herringbone pattern.
- Pedestrian asphalt to general footpaths - Tarmac.
- Vehicular asphalt to all vehicular circulation areas - Tarmac.
- Existing hard surface to remain as existing.
- Paving to entrance area to Leisure Centre to be Marshall's Medial exposed aggregate, textured block paving in 3 colours. 40% Light Cream Granite, 40% Indian granite and 20% Bush Granite. Blocks 300x200, 200x200 and 100x200.
- Shrub and herbaceous planting To be planted in cultivated beds topsoiled 300mm deep on decomposed subsoil. Prior to backfilling add in 50mm PAS 100 compost to base and backfill with site won topsoil adding slow release fertilizer ENMAO2 CHR: at 50g per m². Finish surface with 50mm bark mulch cover. In accordance with ecologist's requirements plants are to be selected from RHS Plants for Pollinators list.
- Existing Ornamental Planted Area To be retained and protected.
- Proposed new area grass cover.
- Wildflower seeding Disturbance to areas along riverbank are to be re-seeded with Emorsgate E11 Hedgerow mixture suitable for shaded locations sown at 4gms/m² on existing soil in accordance with Ecologist's recommendations.
- Existing trees and shrubs to be retained and protected refer to Arboricultural Implications Assessment and tree protection plan prepared by Wharton Natural Infrastructure Consultants.
- Accessible parking and drop off / set down.
- Existing building footprint.

PARKING PROVISION NOTES:

- Total car spaces (adjacent building):** = 2 no
- Standard Spaces (2.5m x 2.5m) = N/A
 - Family Spaces (3m x 5m) = N/A
 - Accessible Spaces = 2no
 - Electric car charging point = N/A
 - Motorcycle parking = N/A
 - 1 no drop off / set down point TBC

SPECIES

SPECIES	SIZE	POT	NOTES	CENTRES
Anemone x hybrida 'Honoree Jobert'	2L	Full pot		450mm
Cornus sanguinea 60-80cm	3L	Branched 3 breaks		750mm
Euphorbia amygdalodes robbiae	2L	Full pot		450mm
Ceranium macrorrhizum 'Aval'	2L	Full pot		450mm
Hedera helix 'Hibernica' 30-40cm	2L	Min. 3 breaks		500mm
Ilex aquifolium 40-60cm	3L	Bushy, 3 breaks		600mm
Ligustrum vulgare 40-60cm	2L	Branched 3 breaks		750mm
Lonicera nitida 40-60cm	2L	Bushy		500mm
Luzula sylvatica	2L	Full pot		450mm
Rhamnus cathartica 60-80cm	BR	Branched 3 breaks		750mm
Sarcococca humilis 20-30cm	3L	Bushy, 6 breaks		500mm
Viburnum opulus 40-60cm	2L	Branched 3 breaks		750mm

EXISTING AND PROPOSED FENCING TYPES

- Proposed new timber post & rail fence (900mm height)
- Proposed new timber feature fence (2200mm min. height)
- Proposed new steel mesh panel security fence (1800mm height).
- Existing fence
- 1800mm timber palisade fence on concrete posts to landscape architect's design. Natural colour.
- Proposed metal hoop top railing (1200mm high) Railing to be proposed on top of retaining structure to be designed by structural engineer.
- Proposed post and rail metal railing (900mm high). Proposed railing to be PPC coated (colour TBC).

PROPOSED SITE PLAN

CREATION DATE	SCALE	DRAWN BY	CHECKED BY	STATUS
12/04/2024	1:200	AK	AK	FOR ISSUE

12943 - DB3 - B01 - XX - D - A - 1902 - S3 P04

AK - DB3 - SP - XX - D - A - 1902 - S3 P04

REV	DATE	DESCRIPTION	BY	CHK
P01	19/02/24	FIRST ISSUE	AK	AK
P02	01/06/24	AMENDED TO SHOW CYCLE HOOP POSITION AND DISABLED BAYS POSITIONS SHOWN	AK	AK
P03	08/06/24	DISPERSED PARKING BAYS UPDATED TO TARMAC.	AK	AK
P04	27/09/24	PLANNING ISSUE	AK	AK

PLANNING

DB3

LEEDS
10 South Parade, Leeds LS2 3ES
Tel: 0113 244 2931 www.db3leeds.com

KIER

CLIENT: WARWICK DISTRICT COUNCIL

PROJECT: ABBEY FIELDS SWIMMING POOL

PROPOSED SITE PLAN

12943 - DB3 - B01 - XX - D - A - 1902 - S3 P04

AK - DB3 - SP - XX - D - A - 1902 - S3 P04