

Deore Double Wooden Garage Inc. Barn Doors Approx **W6m x D5.5m** / **W19'6" x D18'**

(Sizes shown are approximate & full sizes are shown in the product Specification)



FREE DELIVERY*

APPROX 4 - 5 WEEKS

Complete our form if you require it sooner or later!

TOTAL: £ 6,024.99 inc. VAT

Save £1160 | Was £7184.99

Order today with a **£1,506.25** deposit!

Found similar for less?

Tell us, we will beat it by 10%*



Change size



Add to basket



Price change
notifier

18-609 ft

17.30 ft

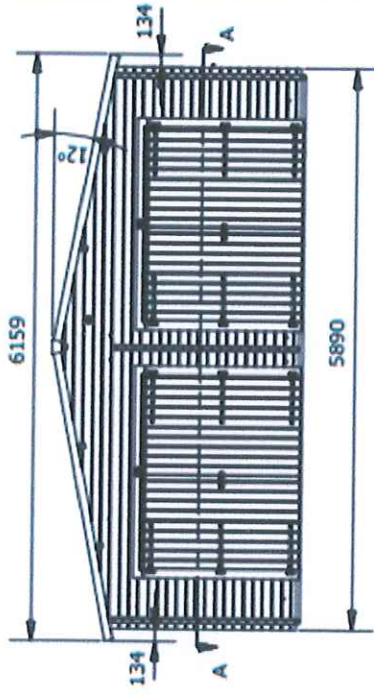
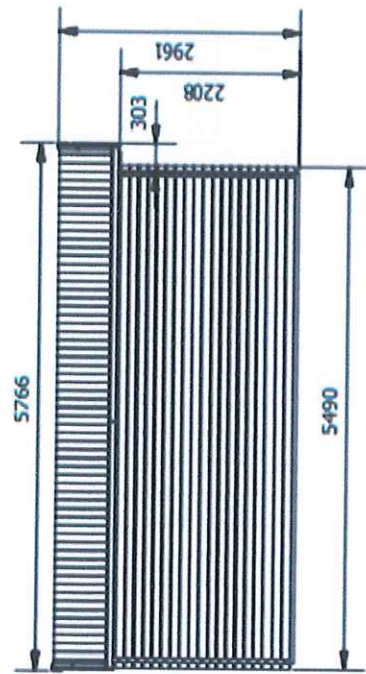
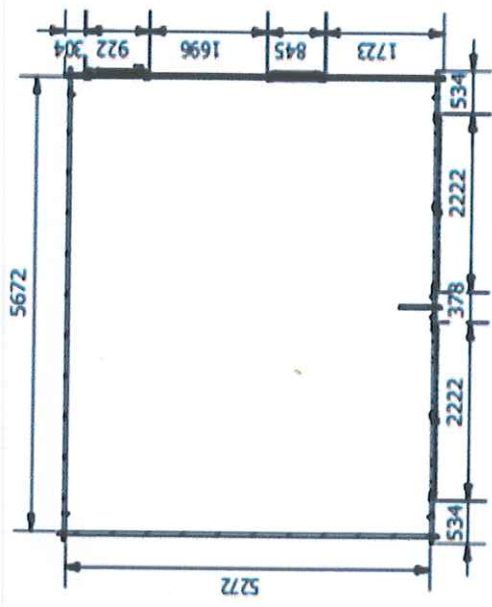

Specification

- Overall External Dimensions: 6.16m x 5.76m (20' 2.5" x 18' 10.75")
- External Width: 5.89m (19' 4")
- External Depth: 5.49m (18' 0.25")
- Internal Width: 5.67m (18' 7.25")
- Internal Depth: 5.27m (17' 3.5")
- Internal Area (m²): 29.88m²
- Front Roof Overhang: 0.3m (0' 11.75")
- Internal Eaves Height: 2.31m (7' 7")
- Internal Truss Height: 2.12m (6' 11.5")
- Roof Thickness: 19mm
- Roof Purlins: 210mm x 45mm
- Wall Thickness: 45mm
- Side Door Opening Size: 0.74m x 1.82m
- Side Door Locking System: Multi-Point Locking System
- Garage Door Opening Size: 1.99m x 1.83m
- Garage Door Locking System: Hasp and Staple
- Number of Windows: 1
- Window Opening Size: 0.66m x 1.08m
- Glazing Material: 24mm Double Glazed
- Ventilation: 2 Plastic Vents Included
- Approx. Assembly Time: 2 Days*
- *This is an approximate time only, based on 2 people. Assembly time may vary depending on season/weather conditions, foundation type, ability of those constructing, etc

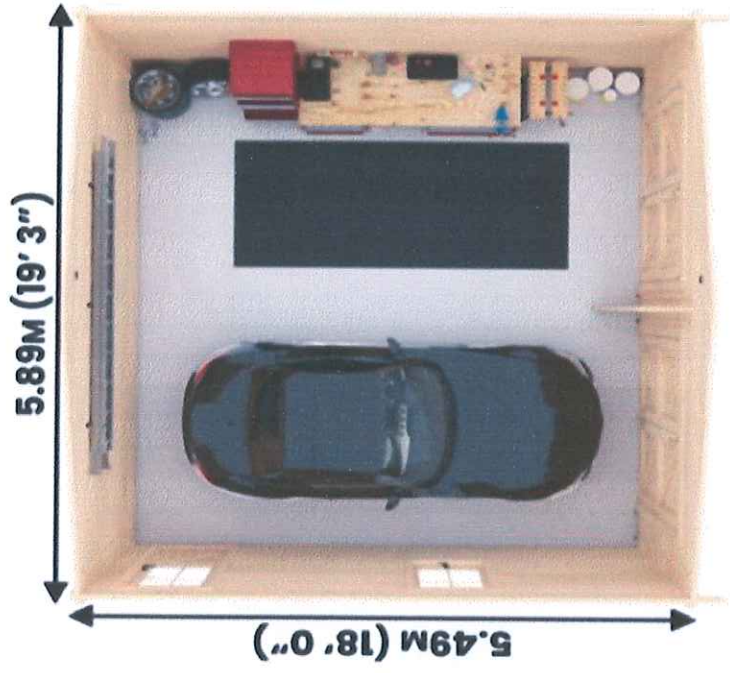

Images may show optional extras or differ slightly from your product, please see