

Site Area:
1498M2 (16,124Sq Ft)

UK Grid Reference:
Easting: 394690
Northing: 648130

Thornton Cottage

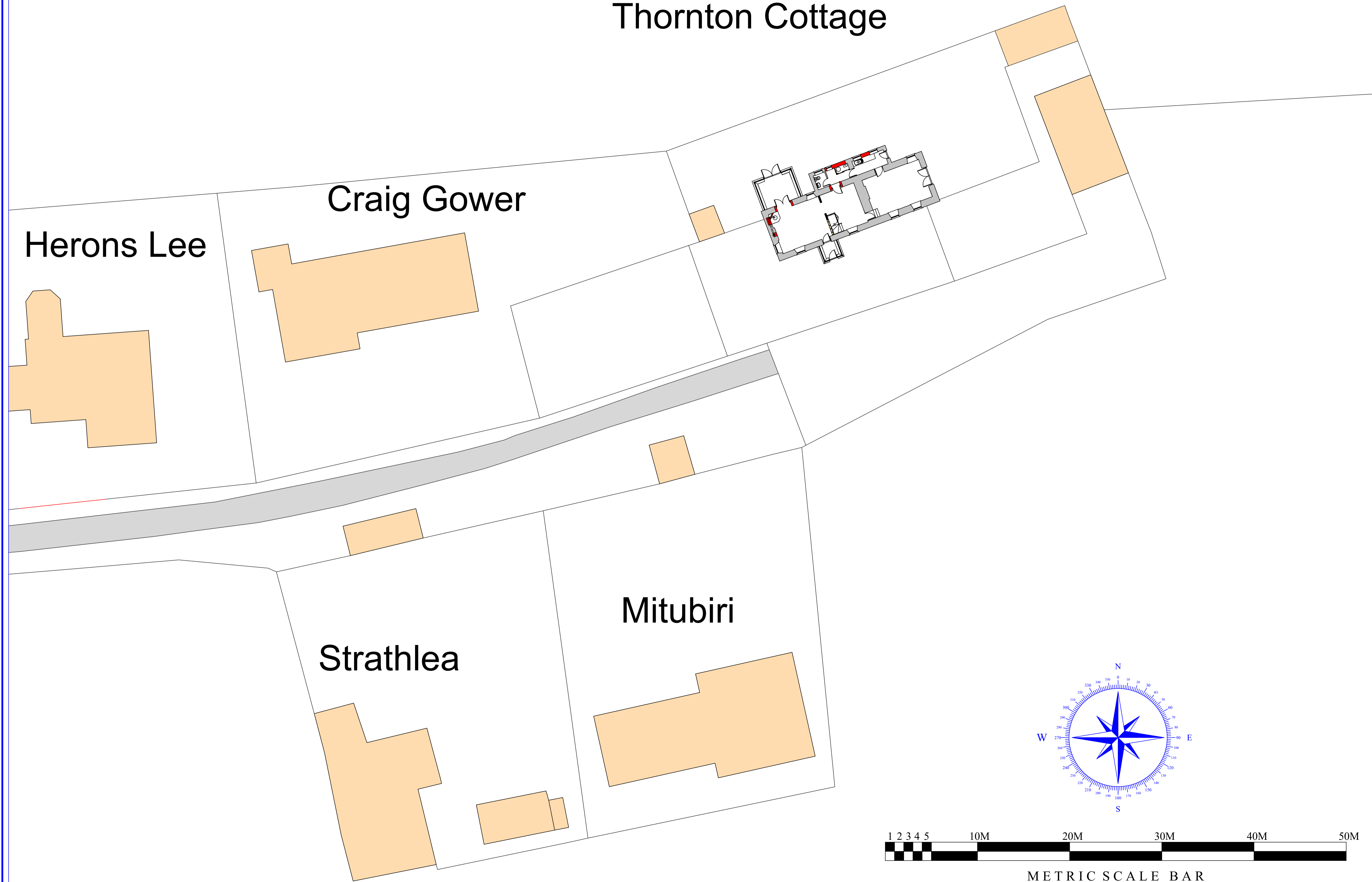

©YEOMAN ARCHITECTURE LIMITED
Copyright of this plan is retained by
YEOMAN ARCHITECTURE LIMITED
No part should be copied or reproduced without
the express permission of the copyright holder.

ALL DIMENSIONS MUST BE CHECKED ON-SITE
AND NOT SCALED FROM THIS DRAWING.
ANY DISCREPANCIES MUST BE REPORTED TO YEOMAN LIMITED
Whilst every effort has been made to ensure the accuracy of this plan and
specification, Contractors should make their own full assessment
of the site conditions therein, always prior to commencement of works on-site.

No.	Revision / Amendment List:	Date:

 YEOMAN ARCHITECTURE LIMITED
is a Registered Professional Practice with the
Chartered Institute of Architectural Technologists



YEOMAN
Architecture

Suite 6
5 Kings Mount
Ramparts Business Park
Berwick Upon Tweed
Northumberland
TD15 1TQ

Telephone: 01289 303960
E-Mail: yeomandesign@aol.com

Yeoman Architecture Limited
Registered in England & Wales Company Number: 1095249

Client:	Mr & Mrs G Sutherland
Project Address:	Thornton Cottage Thornton Berwick Upon Tweed Northumberland TD15 2LP
Project:	Proposed Alteration & Extension of Dwellinghouse
Sheet Title:	Site Plan As Proposed
Scale:	1:200 @ A1 Size
Date:	6th October 2023
Designed By:	James Cromarty <small>MRSAI OCTOBER 1994 MR RIBA 0520</small> Direct Mobile No: 0772 969 0520
Drawing No:	A103
Plan Ref:	GS/1545/23

