

© This drawing and any design thereon is the copyright of this practice and must not be reproduced without written consent. Do not scale from this drawing, use figured dimensions only. Any discrepancies must be reported to this company at once.

© **NOTE 1** : This drawing is a scheme design (in whole or in part) prepared for submission to the relevant local authority for the purposes of obtaining planning/listed building consent only, and shall not be used for any other purpose.

Please be aware that should planning/listed building consent be granted there will almost certainly be conditions which will require permission/discharging prior to commencement on site.

Please check the conditions have been approved before commencement as failure to do so may lead to the planning approval being void.

Please be aware should planning approval be granted for this project you may incur CIL (Community Infrastructure Levy) charges. These charges are arranged and collected through the Local Authority. An agreement on how and what to pay must be agreed with the Local Authority before any commencement of work on site.

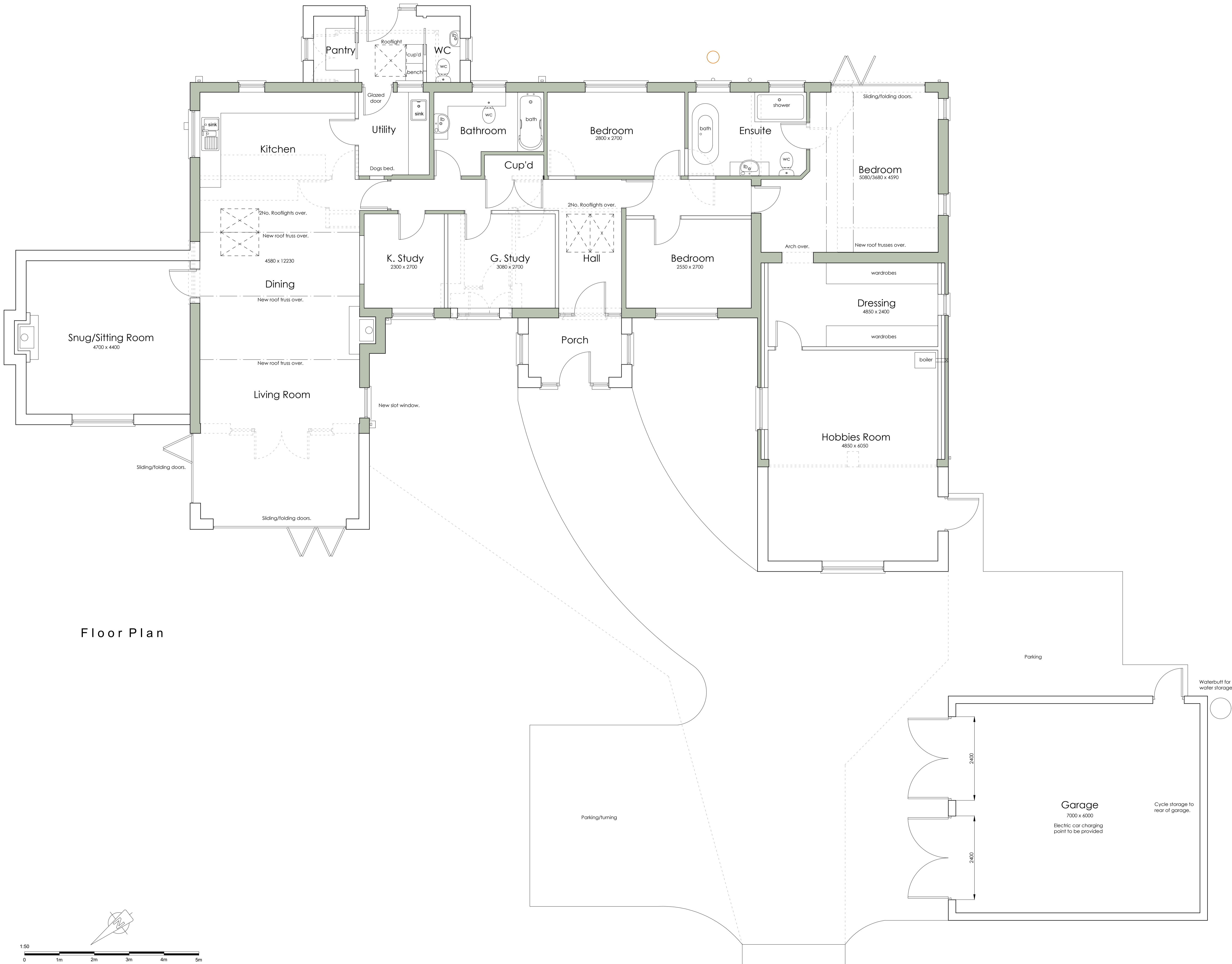

Floor Plan

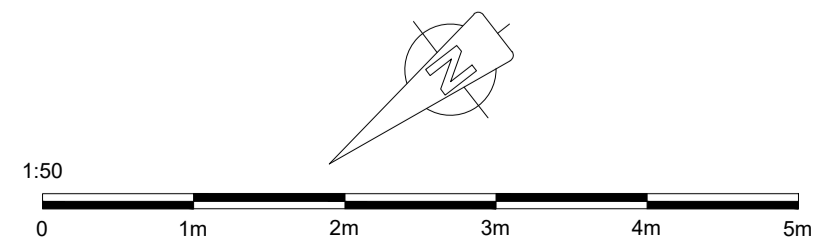

Rev	Date	Description	Drawn
A	31/07/23	Additional info added following clients comments	NJA

ASHTON DESIGN COMPANY
 BUILDING DESIGNERS

ASHTON DESIGN COMPANY LTD.
 The Studio
 PO Box 330
 Woodbridge
 Suffolk
 IP12 9DX

Telephone - (01473) 276 030
 Facsimile - (01473) 276 031
 e-mail - info@ashtondesign.co.uk

PROJECT
 Proposed Alterations & Extensions
 Brookside
 Gedding Road
 Drinkstone
 Suffolk, IP30 9TG

CLIENT
 Mr and Mrs Jolly

DETAIL
 Planning Application Drawing - Floor Plan

SCALES
 1:50 @ A1

DATE
 July '23

DRWG. NO
 8111 - PA/23/06

DRAWN
 NJA

REVISION
 A