

**General Notes**

The data contained in this document includes proprietary rights of Mæ. Any party in receipt of the document shall receive and hold the same in confidence and agrees not to duplicate or otherwise reproduce the document in whole or in part, nor disclose the contents of the same without the written consent of Mæ.

**Notes:**

1. Measurements are based on metric system.
2. All levels are in meters to Ordnance Datum Newlyn (ODN) unless noted otherwise.
3. Do not scale off the drawing and CAD file.
4. All shown figure dimensions are to be followed.
5. Do not use for construction unless expressly permitted.
6. This drawing shows design intent only.
7. Contractor should verify all conditions, levels and dimensions on site and notify contract administrator of any variations from dimensions before construction and/or fabrication.
8. Any discrepancies on this drawing should be reported to Mæ before proceeding to fabrication.
9. Drawings to be read in conjunction with all relevant documents, which include but are not exhaustive - MEP, Structures, shop/fabrication drawings and CDM documents.
10. This drawing may contain colour data. Please refer to original electronic document.
11. These are architectural drawings only. Refer to consultant drawings for further information.
12. Existing buildings to be measured on site and confirmed by contractor.
13. Also refer to accompanying Mæ Schedules and drawings.

Revision	Date	Description
DO1	04/05/21	Stage 4a Issue
TO1	19/05/21	Tender Issue
TO2	13/09/21	Tender Addendum
DO3	08/04/22	For Information

**Key:**

- Title boundary
- - - Planning boundary

**Key Plan**

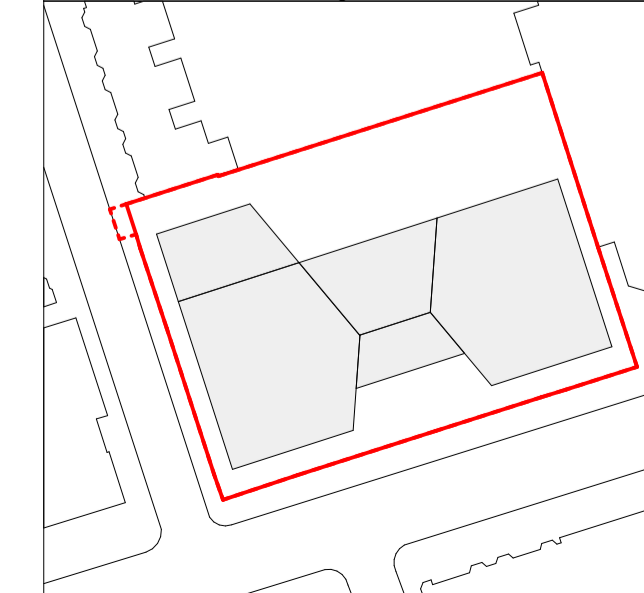

1 Naorji Street - London - WC1X 0GB  
 +44 (0)20 7704 6060  
 office@mæ.co.uk - www.mæ.co.uk

CLIENT <b>Populo Living</b>	
PROJECT NAME <b>Hartley Centre</b>	
PROJECT NO. <b>1826</b>	STAGE <b>4b</b>
DRAWING NAME <b>GA Site Plans, Proposed Site Plan</b>	
SCALE <b>1:200 @ A1</b>	DATE <b>08/04/2022</b>
DRAWN BY <b>OP</b>	CHECKED BY <b>NWa</b>
REV / STATUS <b>D03 FOR INFORMATION</b>	
DRAWING NO. <b>HYC-MAE-XX-00-DRG-06001</b>	