

**HB2 KERB DETAIL**  
1:5

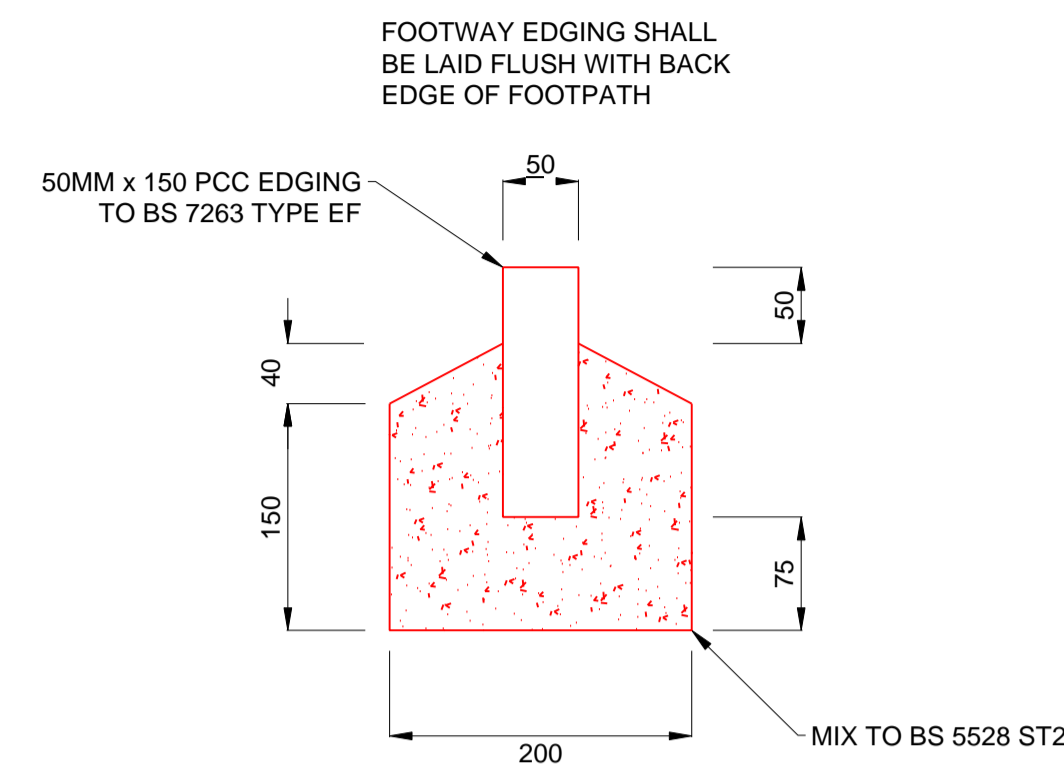

**FOOTWAY EDGING (TYPE EF)**  
1:5

**Table 4.4.1 b - Thickness of Capping Layer and Sub-Base (mm): Construction**

	CBR (%) at time of construction					
	<2	2 to 3	>3 to <5	5 to <10	10 to <15	15+
Foundation layer thickness for Type of Work	150mm sub-base PLUS the capping layer thickness (mm) below					
Haunching, or Local Reconstruction	450*	315*	240	200	150	0
New Works or Major Areas of Reconstruction	600	450	350	250	180	0

THE FORMATION CBR IS TO BE TESTED ON SITE AND THE PAVEMENT DESIGN ADJUSTED IN ACCORDANCE WITH TABLE B OR D AS AGREED WITH THE HIGHWAY INSPECTOR. NOTE THAT A VALUE OF 5-10% HAS BEEN ASSUMED FOR THE PURPOSES OF THE INITIAL DESIGN BASED ON A FORMATION IN NATURAL GROUND TAKEN FROM THE SITE INVESTIGATION DATA.

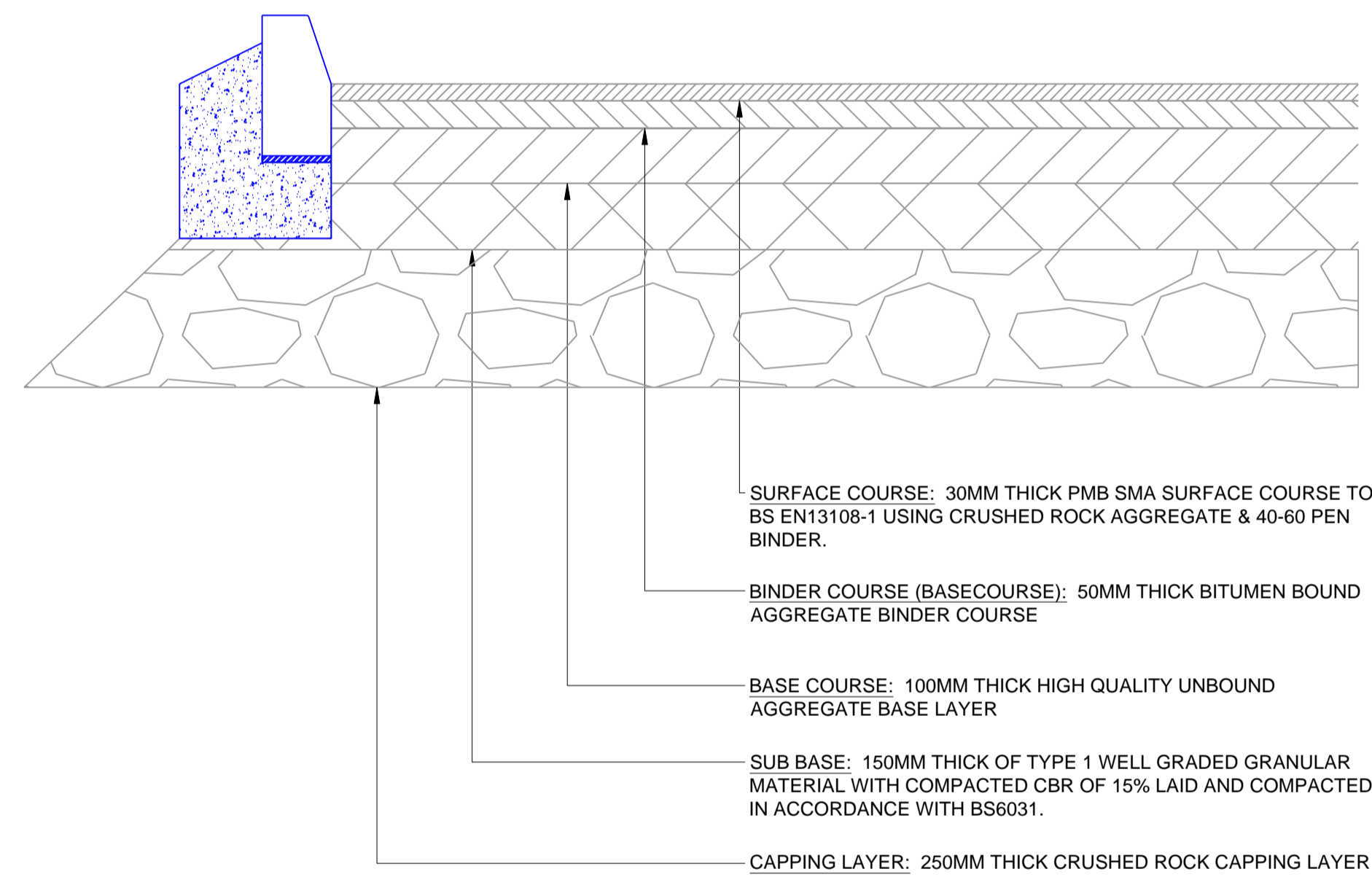

**PROPOSED HIGHWAY CONSTRUCTION DETAIL**  
1:10

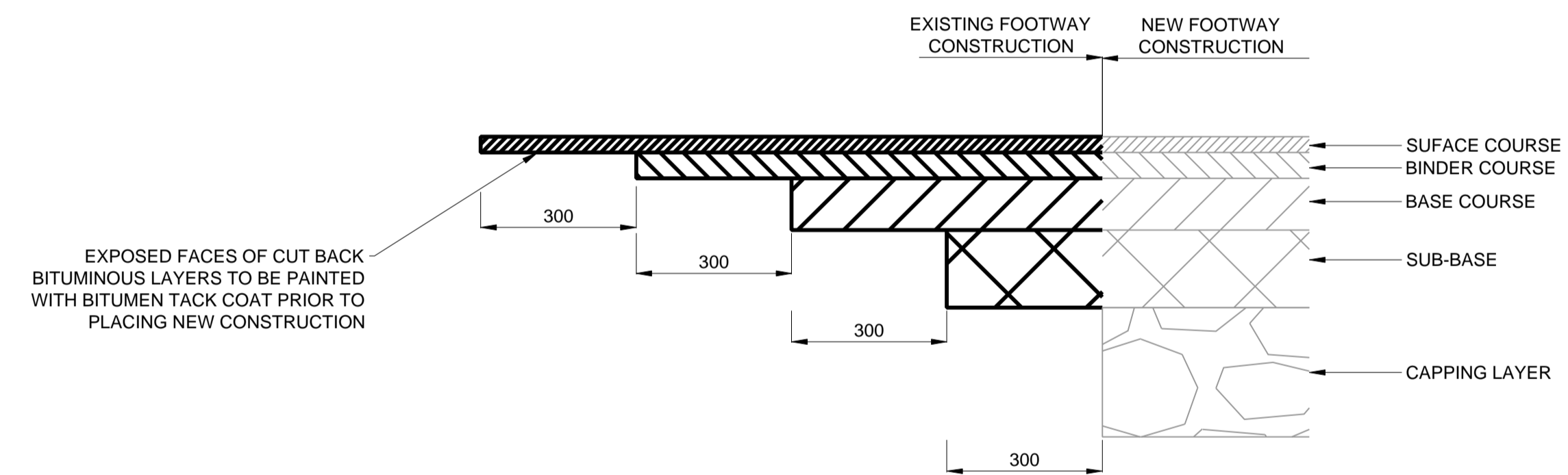

**CARRIAGEWAY TIE-IN DETAIL**  
1:10

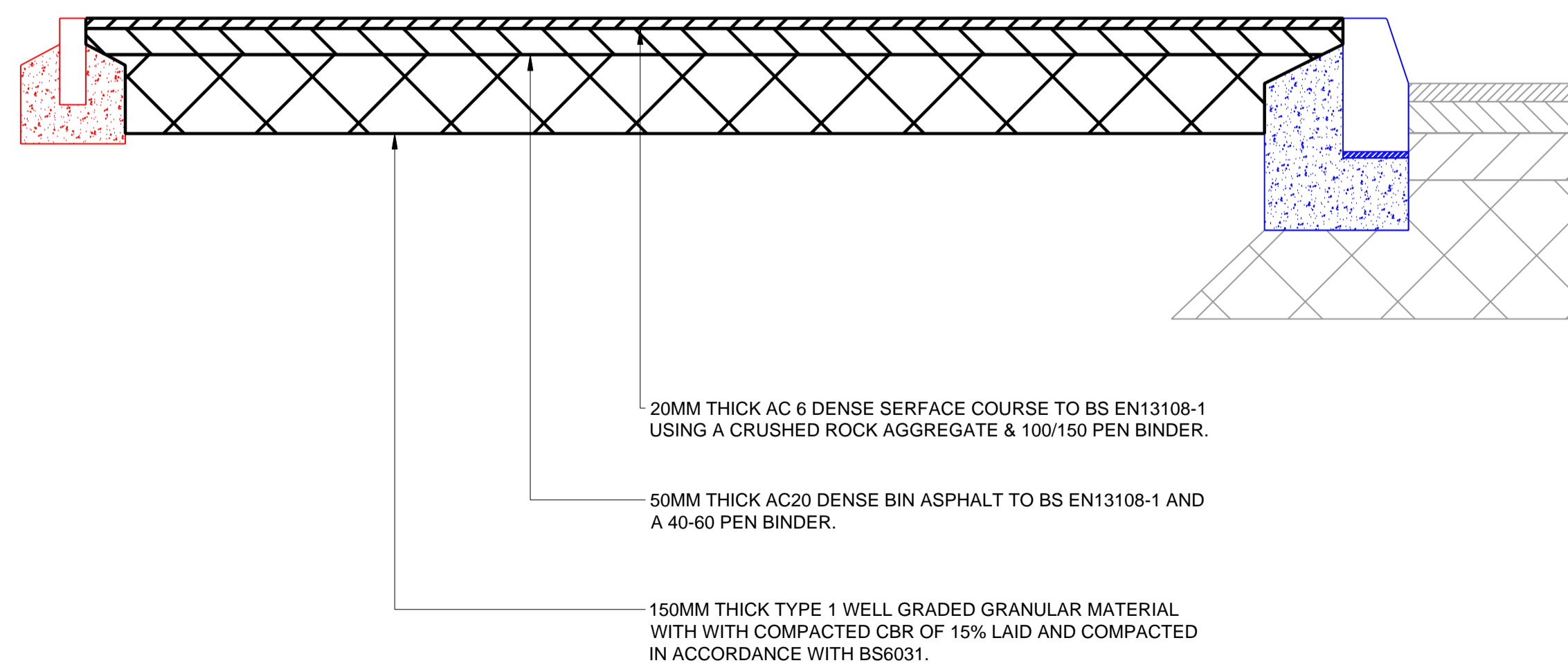

**NEW FOOTWAY CONSTRUCTION**  
1:10

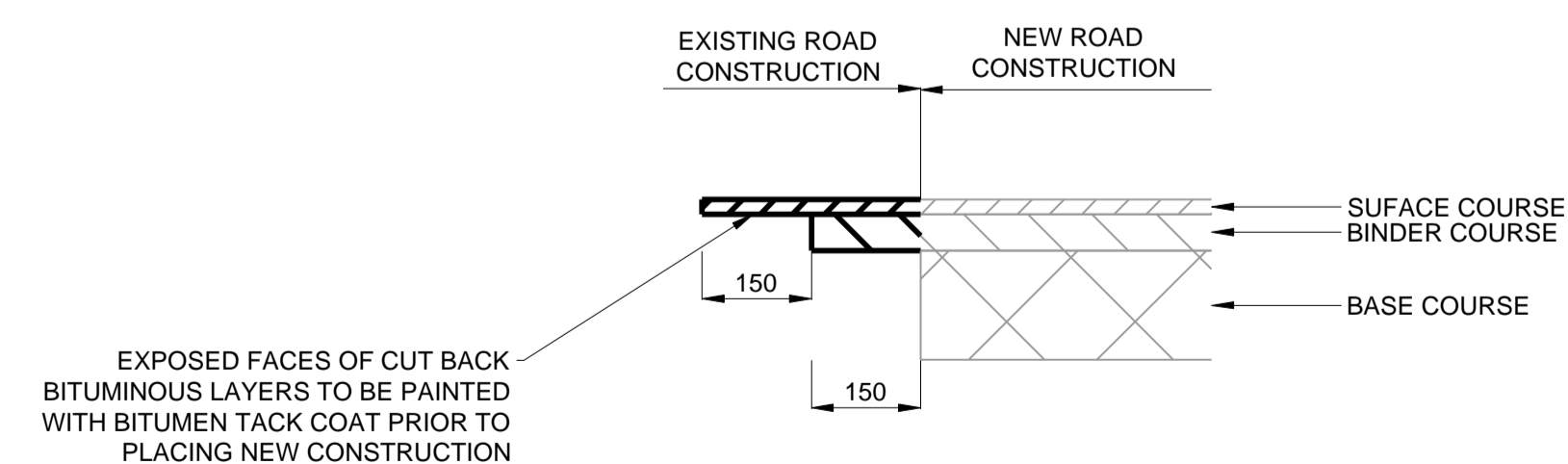

**FOOTWAY TIE-IN DETAIL**  
1:10

PRELIMINARY ISSUE

Rev.	Date	Description
C01	04.10.23	ISSUED FOR CONSTRUCTION



Client: CANHAM HOMES LTD  
Job: CRANBROOK ROAD FRITTENDEN KENT TN17 2DB  
Title: SECTION 278 CONSTRUCTION DETAILS

Scale @ A1 - AS SHOWN Drawn by: MPC  
Date: 04.10.23 Checked by:

Project Originator Zone Level Type Displ. Drawing No. Rev.  
K23143-BWP-XX-XX-DR -C-402 -P01