

ALL DIMENSIONS ARE TO BE CHECKED ON SITE.  
 ALL DIMENSIONS ARE IN MM UNLESS STATED OTHERWISE  
 ORIGINAL SIZE A3.

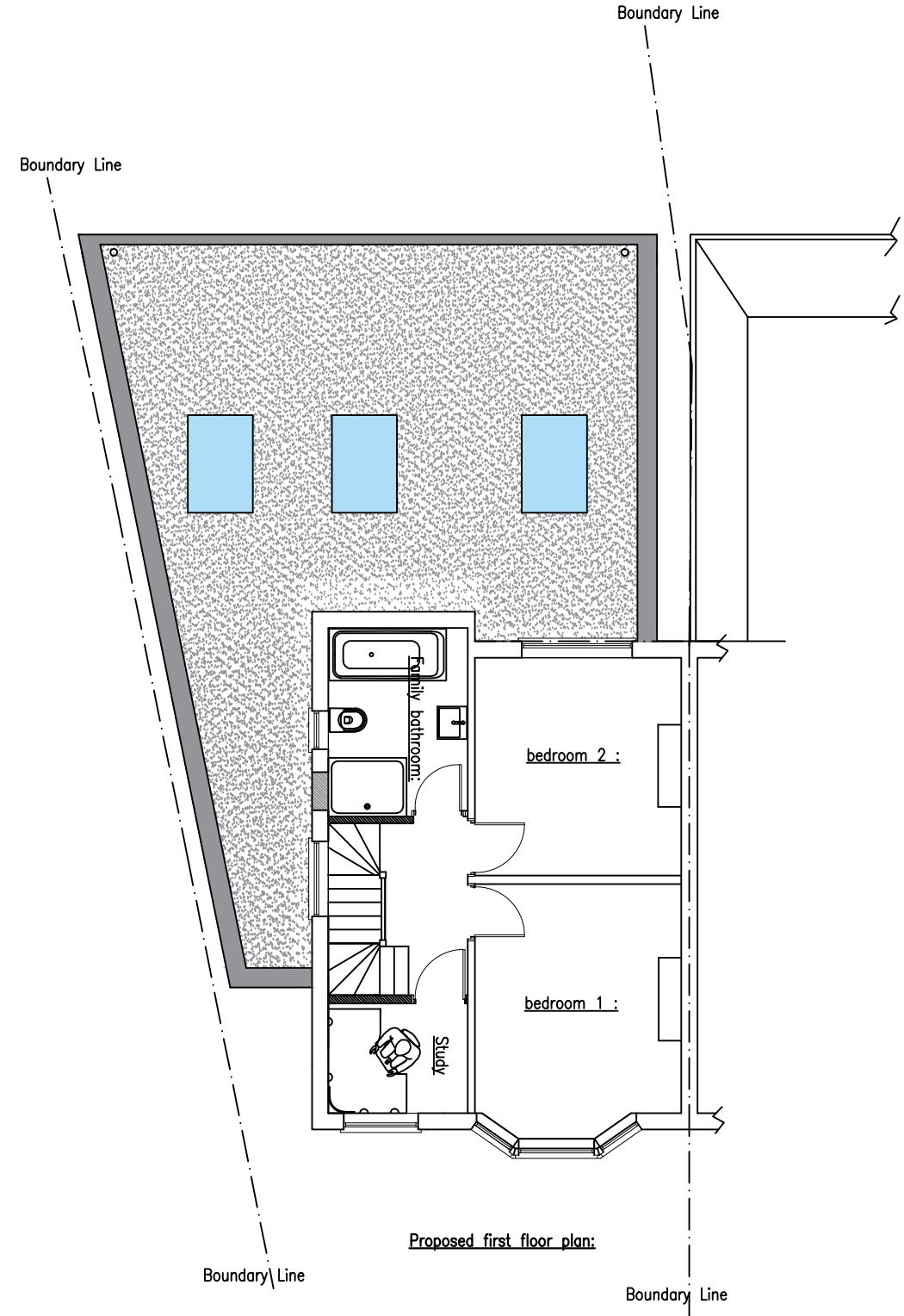
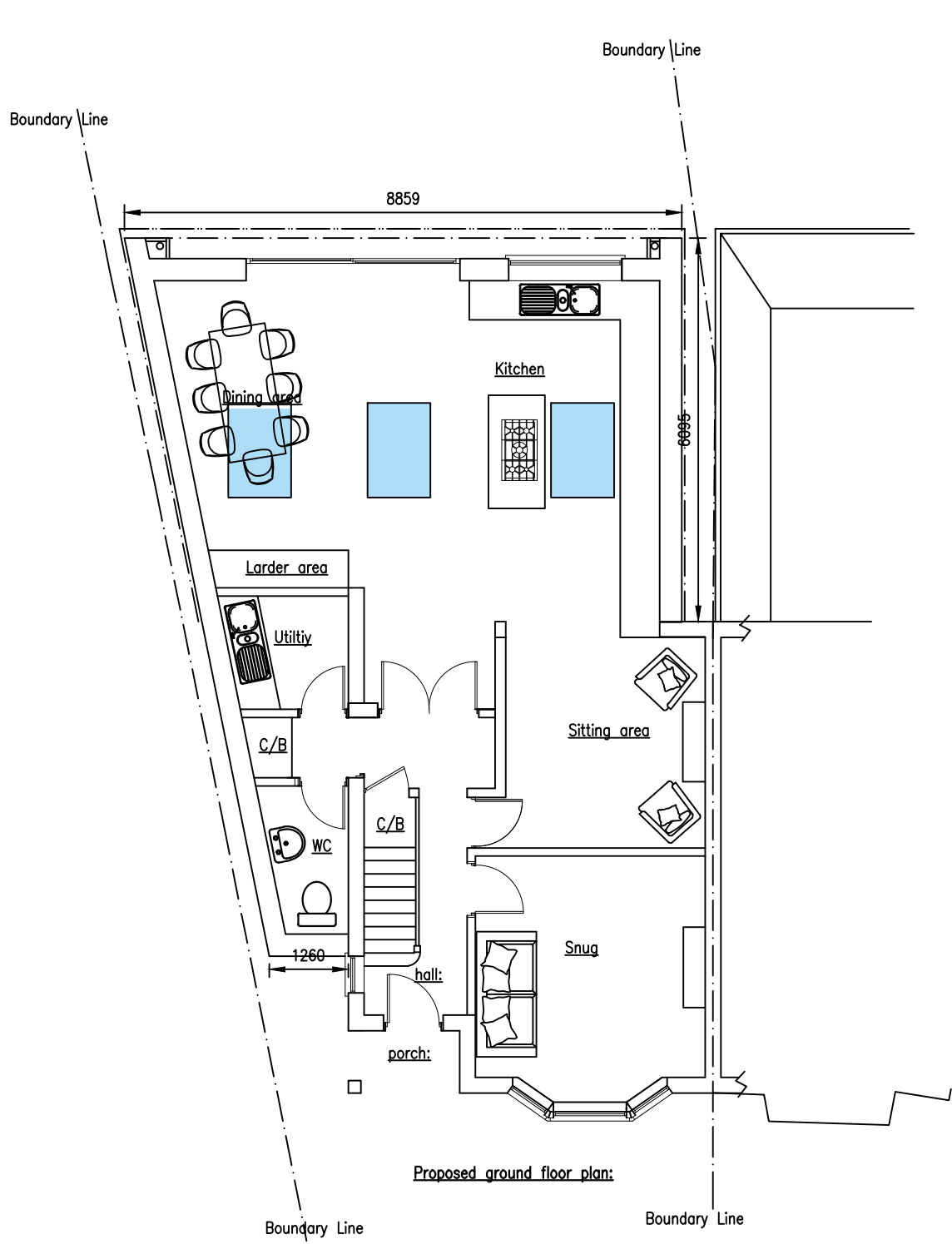
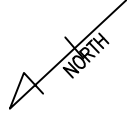
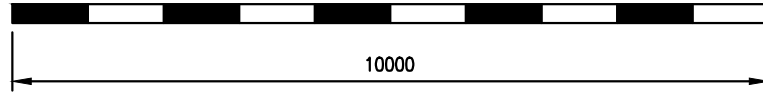

Southborough Building Services LTD  
 design & build

Arun House  
 Church Street  
 Rudgwick  
 West Sussex  
 RH12 3HJ  
 07801 495214  
 mjzsbs@gmail.com

TITLE: Proposed ground floor plan and first floor plan  
 PROJECT: Planning App. Loft and single storey rear extension.  
 Location: 3 Hamilton Close Epsom Surrey KT19 8RG

CLIENT Pop Lifestyle Homes  
 Ranmore Lodge  
 Ranmore Common  
 Road  
 Dorking  
 RH5 6SS  
 TEL

|   |                    |
|---|--------------------|
| SCALE 1:100@ A3                         | DATE 30th Sep 2023 |
| DRN M.J.Z.                              | CHKD               |
| DRN No P.A. 3HC. Proposed GF & FF Plans |                    |