

LUNA - FURNITURE		2022_V1
SYMBOL	REFERENCES	
	AVAILABLE IN 1 NO. FINISH TUNAZI GRAPHIC PRINTED MILL LAMINATE DARK BLUE SEAT PAD - VESCOM LEONE PLUS 7054 98	
	AVAILABLE IN 2ND FINISH: AVAILABLE IN 1 NO. FINISH: OAK EFFECT LAMINATE FURNITURE SUPPLIED BY: KELLER - RESOPAL GLEN OAK 4081 40 DISPLAY WORLD - BIO LAMINATE SPEC TBC SEAT PAD & BACK REST - VESCOM LEONE PLUS 7054 99 TAUPE	
	ROUND STOOLS & PUFFS (H) - CORNVAL HIGH PEDESTALS - FLOOR FIXED (L) - CORNVAL LOW PEDESTALS - FLOOR FIXED (P) - LOW PUFFS - LOOSE	
	AVAILABLE IN 2ND FINISHES: GREEN SEAT PAD - VESCOM LEONE PLUS 7054 97 DARK BLUE SPECKLED SEAT PAD - VESCOM LEONE PLUS 7057 14	
	SQUARE STOOLS (HS) - HIGH LOOSE STOOL (LS) - LOW LOOSE STOOL	
	AVAILABLE IN 2ND FINISHES: GREEN SEAT PAD - VESCOM LEONE PLUS 7054 97 DARK BLUE SEAT PAD - VESCOM LEONE PLUS 7054 98 WITH OR WITHOUT END SCREEN ACCESS	
	L503 - LUNASCAP WITH CT01 SEMI CIRCLE TABLE 3 COVERS PLUS 2 STOOLS LUNASCAP - INNER BENCH WITH GREEN SEAT PAD - VESCOM LEONE PLUS 7054 97 CT01 SEMI CIRCLE TABLE 600 X 1300MM	
	TABLE TOP - OAK EFFECT LAMINATE FURNITURE SUPPLIED BY: KELLER - RESOPAL GLEN OAK 4081 40 DISPLAY WORLD - BIO LAMINATE SPEC TBC	
	T01 - LOW TABLE 500 x 600mm TOP HEIGHT 750mm T01H - HIGH TABLE 500 x 600mm TOP HEIGHT 1100mm T02 - LOW TABLE 1000 x 600mm TOP HEIGHT 750mm T02H - HIGH TABLE 1000 x 600mm TOP HEIGHT 1100mm TO BE USED WITH END PARTITION ONLY TABLE TOP - RESOPAL 3447 60 CLOUDY CEMENT LOW COMMUNAL TABLES TOP HEIGHT 750mm 2400 x 800mm TABLE TOP - RESOPAL 3447 60 CLOUDY CEMENT WITH OR WITHOUT MR HAPPY GRAPHIC MAGIC TABLE TABLE TOP - RESOPAL 8417 60 2ND WHITE HIGH COMMUNAL TABLES TOP HEIGHT 1100mm 2400 x 800mm TABLE TOP - RESOPAL 3447 60 CLOUDY CEMENT WITH OR WITHOUT MR HAPPY GRAPHIC LOOK-OUT TABLES TOP HEIGHT 1100mm 1200 x 600mm LOW (NO GRAPHIC) HIGH (ARCH) HIGH (NO GRAPHIC) HIGH (CIRCLES) 3000 x 4500mm - 4 PERSON 2400 x 4500mm - 4 PERSON 1800 x 4500mm - 4 PERSON TABLE TOP - RESOPAL 3447 60 CLOUDY CEMENT MESH SCREEN WITH GRAPHIC APPLIED NEW BARS FEATURE MAPS UP-LIP TABLE (1100mm HIGH) CLOUDY CEMENT LAMINATE TOP WITH SOLID PLYWOOD EDGES IN (NO. SIZES) 1000x500mm (2ND STOOLS) 1800x500mm (2ND STOOLS) 2400x500mm (2ND STOOLS) 3000x500mm (2ND STOOLS) LUNASCAP ROUND TABLE 600mm TABLE TOP - OAK EFFECT LAMINATE FURNITURE SUPPLIED BY: KELLER - RESOPAL GLEN OAK 4081 40 DISPLAY WORLD - BIO LAMINATE SPEC TBC ROUND TABLE - 1100mm TABLE TOP - OAK EFFECT LAMINATE FURNITURE SUPPLIED BY: KELLER - RESOPAL GLEN OAK 4081 40 DISPLAY WORLD - BIO LAMINATE SPEC TBC MAGIC TABLE - 1100mm TABLE TOP - RESOPAL 8417 60 2ND WHITE TOP HEIGHT 750mm SCREENS TBC BY LUNAS	

2021 CREW ROOM - ECO		2001_V1
	STAFF CHAIR UPHOLSTERED SEAT PAD CHEFFAIR CARNOO VITA POLYPROPYLENE SHELL OAK LEGS SUPPLIED BY DISPLAY WORLD	
	HIGH STOOL CHROME FRAME WITH WHITE POLYPROPYLENE SEAT SUPPLIED BY DISPLAY WORLD	
	STAFF LOUNGE CHAIR NEW N.ECO CREW ROOM REPLACES BY DISPLAY WORLD	
	STAFF SOFA UPHOLSTERED IN VESCOM MALTA 7037 08 OAK LEGS SUPPLIED BY DISPLAY WORLD	
	STORAGE STOOL UPHOLSTERED IN VESCOM MALTA 7037 08 SUPPLIED BY DISPLAY WORLD	
	TABLE 1500 x 600mm PONDOR COATED BLACK PEDESTAL CT1 TABLE TOP FINISHED IN MILLENNIUM OAK	
	COFFEE TABLE 800mm PONDOR COATED BLACK PEDESTAL CT2 TABLE TOP FINISHED IN FORMICA LAMINATE MILLENNIUM OAK SUPPLIED BY DISPLAY WORLD	
	PC UNIT BLACK FRAME WITH M3 CONSUMER LOCK HOLES WHITE LAMINATE WORK TOP WITH COLOUR EDGING 800 L x 400 D x 1000 H SUPPLIED BY DISPLAY WORLD	
	HELMAN LOCKERS RANGE OF 4 STANDING OR 10 WALLET LOCKETS AVAILABLE WITH OR WITHOUT USB CHARGING DOOR FINISH IN FORMICA CONTACT - RANDOM PATTERN TO MATCH VISUAL 1. FORMICA - F418 TERRECOTTA 2. FORMICA - F255 POLAR WHITE	
	STORAGE STOOL TOP OF STOOL UPHOLSTERED SEAT PAD - CHEFFAIR CARNOO VITA STOOL BASE FORMICA LAMINATE MILLENNIUM OAK SUPPLIED BY DISPLAY WORLD	
	BENCH 1200x500mm TOP OF STOOL UPHOLSTERED SEAT PAD - VESCOM MALTA 7037 08 BENCH LEGS IN FORMICA LAMINATE MILLENNIUM OAK	
	MODULAR CREW UNIT MODULE A: 4NO. LOCKERS & 1NO. HIGH LEVEL CUPBOARD MODULE B: 3NO. LOCKERS, 1NO. OPEN SHELF & 1NO. LARGE HIGH LEVEL CUPBOARD MODULE C: 1NO. 1500mm HIGH LEVEL CUPBOARD, 1NO. BOARDING BOARD STORAGE, 4NO. OPEN SHELVES WITH USB SOCKETS MODULE D: CONCEALED RECYCLING UNIT & OPEN LEVEL SHELF MODULE E: 4NO. CHAIRS IN CUPBOARD UNDER COUNTER FRIDGE SUPPLIED BY H&M, WORKTOP FORK SINKS SUPPLIED BY H&M, WORKTOP FORK SINKS SUPPLIED BY H&M SURROUND FINISHED IN FORMICA LAMINATE MILLENNIUM OAK WITH FORMICA SPRING WHITE BACK PANELS COORD TO BE A MIX OF FORMICA F418 TERRECOTTA & F255 POLAR WHITE SUPPLIED BY DISPLAY WORLD	

MARKETING ELEMENTS		2022_V6
	DIGITAL PRICE BOARD - 32" DRP-P2	
	DIGITAL WINDOW POSTER (ANISOR) - 40" EXTERIOR FACING - DRIP EX LINE INTERIOR FACING - DRIP FREE	
	ORDER READY BOARD - 32" ORB-L32	
	PROXIT BOARDS 2 x 47" PORTRAIT SCREENS	
	DOUBLE SIDED SELF ORDER KIOSK (SOK)	
	SINGLE SIDED SELF ORDER KIOSK (SOK)	
	AIRCHARGE MOBILE PHONE CHARGING SOLUTION	
	TABLET TABLE 700mm SCREEN IN SCHEME SPECIFIC LAMINATE IF POWERDATA CANT BE ACCESSED THROUGH FLOOR	
	COLOUR REFERENCE HEAVY EQUIPMENT FURNITURE (OR INDICATED BY COLOURED HATCH) EXTRA FURNITURE EQUIPMENT HEAVY EQUIPMENT FURNITURE EQUIPMENT FUTURE OPTIONAL EQUIPMENT NEW CONSTRUCTION EXISTING STRUCTURE TO BE REMOVED EXISTING 30 WHITE FIRE RATE WALL EXISTING 15 WHITE FIRE RATE WALL PROPOSED 15 WHITE FIRE RATE WALL PROPOSED 30 WHITE FIRE RATE WALL	

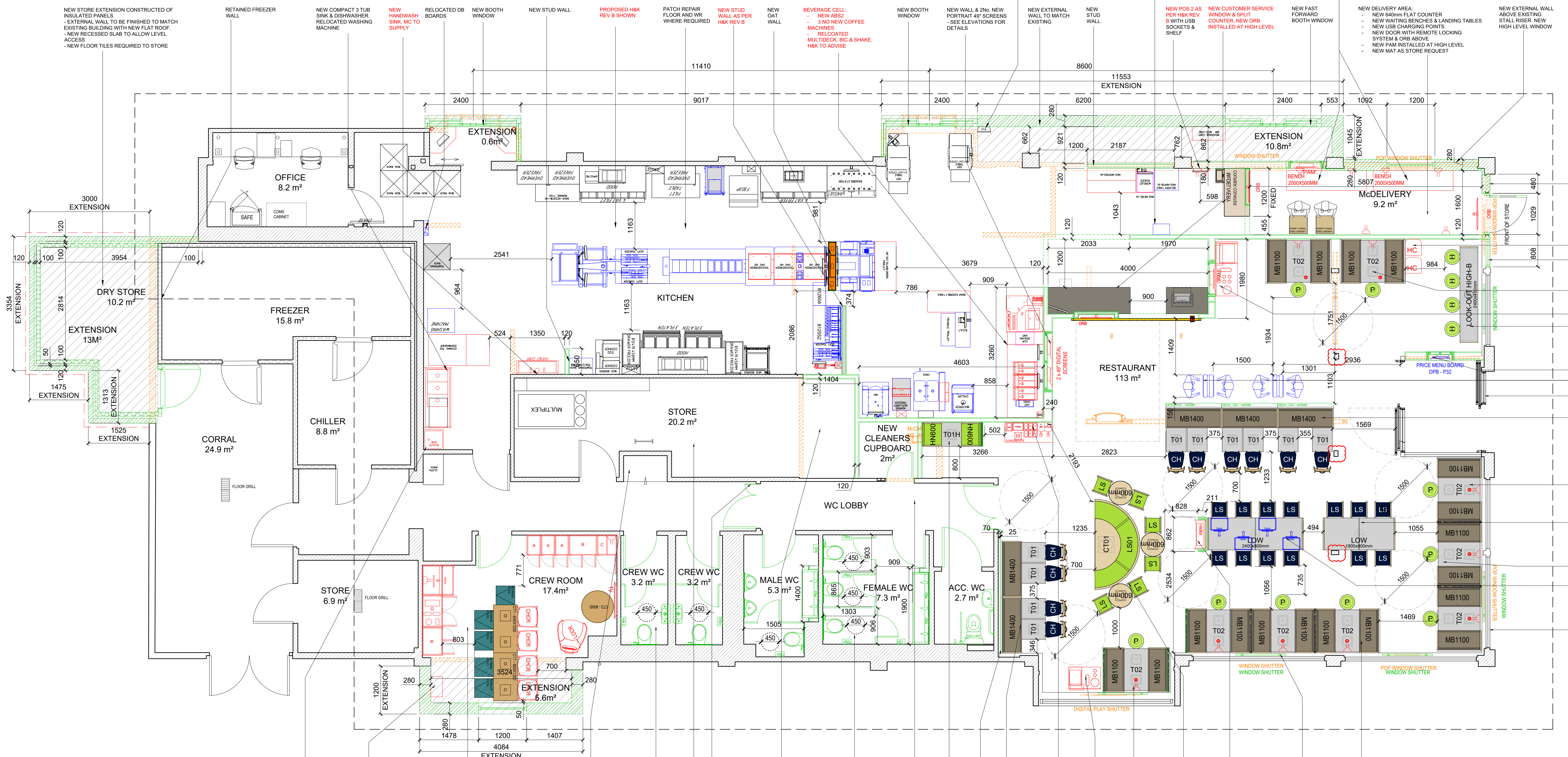

**NOTES**

- All dimensions and levels are to be checked on site.
- Any discrepancies are to be reported to the architect before any work commences.
- This drawing shall not be scaled to ascertain any dimensions. Work to figures only.
- This drawing shall not be reproduced without express written permission from AEW.
- Title overlay drawings and ownership boundaries are produced using all reasonable endeavours. AEW cannot be responsible for the accuracy or scale discrepancy of base plans supplied to them.
- All works are to be undertaken in accordance with Building Regulations and the latest British Standards.
- All proprietary materials and products are to be used strictly in accordance with the manufacturers recommendations.

**CDM 2015**  
Client notified of duties: At design workshops  
Principal Designer: CBS  
Unless noted below, all known hazards have been highlighted on the drawing.

Notes:  
All drawings to be read in conjunction with all other drawings as noted on issue sheet.

D 10/10/23 AL MW  
UPDATED FOLLOWING PROPOSED H&M REV B -  
NEW STUDIO WALL SHOWN AS PER H&M REV B  
NEW HANDWASH & BUTLER SINK, MC TO SUPPLY  
NEW SECTION OF 700MM BOUNDING OUT TO WALL

**DESIGN WORKING GROUP APPROVED**

C 19/07/2023 ST MW  
UPDATED FOLLOWING STG1 MTG 05/01/2023  
- RETAIN FREEZER WALL  
- UPDATES TO EXTENSIONARY STORE AREA  
- NEW FLOOR TILES REQUIRED TO DRY STORE  
- PLINTH REQUIRED TO VOID SPACE ABOVE LOCKERS IN CREW ROOM  
- NEW FLOOR TILES REQUIRED TO STORE  
- 2NO. BENCHES & USB SOCKETS ADDED  
- NEW CLEANERS CUPBOARD ADDED  
- PATCH REPAIR REQUIRED TO KITCHEN FLOOR  
- EXG DRFB RELOCATED  
- NEW DRB SOCIAL TO EXG DOOR  
- REMOVE 2ND CRB  
- CUT BACK WALL TO SLIT NEW COUNTER  
- DWG APPROVED STAMP ADDED

B 16/06/2023 MW DP  
UPDATED TO PLANNING EMAIL  
- SCALE BAR AND NORTH POINT SHOWN

A 17/05/2023 SW DP  
UPDATED TO DWG COMMENTS  
- HIGH LOOK OUT TABLE OMITTED AND REPLACED WITH BOOTH  
- LUNASCAP ROTATED 180 DEGREES AND REPOSITIONED  
- SEAT COUNTS UPDATED  
- WATER DISPENSER OMITTED FROM CREW ROOM  
RESUBMITTED FOR DWG APPROVAL

13/10/23 AL MW  
INITIAL ISSUE  
REV Date Drawn by: Checked by:  
Status Purpose of Issue  
**S2 For Information**  
Drawing stage  
**STAGE 1**  
Client  
McDonald's Restaurants Ltd

project: 334 COPPEN ROAD  
BLYTH, NE24 5ND 1174  
drawing: PROPOSED GA PLAN  
COTF

date: 13.02.23 drawn: AL  
scale: A0 1:50 checked: MW

**PROPOSED GENERAL ARRANGEMENT PLAN 1:50**

REV	DESCRIPTION
B1	Remove flurry spinner.
B2	Show new construction wall behind the 3IP and show a new wall mounted 3IP service chase.
B3	Show tempering rack here and service note.
B4	Show ovens here and relocate tempering as per sticky note.

AREAS SCHEDULE	EXISTING	PROPOSED
TOTAL COVERS	116	93
DINING AREA INTERNAL AREA (m²)	149m²	113m²
WC INTERNAL AREA (m²)	15.3m²	15.3m²
CREW ROOM INTERNAL AREA (m²)	13.5m²	17.4m²

**COTF & REIMAGE LUNA**