

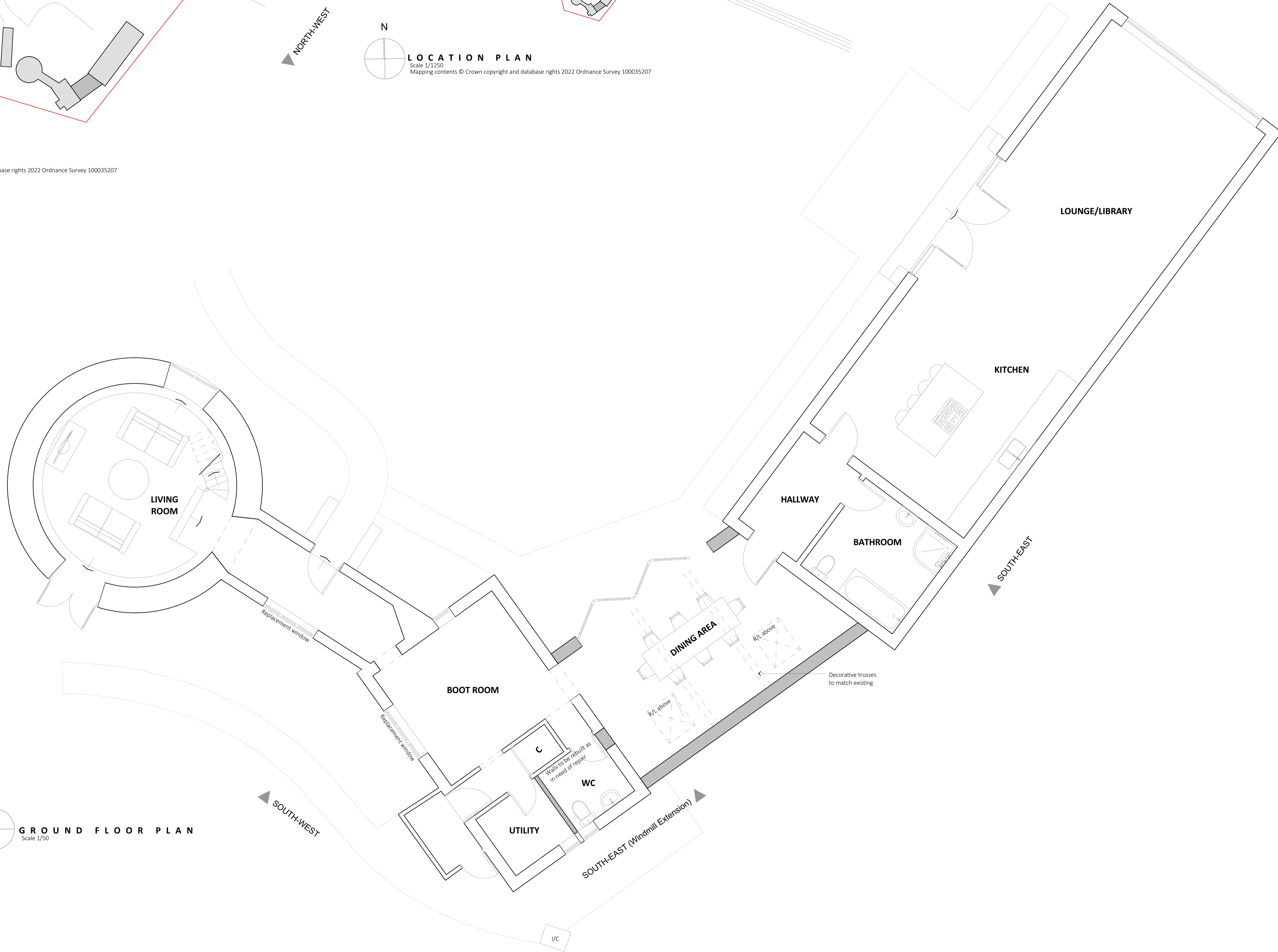

**SITE PLAN**  
 Scale 1/500  
 Mapping contents © Crown copyright and database rights 2022 Ordnance Survey 100035207



**LOCATION PLAN**  
 Scale 1/1250  
 Mapping contents © Crown copyright and database rights 2022 Ordnance Survey 100035207



**GROUND FLOOR PLAN**  
 Scale 1/50

Amendments: \_\_\_\_\_ Date: \_\_\_\_\_ Rev: \_\_\_\_\_



Willow House, 9 Willow Lane  
 Norwich, Norfolk, NR2 1EU  
 www.smg-architects.co.uk  
 info@smg-architects.co.uk  
 01603 614422

All dimensions are to be checked on site and the Architect is to be notified of any discrepancies. Written dimensions are to be followed in preference to scaled dimensions. This drawing is copyright and may not be reproduced without the written consent of SMG Architects.

Job Title  
 Extension and alterations at The Old Mill, Windmill Road, Meeting Hill, Worstead, NR28 9LT  
 Client  
 Mr & Mrs Coleman

Dwg. Title  
 Non-Material Amendment Drawings - Scale as shown

Job No.	Drawn by	Checked by
22.5038.093	RC	RC
Dwg. No.	Rev	Date
NM01		12/10/2023

